

3a

Thunderbird Park Precinct Plan

Final Draft

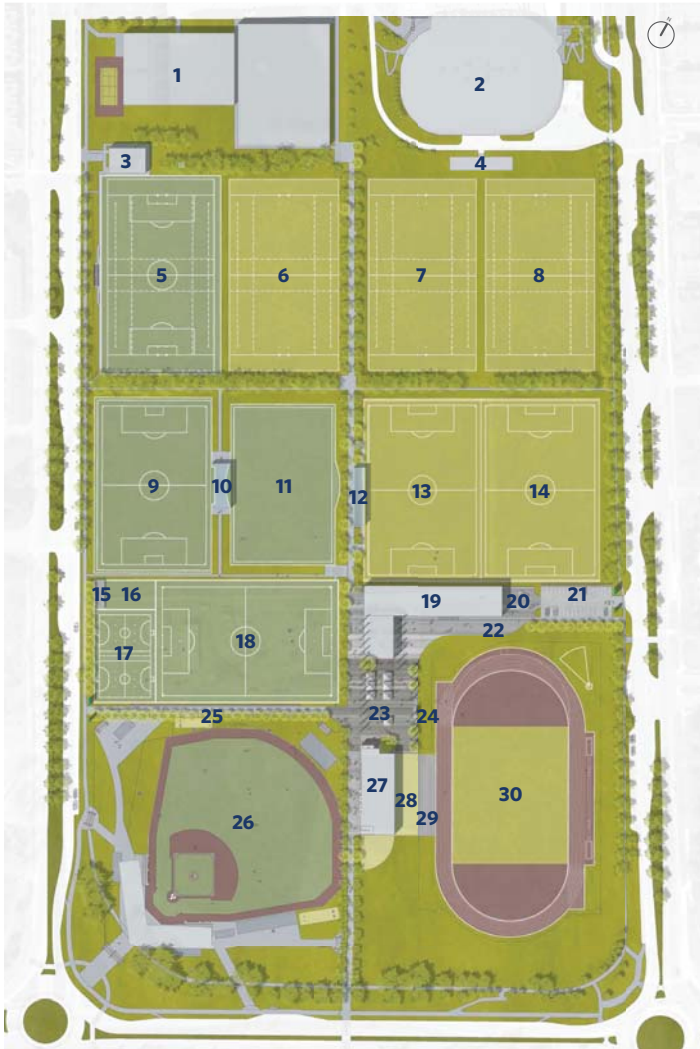

The following illustrates the new layout for the fields and facilities.

Legend

1. Tennis Centre Main Office
2. Doug Mitchell Thunderbird Sports Centre
3. Rugby Pavilion
4. Gerald McGavin UBC Rugby Centre
5. Wolfson West Soccer / Rugby Field
6. Wolfson East Field
7. Arthur Lord Field
8. Frank Buck Field
9. Harry Warren Field
10. Proposed Weather Protection
11. Harold Wright Field
12. Proposed Natural Grass Field Bleacher
13. Proposed Natural Grass Field #1
14. Proposed Natural Grass Field #2
15. Storage Area
16. Proposed Field Hockey Warm-up Area
17. Proposed Futsal Fields
18. Proposed Artificial Turf Field
19. NSDC Whitecaps / NSDC UBC
20. Turn Around / Pick-up & Drop-off
21. Surface Parking / Laneway / Fire Service & Emergency Access
22. Pedestrians / Bikes
23. Thunderbird Plaza
24. Celebration Podium
25. Pedestrians / Bikes
26. Baseball Park / Stadium
27. Baseball Fieldhouse
28. Potential Warm Up / Storage Area
29. Track / Field Bleachers
30. Existing Track & Field Oval

-  Turf fields
-  Natural grass fields





Key Plan - N.T.S.

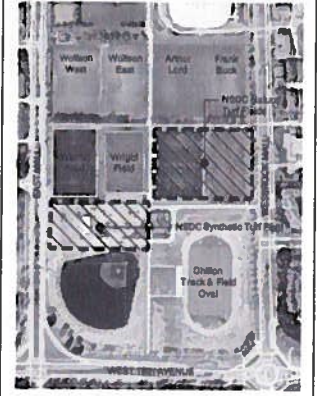

Legend



UBC PROPERTIES TRUST

No	Date	Revisions	By
1	04.21.2016	Open House	JJ

This drawing, as an instrument of service, is provided by, and is the property of The MBTW Group. The contractor shall check and verify all dimensions and report all errors and omissions to the Landscape Architect when used in relation to this drawing before proceeding with the work. This drawing is not to be scaled.



Designed By: North Arrow

the mbtw group
 landscape architecture | urban design | site planning | construction | art & design
 1100 West Broadway, Suite 1000, Vancouver, BC V6E 2R1
 Tel: (604) 681-1111 Fax: (604) 681-1112

RICHARD FINDLAY
 LANDSCAPE ARCHITECT INC.

Project Name: NSDC Natural & Synthetic Turf Fields
 Municipality: University of British Columbia

Sheet Title: CONTEXT PLAN

Design:	Drawn:	Scale:	Drawing No.:
Date of Drawing:	Job No.:	UPT 001	C-1

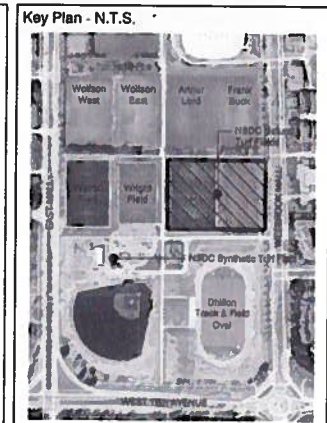
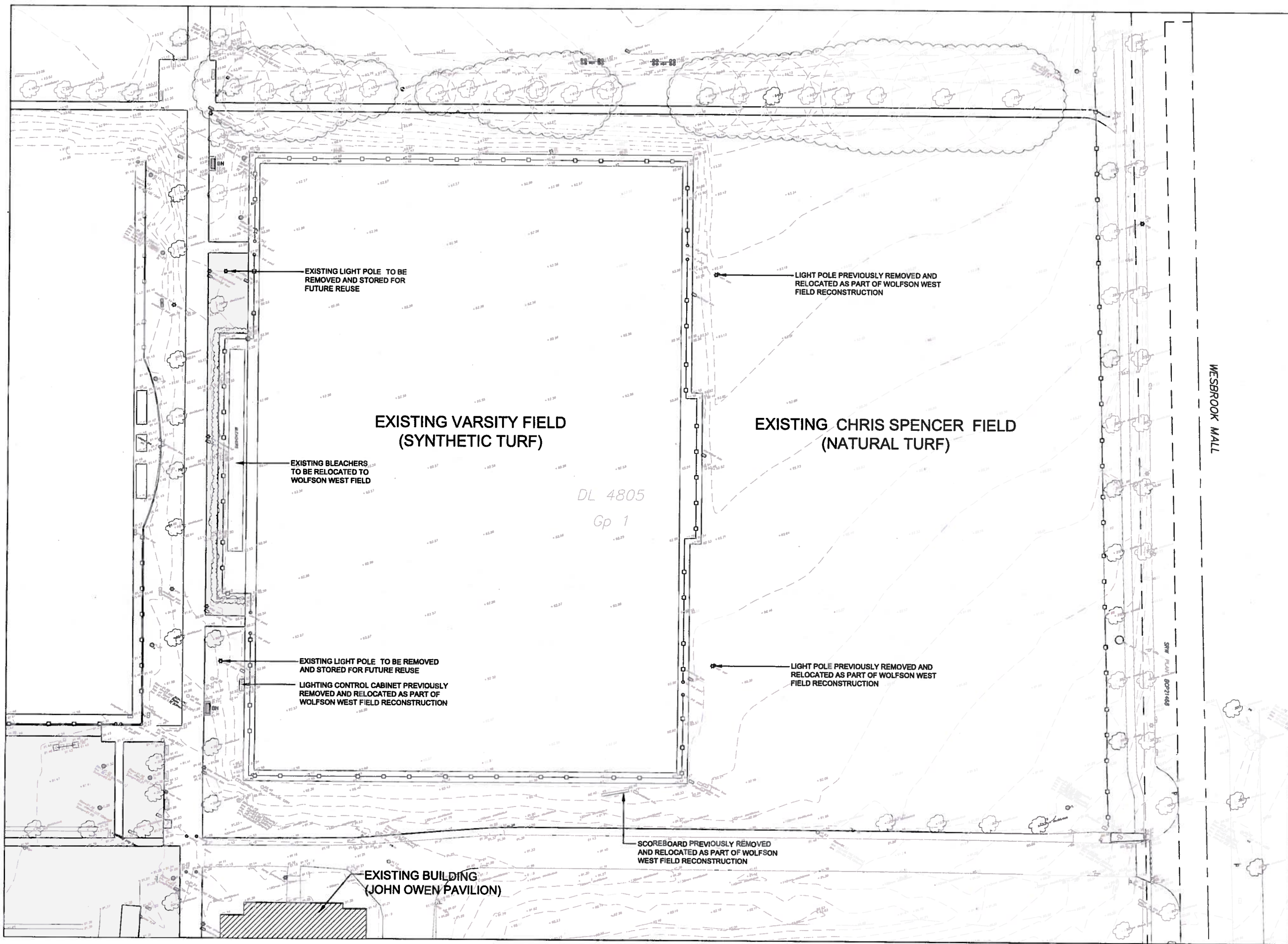

- Legend
- EXISTING CONTOUR (0.25M INTERVALS)
 - EXISTING SPOT ELEVATION
 - EXISTING CHAIN LINK FENCE
 - EXISTING TREE
 - EXISTING VEGETATION
 - EXISTING LIGHT POLE
 - EXISTING BENCH
 - EXISTING TRASH RECEPTACLE



1. 04.01.2014 Open House		JJ
No	Date	Revisions

This drawing, as an instrument of service, is provided by, and is the property of the MBTW Group. The contractor shall check and verify all dimensions and report all errors and omissions to the Landscape Architect within 14 days of completion of the work. This drawing is not to be scaled.

Designed By North Arrow

the mbtw group

RICHARD FINDLAY
LANDSCAPE ARCHITECT INC

Project Name: NSDC Natural & Synthetic Turf Fields

Municipality: University of British Columbia

Sheet Title: EXISTING CONDITIONS PLAN

Designer: JJ	Drawn: OL	Scale: 1:300	Drawing No.:
Date of Drawing: DECEMBER 2014	Job No.: UPT 001	EX-1	

U:\Projects\14\14000_UBC\14000_UBC_Plan\14000_UBC_Plan.dwg 2014/12/01 10:00:00

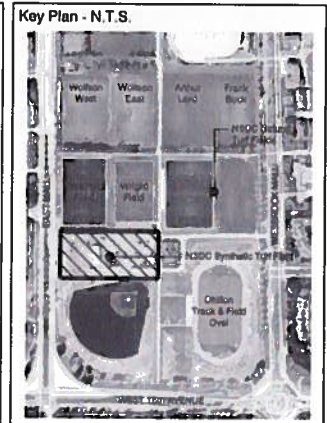
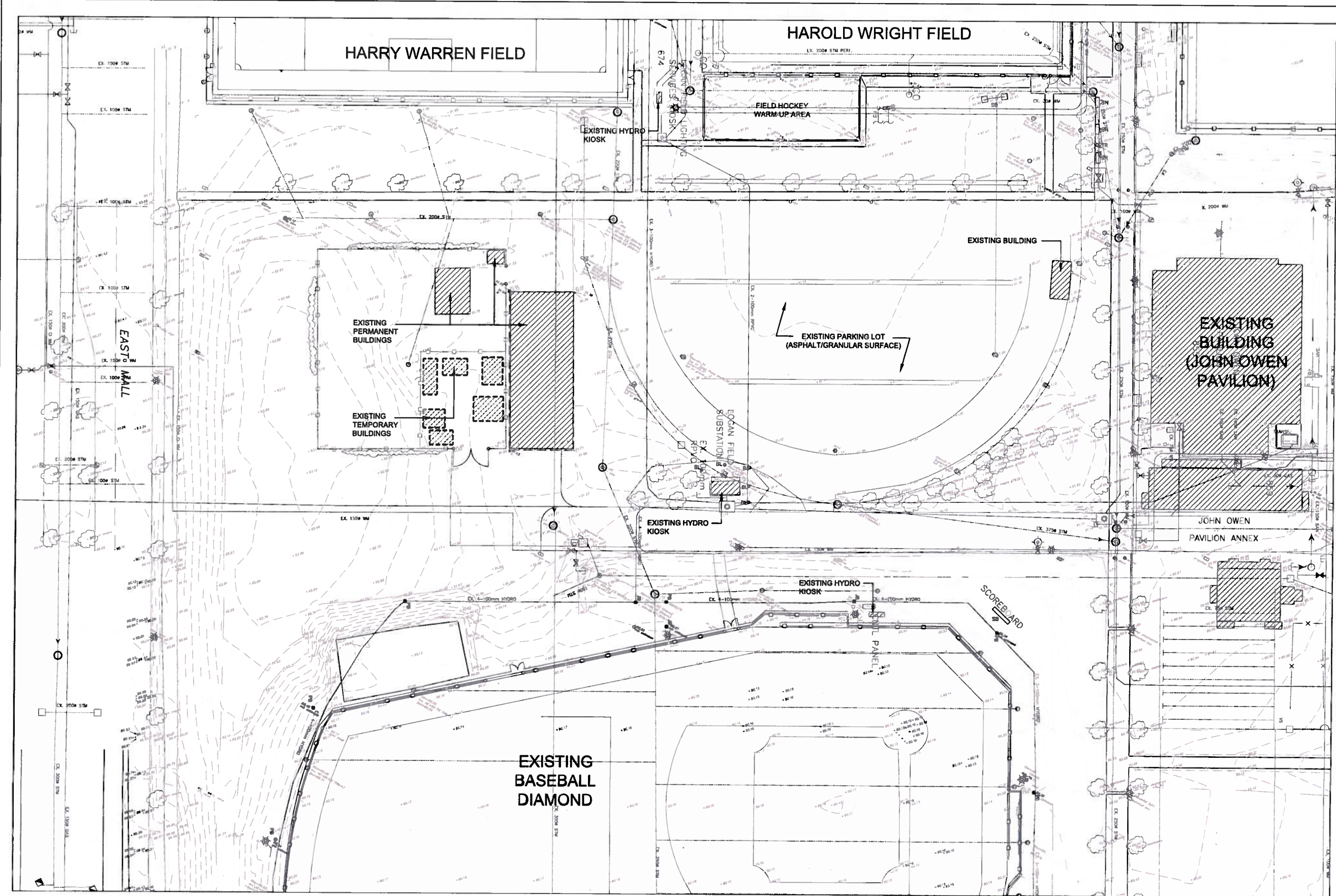

- Legend**
- EXISTING CONTOUR (0.25M INTERVALS)
 - EXISTING SPOT ELEVATION
 - EXISTING CHAIN LINK FENCE
 - EXISTING TREE
 - EXISTING VEGETATION
 - EXISTING PERMANENT BUILDING/STRUCTURE
 - EXISTING TEMPORARY BUILDING/STRUCTURE
 - EXISTING LIGHT POLE
 - EXISTING STEEL BOLLARD
 - EXISTING BENCH
 - EXISTING TRASH RECEPTACLE
 - EXISTING BIKE RACK
 - EXISTING SCOREBOARD



No	Date	Revisions	By
1.	04.21.2014	Open House	

This drawing is an instrument of service, is prepared by, and is the property of the mbtw group. The contractor shall check and verify all dimensions and report all errors and omissions to the Landscape Architect prior to and during the starting period preceding the start of the work. This drawing is not to be scaled.

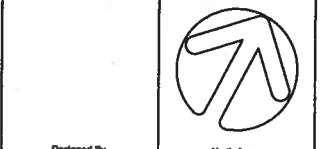

Designed By: **the mbtw group**
landscape architecture | urban design | site planning | construction management

ERIC R. D. A.
LANDSCAPE ARCHITECT

Project Name: **NSDC**
 Natural & Synthetic Turf Fields

Municipality: University of British Columbia

EXISTING CONDITIONS PLAN

Designed: JJ	Drawn: OL	Scale: 1:300	Drawing No.: EX-2
Date of Drawing: DECEMBER 2014	Job No.: UPT 001		

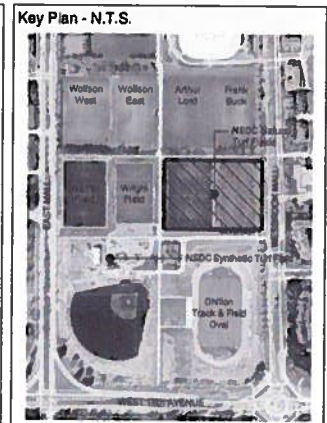

- Legend**
- LIMIT OF WORK
 - ☁ EXISTING TREE TO REMAIN
 - PROPOSED HEDGE 2.2M HT. TRAMA PLACIDA (PRECISION RED CEDAR)
 - ▨ PROPOSED MAINTENANCE PATH (GRAVEL OR PAVING)
 - ▬ 6.0m HT. BLACK WYLL CHAIN LINK FENCE
 - ▬ 3.4m HT. BLACK WYLL CHAIN LINK FENCE
 - ▬ 2.4m HT. BLACK WYLL CHAIN LINK DOUBLE GATE
 - ▬ 2.4m HT. BLACK WYLL CHAIN LINK SINGLE GATE



No	Date	Revisions	By
1.	04.21.2010	Open House	JJ

This drawing, as an instrument of service, is provided by, and is the property of The MBTW Group. The customer shall check and verify all dimensions and report all errors and omissions to the Landscape Architect when used in this drawing before proceeding with the work. This drawing is not to be used.

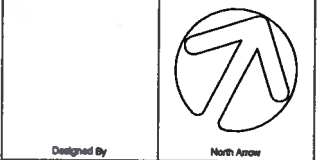

Designed By: **the mbtw group**

Project Name: **RICHARD FINDLAY LANDSCAPE ARCHITECTURE**

Project Name: **NSDC Natural & Synthetic Turf Fields**
 Municipality: **University of British Columbia**

Sheet Title: **SITE PLAN**

Designed: JJ	Drawn: OL	Scale: 1:300	Drawing No.: SP-1
Date of Drawing: DECEMBER 2014	Job No.: UPT 001		

U:\Projects\2014\14-001\14-001-001\14-001-001-001.dwg, 21/12/2014, 10:30 AM, JJ

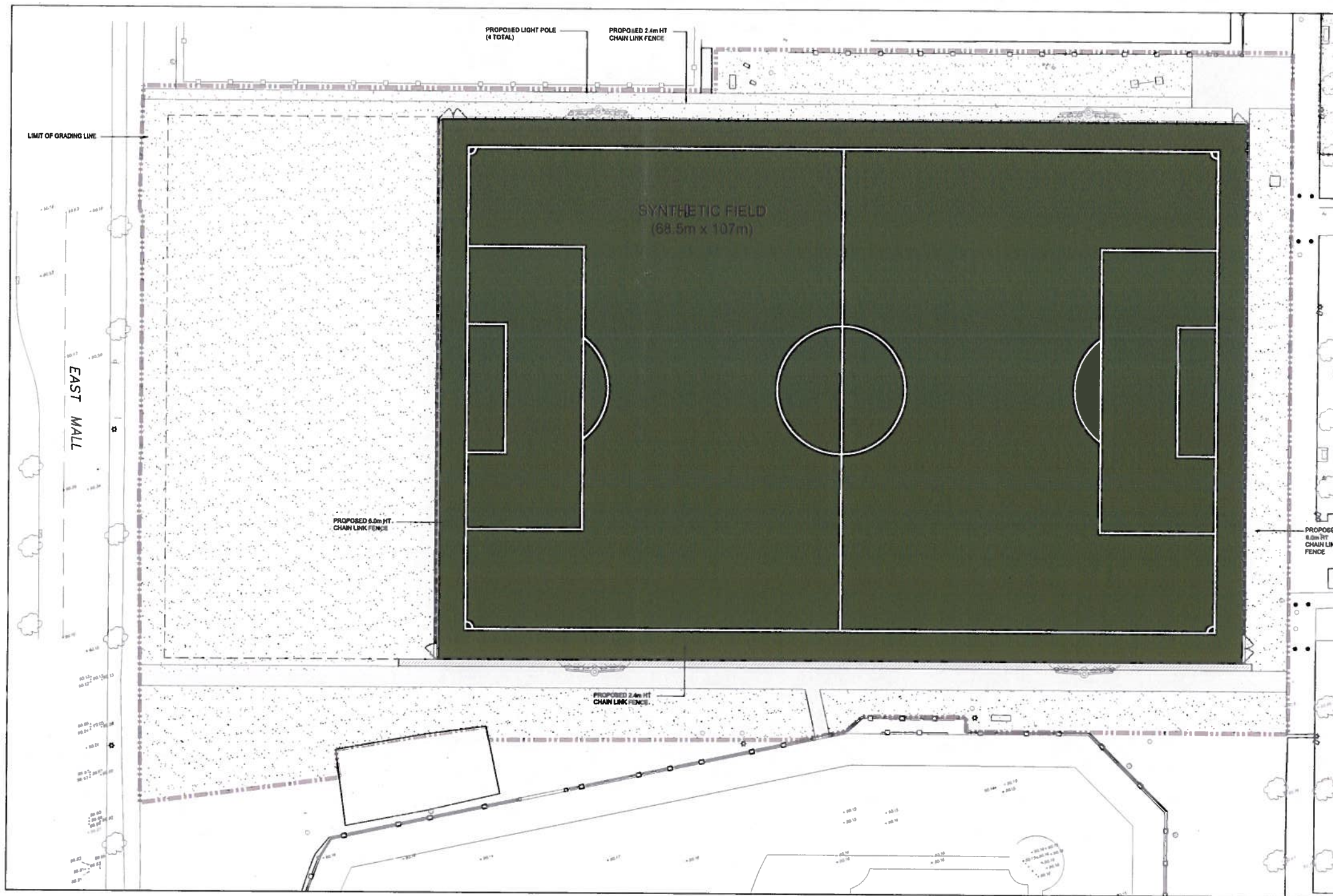

Key Plan - N.T.S.

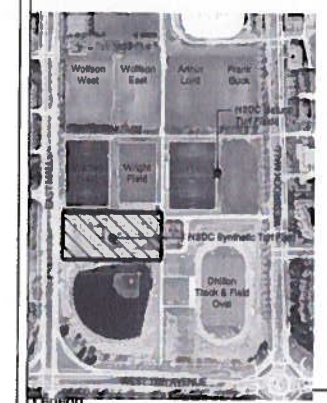

- Legend**
- LIMIT OF WORK
 - ☉ EXISTING TREE TO REMAIN
 - ▨ PROPOSED TURF/LAWN AREA
 - ▤ PROPOSED PEDESTRIAN PARKING
 - ▥ PROPOSED VEHICULAR PARKING
 - ▧ PROPOSED RETAINING WALL
 - ▩ 6.0m HT. BLACK VINYL CHAIN LINK FENCE
 - 2.4m HT. BLACK VINYL CHAIN LINK FENCE
 - 2.4m HT. BLACK VINYL CHAIN LINK DOUBLE GATE
 - ▬ 2.4m HT. BLACK VINYL CHAIN LINK SINGLE GATE



UBC PROPERTIES TRUST

This drawing, as an instrument of service, is provided by, and is the property of, the MBTW Group. The contractor shall check and verify all dimensions and report all errors and omissions to the Landscaper. Approval shall not be given to this drawing before proceeding with the work. This drawing is not to be used.

Designed By:  North Arrow

the mbtw group
landscape architecture | urban design | site planning | construction | data | urban design
 100 - 1000 Ave. Rd. 10, Toronto, Ontario, Canada M5S 1A8
 T: (416) 593-8888 | F: (416) 593-8888 | www.mbtw.com

RICHARD FINDLAY
 LANDSCAPE ARCHITECT INC.

NSDC
 Natural & Synthetic Turf Fields
 Municipality: University of British Columbia

Sheet Title:

Designed:	Drawn:	Scale:	Drawing No.:

C:\Users\jw\Documents\Projects\NSDC\NSDC_SitePlan.dwg, 14-Dec-14, 10:53 AM, 10:53 AM, 10:53 AM



VIEW OF NATURAL TURF FIELDS FROM NORTHEAST

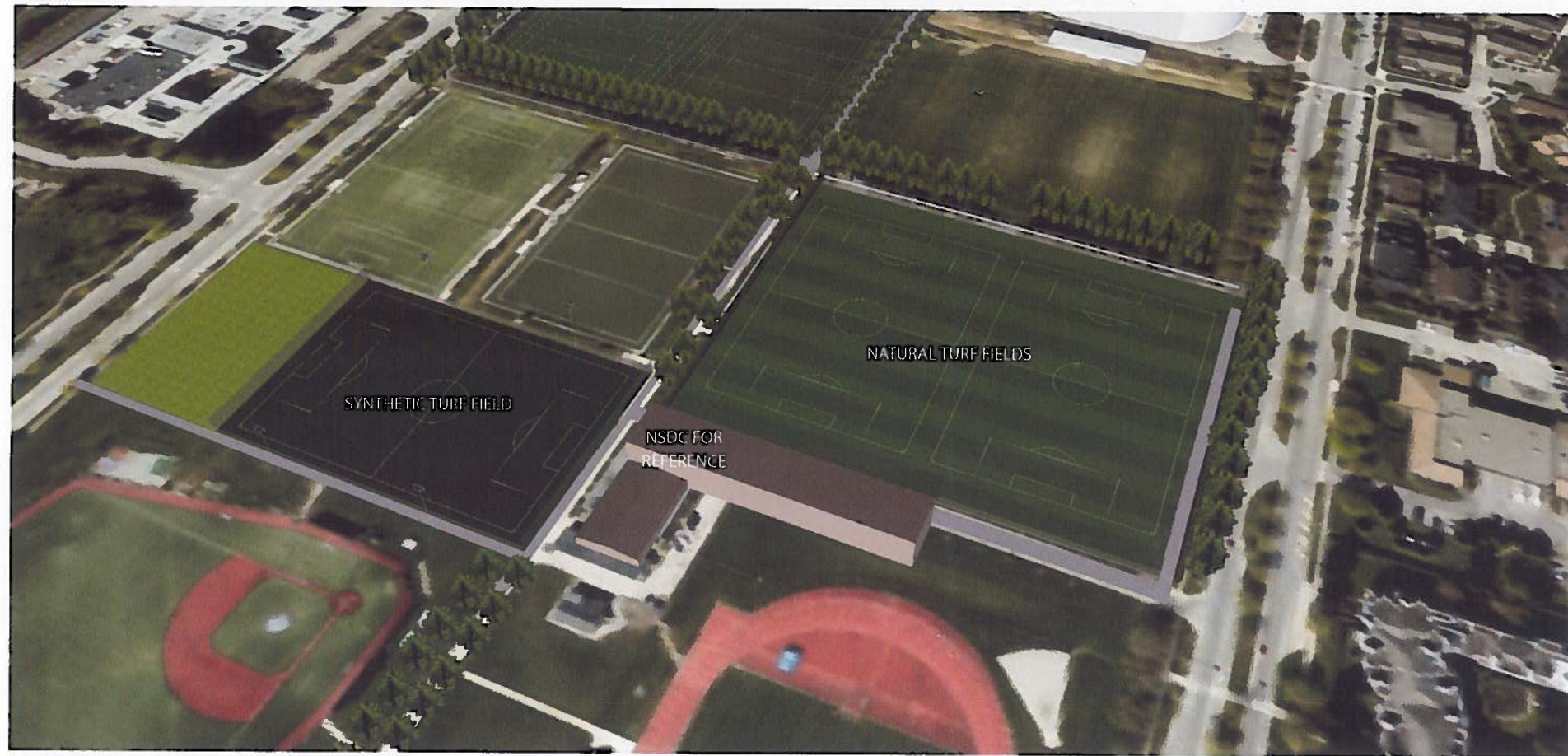

VIEW OF NATURAL AND SYNTHETIC TURF FIELDS FROM SOUTHEAST

Key Plan - N.T.S.



Legend



UBC PROPERTIES TRUST

No	Date	Revisions	By
1.	04.21.2016	Open House	JJ

This drawing, as an instrument of service, is granted by, used in the service of, and for the benefit of the University of British Columbia. It is the property of the University of British Columbia and shall remain the property of the University of British Columbia. It is not to be used for any other purpose without the written consent of the University of British Columbia. It is not to be used for any other purpose without the written consent of the University of British Columbia.



Designed By: North Arrow

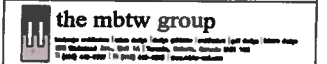

Project Name:
**NSDC
Natural & Synthetic Turf Fields**

Municipality: **University of British Columbia**

Sheet Title:
AERIAL VIEWS

Designed:	Drawn:	Scale:	Drawing No.:
Date of Drawing:	Job No.:		SK-1
	UPT 001		

© University of British Columbia, 2016. All rights reserved. This drawing is the property of the University of British Columbia and shall remain the property of the University of British Columbia.

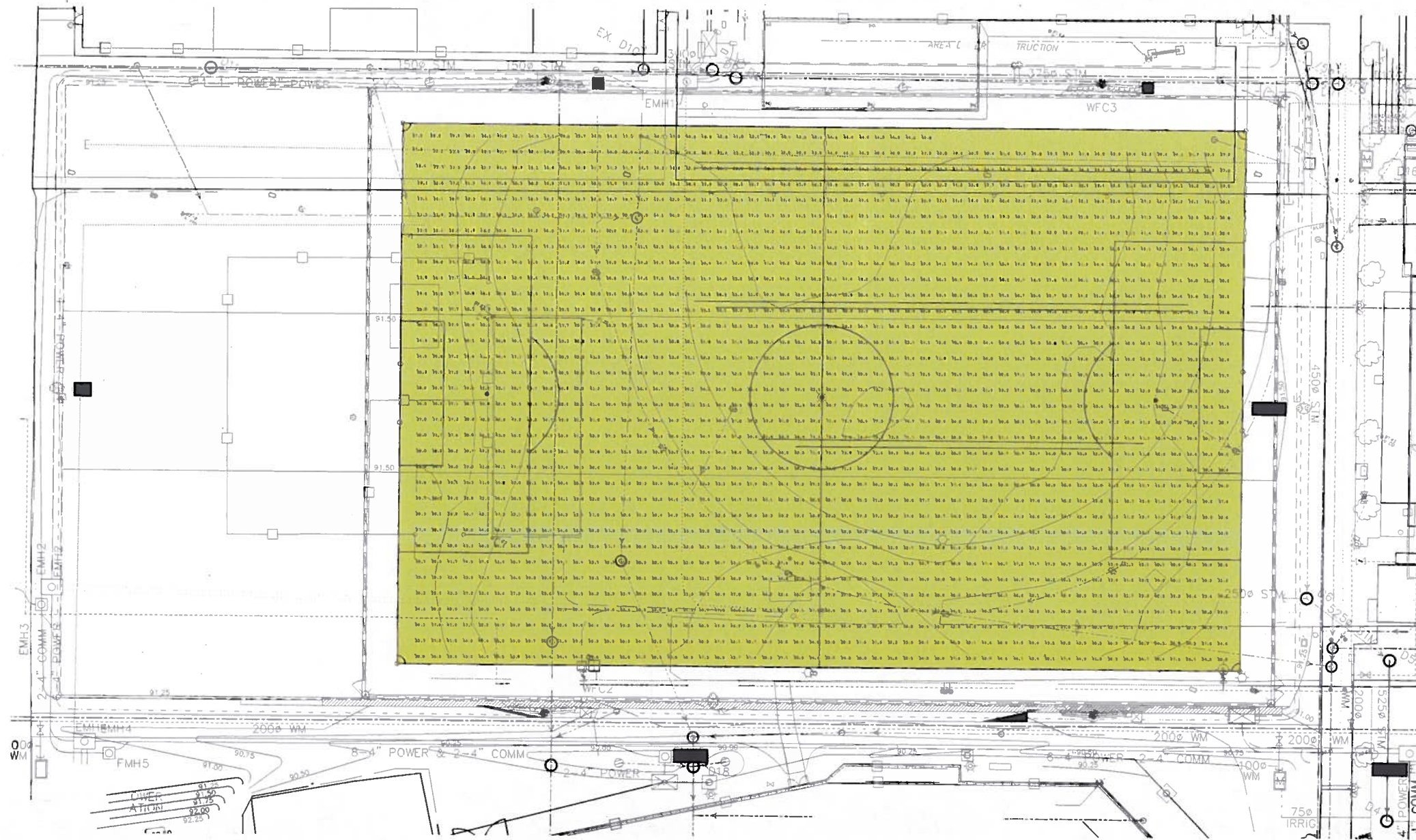

Legend



No	Date	Revisions	By
1.	04.21.2016	Open House	JL

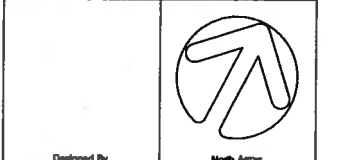

Designed By: **the mbtw group**

RICHARD FINDLAY
LANDSCAPE ARCHITECT INC.

Project Name:
NSDC
Natural & Synthetic Turf Fields

Municipality: **University of British Columbia**

Sheet Title:
**SPORTS FIELD LIGHTING
PHOTOMETRICS**

Drawn:	Scale:	Drawing No.:
Job No.:	UFT 001	E-1

EXAMPLES OF FIELDS WITH SIMILAR LIGHTING

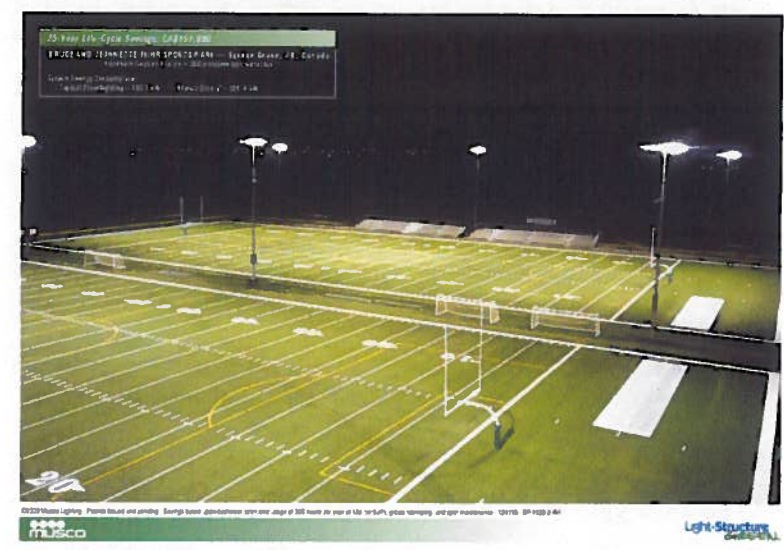

1 BRUCE AND JEANNETTE FURR SPORTS PARK - Rossmore, Ontario, Canada



2 LAYRITZ PARK SOCCER FIELD - Victoria, BC, Canada



3 THUNDERBOLT SPORTS PARK - UBC