







CLIENT:

**ACTON OSTRY ARCHITECTS INC**

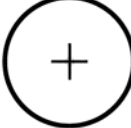
**GENERAL NOTES:**

1. ALL ELEVATIONS AND DISTANCES SHOWN ARE IN METRES.
2. TOPOGRAPHIC SURVEY BY MURRAY & ASSOCIATES, DATED: AUGUST 22, 2013. FILE NO. 8613EM-10

**LEGEND**

-  EXISTING TREES TO REMAIN AND TO BE PROTECTED
-  EXISTING SHRUBS TO REMAIN
-  EXISTING SHRUBS TO BE REMOVED
-  EXISTING GRADES REFER TO SURVEY
-  TREES & SHRUBS PROTECTION FENCE REFER TO DETAIL #1 BELOW
-  EXISTING CONC. PAVING TO BE REMOVED

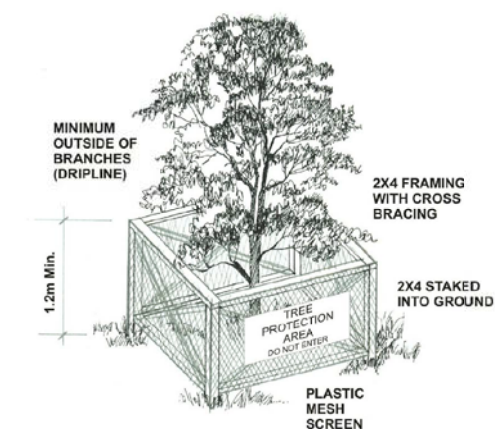
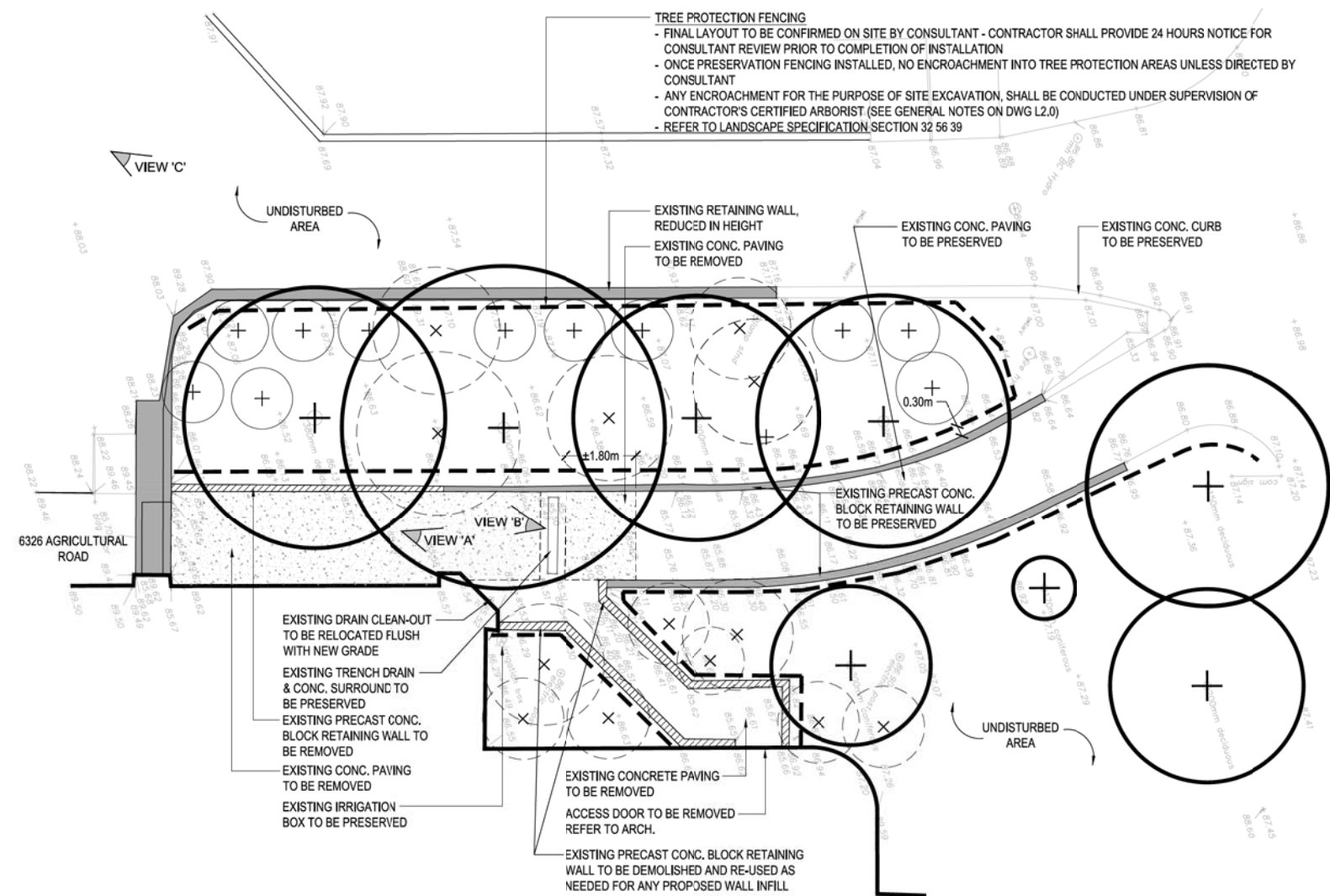

**NOTE:**  
WOOD FRAME CONSTRUCTION STAKED INTO THE GROUND IS REQUIRED.  
(METAL FRAMING DOES NOT MEET CITY STANDARDS)

TREE TRUNK DIAMETER		DISTANCE FROM TRUNK		TOTAL DIAMETER	
cm	Inches	m	feet	m	feet
20	8	0.6	1.2	2.60	8.5
25	10	0.8	1.5	3.25	10.7
30	12	1.0	1.8	3.90	12.8
35	14	1.2	2.1	4.55	14.9
40	16	1.3	2.4	5.20	17.1
45	18	1.5	2.7	5.85	19.2
50	20	1.7	3.0	6.50	21.3
55	22	1.8	3.3	7.15	23.5
60	24	2.0	3.6	7.80	25.6
75	26	2.5	4.5	9.75	32.0
90	32	3.0	5.0	11.40	37.4
100	36	3.3	6.0	13.00	42.7

**TREE PROTECTION TABLE**  
MINIMUM PROTECTION REQUIRED AROUND TREE



**VIEW 'A'**

EXISTING PRECAST CONC. BLOCK RETAINING WALL TO BE REMOVED

EXISTING CONC. PAVING TO BE REMOVED & REPLACED

EXISTING RETAINING WALL IS DAMAGED AND LEANING FORWARD.

\*NOTE: DAMAGED WALL NEEDS TO BE REPAIRED AS PER MANUFACTURER'S RECOMMENDATION



**VIEW 'B'**

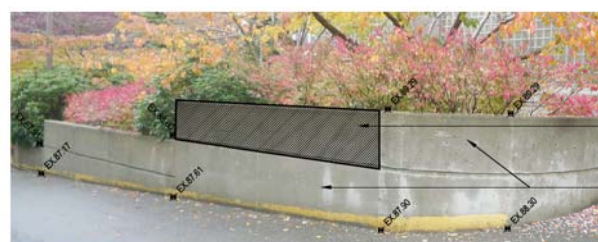

**VIEW 'C'**

**2 SITE PHOTOS**  
SCALE: N.T.S.

**1 TREE PROTECTION FENCE**  
SCALE: N.T.S.

COPYRIGHT RESERVED:  
This plan and design are, and at all times remain the exclusive property of PFS Studio and cannot be reproduced without written consent. Contractors shall verify and be responsible for all dimensions and conditions on the job. This office shall be informed of any discrepancies from the dimensions and conditions shown on the drawing.

ISSUANCE:

No.	Date	Details	By
1	NOV. 18, 2013	ISSUED FOR REVIEW	CM
2	NOV. 20, 2013	ISSUED FOR DEMOLITION TENDER (DWG L1.0 ONLY)	CM
3	NOV. 22, 2013	ISSUED FOR TENDER COORDINATION	CM
4	NOV. 27, 2013	ISSUED FOR TENDER / BP	CM

**PFS STUDIO** 1777 West 4<sup>th</sup> Avenue  
Vancouver BC V6J 1K7  
604-738-5158  
pfs@pfs.bc.ca  
www.pfs.bc.ca

PLANNING • URBAN DESIGN • LANDSCAPE ARCHITECTURE

STAMP:

PROJECT NAME:  
**UBC - SAUDER SCHOOL OF BUSINESS LEARNING LABS**

DRAWING TITLE:  
**TREE PROTECTION AND DEMOLITION PLAN**

PFS PROJECT NUMBER: 13030  
DRAWN BY: AF / CM

SCALE: 1:75  
CHECKED BY: CM

DWG. NO.:  
DATE: NOV. 15, 2013

**L1.0**

CLIENT:

**ACTON OSTRY**  
ARCHITECTS INC

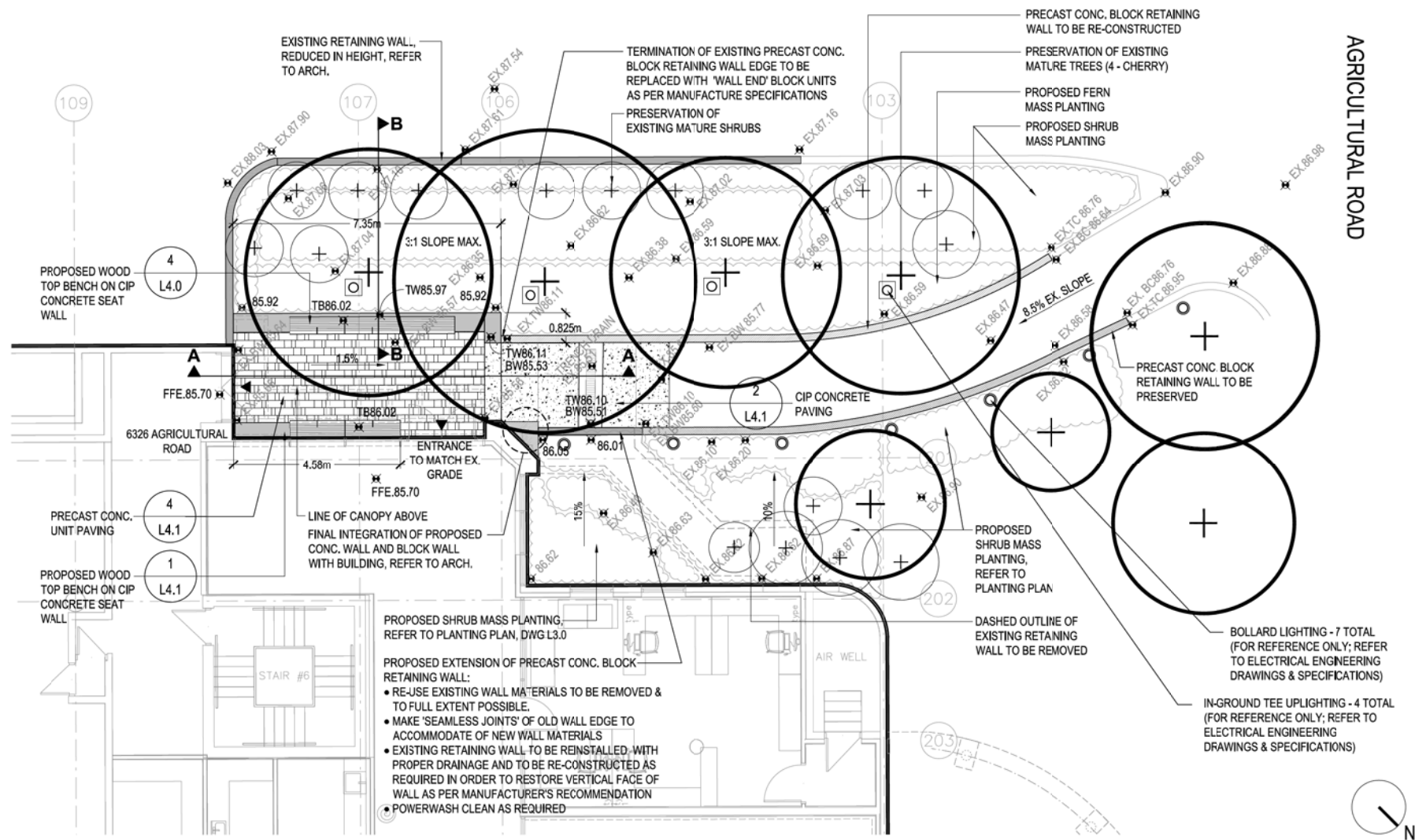

**GENERAL NOTES:**

1. ALL ELEVATIONS AND DISTANCES SHOWN ARE IN METRES.
2. DO NOT SCALE DRAWINGS. LAYOUT AS PER DIMENSIONS NOTED ON LANDSCAPE PLANS. REPORT ANY DISCREPANCIES TO THE CONSULTANT FOR REVIEW AND RESPONSE.
3. LAYOUT AND MATERIALS DRAWINGS ARE TO BE READ IN CONJUNCTION WITH LANDSCAPE SPECIFICATIONS FOR COMPLIANCE.
4. LANDSCAPE DRAWINGS ARE TO BE READ IN CONJUNCTION WITH ARCHITECTURAL AND ENGINEERING DRAWINGS. REPORT ANY DISCREPANCIES TO THE CONSULTANT FOR REVIEW AND RESPONSE.
5. VERIFY ALL DIMENSIONS WITH FIELD CONDITIONS. REPORT ANY DISCREPANCIES TO THE CONSULTANT FOR REVIEW AND RESPONSE.
6. ADDITIONAL GRADING INFORMATION INTERPOLATED FROM ENGINEERING DRAWINGS. CONTRACTOR TO VERIFY ALL EXISTING CONDITIONS AND GRADES ON SITE PRIOR TO CONSTRUCTION.
7. ALL EXCAVATION NEAR ANY ROOT SYSTEMS OF EXISTING TREES SHALL BE CONDUCTED UNDER SUPERVISION AND DIRECTION BY CONTRACTOR'S CERTIFIED ARBORIST. ALL NECESSARY BRANCH OR ROOT PRUNING OF EXISTING TREES REQUIRED TO EXECUTE SHALL BE CONDUCTED BY CONTRACTOR'S CERTIFIED ARBORIST. (REFER TO LANDSCAPE SPECIFICATION SECTION 32 56 39)

**LEGEND**

- EXISTING TREES TO REMAIN AND TO BE PROTECTED
- PROPOSED SHRUBS REFER TO PLANTING PLAN
- EXISTING SHRUBS TO REMAIN
- EXISTING GRADES REFER TO SURVEY
- PROPOSED GRADES BY PFS
- DIRECTION AND VALUE OF SLOPE
- CAST-IN-PLACE
- EXISTING
- TOP OF WALL
- BOTTOM OF WALL
- TOP OF BENCH
- BOLLARD LIGHTING (FOR REFERENCE ONLY; REFER TO ELECTRICAL ENGINEERING DRAWINGS & SPECIFICATIONS)
- IN-GROUND TEE UPLIGHTING (FOR REFERENCE ONLY; REFER TO ELECTRICAL ENGINEERING DRAWINGS & SPECIFICATIONS)

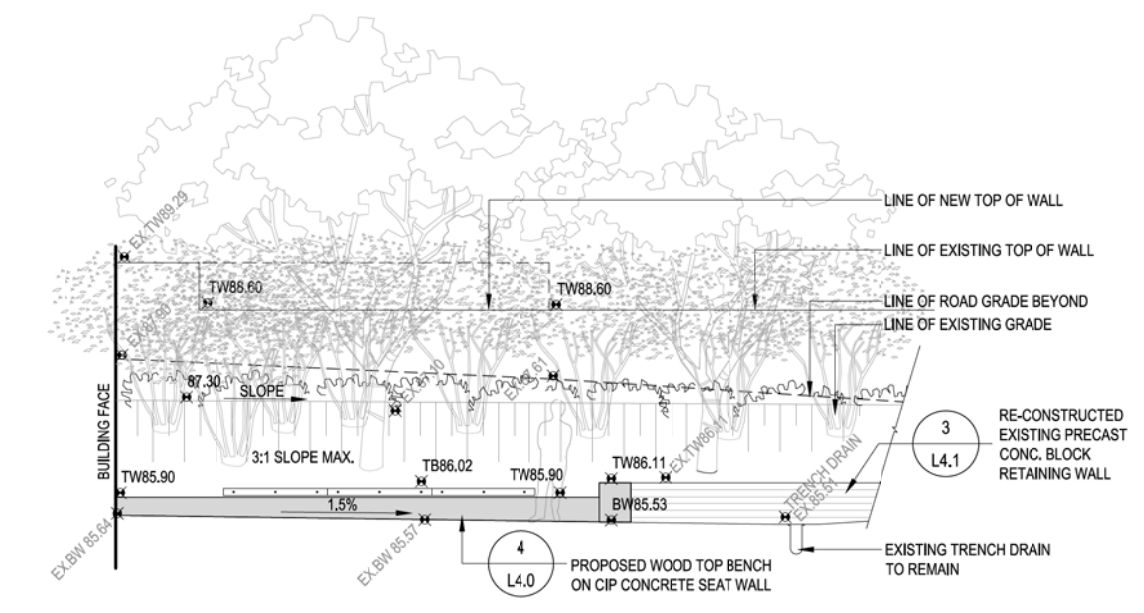

**1 SECTION 'A'**  
SCALE: 1:50

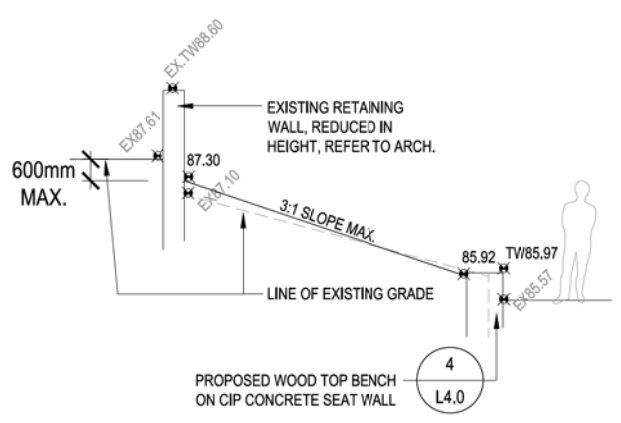

**2 SECTION 'B'**  
SCALE: 1:50

COPYRIGHT RESERVED:  
This plan and design are, and at all times remain the exclusive property of PFS Studio and cannot be used or reproduced without written consent. Contractors shall verify and be responsible for all dimensions and conditions on the job. This office shall be informed of any discrepancies from the dimensions and conditions shown on the drawing.

ISSUANCE:

No.	Date	Details	By
1	NOV. 18, 2013	ISSUED FOR REVIEW	CM
2	NOV. 20, 2013	ISSUED FOR DEMOLITION TENDER (DWG L1.0 ONLY)	CM
3	NOV. 22, 2013	ISSUED FOR TENDER COORDINATION	CM
4	NOV. 27, 2013	ISSUED FOR TENDER / BP	CM

**PFS STUDIO**  
PLANNING - URBAN DESIGN - LANDSCAPE ARCHITECTURE  
1777 West 4<sup>th</sup> Avenue  
Vancouver BC V6L 1K7  
604.736.0188  
pfs@pfs.bc.ca  
www.pfs.bc.ca

STAMP:

PROJECT NAME:  
**UBC - SAUDER SCHOOL OF BUSINESS LEARNING LABS**

DRAWING TITLE:  
**LANDSCAPE MATERIAL LAYOUT & GRADING PLAN**

PFS PROJECT NUMBER: 13030  
SCALE: 1:75  
DWG. NO.: L2.0

DRAWN BY: AF / CM  
CHECKED BY: CM  
DATE: NOV. 15, 2013

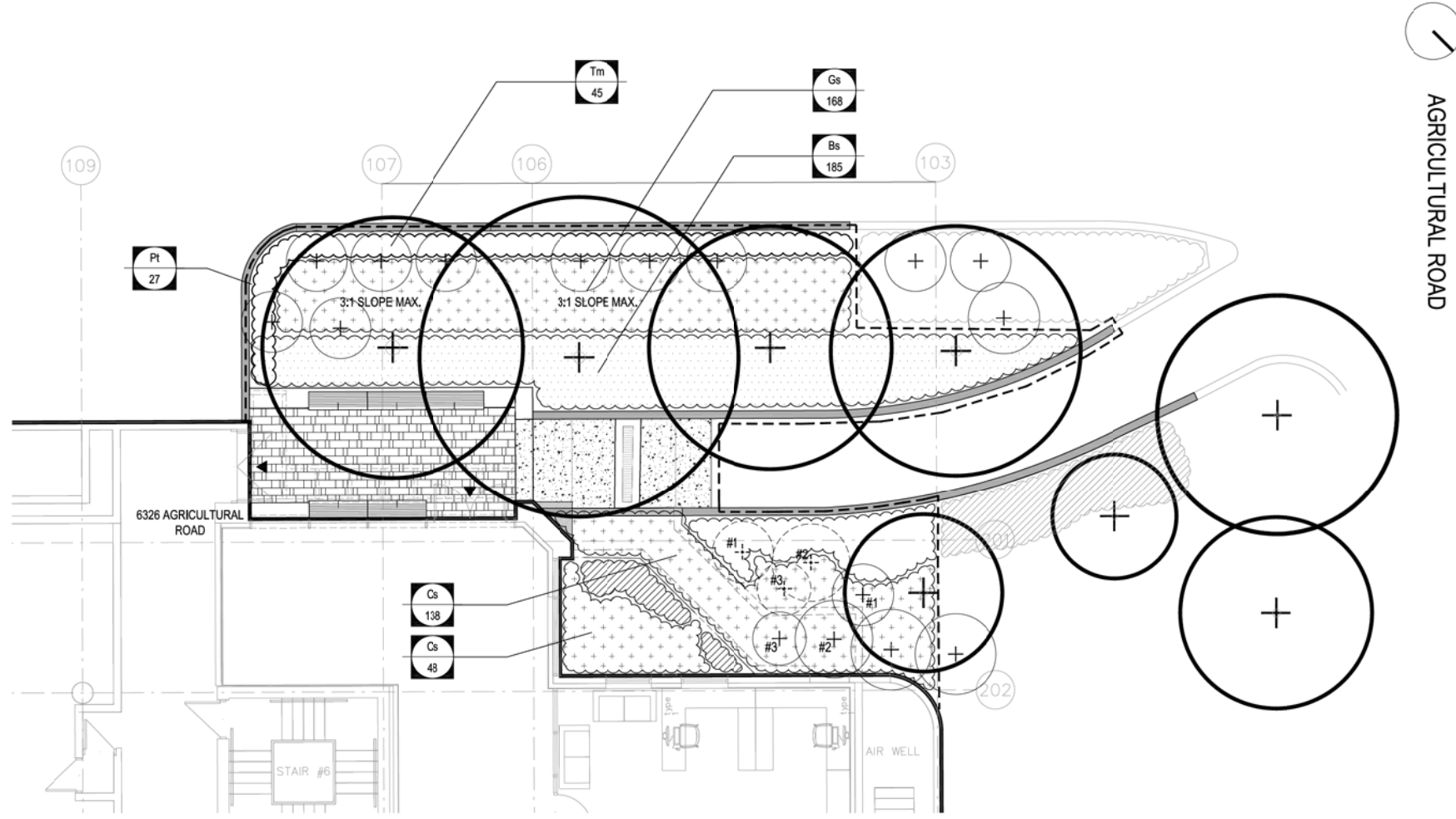



GENERAL NOTES:

1. ALL ELEVATIONS AND DISTANCES SHOWN ARE IN METRES.
2. DO NOT SCALE DRAWINGS. LAYOUT AS PER DIMENSIONS NOTED ON LANDSCAPE PLANS. REPORT ANY DISCREPANCIES TO THE CONSULTANT FOR REVIEW AND RESPONSE.
3. LAYOUT AND MATERIALS DRAWINGS ARE TO BE READ IN CONJUNCTION WITH LANDSCAPE SPECIFICATIONS FOR COMPLIANCE.
4. LANDSCAPE DRAWINGS ARE TO BE READ IN CONJUNCTION WITH ARCHITECTURAL AND ENGINEERING DRAWINGS. REPORT ANY DISCREPANCIES TO THE CONSULTANT FOR REVIEW AND RESPONSE.
5. VERIFY ALL DIMENSIONS WITH FIELD CONDITIONS. REPORT ANY DISCREPANCIES TO THE CONSULTANT FOR REVIEW AND RESPONSE.
6. ADDITIONAL GRADING INFORMATION INTERPOLATED FROM ENGINEERING DRAWINGS. CONTRACTOR TO VERIFY ALL EXISTING CONDITIONS AND GRADES ON SITE PRIOR TO CONSTRUCTION.

LEGEND

--- LIMIT OF WORK

 EXISTING TREES TO REMAIN AND TO BE PROTECTED

  EXISTING SHRUBS TO REMAIN AND TO BE PROTECTED

 EXISTING SHRUBS TO BE RE-LOCATED

 LOCATION OF RE-LOCATED TREES

 EXISTING SHRUB MASSES TO BE GROOMED, REPAIRED AND PRESERVED (ESTIMATED ONLY, TO BE VERIFIED ON SITE)

 PROPOSED SHRUB MASSES

 EXISTING GRADES REFER TO SURVEY

 PROPOSED GRADES BY PFS

 DIRECTION AND VALUE OF SLOPE

 CAST-IN-PLACE

 EXISTING

 TOP OF WALL

 BOTTOM OF WALL

 TOP OF BENCH

PLANT SCHEDULE

Key	Quantity	Botanical Name / Common Name	Description
<b>Hedges</b>			
Tm	45	Taxus media hicksii 'H. M. Eddie' / Yew (no berries)	1.2m Ht., Full, 45cm o.c.
<b>Shrubs</b>			
Gs	168	Gaultheria shallon / Salal	#3 Pot, 40cm o.c.
<b>Ferns</b>			
Bs	185	Blechnum spicant / Deer Fern	#3 Pot, 45cm o.c.
<b>Groundcover</b>			
Cs	186	Cotoneaster salicifolius 'Repen' / Willowleaf Cotoneaster	#3 Pot, 40cm o.c.
<b>Climbing Vines</b>			
Pt	27	Parthenocissus tricuspidata / Boston Ivy	#3 Pot, 75cm o.c.

IRRIGATION NOTES:

1. ALL COMPONENTS OF EXISTING IRRIGATION SHALL BE PRESERVED AND PROTECTED FROM DAMAGE DURING ALL LANDSCAPE INSTALLATION WORK.
2. CONTRACTOR SHALL SURVEY AND VERIFY FULL EXTENT OF ALL COMPONENTS EXISTING IRRIGATION SYSTEM, THAT IS IN-PLACE ON SITE, PRIOR TO COMMENCEMENT OF ANY LANDSCAPE CONSTRUCTION AND/OR INSTALLATION.
3. CONTRACTOR SHALL MAKE GOOD ANY DAMAGE MADE COMPONENTS OF EXISTING IRRIGATION SYSTEM LANDSCAPE CONSTRUCTION/INSTALLATION, AT NO EXPENSE TO OWNER.
4. CONTRACTOR SHALL PROVIDE AS-BUILT DRAWING OF ALL SURVEYED IRRIGATION SYSTEM VERIFYING LOCATION OF ALL IRRIGATION COMPONENTS RELATIVE TO SURVEY OF EXISTING SITE ELEMENTS.
5. CONTRACTOR SHALL PROPOSE ALL REQUIRED ADDITIONS TO EXISTING IRRIGATION SYSTEM NECESSARY TO OBTAIN FULL IRRIGATION COVERAGE OF ALL LANDSCAPE WORK AS DEFINED WITHIN LIMIT OF WORK BOUNDARY, AND PROVIDE A DESIGN-BUILD DRAWING IDENTIFYING BOTH EXISTING AND PROPOSED ADDITIONAL IRRIGATION SYSTEM COMPONENTS FOR TENDER.

PLANTING NOTES:

1. CONTRACTOR SHALL VERIFY ALL EXISTING SITE CONDITIONS AND REPORT ALL DISCREPANCIES BETWEEN DRAWINGS AND SITE TO CONSULTANT, PRIOR TO QUANTIFYING AND TENDERING SCOPE OF WORK.
2. CONTRACTOR SHALL PRUNE CANOPIES OF EXISTING TREES TO BE PRESERVED, TO 'LIGHTEN' CANOPY DENSITY, IN AN EFFORT TO ALLOW MORE LIGHT INTO UNDERSTORY AND PAVED AREAS. ALL PRUNING BY CONTRACTOR SHALL BE PERFORMED BY CERTIFIED ARBORIST IN ACCORDANCE WITH PROJECT SPECIFICATIONS AND UNDER DIRECTION OF PROJECT LANDSCAPE ARCHITECT.
3. ALL RELOCATION OF EXISTING PLANT MATERIAL INCLUDING MATURE SHRUBS AND GROUNDCOVER SHALL BE PERFORMED IN ACCORDANCE WITH PROJECT SPECIFICATIONS AND UNDER DIRECTION OF PROJECT LANDSCAPE ARCHITECT.
4. EXISTING GROUNDCOVER PLANTINGS OF COTONEASTER SOLICIFOLIUS, SHALL BE 'GROOMED' AND 'INTER-PLANTED' AS NECESSARY TO RE-ESTABLISH A CONTINUOUS GROUNDCOVER. CONTRACTOR SHALL VERIFY EXTENT OF EXISTING GROUNDCOVER ON SITE, AND QUANTIFY NECESSARY INTER-PLANTING FOR TENDER.
5. PROPOSED SLOPE OF SHRUB MASS PLANTING, AREAS, AS SHOWN, SHALL BE STABILIZED THROUGH INSTALLATION OF GEO-TEXTILE, 70% STRAW + 30% COCONUT FIBER BLANKET, AS SPECIFIED. PROPOSED SHRUB MASS PLANTING SHALL BE INSTALLED 'THROUGH' CONTINUOUS GEO-TEXTILE COVERAGE, IN ACCORDANCE WITH MANUFACTURES SPECIFICATIONS.
6. REFER TO PROJECT SPECIFICATIONS.

**COPYRIGHT RESERVED:**  
This plan and design are, and at all times remain the exclusive property of PFS Studio and cannot be used or reproduced without written consent. Contractors shall verify and be responsible for all dimensions and conditions on the job. This office shall be informed of any discrepancies from the dimensions and conditions shown on the drawing.

**ISSUANCE:**

No.	Date	Details	By
1	NOV. 18, 2013	ISSUED FOR REVIEW	CM
2	NOV. 20, 2013	ISSUED FOR DEMOLITION TENDER (DWG L1-D ONLY)	CM
3	NOV. 22, 2013	ISSUED FOR TENDER COORDINATION	CM
4	NOV. 27, 2013	ISSUED FOR TENDER / BP	CM

STAMP:

PROJECT NAME:  
**UBC - SAUDER SCHOOL OF BUSINESS LEARNING LABS**

DRAWING TITLE:  
**LANDSCAPE PLANTING & IRRIGATION PLAN**

PFS PROJECT NUMBER: 13030  
DRAWN BY: AF / CM

SCALE: 1:75  
CHECKED BY: CM

DWG. NO.:  
**L3.0**

DATE: NOV. 15, 2013

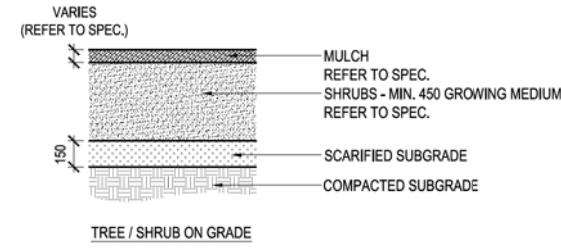
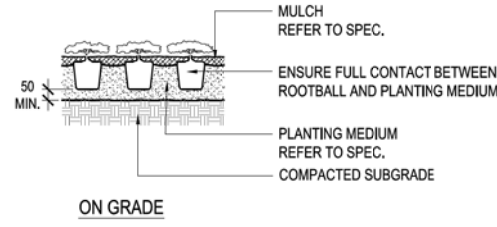
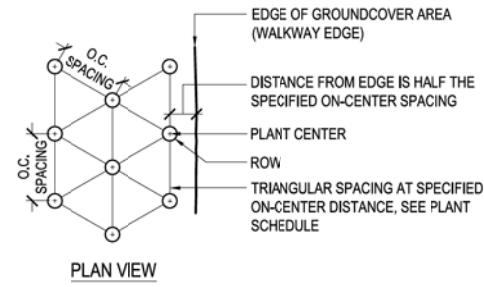
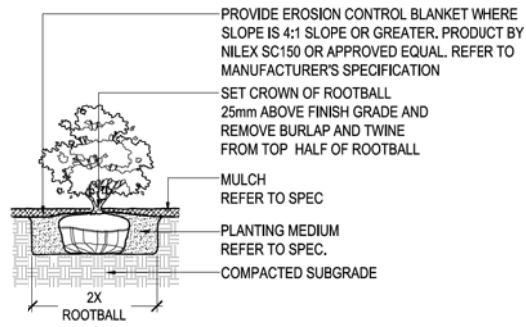

**1 SHRUB PLANTING**  
SCALE: 1:20

**2 GROUNDCOVER PLANTING**  
SCALE: 1:20

**3 SOIL PROFILES**  
SCALE: 1:20

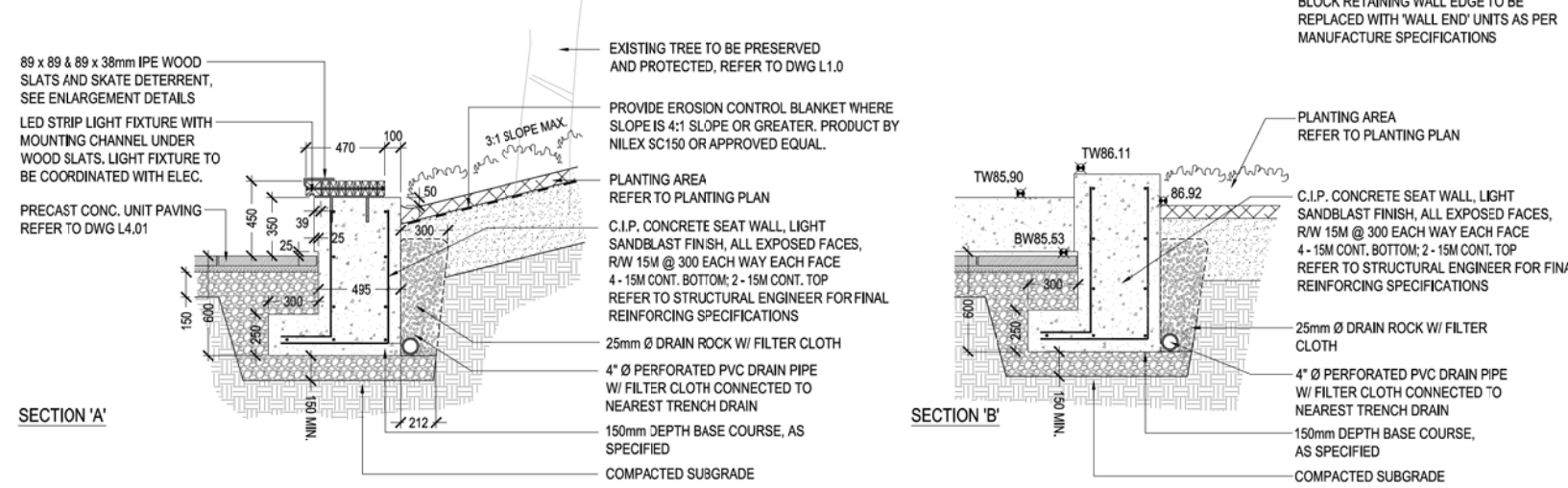
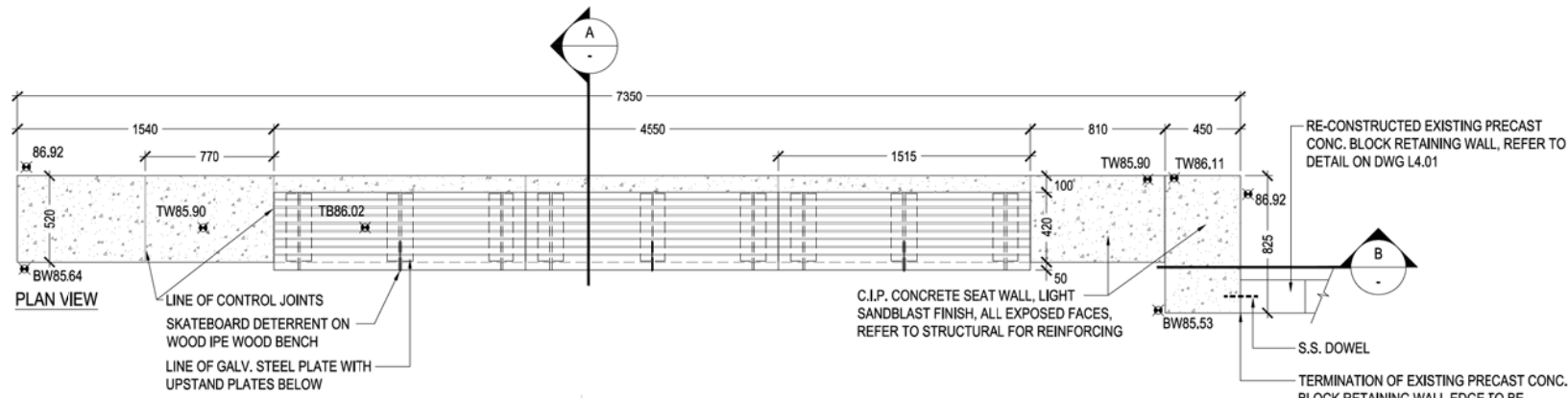

- NOTES:**
1. PROVIDE ENGINEERED SHOP DRAWINGS FOR ALL BENCH ASSEMBLIES.
  2. ALL WOOD TO BE IPE, REFER TO LANDSCAPE SPECS FOR WOOD MATERIAL AND FINISHES.
  3. ALL STEEL TO BE GALVANIZED UNLESS OTHERWISE INDICATED.
  4. REFER TO STRUCTURAL FOR REINFORCEMENT DETAILS AND FOOTINGS.
  5. REFER TO STRUCTURAL FOR WELDING SCHEDULE & CONNECTION MATERIAL SPECIFICATION.
  6. REFER TO LAYOUT PLANS FOR BENCH LOCATIONS.
  7. PROVIDE ENGINEERED SHOP DRAWINGS FOR BENCH SLATTING & ASSEMBLIES PRIOR TO CONSTRUCTION.

**4 WOOD TOP BENCH ON CIP CONCRETE SEAT WALL - TYPE 1**  
SCALE: 1:20

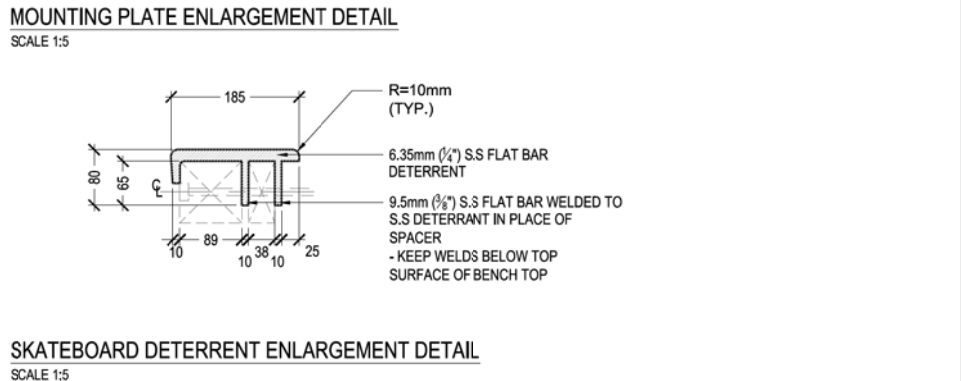
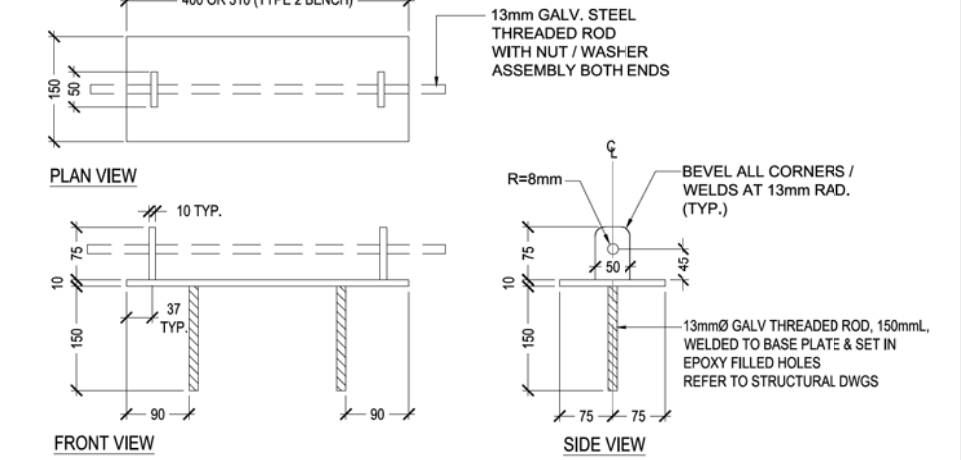
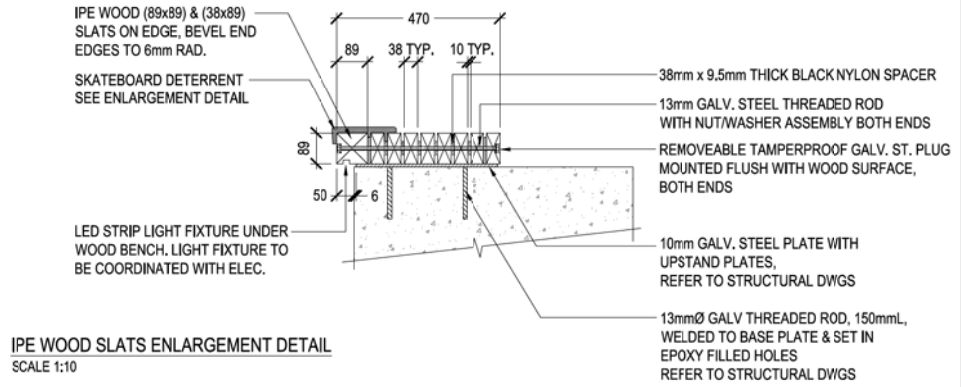

COPYRIGHT RESERVED:  
This plan and design are, and at all times remain the exclusive property of PFS Studio and cannot be used or reproduced without written consent. Contractors shall verify and be responsible for all dimensions and conditions on the job. This office shall be informed of any discrepancies from the dimensions and conditions shown on the drawing.

ISSUANCE:

No.	Date	Details	By
1	NOV. 18, 2013	ISSUED FOR REVIEW	CM
2	NOV. 20, 2013	ISSUED FOR DEMOLITION TENDER (DWG L1.0 ONLY)	CM
3	NOV. 22, 2013	ISSUED FOR TENDER COORDINATION	CM
4	NOV. 27, 2013	ISSUED FOR TENDER / BP	CM

STAMP:

PROJECT NAME:  
**UBC - SAUDER SCHOOL OF BUSINESS LEARNING LABS**

DRAWING TITLE:  
**LANDSCAPE DETAILS**

PFS PROJECT NUMBER: 13030  
DRAWN BY: AF / CM

SCALE: 1:75  
CHECKED BY: CM

DWG. NO.:  
**L4.0**  
DATE: NOV. 15, 2013

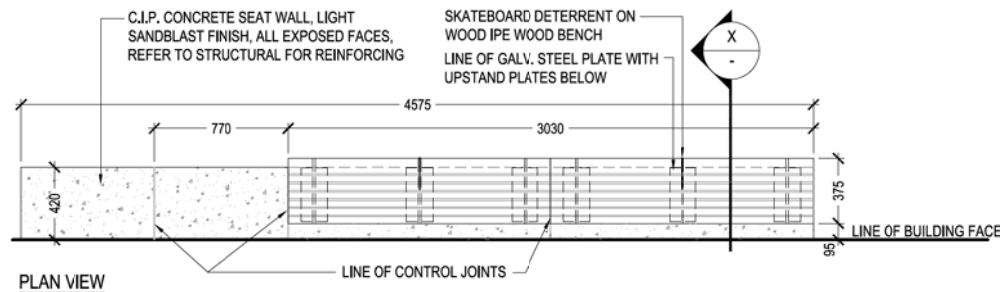

NOTES:

1. PROVIDE ENGINEERED SHOP DRAWINGS FOR ALL BENCH ASSEMBLIES.
2. ALL WOOD TO BE IPE, REFER TO LANDSCAPE SPECS FOR WOOD MATERIAL AND FINISHES.
3. ALL STEEL TO BE GALVANIZED UNLESS OTHERWISE INDICATED.
4. REFER TO STRUCTURAL FOR REINFORCEMENT DETAILS AND FOOTINGS.
5. REFER TO STRUCTURAL FOR WELDING SCHEDULE & CONNECTION MATERIAL SPECIFICATION.
6. REFER TO LAYOUT PLANS FOR BENCH LOCATIONS.
7. PROVIDE ENGINEERED SHOP DRAWINGS FOR BENCH SLATTING & ASSEMBLIES PRIOR TO CONSTRUCTION.

1 WOOD TOP BENCH ON CIP CONCRETE SEAT WALL - TYPE 2

SCALE: 1:20

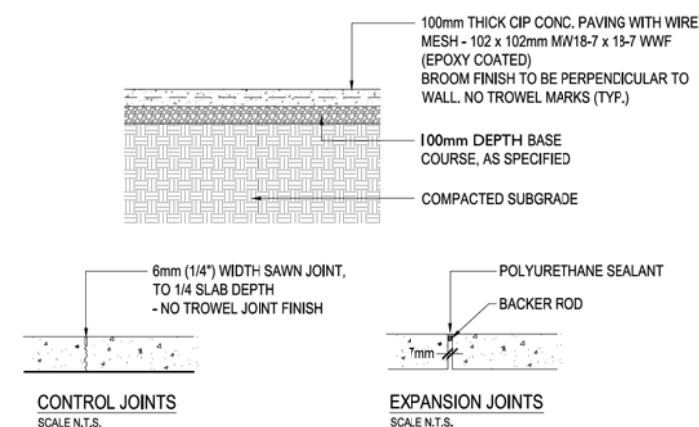
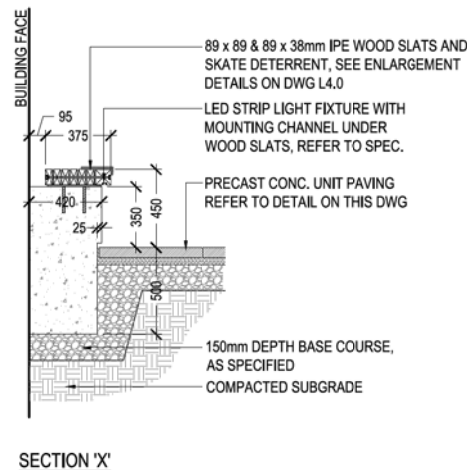

NOTES:

1. 12.5mm (1/2") CONTROL JOINTS TO BE LOCATED AT 6.0m INTERVALS OR INDICATED ON PLAN
2. EXPANSION JOINTS TO BE LOCATED AT 6.0m INTERVALS, AND WHERE CONCRETE PAVING ABUTS OTHER STRUCTURES OR BUILDINGS
3. CUT JOINTS BEFORE RANDOM CRACKING OCCURS

2 CIP CONCRETE PAVING

SCALE: 1:20

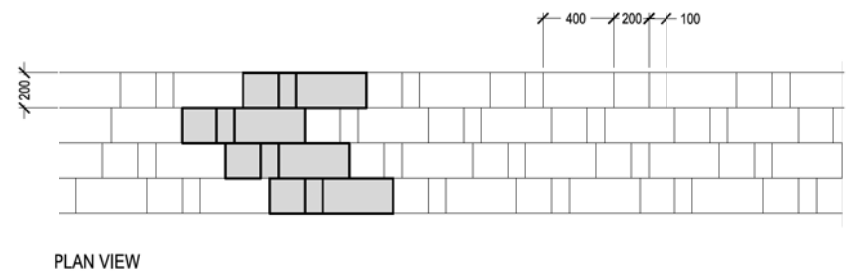

PLAN VIEW

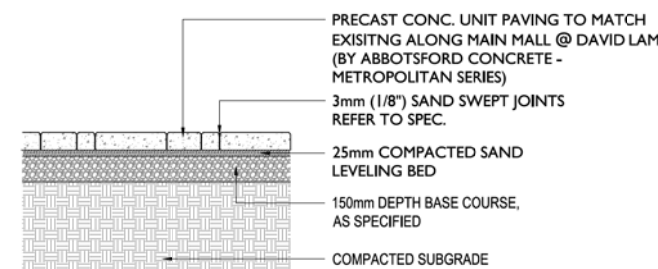

NOTES:

1. END PAVING UNIT SHALL BE NO SMALLER THAN 200 x 200mm (8"x8")
2. END PAVING SHALL NOT BE A SOLIDER COURSE
3. REFER TO UNIT PAVING SPECIFICATIONS FOR ADDITIONAL INSTALLATION NOTES AND TOLERANCES.

4 PRECAST CONC. UNIT PAVING

SCALE: 1:20

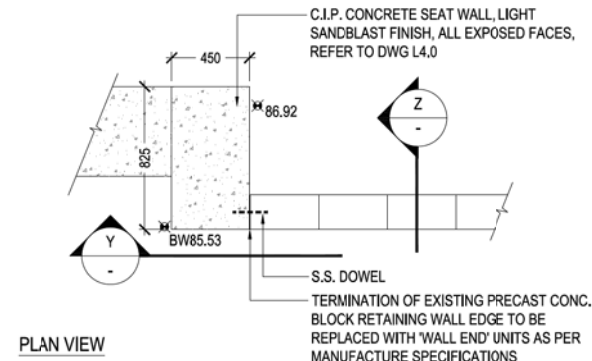

PLAN VIEW

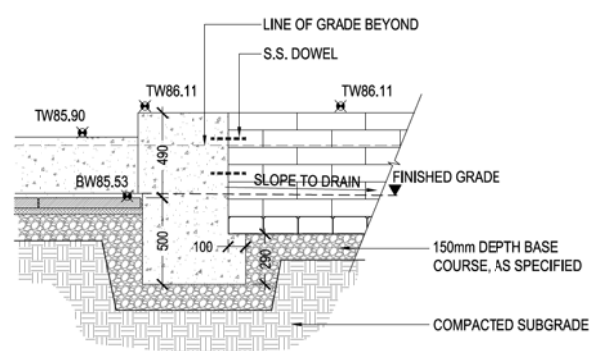

SECTION 'Y'

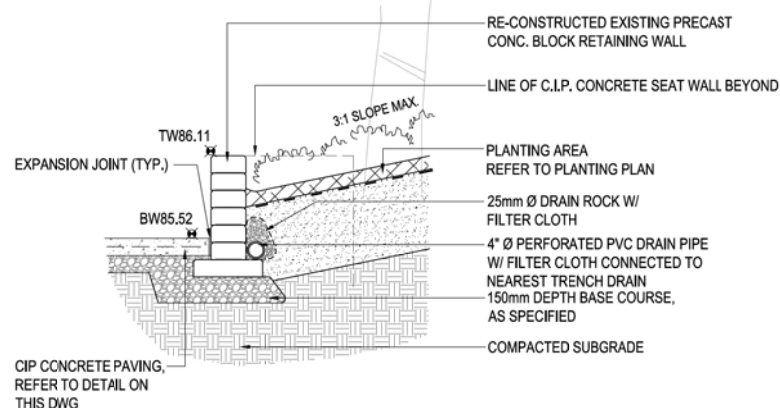

SECTION 'Z'

3 RE-CONSTRUCTED EXISTING PRECAST CONC. BLOCK RETAINING WALL

SCALE: 1:20

COPYRIGHT RESERVED:

This plan and design are, and at all times remain the exclusive property of PFS Studio and cannot be used or reproduced without written consent. Contractors shall verify and be responsible for all dimensions and conditions on the job. This office shall be informed of any discrepancies from the dimensions and conditions shown on the drawing.

ISSUANCE:

No.	Date	Details	By
1	NOV. 16, 2013	ISSUED FOR REVIEW	CM
2	NOV. 20, 2013	ISSUED FOR DEMOLITION TENDER (DWG L1,0 ONLY)	CM
3	NOV. 22, 2013	ISSUED FOR TENDER COORDINATION	CM
4	NOV. 27, 2013	ISSUED FOR TENDER / BP	CM



STAMP:

PROJECT NAME:  
**UBC - SAUDER SCHOOL OF BUSINESS LEARNING LABS**

DRAWING TITLE:  
**LANDSCAPE DETAILS**

PFS PROJECT NUMBER: 13030  
 DRAWN BY: AF / CM

SCALE: 1:75  
 CHECKED BY: CM

DWG. NO.:  
 DATE: NOV. 15, 2013

L4.1