

**MacInnes Field  
 Public Realm  
 UNIVERSITY  
 BOULEVARD, UBC**

**Context Plan**

DATE	2/28/2018
DRAWN BY	MT
CHECKED BY	RD
SCALE	As Indicated
JOB NUMBER	PFS-117074

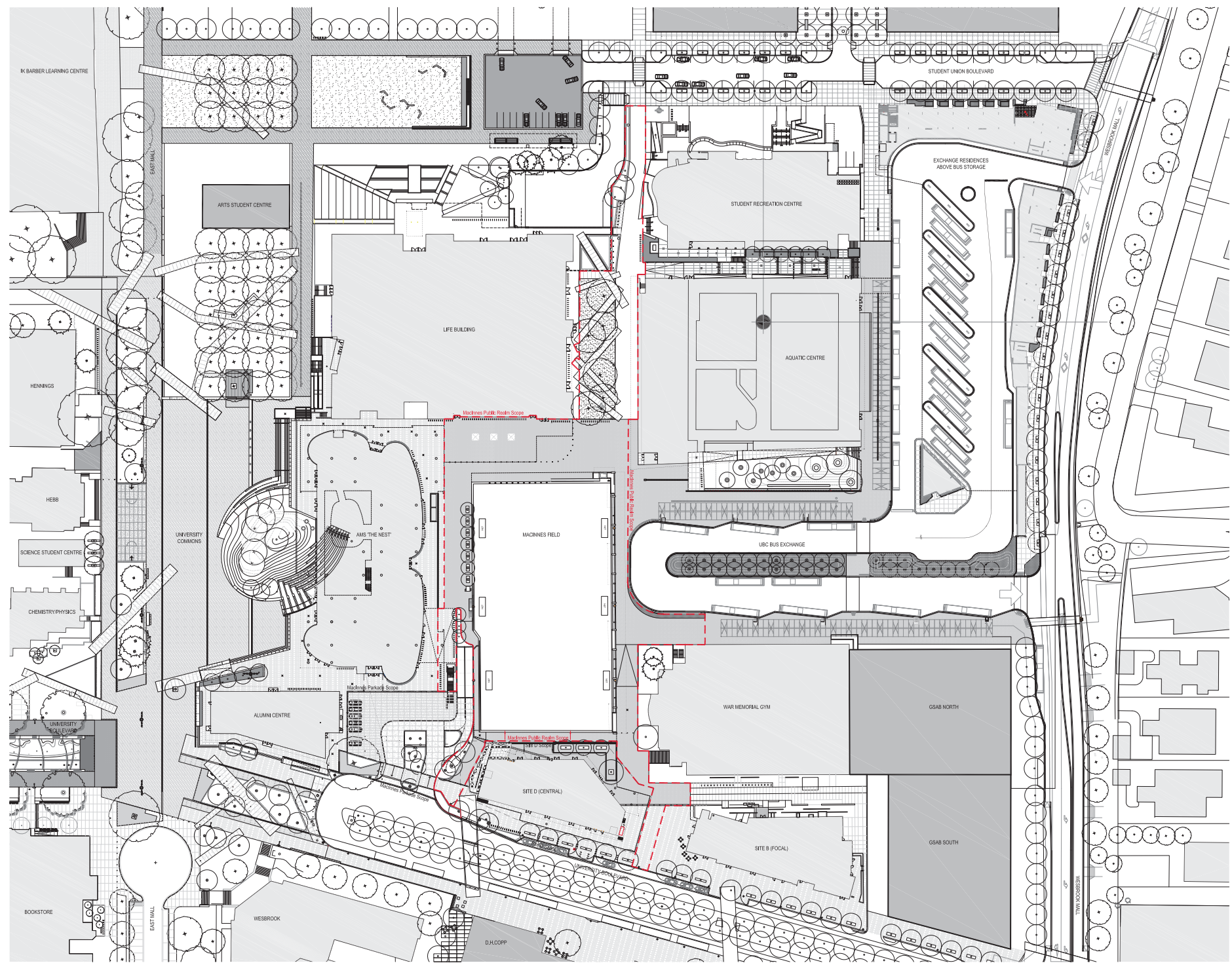

MATCH L101  
MATCH L102

THE NEST

MACINNES FIELD

UBC BUS EXCHANGE

WAR MEMORIAL GYM

SITE D

SITE B

UNIVERSITY BOULEVARD

**TREE PROTECTION NOTES**

1. NO STORAGE OF BUILDING/CONSTRUCTION MATERIALS WITHIN PROTECTED AREAS OR AGAINST PROTECTION BARRIER.
2. ANY PRUNING OF BRANCHES OR ROOTS MUST BE DONE BY THE PROJECT ARBORIST.
3. CONTRACTOR TO UNDERTAKE TREE PROTECTION MEASURES TO UNIVERSITY OF BRITISH COLUMBIA STANDARDS.
4. HAND EXCAVATE ONLY WITHIN DRILLPIPE OF TREES TO BE RETAINED. SEVER ROOTS CLEANLY. CONTACT PROJECT ARBORIST FOR APPROVAL PRIOR TO SEVERING ROOTS IN EXCESS OF 100mm DIA.
5. TREE PROTECTION FENCES NOT TO BE LIFTED OR REMOVED AT ANY TIME FOR VEHICULAR ACCESS. VEHICLES AND HEAVY EQUIPMENT CAN CAUSE SOIL COMPACTION IN THE ROOT ZONE DEPLETING THE AIR SPACE THAT IS ESSENTIAL TO THE TREE'S HEALTH.
6. LOCATION OF TREE PROTECTION FENCING AND LIMIT OF ACCESS FENCING TO BE VERIFIED WITH CONSULTANT AND PROJECT ARBORIST PRIOR TO INSTALLATION.
7. BASED ON CONTRACTOR'S STAGING AND ACCESS REQUIREMENTS, FINAL TREE PROTECTION LOCATION TIED ON SITE. ADDITIONAL TREE PROTECTION FENCING MAY BE REQUIRED.
8. PER CAMPUS ARBORIST RECOMMENDATION, INSTALL 6' HIGH METAL FENCE ALONG WEST CURB LINE OF ATHLETE'S WAY AS PRIMARY PROTECTION MEASURE FOR EXISTING TREES (SEE PLAN).

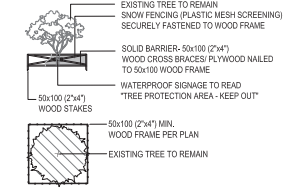

**1 TREE PROTECTION FENCE (TYP)**  
SCALE: 1:100

**SITE DEMOLITION NOTES**

1. PLAN BASED ON SURVEY CONDUCTED BY MURRAY & ASSOCIATES, SURREY, BC AND SUPPLIED BY UBC.
2. ALL EXISTING HARDSCAPE AND SOFTSCAPE WITHIN PROJECT BOUNDARY TO BE DEMOLISHED EXCEPT FOR UNIVERSITY BOULEVARD PAVERS ALONG EAST SIDE OF AHS BUILDING AND EAST SIDE OF SITE D. PAVERS IN GOOD CONDITION MAY BE STOCKPILED FOR REUSE. PAVERS WITH CHIPS AND CRACKS WILL NOT BE CONSIDERED IN GOOD CONDITION AND WILL NOT BE ACCEPTED FOR REUSE.
3. REMOVE AND STOCKPILE ANY EXISTING SITE FURNISHINGS WITHIN HATCHED AREAS. COORDINATE STORAGE WITH UBC PLANT OPERATIONS.
4. REMOVE AND RETAIN ANY MEMORIAL OR HISTORIC LANDSCAPE ITEMS, PLAQUES, BENCHES, TREES, ETC. AND RETURN TO OWNER.
5. LOCATION OF AT-GRADE SERVICES SHOWN ON DRAWINGS ARE INDICATIVE ONLY. CONTRACTOR TO VERIFY LOCATION AND PROTECT ALL SITE SERVICES WITHIN SCOPE OF WORK PRIOR TO COMMENCEMENT OF EXCAVATION. REFER TO CIVIL FOR SUB SURFACE UTILITY LOCATIONS.
6. REFER TO CIVIL FOR EROSION CONTROL MEASURES.
7. REFER TO CIVIL TO MAKE GOOD ANY DAMAGE DONE DURING THE CONSTRUCTION PERIOD TO EXISTING FEATURES TO BE RETAINED.

**LEGEND**

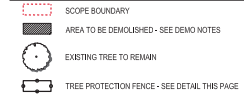

■ GBL ARCHITECTS INC.  
139 EAST 8TH AVENUE  
VANCOUVER, BC CANADA V6T 1R8  
TEL: 604 736 1150  
FAX: 604 731 9276

THIS DOCUMENT IS THE PROPERTY OF GBL ARCHITECTS INC. AND IS NOT TO BE USED FOR ANY OTHER PROJECT WITHOUT THE WRITTEN PERMISSION OF GBL ARCHITECTS INC.

**NOTES**



REVISIONS  
NO. DATE DESCRIPTION  
01 Nov.15,2018 Development Permit

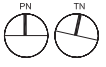

MacInnes Field  
Public Realm  
UNIVERSITY  
BOULEVARD, UBC

Surface Demolition & Tree  
Management Plan (South)

DATE: 2020/01/18  
DRAWN BY: NT  
CHECKED BY: RD  
SCALE: As Indicated 1:200  
JOB NUMBER: PFS 171074



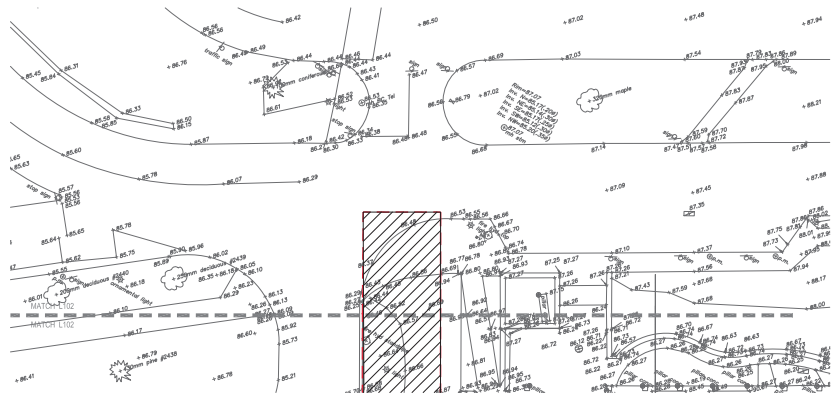
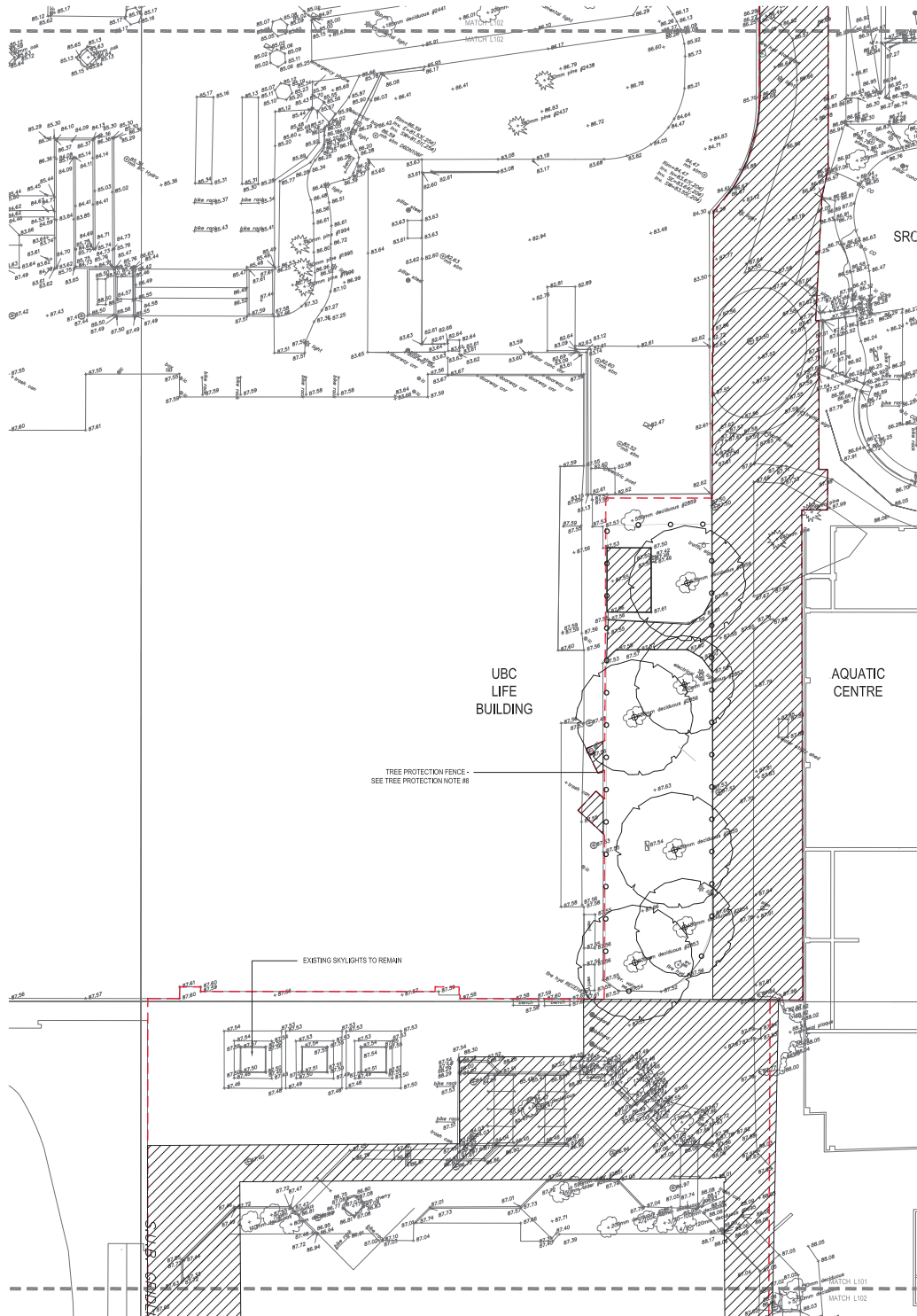

1 ATHLETE'S WAY AT STUDENT UNION BOULEVARD

L102 SCALE: 1:200

NO.	DATE	DESCRIPTION
01	Nov. 15, 2018	Development Permit

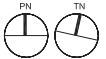

MacInnes Field  
 Public Realm  
 UNIVERSITY  
 BOULEVARD, UBC

Surface Demo & Tree  
 Management Plan (North)

DATE	2/29/2018
DRAWN BY	NT
CHECKED BY	RD
SCALE	As Indicated 1:200
JOB NUMBER	PFS 181074

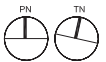

MacInnes Field  
 Public Realm  
 UNIVERSITY  
 BOULEVARD, UBC

Materials Plan (South)

DATE	2/29/2018
DRAWN BY	NT
CHECKED BY	RO
SCALE	As Indicated 1:200
JOB NUMBER	PFS-117074

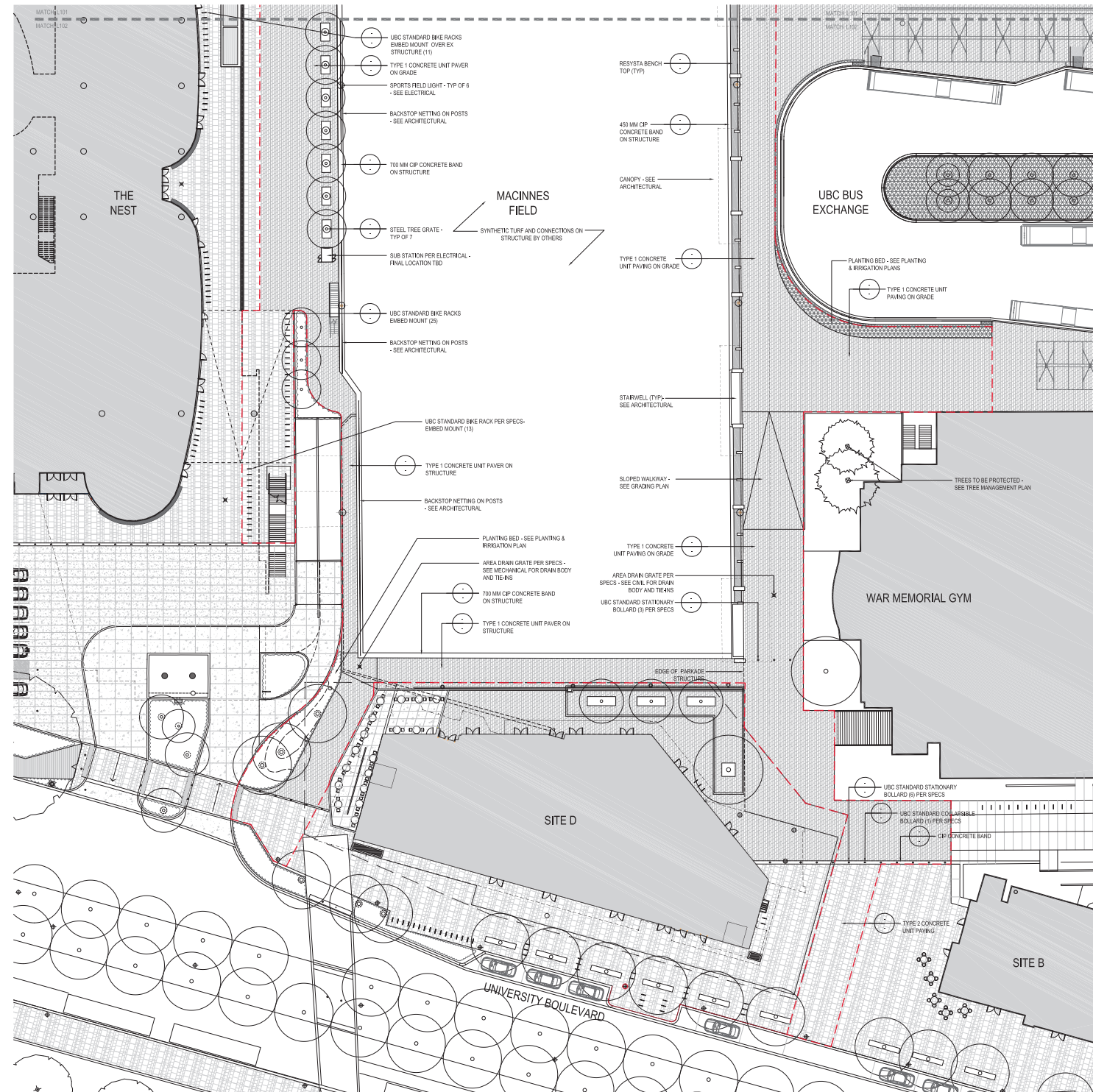



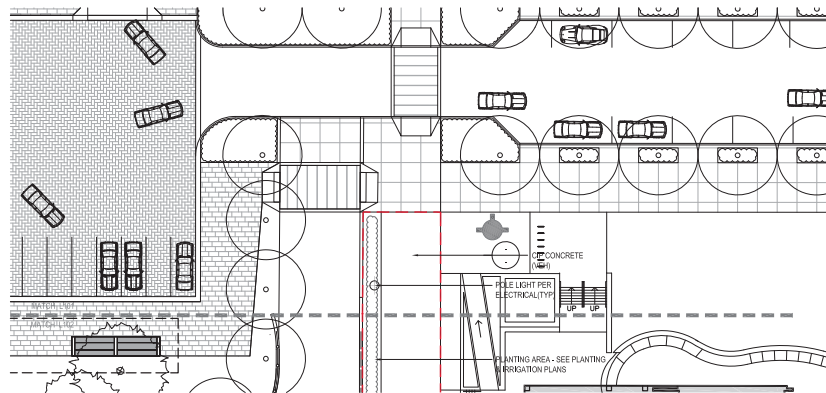
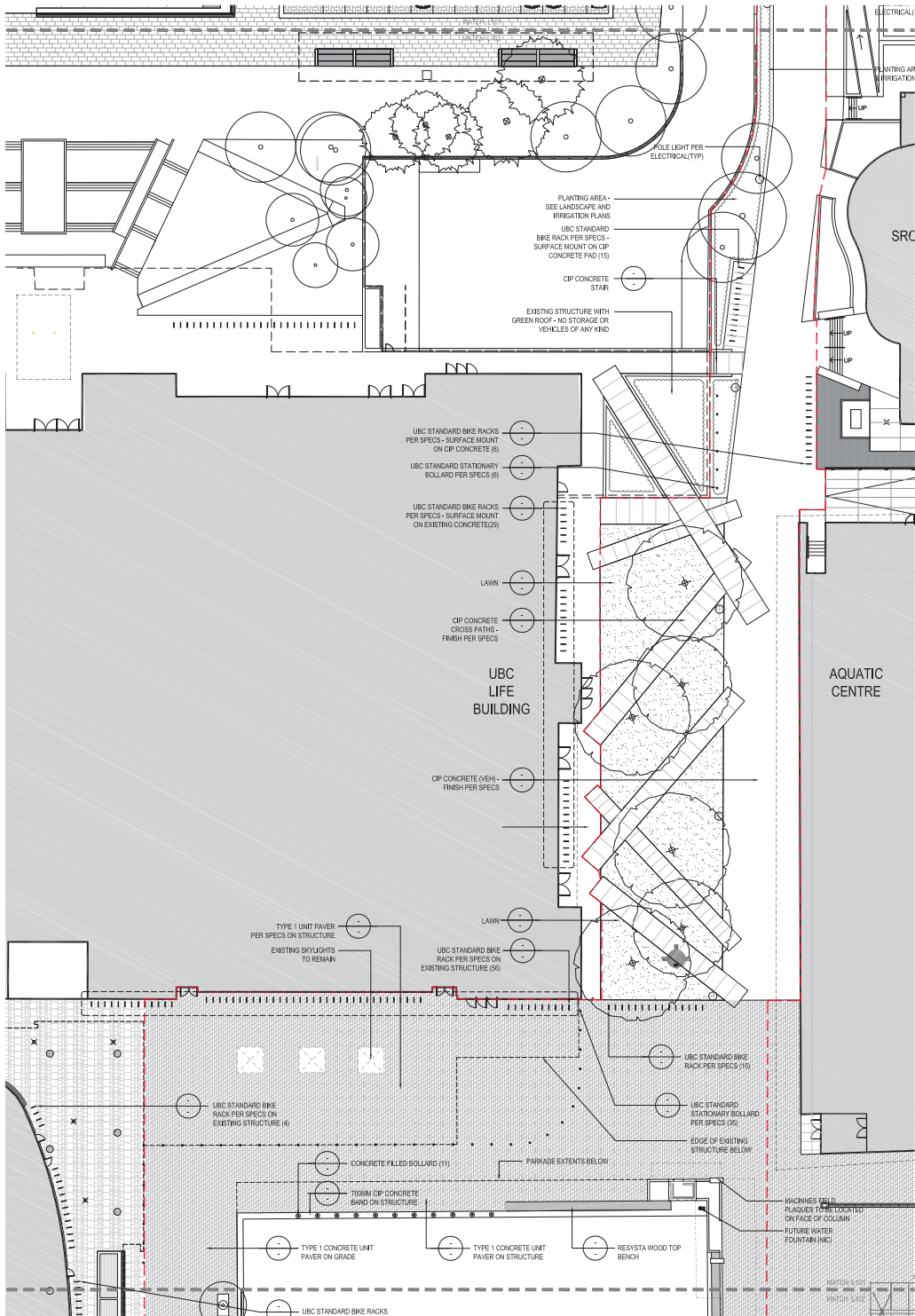

1 ATHLETE'S WAY AT STUDENT UNION BOULEVARD

1/20 SCALE: 1:200

NO.	DATE	DESCRIPTION
01	Nov. 15, 2018	Development Permit

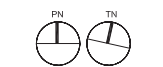

MacInnes Field  
 Public Realm  
 UNIVERSITY  
 BOULEVARD, UBC

Materials Plan (North)

DATE	2020/01/18
DRAWN BY	MT
CHECKED BY	RO
SCALE	As Indicated 1:200
JOB NUMBER	PFS-181074

NO.	DATE	DESCRIPTION
01	Nov.15,2018	Development Permit

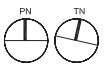

MacInnes Field  
 Public Realm  
 UNIVERSITY BOULEVARD, UBC

Layout Plan (South)

DATE	2020/01/18
DRAWN BY	NT
CHECKED BY	RD
SCALE	As Indicated 1:200
JOB NUMBER	PFS-171074

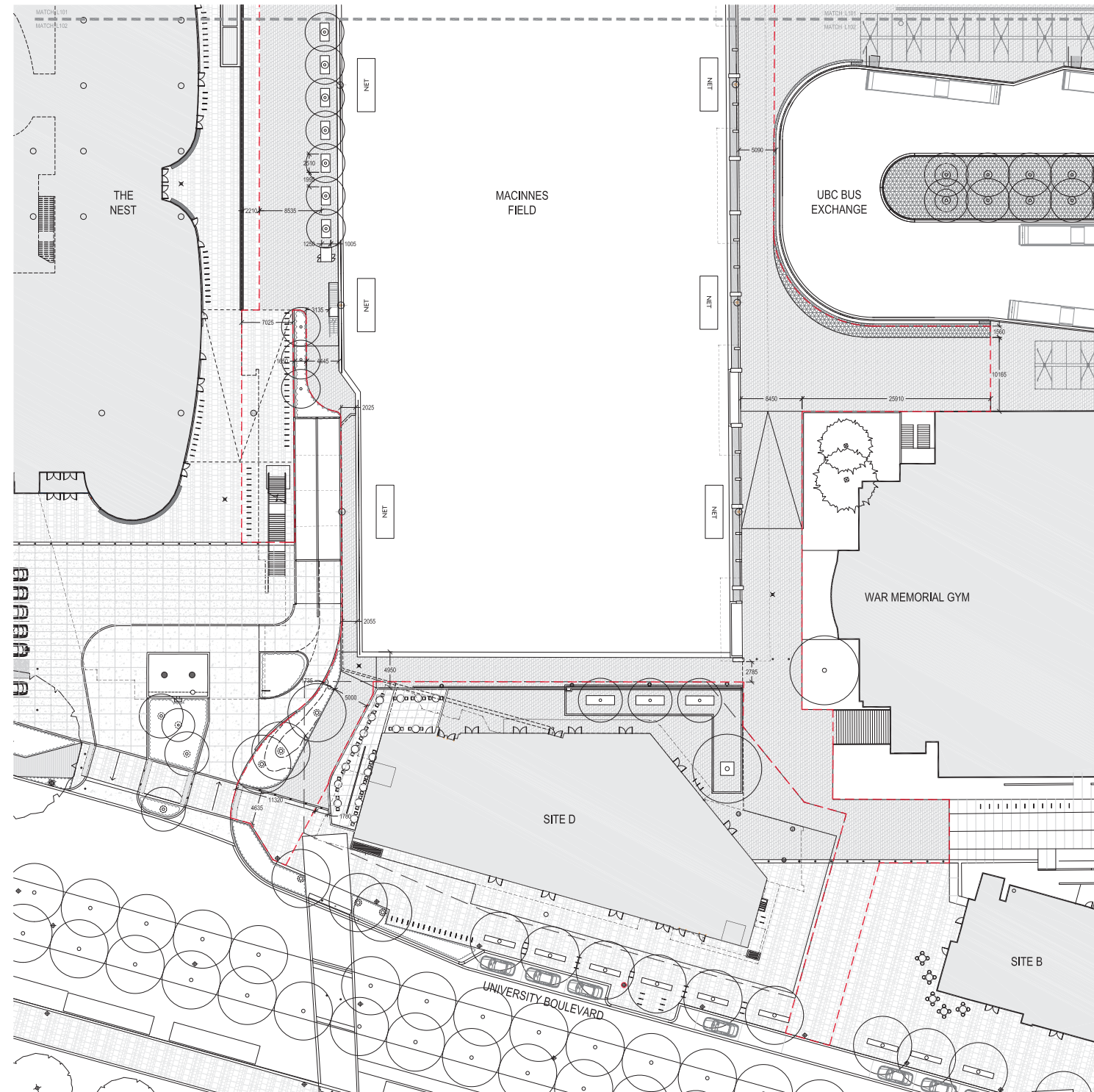



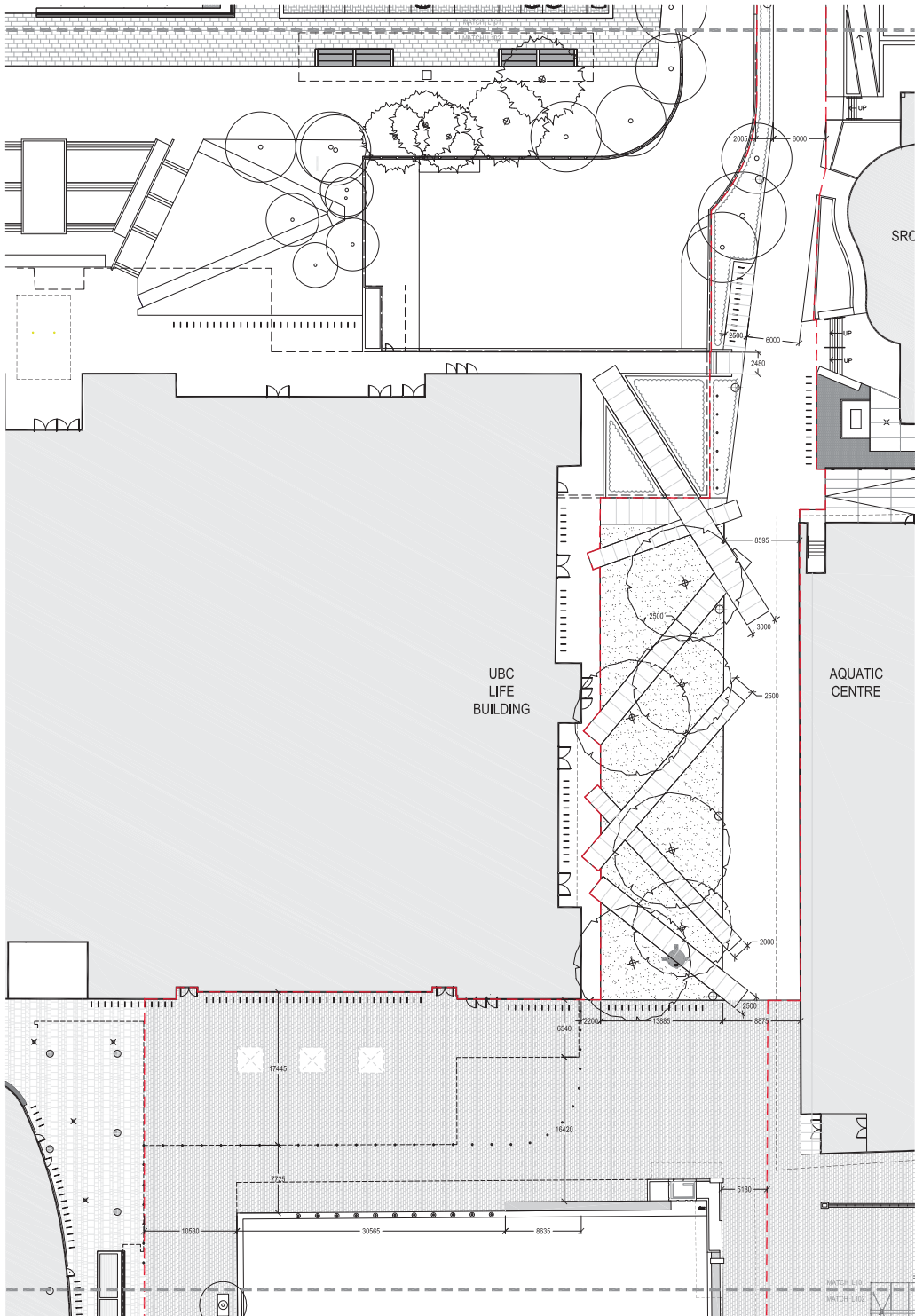

NO.	DATE	DESCRIPTION
01	Nov.15,2018	Development Permit

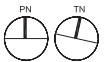
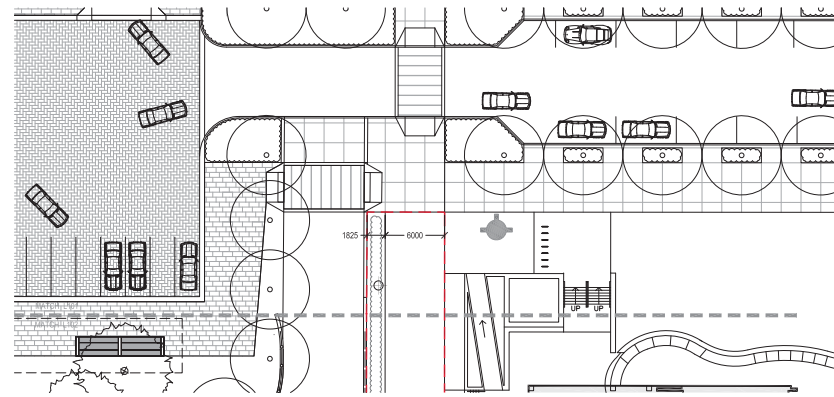

MacInnes Field  
Public Realm  
UNIVERSITY  
BOULEVARD, UBC

Layout Plan (North)

DATE	2018/01/18
DRAWN BY	MT
CHECKED BY	RO
SCALE	As Indicated
JOB NUMBER	PFS-171074

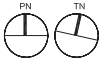

MacInnes Field  
 Public Realm  
 UNIVERSITY  
 BOULEVARD, UBC

Grading Plan (South)

DATE	2020/01/8
DRAWN BY	NT
CHECKED BY	RO
SCALE	As Indicated 1:200
JOB NUMBER	PFS-117074

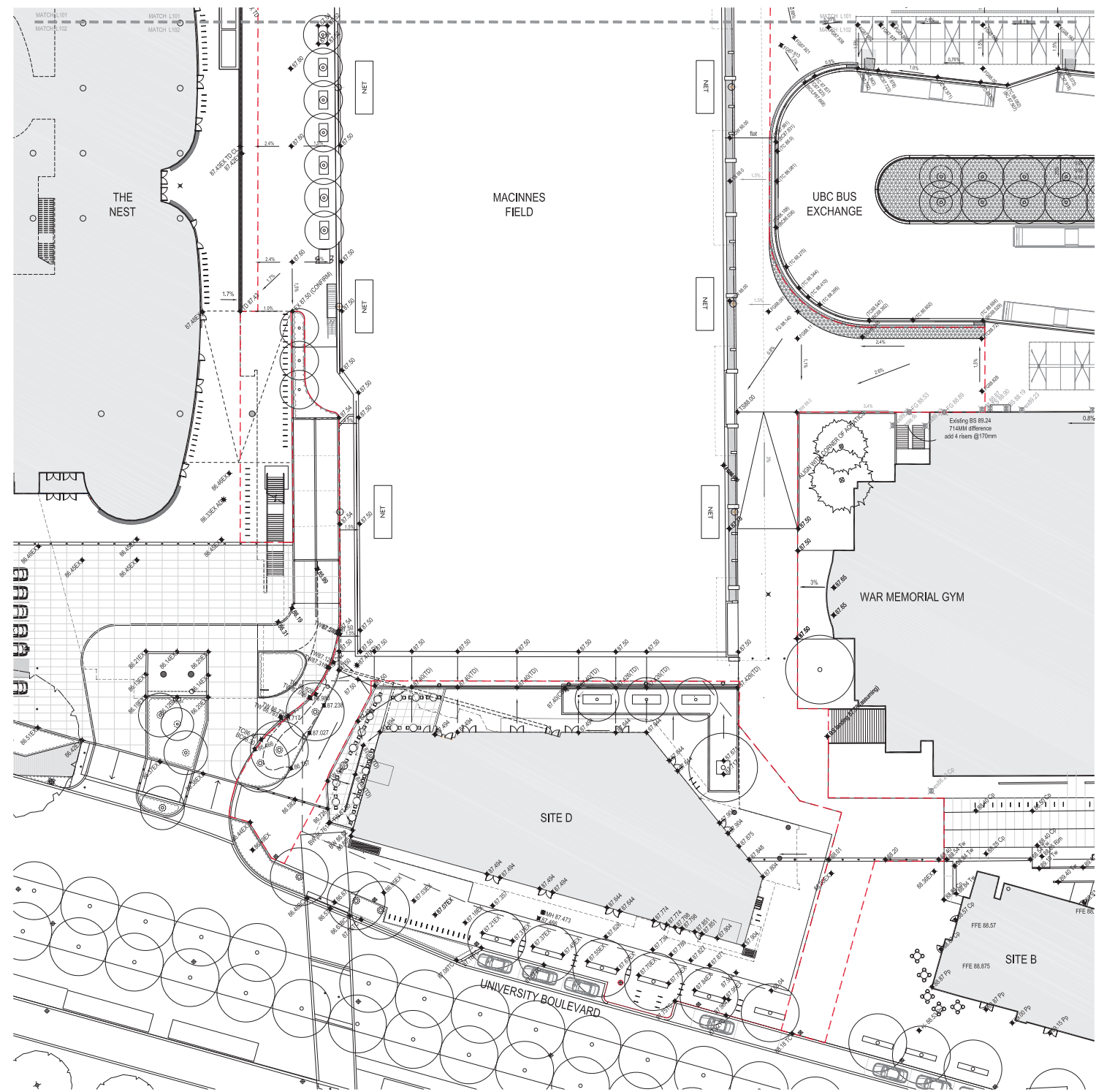



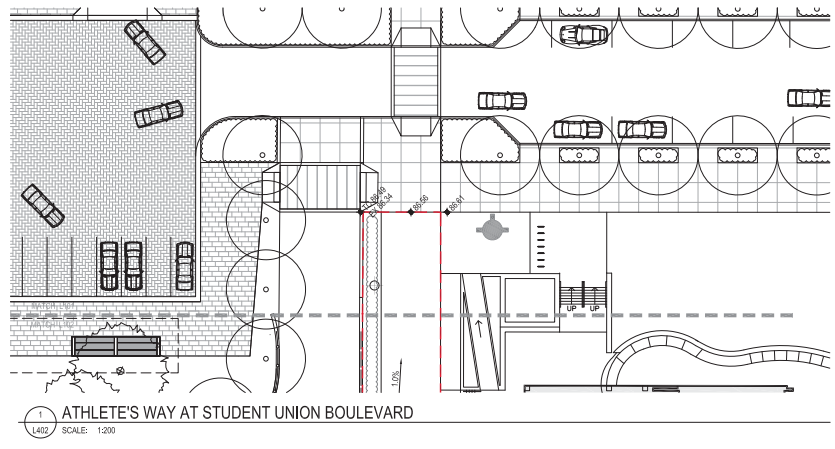
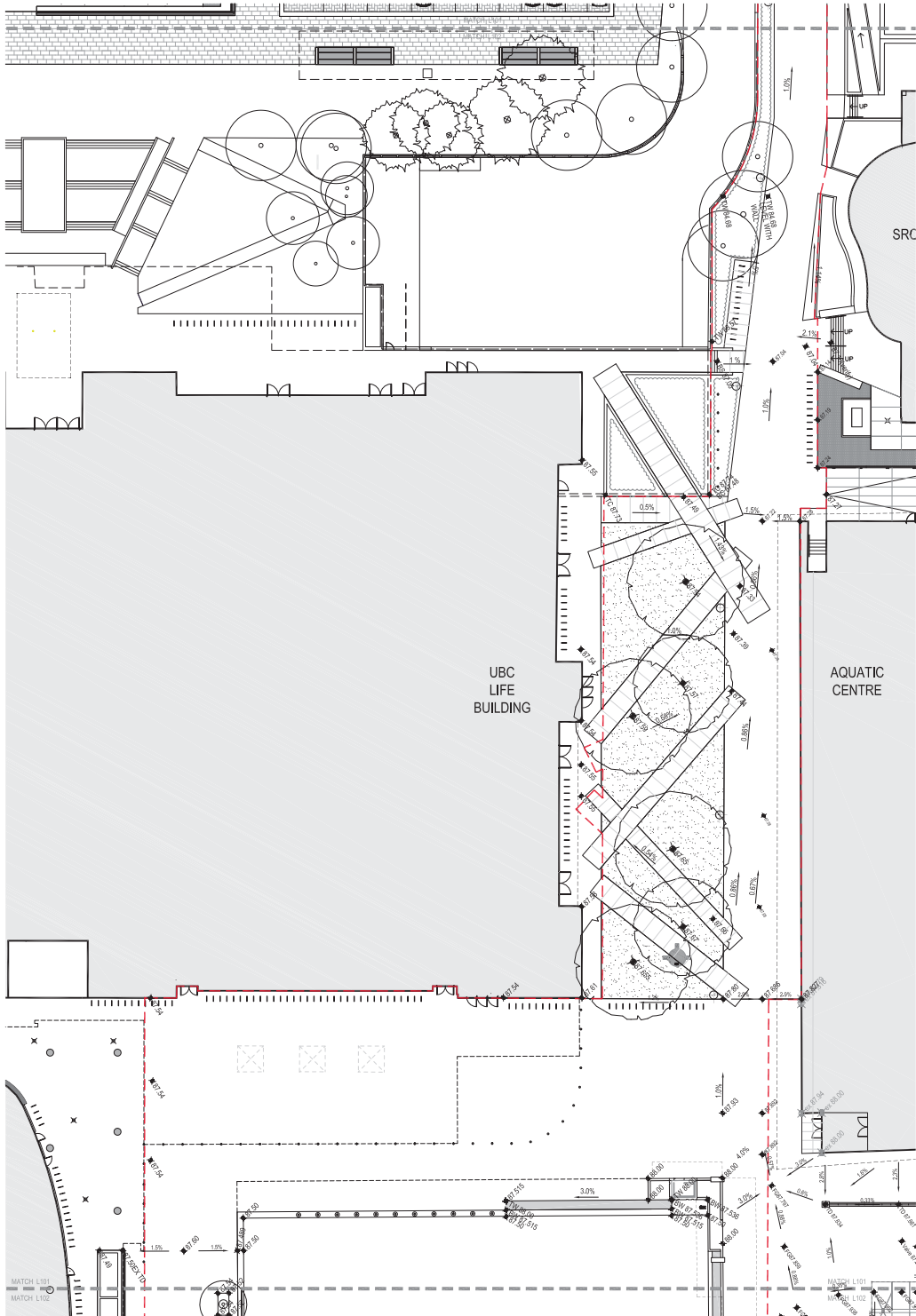

NO.	DATE	DESCRIPTION
01	Nov. 15, 2018	Development Permit

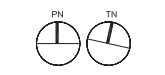

MacInnes Field  
 Public Realm  
 UNIVERSITY  
 BOULEVARD, UBC

Grading Plan (North)

DATE	2020/01/18
DRAWN BY	NT
CHECKED BY	RD
SCALE	As Indicated 1:200
JOB NUMBER	PFS 117074

1 ATHLETE'S WAY AT STUDENT UNION BOULEVARD  
 L402 SCALE: 1:200

**PLANTING NOTES**

1. ALL NEW TREES TO BE PLANTED A MINIMUM OF 1M AWAY FROM UTILITIES (FROM EDGE OF ROOTBALL).
2. ANY LAWN AREAS DISTURBED BY CONSTRUCTION ACTIVITIES TO BE RAKED AND RE-SEEDED POST CONSTRUCTION ACTIVITIES.
3. ALL PLANT MATERIAL SHALL CONFORM TO THE STANDARDS SPECIFIED IN THE CURRENT EDITION OF THE BC LANDSCAPE STANDARD, THIS STANDARD IS PUBLISHED JOINTLY BY THE BC SOCIETY OF LANDSCAPE ARCHITECTS (BCSLA) AND THE BC LANDSCAPE AND NURSERY ASSOCIATION (BCLNA) AND PER PROJECT SPECIFICATIONS.
4. PLANT MATERIAL SIZES SPECIFIED ARE THE MINIMUM ACCEPTABLE SIZES TO BE SUPPLIED TO THIS PROJECT.
5. ALL PLANT MATERIAL SHALL BE WELL-ESTABLISHED AND UNIFORM IN SHAPE AND SIZE.
6. ALL PLANT MATERIAL SHALL BE NURSERY-GROWN UNLESS OTHERWISE NOTED. ONLY CERTIFIED S.O.D. NURSERY STOCK WILL BE ACCEPTED.
7. THE CONTRACTOR SHALL PROVIDE A GROWING MEDIUM ANALYSIS FOR REVIEW BY THE CONSULTANT - AS PER SPECIFICATIONS - PRIOR TO THE START OF CONSTRUCTION. GROWING MEDIUM SUPPLIED TO THE SITE OR INSTALLED ON SITE PRIOR TO CONSULTANT APPROVAL, SHALL BE REJECTED AT NO COST TO THE OWNER.
8. THE CONTRACTOR SHALL CONFIRM PLANT QUANTITIES ON THE DRAWINGS CORRESPOND TO THOSE INDICATED ON THE PLANT LIST. ANY DISCREPANCIES ARE TO BE VERIFIED BY THE CONSULTANT FOR REVIEW AND RESPONSE.
9. PLANT LIST TO BE READ IN CONJUNCTION WITH SPECIFICATIONS FOR COMPLIANCE.
10. PRIOR TO THE START OF CONSTRUCTION, THE CONTRACTOR SHALL CONFIRM THE AVAILABILITY OF THE PLANT MATERIAL SPECIFIED AS PER SPECIFICATIONS. ALLOWING FOR ANY AND ALL REQUIRED APPROVALS, PLANT SUBSTITUTIONS NOT CONFIRMED AND APPROVED BY THE CONSULTANT WILL BE REJECTED.

**PLANTING SCHEDULE**

TREES					
QTY	KEY	BOTANICAL NAME	COMMON NAME	SIZE	NOTES
2	AC	Acer chloratum	Vine Maple	8cm cal.	6' standard, matched/evenly branched
10	AR	Acer rubrum 'Bowhall'	Bowhall Red Maple	7cm cal.	6' standard, matched/evenly branched
1	GB	Ginkgo biloba	Ginkgo	8cm cal.	6' standard, matched/evenly branched
3	PY	Prunus x yedoensis	Yoshino Cherry	8cm cal.	6' standard, matched/evenly branched

SHRUBS					
QTY	KEY	BOTANICAL NAME	COMMON NAME	SIZE	NOTES
-	CI	Chydya ternata 'Sundance'	Sundance Mexican Orange	#3 pot/1000mm O.C.	Full matched
-	H2	Hydrangea quercifolia 'Pee Wee'	Pee Wee Oakleaf Hydrangea	#3 pot/500mm O.C.	Full matched
-	Lp	Lonicera plata	Pinket honeysuckle	#2 pot/600mm O.C.	Full matched
-	Vo	Vaccinium ovatum	Evergreen huckleberry	#3 pot/450mm O.C.	Full matched

GROUNDCOVERS					
QTY	KEY	BOTANICAL NAME	COMMON NAME	SIZE	NOTES
-	gs	Gaultheria shallon	Sale	#2 pot/450mm O.C.	Full matched
-	pn	Polystichum munitum	Sword Fern	#2 pot/750mm O.C.	Full matched

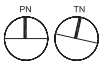

**IRRIGATION NOTES**

1. ALL LANDSCAPE AREAS TO RECEIVE HIGH EFFICIENCY IRRIGATION PER UBC STANDARDS.
2. ALL RISERS IN SHRUB BEDS TO BE POINTED AWAY FROM HARDSCAPE AREAS



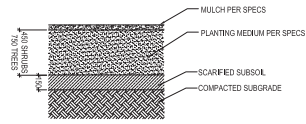
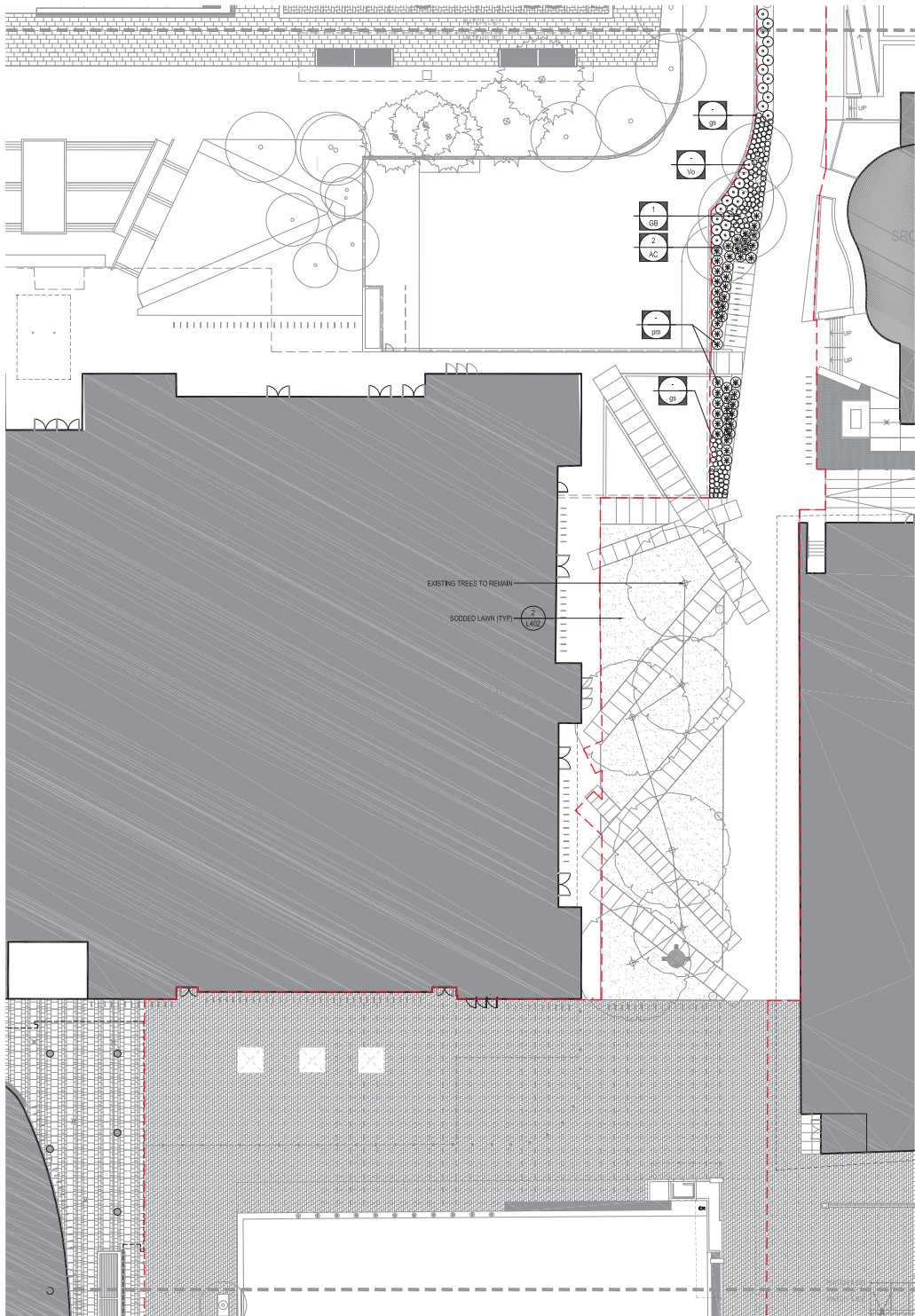

**SOIL PROFILE**  
SCALE: 1:20

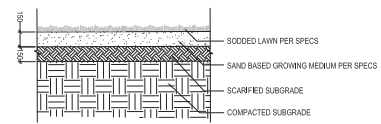

**LAWN PROFILE**  
SCALE: 1:20

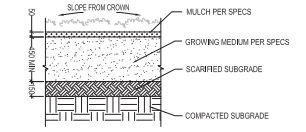

**SHRUB PLANTING ON GRADE**  
SCALE: 1:20

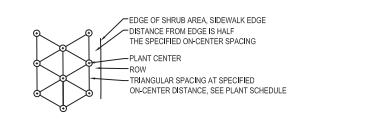

**TRIANGULAR SPACING**  
SCALE: 1:20

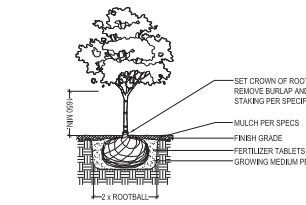

**TREE PLANTING ON GRADE**  
SCALE: 1:20

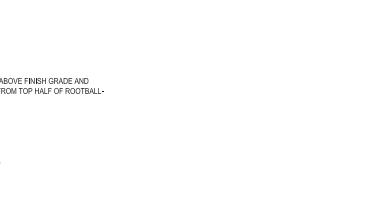

**TREE PLANTING ON GRADE W/ SILVA CELLS**  
SCALE: 1:20

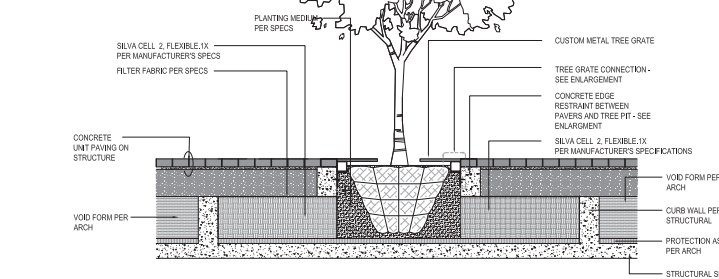

**TREE PLANTING ON STRUCTURE**  
SCALE: 1:20

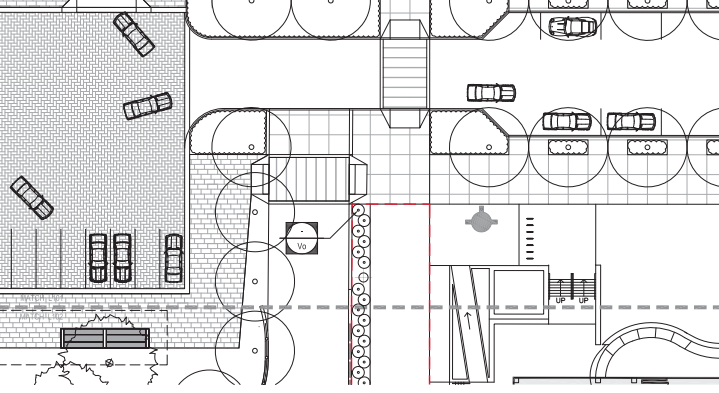

**1 ATHLETE'S WAY AT STUDENT UNION BOULEVARD**  
SCALE: 1:200



■ GBL ARCHITECTS INC.  
139 EAST 8TH AVENUE TEL: 604 736 1195  
VANCOUVER, BC CANADA V6T 1R8 FAX: 604 731 9278  
DESIGN AND CONSTRUCTION OF THIS PROJECT WAS PROVIDED BY GBL ARCHITECTS INC. ALL RIGHTS RESERVED.  
COURTESY PROPERTY OF GBL ARCHITECTS INC. AND NOT BE USED FOR  
REPRODUCTION WITHOUT THE WRITTEN PERMISSION OF GBL ARCHITECTS INC.

NOTES



REVISIONS  
NO. DATE DESCRIPTION  
01 Nov.15,2018 Development Permit

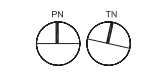

MacInnes Field  
Public Realm  
UNIVERSITY  
BOULEVARD, UBC

Planting & Irrigation (North)

DATE 2020/01/18  
DRAWN BY NT  
CHECKED BY RD  
SCALE As Indicated  
JOB NUMBER PFS 817074

L502

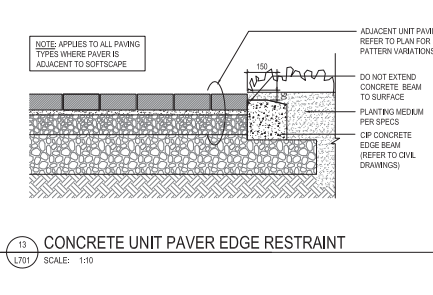
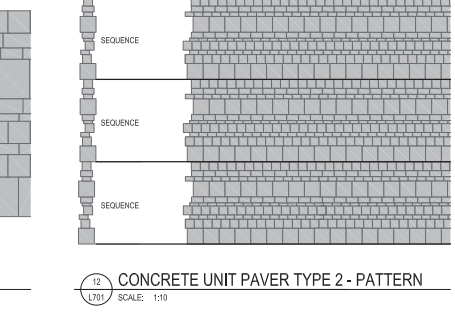
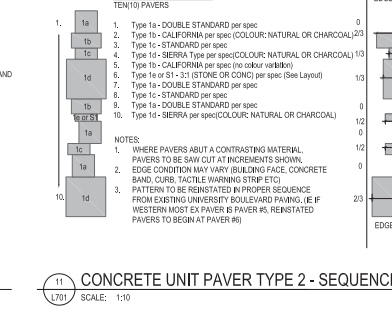
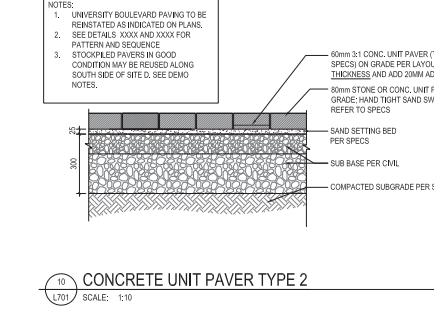
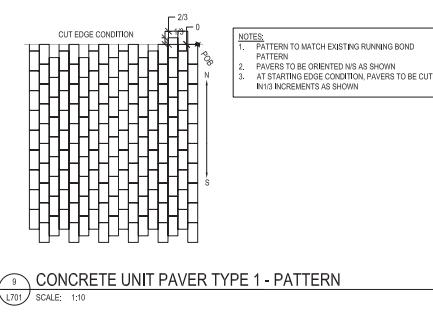
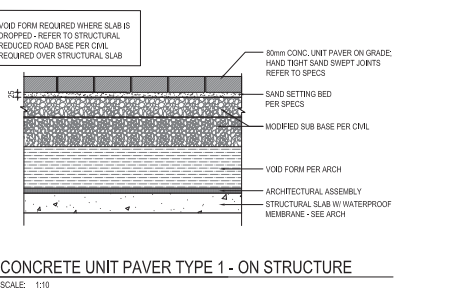
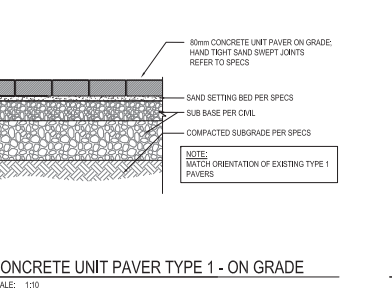
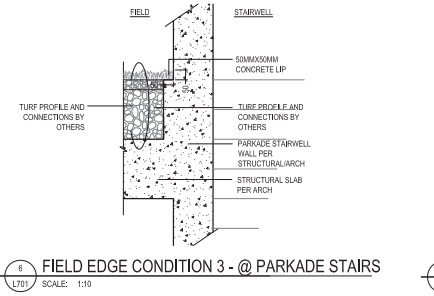
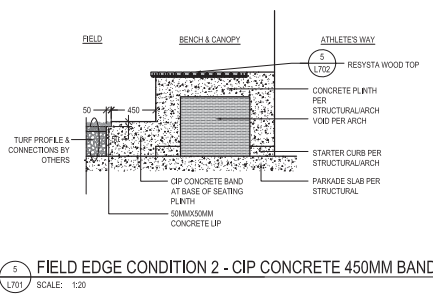
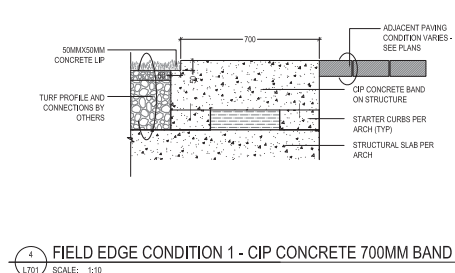
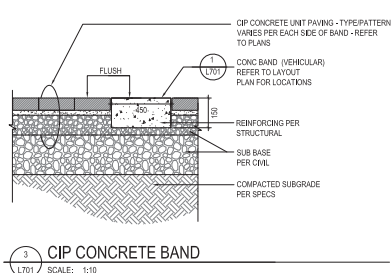
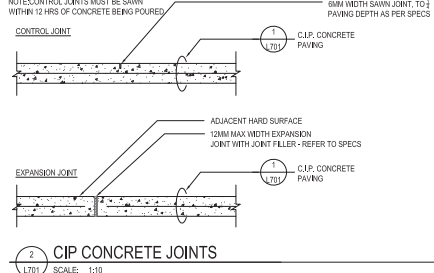
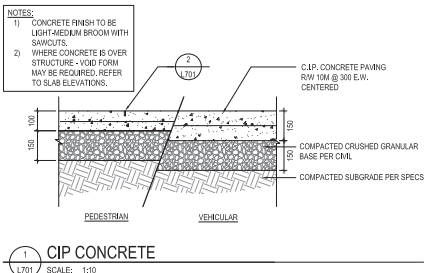



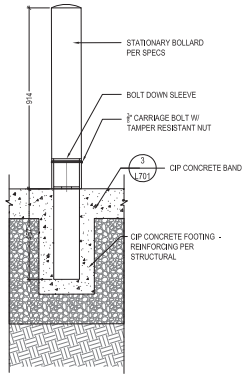

**1 STATIONARY BOLLARD**  
L702 SCALE: 1:10

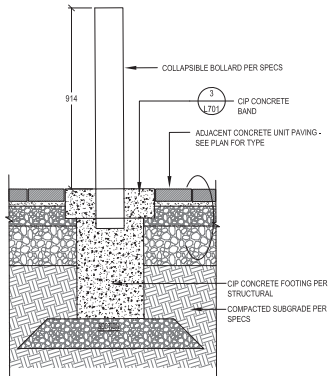

**2 COLLAPSIBLE BOLLARD**  
L702 SCALE: 1:10

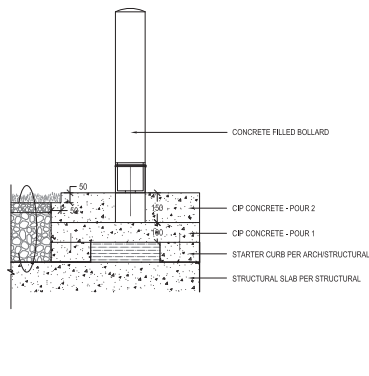

**3 CONCRETE FILLED BOLLARD ON STRUCTURE**  
L702 SCALE: 1:10

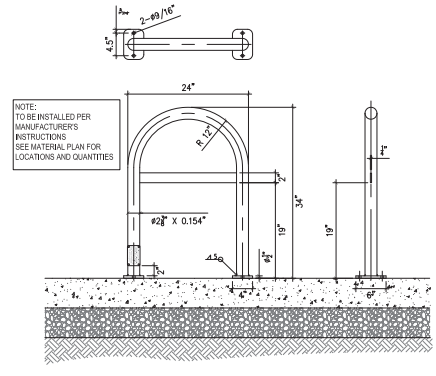

**4 UBC STANDARD BIKE RACK - SURFACE MOUNTED**  
L702 SCALE: 1:10

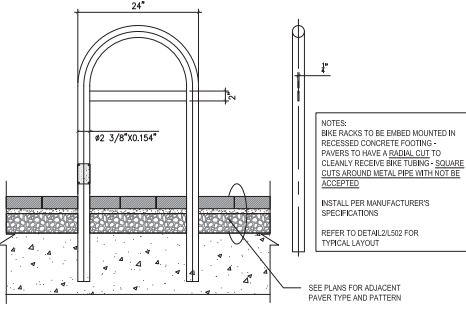

**5 UBC STANDARD BOLLARD - EMBED MOUNTED**  
L702 SCALE: 1:10

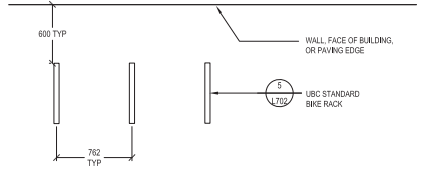

**6 TYPICAL BIKE LAYOUT**  
L702 SCALE: 1:10

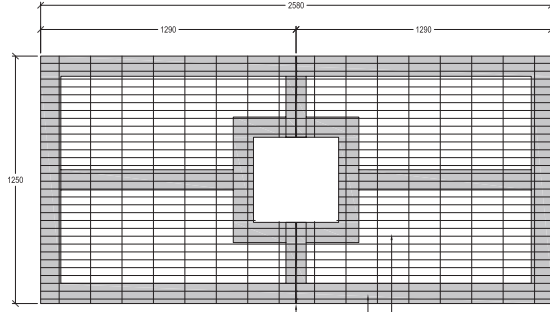

**7 STEEL TREE GRATE**  
L702 SCALE: 1:10

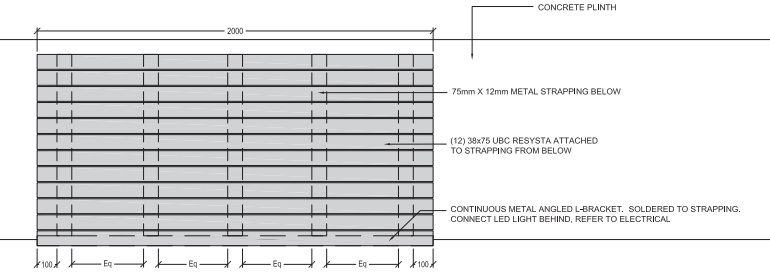

**8 RESYSTA BENCH TOP (TYP) - PLAN**  
L702 SCALE: 1:10

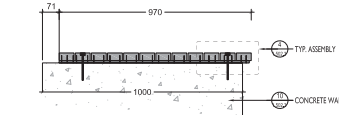

**9 RESYSTA BENCH TOP (TYP) - SECTION**  
L702 SCALE: 1:10

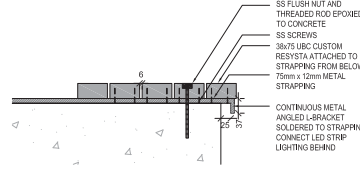

**10 RESYSTA BENCH TOP ASSEMBLY**  
L702 SCALE: 1:10