

REVISIONS AND ISSUES

NO.	DATE	DESCRIPTION
1	2012/04/27	ISSUED FOR DP
2	2012/05/03	ISSUED FOR DP
3	2012/05/17	ISSUED TO DRC

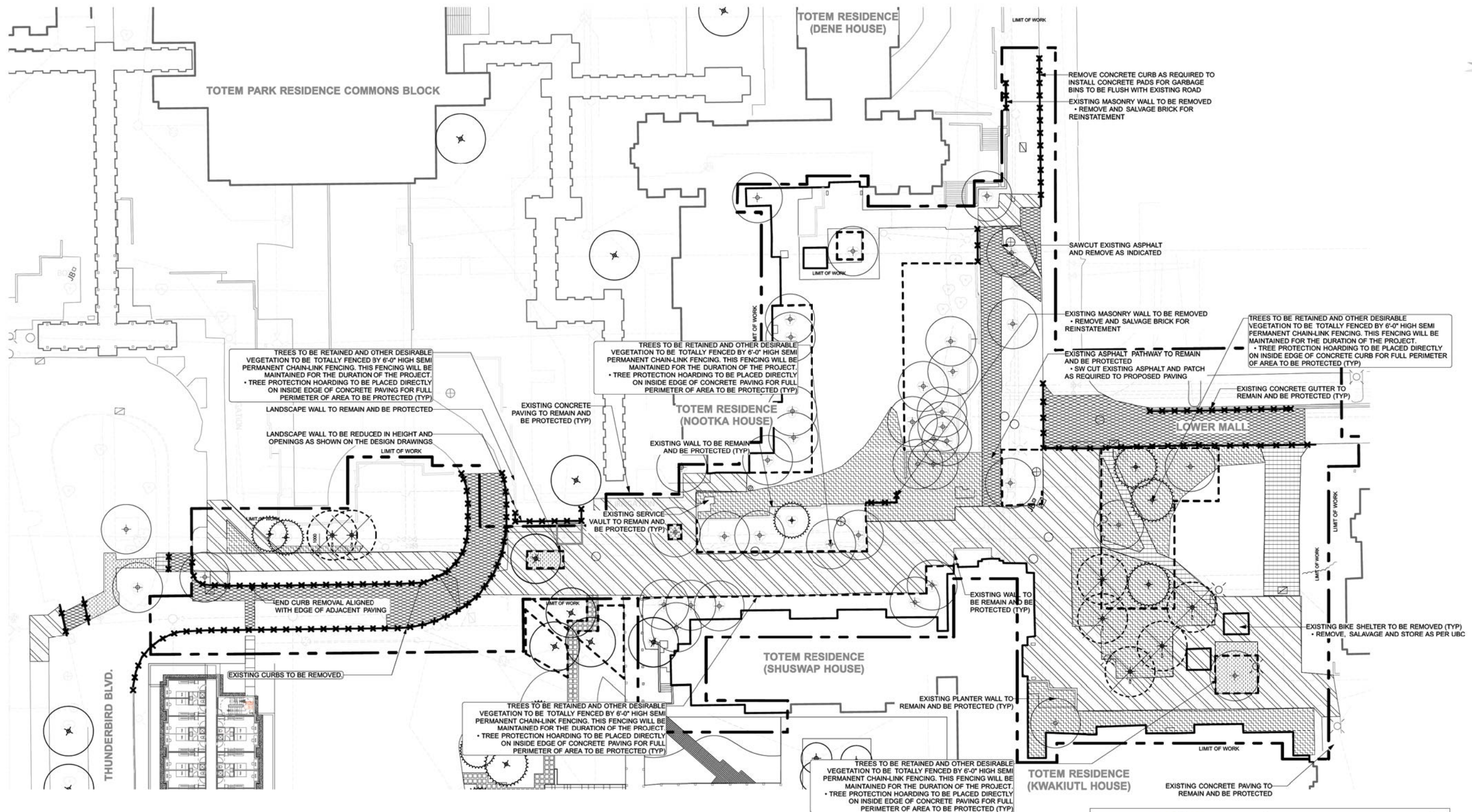

- REMOVAL GENERAL NOTES**
- DO NOT SCALE DRAWING. LAYOUT AS PER DIMENSIONS NOTED ON LANDSCAPE PLANS. REPORT ANY DISCREPANCIES TO CONSULTANT FOR REVIEW AND RESPONSE PRIOR TO COMMENCING WORK.
  - THE LOCATIONS OF UTILITIES SHOWN IS APPROXIMATE ONLY. THE EXACT LOCATION SHOULD BE DETERMINED BY CONSULTING THE MUNICIPAL AUTHORITIES AND UTILITY COMPANIES CONCERNED. THE CONTRACTOR SHALL PROVE THE LOCATION OF UTILITIES AND SHALL BE RESPONSIBLE FOR ADEQUATE PROTECTION FROM DAMAGE.
  - CONTRACTOR SHALL MAKE GOOD ALL DAMAGES TO EXISTING FEATURES SCHEDULED TO REMAIN TO THE SATISFACTION OF THE CONTRACT ADMINISTRATOR.
  - NO STAGING OR STORAGE OF EQUIPMENT OR MATERIALS SHALL TAKE PLACE OUTSIDE OF DESIGNATED AREAS WITHOUT WRITTEN CONSENT.
  - CONTRACTOR SHALL DISPOSE OF MATERIALS OFF-SITE UNLESS OTHERS NOTED.
  - LANDSCAPE DRAWINGS ARE TO BE READ IN CONJUNCTION WITH SPECIFICATIONS AND THE DRAWINGS OF ALL OTHER DISCIPLINES INVOLVED.

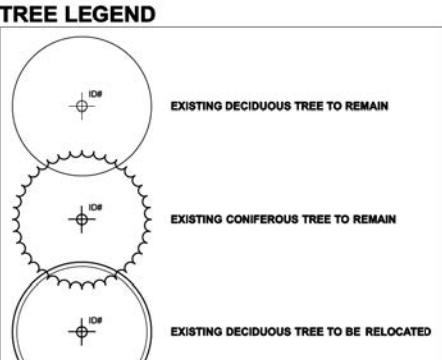
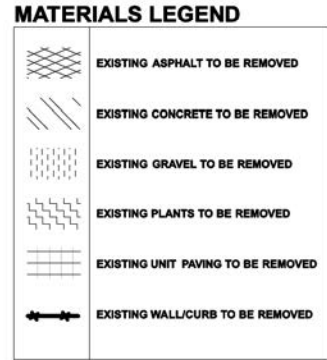

- TREE PROTECTION GENERAL NOTES**
- A. EXCAVATION AROUND TREES**
- EXCAVATION WITHIN DRIP LINE OF TREES ONLY WHERE INDICATED ON PLANS AND AS DIRECTED BY THE CONSULTANT.
  - DURING ANY EXCAVATION WITHIN THE DRIP LINE OF A TREE THE CONTRACTOR SHALL EXCAVATE AROUND TREE ROOTS AS DIRECTED BY THE CONSULTANT. DO NOT CUT TREE ROOTS UNLESS DIRECTED BY THE CONSULTANT.
  - TREES AND OTHER DESIRABLE VEGETATION TO BE TOTALLY FENCED BY 1.8M (6'-0") HIGH SEMI-PERMANENT CHAIN-LINK FENCING. FENCING TO BE MAINTAINED FOR THE DURATION OF THE PROJECT.
- B. EXCAVATION FOR NEW CONSTRUCTION WITHIN THE DRIP LINES OF TREES**
- HAND EXCAVATE TO MINIMIZE DAMAGE TO ROOT SYSTEMS.
  - USE NARROW TINE SPADING FORKS TO PROBE AND COMB SOIL TO EXPOSE ROOTS.
  - RELOCATE ROOTS INTO BACKFILL AREAS WHENEVER POSSIBLE. IF LARGE MAIN LATERAL ROOTS ARE ENCOUNTERED, EXPOSE BEYOND EXCAVATION LIMITS AS REQUIRED TO BEND AND RELOCATE WITHOUT BREAKING.
- C. UTILITY TRENCHING WITHIN THE DRIP LINES OF TREES**
- TUNNEL UNDER AND AROUND ROOTS BY HAND DIGGING.
  - DO NOT CUT MAIN LATERAL ROOTS.
  - CUTTING OF SMALLER ROOTS THAT INTERFERE WITH INSTALLATION OF NEW WORK SHALL BE DONE WITH CLEAN SHARP TREE PRUNING TOOLS.
  - ROOTS THAT ARE ENCOUNTERED IMMEDIATELY ADJACENT TO THE LOCATION OF NEW CONSTRUCTION AND ARE TOO DIFFICULT TO RELOCATE SHALL BE CUT 150MM (6") BACK FROM NEW CONSTRUCTION. USE CLEAN SHARP TREE PRUNING TOOLS.
- D. PROTECTION OF EXPOSED ROOTS**
- DO NOT ALLOW EXPOSED ROOTS TO DRY OUT PRIOR TO PLACEMENT OF PERMANENT COVER. PROVIDE ONE OF THE FOLLOWING TEMPORARY REMEDIAL MEASURES:
    - PROVIDE TEMPORARY EARTH COVER. MAINTAIN MOISTURE.
    - PACK WITH WET PEAT BAGS. MAINTAIN MOISTURE.
    - PACK WITH FOUR LAYERS OF WET UNTREATED BURLAP. MAINTAIN MOISTURE.
  - TEMPORARILY SUPPORT AND PROTECT EXPOSED ROOTS FROM DAMAGE UNTIL PERMANENTLY RELOCATED AND COVERED WITH BACKFILL.
  - WATER PUDDLE BACKFILL AROUND ROOTS TO ELIMINATE VOIDS AND AIR POCKETS.

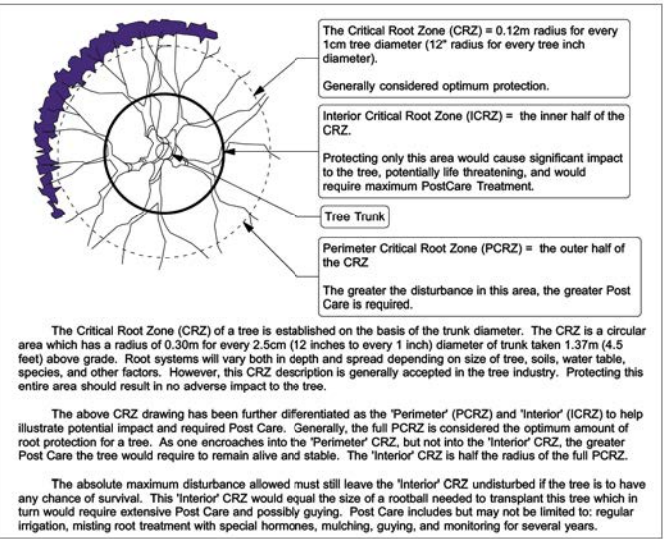

PROJECT  
**UBC Totem Planning**

DRAWING TITLE  
**Tree Management & Removals Plan**

PROJECT NO. 1216  
 DATE May 3, 2012  
 FILE NAME 1216 TD tree management plan.vwx  
 PLOTTED 5/17/12 at 6:52:57 PM  
 DRAWN KF REVIEWED JW

SCALE  
 1:300

L 0.00



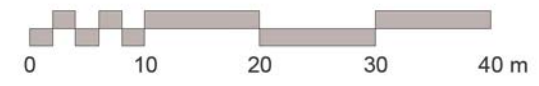

REVISIONS AND ISSUES

NO.	DATE	DESCRIPTION
1	2012/04/27	ISSUED FOR DP
2	2012/05/03	ISSUED FOR DP
3	2012/06/17	ISSUED TO DRC

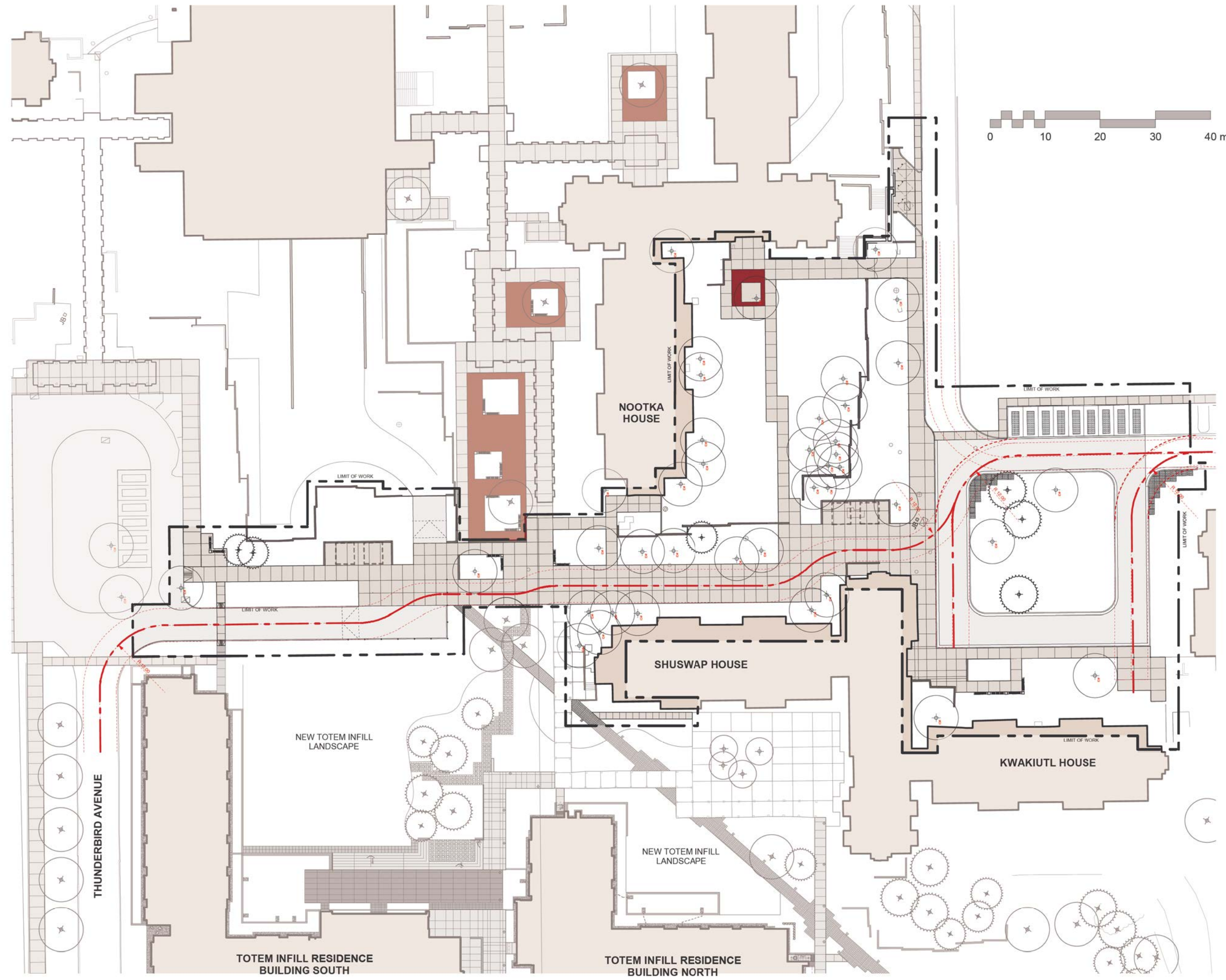

PROJECT  
**UBC Totem Planning**

DRAWING TITLE  
**Fire Route Plan**

Copyright: All rights reserved. Reproduction in whole or in part is prohibited. This drawing is an instrument of service in the property of the Consultant and may not be used in any way without the written permission of this office.

NORTH  SCALE **1:300**

PROJECT NO.	1216
DATE	May 17, 2012
FILE NAME	1216 TD PLAN.vwx
PLOTTED	5/17/12 at 10:39:06 PM
DRAWN	KF
REVIEWED	JW

DRAWING  
**L 0.01**



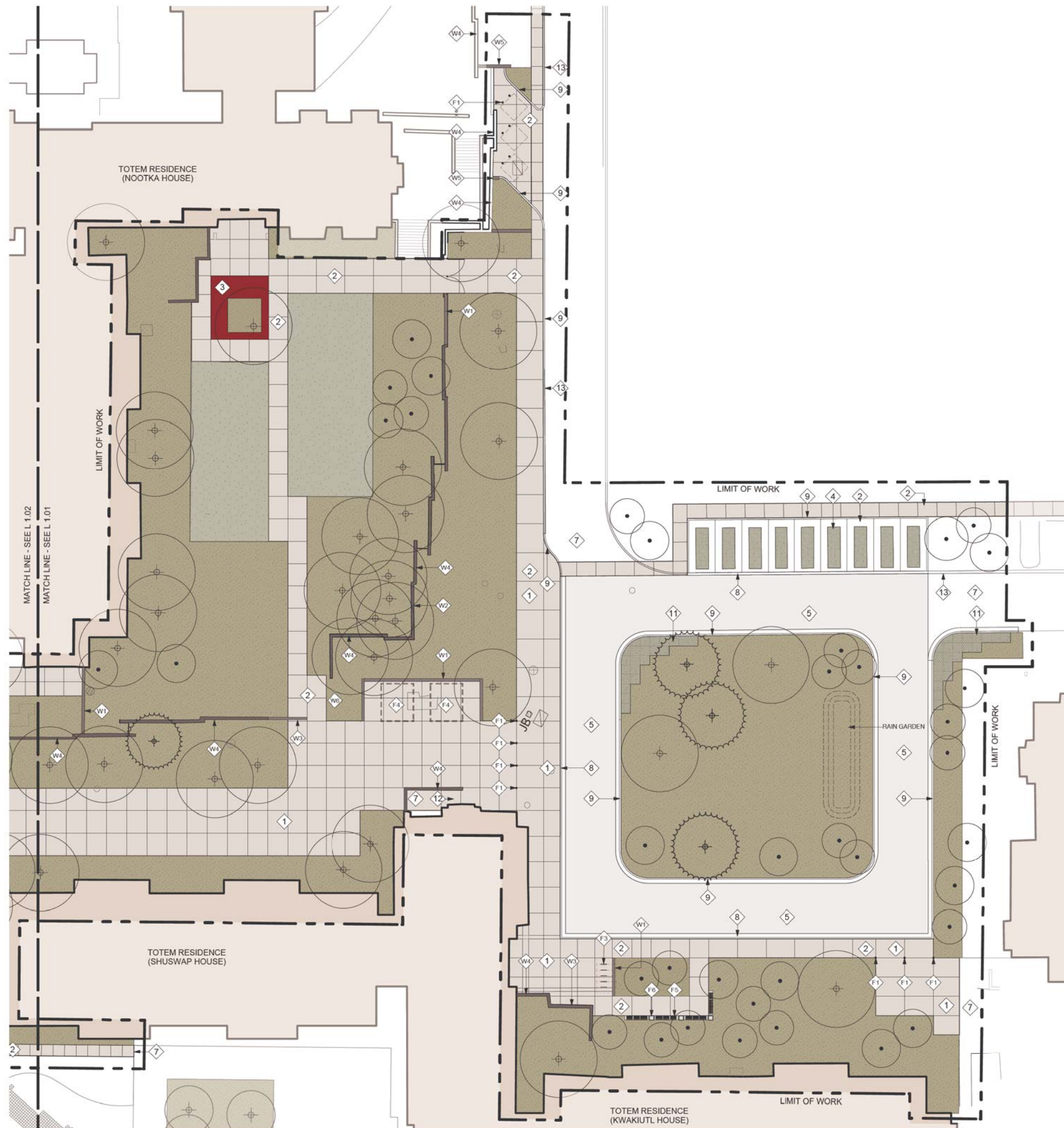

### PAVING MATERIALS

1	CAST IN PLACE CONCRETE PAVING - HEAVY DUTY FINISH: LIGHT SANDBLAST COLOUR: NATURAL CONTROL JOINT: SAWCUTS
2	CAST IN PLACE CONCRETE PAVING - LIGHT DUTY FINISH: LIGHT SANDBLAST COLOUR: NATURAL CONTROL JOINT: SAW CUT
3	EXISTING BRICK PAVING TO REMAIN • WITH ADJUSTMENTS TO EXTENT OF OPEN PLANTING AREA
4	PERMEABLE PAVING
5	ASPHALT PAVING - VEHICULAR
6	ASPHALT PAVING RAMP - VEHICULAR
7	EXISTING PAVING TO REMAIN AND BE PROTECTED
8	CONCRETE ROLLED CURB
9	CONCRETE BARRIER CURB
10	CONCRETE FLASH CURB
11	GRASS PAVERS • INSTALL AS PER MANUFACTURER'S INSTRUCTIONS
12	EXISTING CONCRETE STAIRS TO REMAIN AND BE PROTECTED
13	EXISTING CONCRETE CURB TO REMAIN AND BE PROTECTED

### REVISIONS AND ISSUES

NO.	DATE	DESCRIPTION
1	2012/04/27	ISSUED FOR DP
2	2012/05/03	ISSUED FOR DP
3	2012/05/17	ISSUED TO DRC

### SITE FURNISHINGS

F1	BOLLARD Type 1 TYPE: UBC STANDARD STATIONARY BOLLARD MODEL: SENTRY 2868 FINISH: UBC GREY HEIGHT: 42" DIAMETER: 8" MOUNTING: REMOVABLE
F2	BOLLARD Type 2 TYPE: UBC STANDARD STATIONARY BOLLARD MODEL: SENTRY 2868 FINISH: UBC GREY HEIGHT: 42" DIAMETER: 8" MOUNTING: FLUSH MOUNT CONCRETE BASE
F3	BIKE RACK • UBC STANDARD 1/1
F4	RELOCATED EXISTING BIKE SHELTER
F5	CUSTOM TOTEM BENCH • PER TOTEM INFILL (RESIDENCE)
F6	CUSTOM TOTEM METAL SIDE TABLE • PER TOTEM INFILL (RESIDENCE)

### LANDSCAPE WALLS & STRUCTURES

W1	NEW TOTEM PARK STYLE WALL • 1.2M MAX. HEIGHT, FREESTANDING, BRICK BOTH SIDES, CONCRETE CAP
W2	TOTEM PARK NAME WALL • SIGNAGE ON EXISTING WALL
W3	RESIDENCE NAME WALL • 1.2M MAX. HEIGHT, FREESTANDING, BRICK BOTH SIDES, CONCRETE CAP
W4	EXISTING LANDSCAPE WALL TO REMAIN AND BE PROTECTED
W5	GARBAGE ENCLOSURE • T.B.D.
W6	EXISTING LANDSCAPE WALL TO BE REMOVED • BRICK TO BE STORED AND REUSED ON SITE
W7	VEHICLE GATE
W8	EXISTING COLONADE TO REMAIN

### NOTE:

NEW POLE-MOUNTED LIGHTING TO CONFORM TO UBC GUIDELINES.

### LAYOUT AND MATERIALS GENERAL NOTES

- DO NOT SCALE DRAWING. LAYOUT AS PER DIMENSIONS NOTED ON LANDSCAPE PLANS. REPORT ANY DISCREPANCIES TO CONSULTANT FOR REVIEW AND RESPONSE PRIOR TO COMMENCING WORK.
- THE LOCATIONS OF UTILITIES SHOWN IS APPROXIMATE ONLY. THE EXACT LOCATION SHOULD BE DETERMINED BY CONSULTING THE MUNICIPAL AUTHORITIES AND UTILITY COMPANIES CONCERNED. THE CONTRACTOR SHALL PROVIDE THE LOCATION OF UTILITIES AND SHALL BE RESPONSIBLE FOR ADEQUATE PROTECTION FROM DAMAGE.
- CONTRACTOR SHALL MAKE GOOD ALL DAMAGES TO EXISTING FEATURES SCHEDULED TO REMAIN, TO THE SATISFACTION OF THE CONTRACT ADMINISTRATOR.
- NO STAGING OR STORAGE OF EQUIPMENT OR MATERIALS SHALL TAKE PLACE OUTSIDE OF DESIGNATED AREAS WITHOUT WRITTEN CONSENT.
- CONTRACTOR SHALL DISPOSE OF MATERIALS OFF-SITE UNLESS OTHERS NOTED.
- LANDSCAPE DRAWINGS ARE TO BE READ IN CONJUNCTION WITH SPECIFICATIONS AND THE DRAWINGS OF ALL OTHER DISCIPLINES INVOLVED.

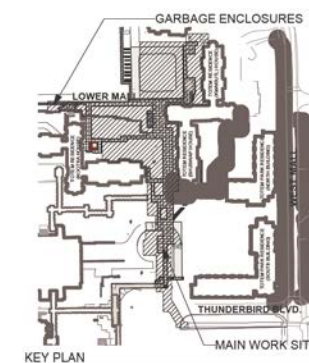

PROJECT  
**UBC Totem Planning**

DRAWING TITLE  
**Materials Plan**

Copyright: All rights reserved. Reproduction in whole or in part is prohibited. This drawing is an instrument of service to the property of the Consultant and may not be used in any way without the written permission of the office.



PROJECT NO.	1216
DATE	May 17, 2012
FILE NAME	1216 TD PLAN.vwx
PLOTTED	5/17/12 at 10:39:06 PM
DRAWN	KF
REVIEWED	JW
DRAWING	

# L 1.01



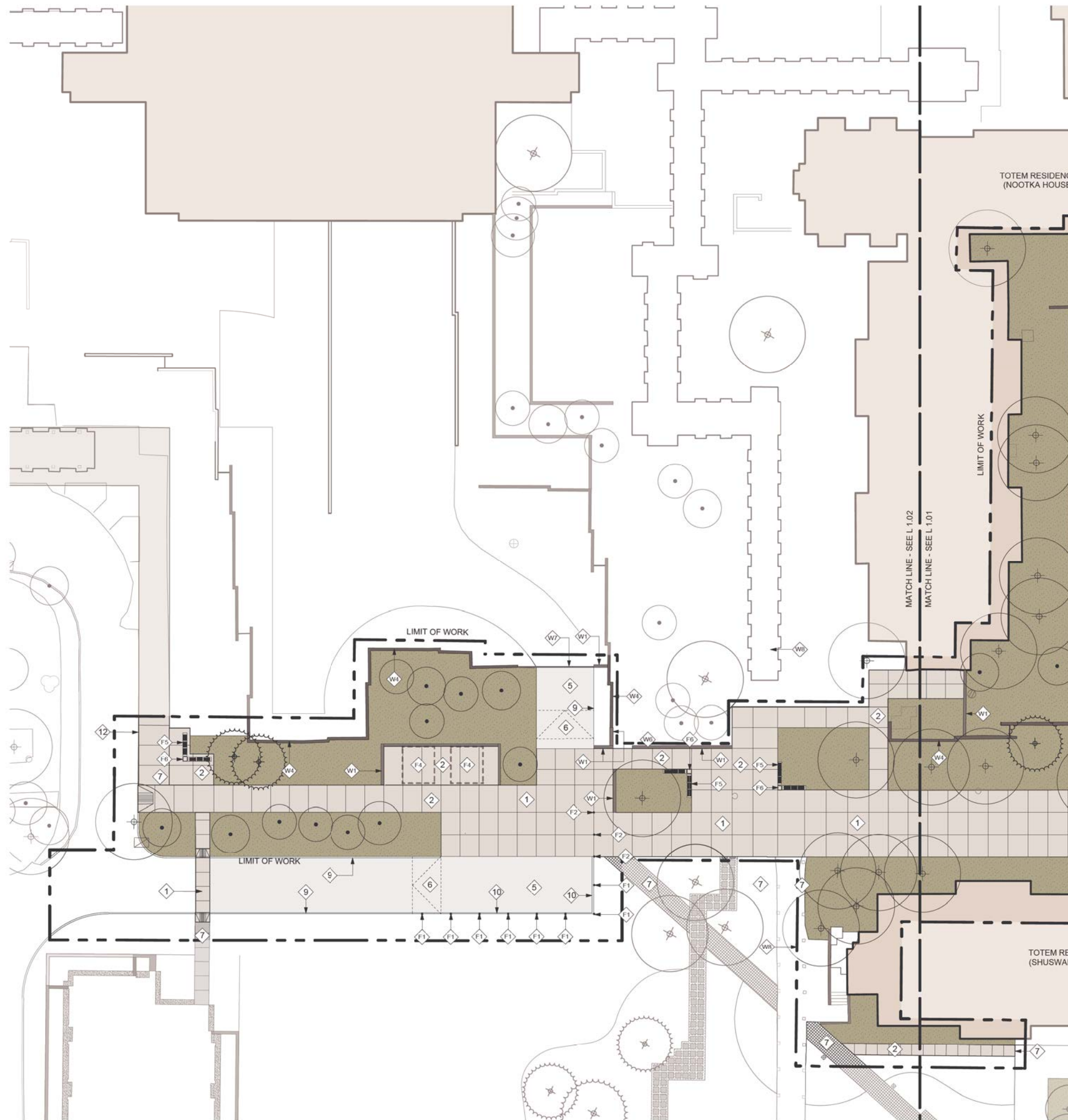

### PAVING MATERIALS

1	CAST IN PLACE CONCRETE PAVING - HEAVY DUTY FINISH: LIGHT SANDBLAST COLOUR: NATURAL CONTROL JOINT: SAWCUTS
2	CAST IN PLACE CONCRETE PAVING - LIGHT DUTY FINISH: LIGHT SANDBLAST COLOUR: NATURAL CONTROL JOINT: SAW CUT
3	EXISTING BRICK PAVING TO REMAIN • WITH ADJUSTMENTS TO EXTENT OF OPEN PLANTING AREA
4	PERMEABLE PAVING
5	ASPHALT PAVING - VEHICULAR
6	ASPHALT PAVING RAMP - VEHICULAR
7	EXISTING PAVING TO REMAIN AND BE PROTECTED
8	CONCRETE ROLLED CURB
9	CONCRETE BARRIER CURB
10	CONCRETE FLASH CURB
11	GRASS PAVERS • INSTALL AS PER MANUFACTURER'S INSTRUCTIONS
12	EXISTING CONCRETE STAIRS TO REMAIN AND BE PROTECTED
13	EXISTING CONCRETE CURB TO REMAIN AND BE PROTECTED

### SITE FURNISHINGS

F1	BOLLARD Type 1 TYPE: UBC STANDARD STATIONARY BOLLARD MODEL: SENTRY 2868 FINISH: UBC GREY HEIGHT: 42" DIAMETER: 8" MOUNTING: REMOVABLE
F2	BOLLARD Type 2 TYPE: UBC STANDARD STATIONARY BOLLARD MODEL: SENTRY 2868 FINISH: UBC GREY HEIGHT: 42" DIAMETER: 8" MOUNTING: FLUSH MOUNT CONCRETE BASE
F3	BIKE RACK • UBC STANDARD 'U'
F4	RELOCATED EXISTING BIKE SHELTER
F5	CUSTOM TOTEM BENCH • PER TOTEM INFILL (RESIDENCE)
F6	CUSTOM TOTEM METAL SIDE TABLE • PER TOTEM INFILL (RESIDENCE)

### LANDSCAPE WALLS & STRUCTURES

W1	NEW TOTEM PARK STYLE WALL • 1.2M MAX. HEIGHT, FREESTANDING, BRICK BOTH SIDES, CONCRETE CAP
W2	TOTEM PARK NAME WALL • SIGNAGE ON EXISTING WALL
W3	RESIDENCE NAME WALL • 1.2M MAX. HEIGHT, FREESTANDING, BRICK BOTH SIDES, CONCRETE CAP
W4	EXISTING LANDSCAPE WALL TO REMAIN AND BE PROTECTED
W5	GARBAGE ENCLOSURE • T.B.D.
W6	EXISTING LANDSCAPE WALL TO BE REMOVED • BRICK TO BE STORED AND REUSED ON SITE
W7	VEHICLE GATE
W8	EXISTING COLONADE TO REMAIN

#### NOTE:

NEW POLE-MOUNTED LIGHTING TO CONFORM TO UBC GUIDELINES.

#### LAYOUT AND MATERIALS GENERAL NOTES

- DO NOT SCALE DRAWING. LAYOUT AS PER DIMENSIONS NOTED ON LANDSCAPE PLANS. REPORT ANY DISCREPANCIES TO CONSULTANT FOR REVIEW AND RESPONSE PRIOR TO COMMENCING WORK.
- THE LOCATIONS OF UTILITIES SHOWN IS APPROXIMATE ONLY. THE EXACT LOCATION SHOULD BE DETERMINED BY CONSULTING THE MUNICIPAL AUTHORITIES AND UTILITY COMPANIES CONCERNED. THE CONTRACTOR SHALL PROVE THE LOCATION OF UTILITIES AND SHALL BE RESPONSIBLE FOR ADEQUATE PROTECTION FROM DAMAGE.
- CONTRACTOR SHALL MAKE GOOD ALL DAMAGES TO EXISTING FEATURES SCHEDULED TO REMAIN, TO THE SATISFACTION OF THE CONTRACT ADMINISTRATOR.
- NO STAGING OR STORAGE OF EQUIPMENT OR MATERIALS SHALL TAKE PLACE OUTSIDE OF DESIGNATED AREAS WITHOUT WRITTEN CONSENT.
- CONTRACTOR SHALL DISPOSE OF MATERIALS OFF-SITE UNLESS OTHERS NOTED.
- LANDSCAPE DRAWINGS ARE TO BE READ IN CONJUNCTION WITH SPECIFICATIONS AND THE DRAWINGS OF ALL OTHER DISCIPLINES INVOLVED.

REVISIONS AND ISSUES		
NO.	DATE	DESCRIPTION
1	2012/04/27	ISSUED FOR DP
2	2012/05/03	ISSUED FOR DP
3	2012/05/17	ISSUED TO DRC

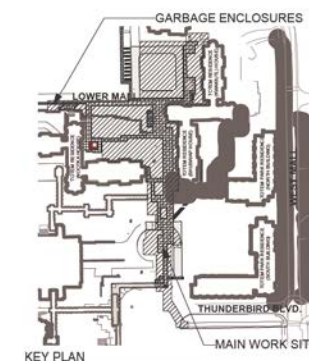

PROJECT  
**UBC Totem Planning**

DRAWING TITLE  
**Materials Plan**

Copyright: All rights reserved. Reproduction in whole or in part is prohibited. This drawing is an indication of service to the property of the Consultant and may not be used in any way without the written permission of the office.



PROJECT NO.	1216
DATE	May 17, 2012
FILE NAME	1216 TD PLAN.vwx
PLOTTED	5/17/12 at 10:39:06 PM
DRAWN	KF
REVIEWED	JW
DRAWING	

# L 1.02







REVISIONS AND ISSUES

NO.	DATE	DESCRIPTION
1	2012/05/17	ISSUED TO DRC

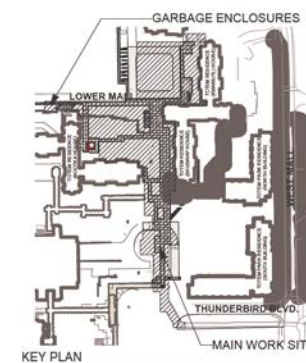
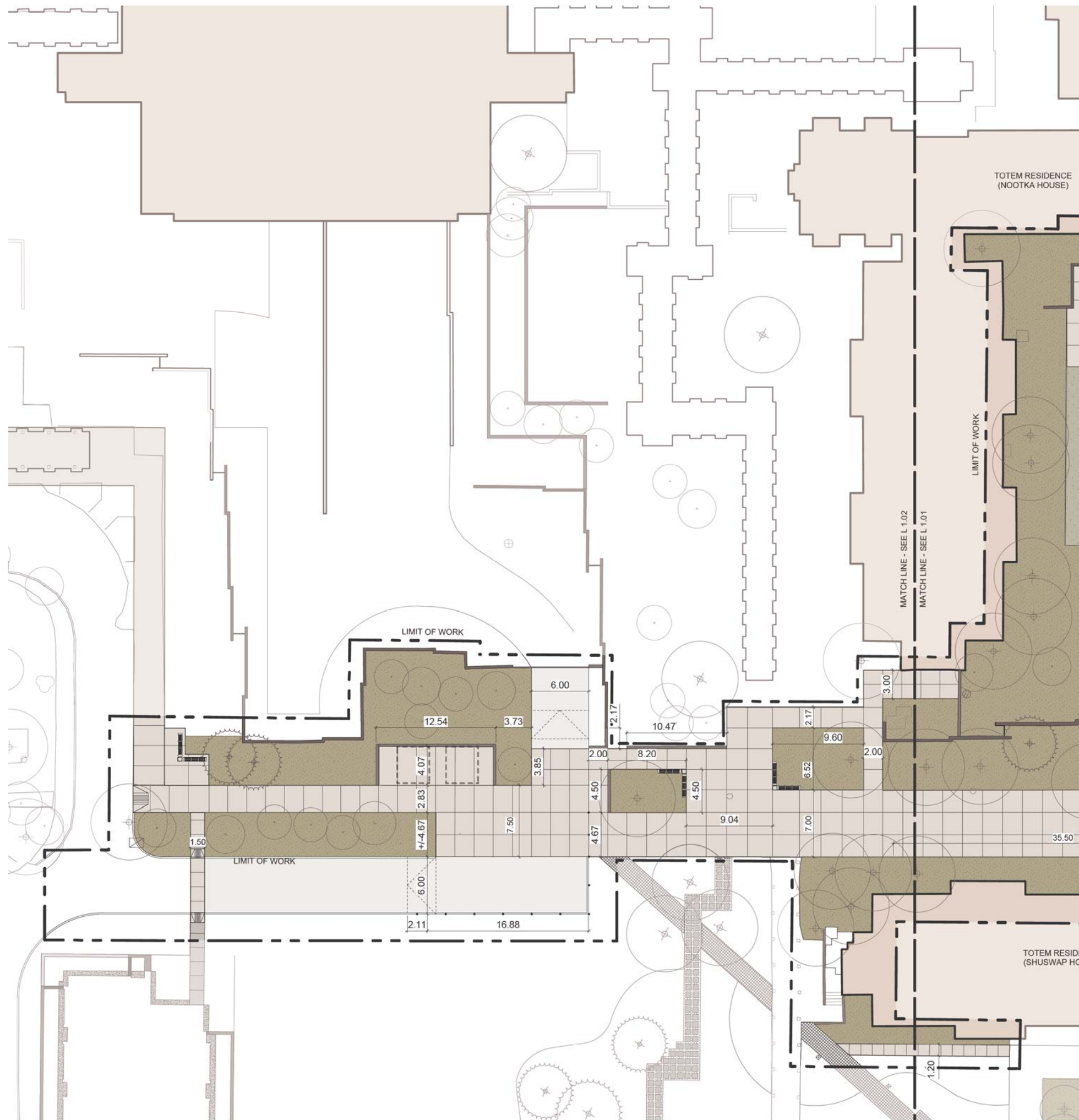

PROJECT  
**UBC Totem Planning**

DRAWING TITLE  
**Layout Plan**

Copyright: All rights reserved. Reproduction in whole or in part is prohibited. This drawing is an instrument of service in the property of the Consultant and may not be used in any way without the written permission of the office.



PROJECT NO.	1216
DATE	May 17, 2012
FILE NAME	1216 TD PLAN.vwx
PLOTTED	5/17/12 at 10:39:06 PM
DRAWN	KF
REVIEWED	JW
DRAWING	

**L 2.02**

**NOTE:**

NEW POLE-MOUNTED LIGHTING TO CONFORM TO UBC GUIDELINES.

**LAYOUT AND MATERIALS GENERAL NOTES**

- DO NOT SCALE DRAWING. LAYOUT AS PER DIMENSIONS NOTED ON LANDSCAPE PLANS. REPORT ANY DISCREPANCIES TO CONSULTANT FOR REVIEW AND RESPONSE PRIOR TO COMMENCING WORK.
- THE LOCATIONS OF UTILITIES SHOWN IS APPROXIMATE ONLY. THE EXACT LOCATION SHOULD BE DETERMINED BY CONSULTING THE MUNICIPAL AUTHORITIES AND UTILITY COMPANIES CONCERNED. THE CONTRACTOR SHALL PROVIDE THE LOCATION OF UTILITIES AND SHALL BE RESPONSIBLE FOR ADEQUATE PROTECTION FROM DAMAGE.
- CONTRACTOR SHALL MAKE GOOD ALL DAMAGES TO EXISTING FEATURES SCHEDULED TO REMAIN TO THE SATISFACTION OF THE CONTRACT ADMINISTRATOR.
- NO STAGING OR STORAGE OF EQUIPMENT OR MATERIALS SHALL TAKE PLACE OUTSIDE OF DESIGNATED AREAS WITHOUT WRITTEN CONSENT.
- CONTRACTOR SHALL DISPOSE OF MATERIALS OFF-SITE UNLESS OTHERS NOTED.
- LANDSCAPE DRAWINGS ARE TO BE READ IN CONJUNCTION WITH SPECIFICATIONS AND THE DRAWINGS OF ALL OTHER DISCIPLINES INVOLVED.



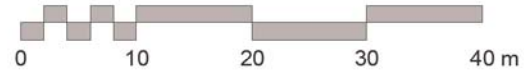
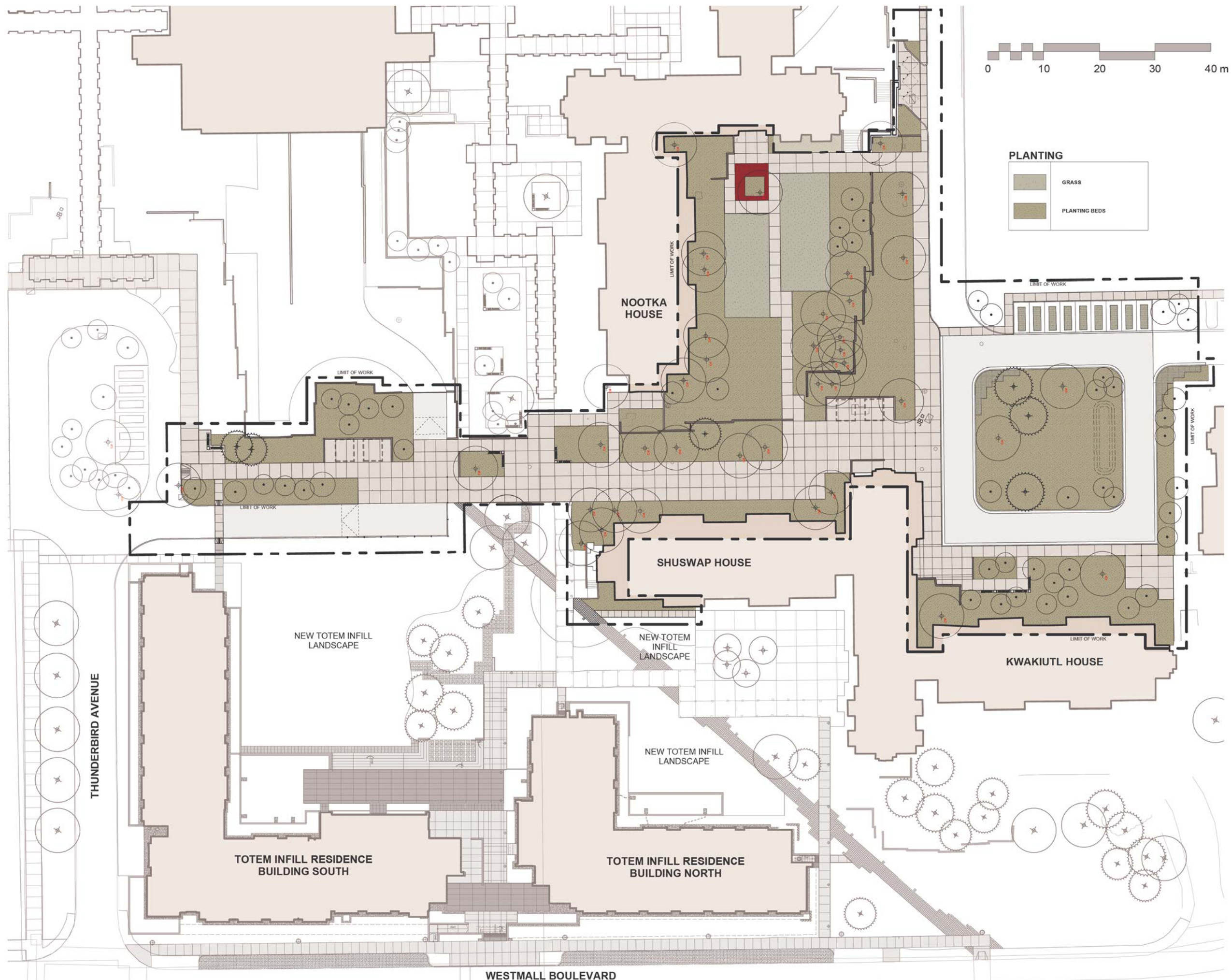

**PLANTING**

	GRASS
	PLANTING BEDS

**PWL partnership**  
 PWL Partnership Landscape Architects Inc.  
 5th Floor, East Astoria House  
 1201 West Pender Street  
 Vancouver BC Canada V6E 2V2  
 www.pwlpairtnership.com  
 T 604.688.8111  
 F 604.688.8112

REVISIONS AND ISSUES

NO.	DATE	DESCRIPTION
1	2012/04/27	ISSUED FOR DP
2	2012/05/03	ISSUED FOR DP
3	2012/05/17	ISSUED TO DRC

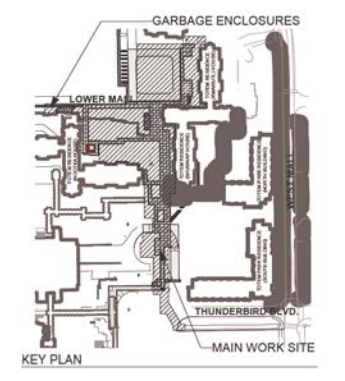

PROJECT  
**UBC Totem Planning**

DRAWING TITLE  
**Planting Plan**

Copyright: All rights reserved. Reproduction in whole or in part is prohibited. This drawing is an instrument of service and the property of the Consultant and may not be used in any way without the written permission of the office.

NORTH

SCALE  
**1:300**

PROJECT NO.	1216
DATE	May 17, 2012
FILE NAME	1216 TD PLAN.vwx
PLOTTED	5/17/12 at 10:39:06 PM
DRAWN	KF
REVIEWED	JW

DRAWING  
**L 4.01**



### Plant List

UBC Totem

ID	Botanical Name	Common Name
<b>Trees</b>		
acr	<i>Acer circinatum</i>	Vine Maple
aal	<i>Amelanchier alnifolia</i>	Saskatoon Serviceberry
crw	<i>Cornus nuttallii</i> 'Eddie's White Wonder'	Eddie's White Wonder Dogwood
pcn	<i>Pinus contorta</i>	Shore Pine
<b>Shrubs</b>		
ani	Azalea 'Northern Lights' Mix	Mixed Northern Lights Azalea
aci	Azalea 'Orchid Lights'	Orchid Lights Azalea
gsh	<i>Gaultheria shallon</i>	Salal
mac	<i>Mahonia aquifolium</i> 'Compacta'	Compact Oregon Grape
rsk	<i>Ribes sanguineum</i> 'King Edward VII'	King Edward VII Flowering Currant
rac	<i>Rosa acicularis</i>	Prickly Rose
sbt	<i>Spiraea betulifolia</i>	Birchleaf Spiraea
smo	<i>Symphoricarpos mollis</i>	Creeping Snowberry
vot	<i>Vaccinium ovatum</i> 'Thunderbird'	Thunderbird Evergreen Huckleberry
vvi	<i>Vaccinium vitis-idaea</i>	Lingonberry
<b>Ground Covers</b>		
auv	<i>Arctostaphylos uva-ursi</i>	Kinnikinnick
ac	<i>Asarum caudatum</i>	Wild Ginger
fv	<i>Fragaria vesca</i>	Woodland Strawberry
gpr	<i>Gaultheria procumbens</i>	Wintergreen
mnr	<i>Mahonia nervosa</i>	Cascade Barberry
mr	<i>Mahonia repens</i>	Creeping Mahonia
<b>Rain Garden Plant List</b>		
cac	<i>Carex caryophylleas</i> 'The Beatles'	Spring Sedge
cam	<i>Carex muskingumensis</i>	Palm Sedge
cao	<i>Carex obnupta</i>	Slough Sedge
irs	<i>Iris missouriensis</i>	Rocky Mountain Iris
jun	<i>Juncus effusus</i>	Common Rush
<b>Plant List-Perennials/Ferns/Groundcover/Grasses</b>		
ati	<i>Achlys triphylla</i>	Vanilla Leaf
aff	<i>Aquilegia formosa</i>	Red Columbine
am	<i>Armeria maritima</i>	Common Thrift
bsp	<i>Blechnum spicant</i>	Deer Fern
df	<i>Dicentra formosa</i>	Native Bleeding Heart
dh	<i>Doedecatheon hendersonii</i>	Shooting Star
irs	<i>Iris missouriensis</i>	Rocky Mountain Iris
lb	<i>Linnaea borealis</i>	Twinflower
mar	<i>Maianthemum racemosa</i>	False Solomon's Seal
pm	<i>Polystichum munitum</i>	Western Sword Fern
pv	<i>Prunella vulgaris</i>	Self Heal
rf	<i>Rudbeckia fulgida</i>	Black-Eyed Susan
sb	<i>Stipa brachytricha</i>	Korean Feather Reed Grass
tt	<i>Tiarella trifoliata</i>	Foamflower
v	<i>Viola sempervirens</i>	Evergreen Violet

### TREES

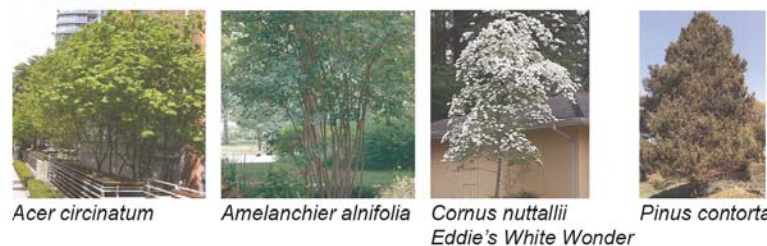

*Acer circinatum*    *Amelanchier alnifolia*    *Cornus nuttallii* 'Eddie's White Wonder'    *Pinus contorta*

### SHRUBS



*Azalea* 'Northern Lights'    *Azalea* 'Orchid Lights'    *Gaultheria shallon*    *Mahonia aquifolium* 'Compacta'

### GROUND COVERS



*Arctostaphylos uva-ursi*    *Asarum caudatum*    *Fragaria vesca*



*Gaultheria procumbens*    *Mahonia nervosa*    *Mahonia repens*

### RAIN GARDEN



*Carex caryophylleas* 'The Beatles'    *Carex muskingumensis*    *Carex obnupta*



*Iris missouriensis*    *Juncus effusus*



*Ribes sanguineum* 'King Edward VII'    *Rosa acicularis*    *Spiraea betulifolia*    *Symphoricarpos mollis*



*Vaccinium ovatum* 'Thunderbird'    *Vaccinium vitis-idaea*

### PERENNIALS/ FERNS/ GROUND COVERS/ GRASSES



*Achlys triphylla*    *Aquilegia formosa*    *Armeria maritima*    *Blechnum spicant*    *Dicentra formosa*    *Doedecatheon hendersonii*    *Iris missouriensis*    *Linnaea borealis*



*Maianthemum racemosa*    *Polystichum munitum*    *Prunella vulgaris*    *Rudbeckia fulgida*    *Stipa brachytricha*    *Tiarella trifoliata*    *Viola sempervirens*

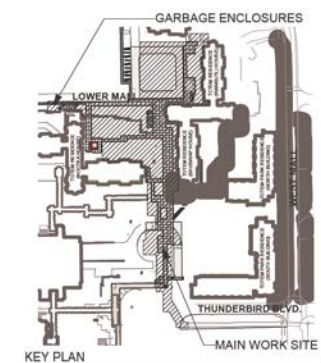

KEY PLAN

PROJECT  
**UBC Totem Planning**

DRAWING TITLE  
**Plant List**

Copyright: All rights reserved. Reproduction in whole or in part is prohibited. This drawing is an instrument of service and the property of the Consultant and may not be used in any way without the written permission of the office.

SCALE

PROJECT NO. 1216  
 DATE May 17, 2012  
 FILE NAME 1216 TD PLAN.vwx  
 PLOTTED 5/17/12 at 10:39:06 PM  
 DRAWN KF REVIEWED JW

DRAWING  
**L 4.02**



REVISIONS AND ISSUES		
NO.	DATE	DESCRIPTION
1	2012/05/17	ISSUED TO DRC

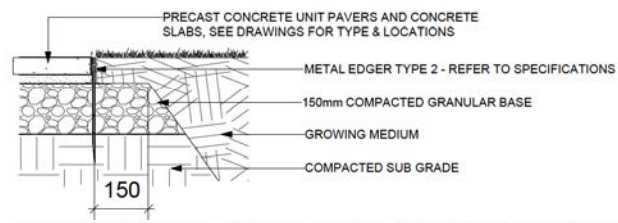

NOTE: USE METAL EDGER ALONG ALL PRECAST UNIT PAVING AND CONCRETE SLABS, EXCEPT WHERE BOUNDED BY CAST IN PLACE CONCRETE PAVING, WALLS, BUILDING OR CURBS.

1 Edger at Precast Concrete Unit Pavers/Concrete Slabs  
1:10

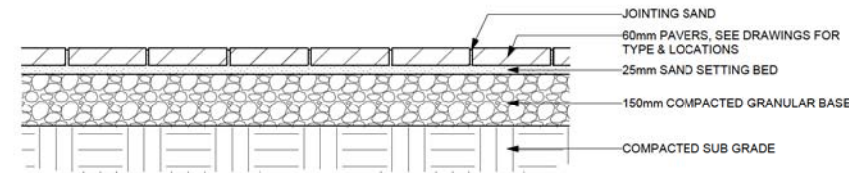

2 Precast Concrete Unit Pavers on Grade  
1:10

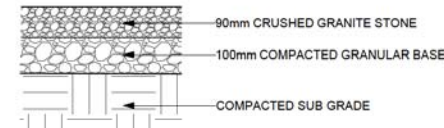

4 Crushed Granite Paving on Grade  
1:10

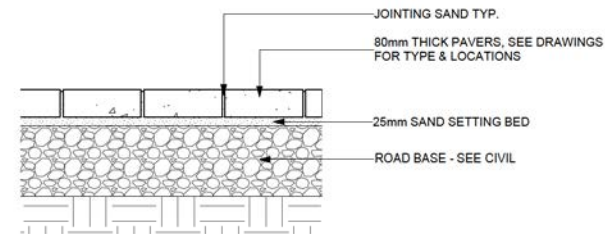

5 Precast Concrete Unit Pavers on Grade - Vehicular  
1:10

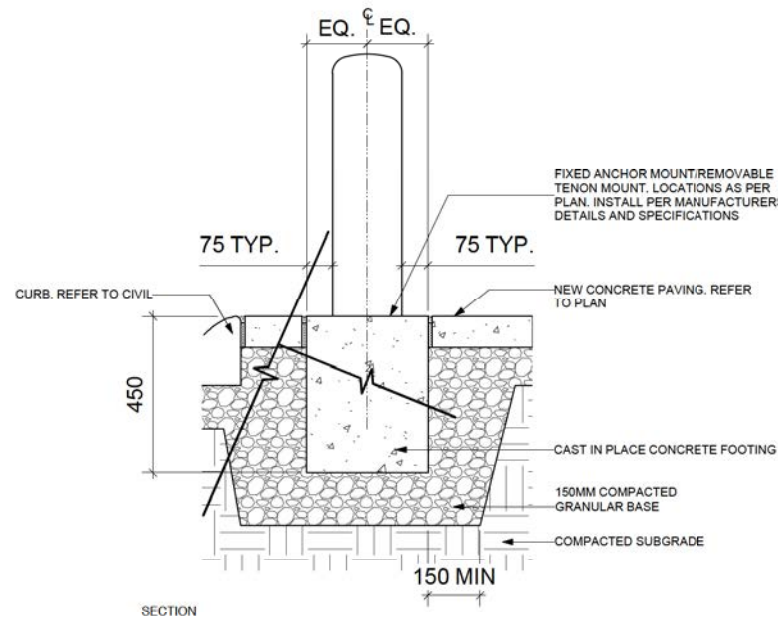

6 Bollard Footing  
1:10

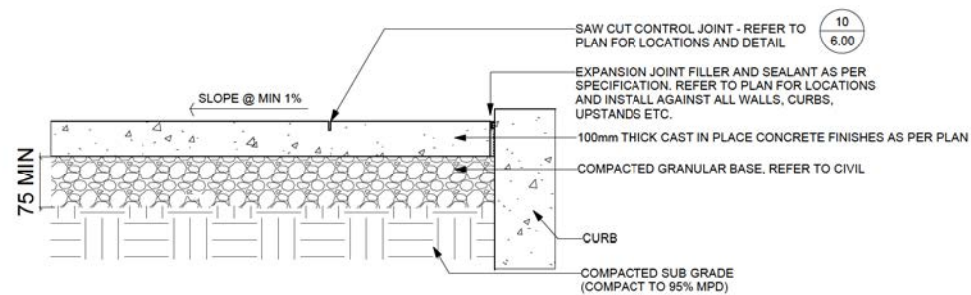
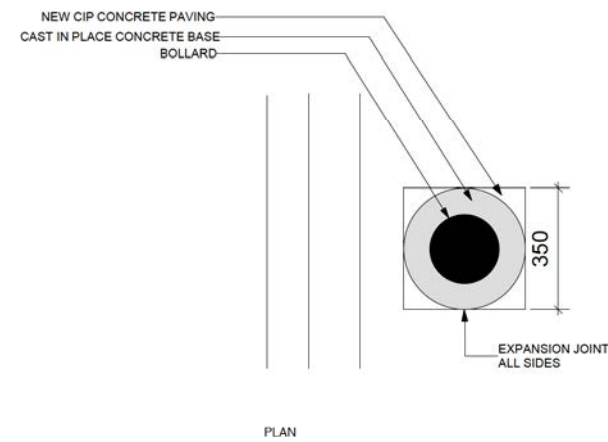

9 CIP Concrete Slab - Light Duty  
1:10

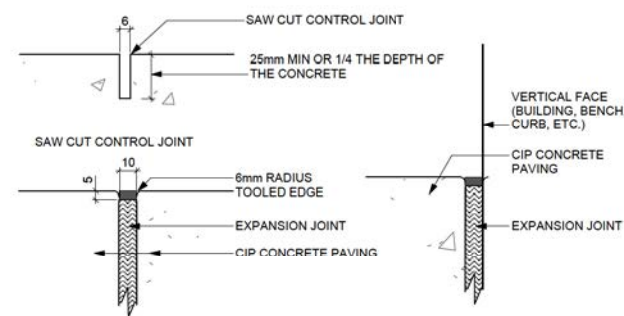

NOTE:  
1. EXPANSION JOINT: W.R. MEADOWS ECO-JOINT 9780-458-8773) OR PRE-APPROVED EQUAL

10 Saw Cut and Expansion Joints  
1:2

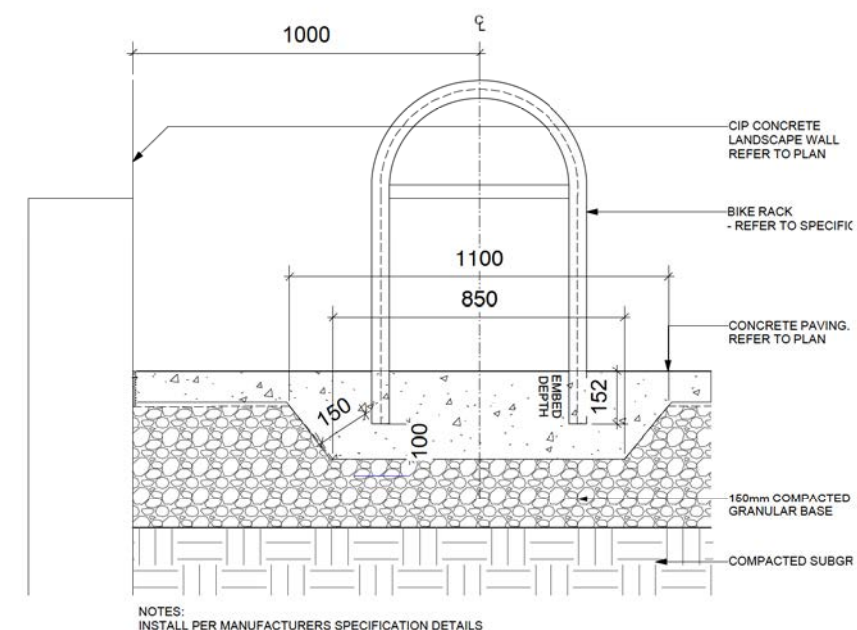

7 Bicycle Rack  
1:10

PROJECT  
**UBC TOTEM MASTER PLAN  
 PHASE 1 CONSTRUCTION**

DRAWING TITLE  
**Details**

Copyright. All rights reserved. Reproduction in whole or in part is prohibited. This drawing is an instrument of service in the property of the Consultant and may not be used in any way without the written permission of this office.

NORTH	SCALE
<b>AS SHOWN</b>	
PROJECT NO.	1216
DATE	MAY 2012
FILE NAME	1216 TD Details.vwx
PLOTTED	5/17/12 at 4:19:53 PM
DRAWN	TH & SM
REVIEWED	JW

**L5.01**



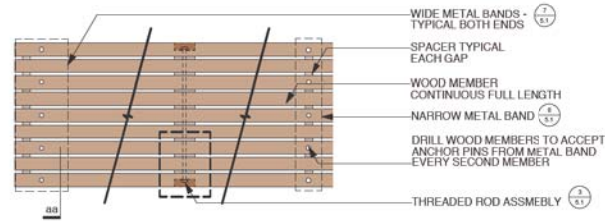

2 WOOD SEATING SLAT ASSEMBLY  
1:10

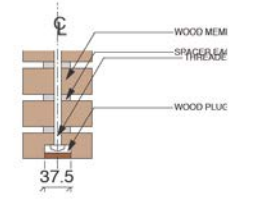

3 THREADED ROD VERTICAL SECTION  
1:5

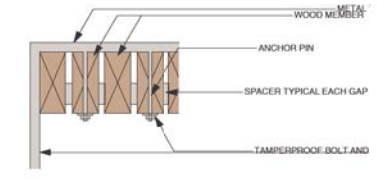

4 SECTION : aa  
1:5

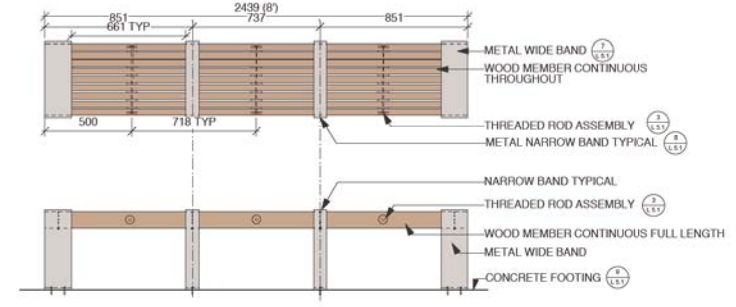

1 BENCH TYPE "A"  
1:20

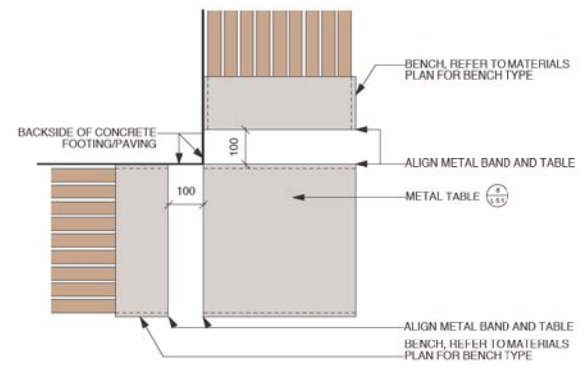

5 ANGLED SEATING LAYOUT WITH METAL TABLE  
1:10

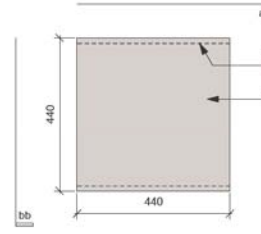

6 METAL TABLE  
1:10

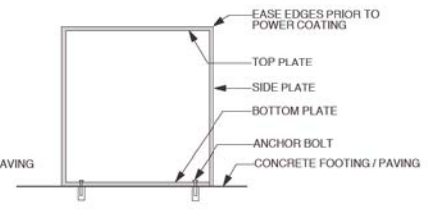
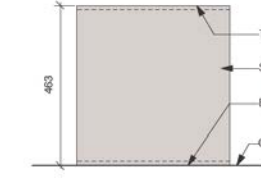
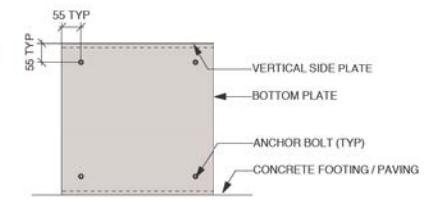

- NOTES:**
- CONTRACTOR TO PROVIDE ENGINEER STAMPED SHOP DRAWINGS OF ALL ELEMENTS REQUIRED TO COMPLETE THIS ELEMENT (TABLE, BENCH, FOOTING ETC.)
  - ALL WOOD MEMBERS TO BE 38 X 89mm UNTREATED IPE.
  - WOOD PLUG TO BE IPE.
  - USE METAL GALVANIZED SHIMS TO ENSURE TABLE AND BENCHES ARE LEVEL IN ALL DIRECTIONS
  - THREADED STEEL ROD TO BE 13mm (1/2") HOT DIPPED GALVANIZED
  - ALL FASTENERS TO BE HOT DIPPED GALVANIZED TAMPERPROOF
  - METAL BANDS : 12.5mm (1/2") THICK PLATE STEEL  
PREDRILL ALL HOLES AND COMPLETE ALL ASSEMBLY PRIOR TO FINISH / POWDER COAT  
GRIND ALL WELDS SMOOTH  
ALL CORNERS TO BE CLEAN 90 DEGREE ANGLES, EASE OUTSIDE EDGES  
FINISH : POWDER COAT UBC GREY (RAL 7043)
  - METAL ANCHOR PINS - GALVANIZED TAMPERPROOF
  - METAL ANGLES : 75mm x 50mm x 9mm (3" x 2" x 3/8")
  - METAL VERTICAL SUPPORT : 100mm x 50mm x 6mm (4" x 2" x 1/4")
  - METAL CHANNEL : 200mm x 57mm x 6mm (8" x 2 1/4" x 1/4")
  - METAL VERTICAL SPACER TAB : 10mm (3/8") THICK
  - METAL SPACERS TO BE 10mm (3/8") HOT DIPPED GALVANIZED.
  - PREPARE MOCK UPS OF EACH COMPONENT (COMPLETE WITH WOOD MEMBERS IN PLACE) FOR REVIEW PRIOR TO FABRICATION OF ALL REMAINING PARTS
  - ALL WELDS NOT IDENTIFIED TO BE GROUND SMOOTH ARE TO BE HIGH QUALITY UNIFORM BEAD. ELEMENTS WITH POOR OR IRREGULAR WELD BEAD MAY BE REJECTED

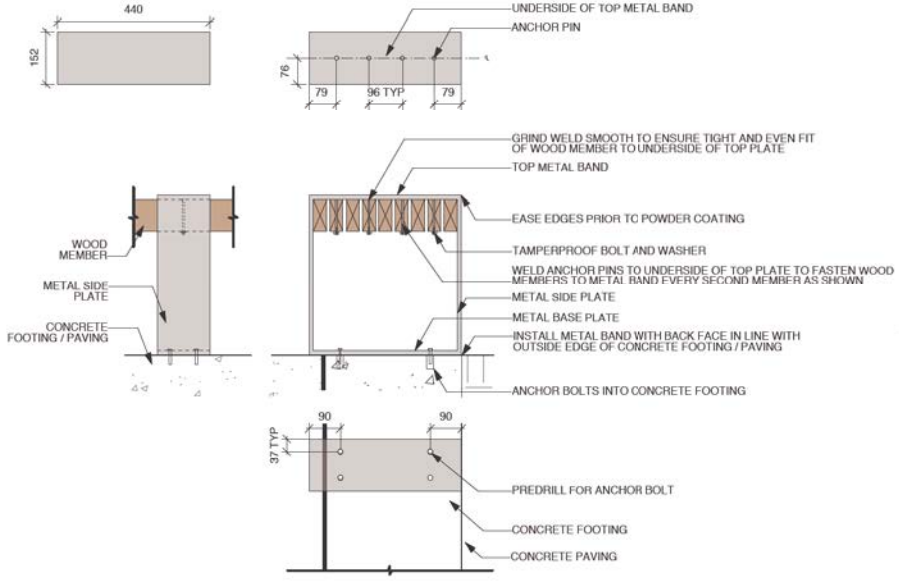

7 TYPICAL WIDE METAL BAND  
1:5

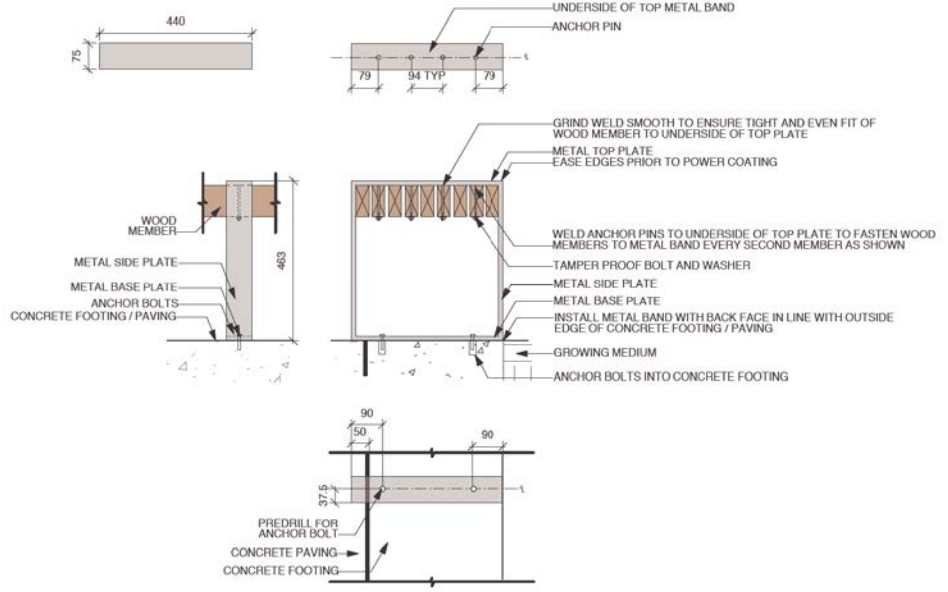

8 TYPICAL NARROW METAL BAND  
1:5

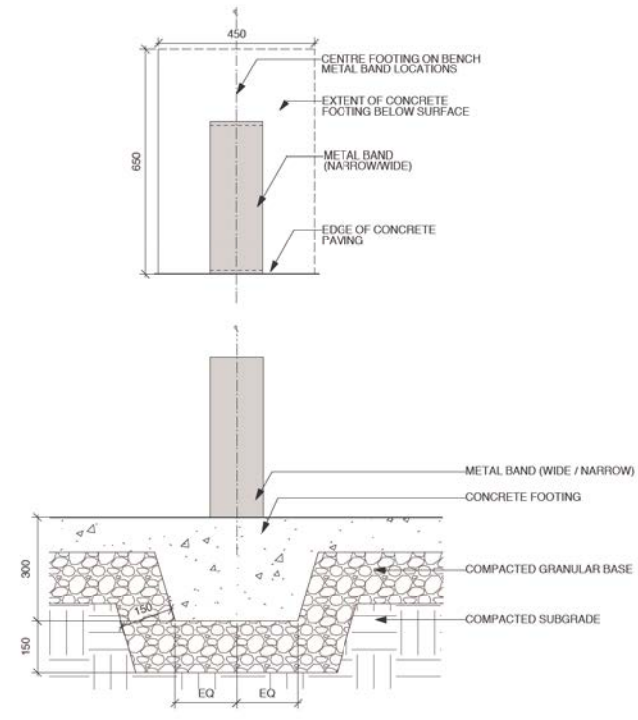

9 CONCRETE FOOTING AT BENCH METAL BANDS  
1:10

NO.	DATE	DESCRIPTION
1	2012/05/17	ISSUED TO DRC

PROJECT  
**UBC TOTEM MASTER PLAN  
PHASE 1 CONSTRUCTION**

DRAWING TITLE  
**Details**

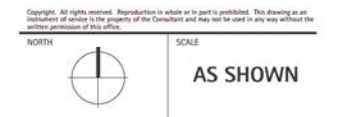

PROJECT NO.	1216
DATE	MAY 2013
FILE NAME	1216 TD Details.vwx
PLOTTED	5/17/12 at 4:19:53 PM
DRAWN	TH & SM
REVIEWED	JW

**L5.02**



REVISIONS AND ISSUES		
NO.	DATE	DESCRIPTION
1	2012/05/17	ISSUED TO DRC

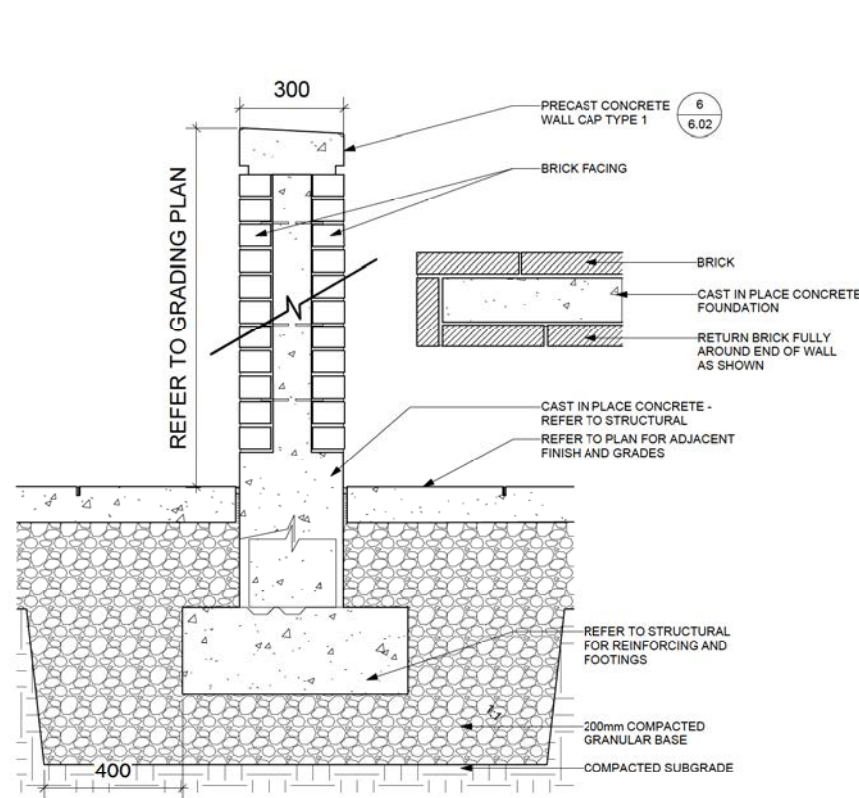

- NOTES:
1. EXPANSION JOINTS TO BE PROVIDED AT WALL/POUR INTERSECTIONS
  2. SAWCUT CONTROL JOINTS MAXIMUM 2500mm OC SPACING
  3. DAMP PROOFING: AQUASEAL ECOFLEX RUBBAR WATERPROOFING MEMBRANE (1-800-282-3681) OR PREAPPROVED EQUAL
  4. REFER TO STRUCTURAL FOR REINFORCING AND FOOTING DESIGN
  5. REFER TO ARCHITECTURAL FOR BRICK TYPE AND SIZE
  6. REFER TO ARCHITECTURAL AND STRUCTURAL FOR ALL BRICK INSTALLATION DETAILS INCLUDING LAYOUT/PATTERN, DRAIN/WEEP HOLES, TIE BACKS, ETC.

1 NEW TOTEM PARK FREE STANDING WALL BRICK FACED TWO SIDES  
 1:10

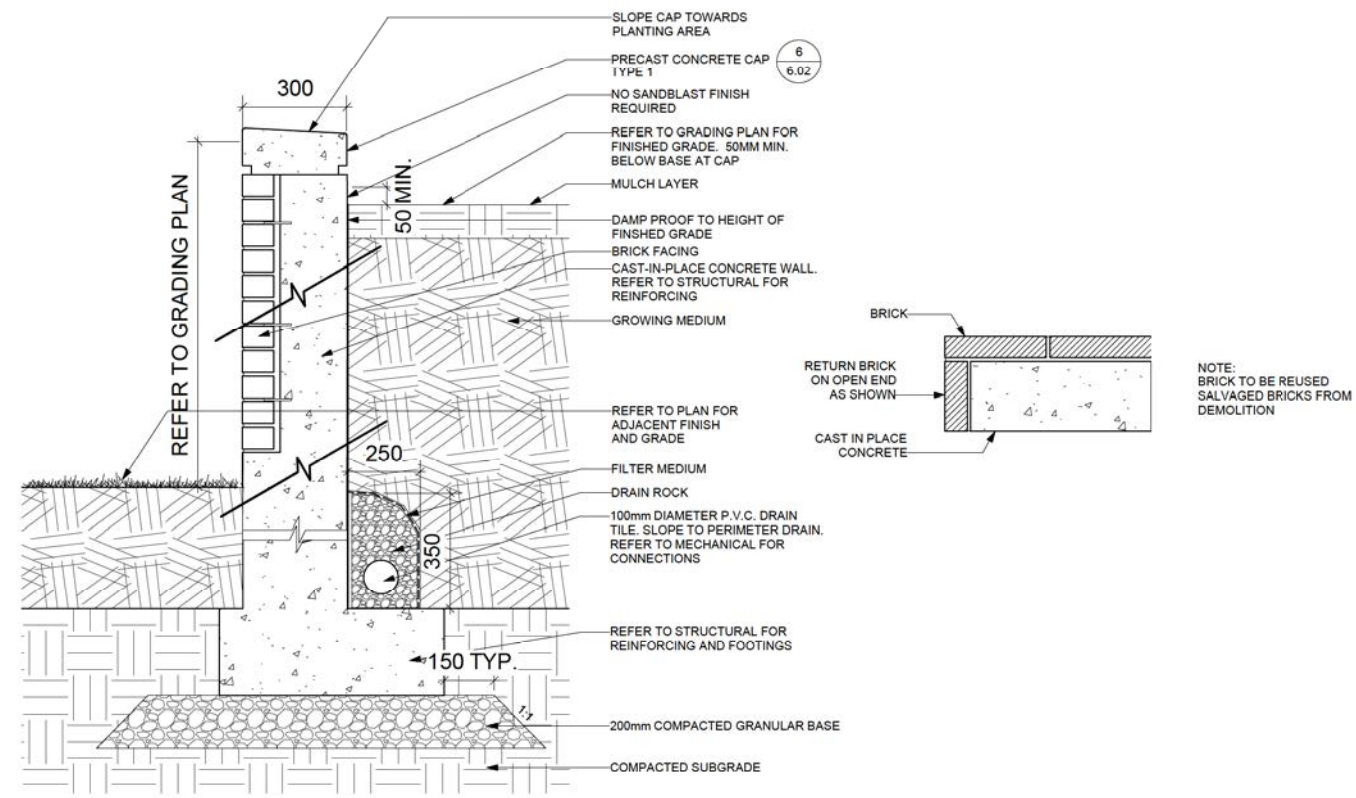

- NOTES:
1. EXPANSION JOINTS TO BE PROVIDED AT WALL/POUR INTERSECTIONS
  2. SAWCUT CONTROL JOINTS MAXIMUM 2500mm OC SPACING
  3. DAMP PROOFING: AQUASEAL ECOFLEX RUBBAR WATERPROOFING MEMBRANE (1-800-282-3681) OR PREAPPROVED EQUAL
  4. REFER TO STRUCTURAL FOR REINFORCING AND FOOTING DESIGN
  5. REFER TO ARCHITECTURAL FOR BRICK TYPE AND SIZE
  6. REFER TO ARCHITECTURAL AND STRUCTURAL FOR ALL BRICK INSTALLATION DETAILS INCLUDING LAYOUT/PATTERN, DRAIN/WEEP HOLES, TIE BACKS, ETC.

2 NEW TOTEM PARK RETAINING WALL BRICK FACED ONE SIDE  
 1:10

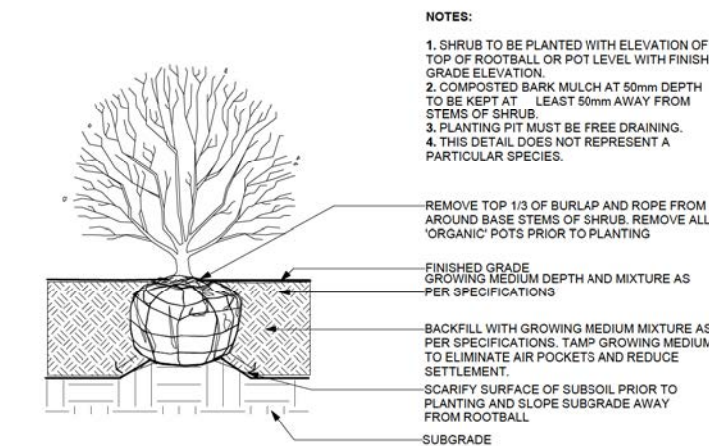

- NOTES:
1. SHRUB TO BE PLANTED WITH ELEVATION OF TOP OF ROOTBALL OR POT LEVEL WITH FINISH GRADE ELEVATION.
  2. COMPOSTED BARK MULCH AT 50mm DEPTH TO BE KEPT AT LEAST 50mm AWAY FROM STEMS OF SHRUB.
  3. PLANTING PIT MUST BE FREE DRAINING.
  4. THIS DETAIL DOES NOT REPRESENT A PARTICULAR SPECIES.

- REMOVE TOP 1/3 OF BURLAP AND ROPE FROM AROUND BASE STEMS OF SHRUB. REMOVE ALL 'ORGANIC' POTS PRIOR TO PLANTING
- FINISHED GRADE
- GROWING MEDIUM DEPTH AND MIXTURE AS PER SPECIFICATIONS
- BACKFILL WITH GROWING MEDIUM MIXTURE AS PER SPECIFICATIONS. TAMP GROWING MEDIUM TO ELIMINATE AIR POCKETS AND REDUCE SETTLEMENT.
- SCARIFY SURFACE OF SUBSOIL PRIOR TO PLANTING AND SLOPE SUBGRADE AWAY FROM ROOTBALL
- SUBGRADE

3 SHRUB PLANTING  
 1:10

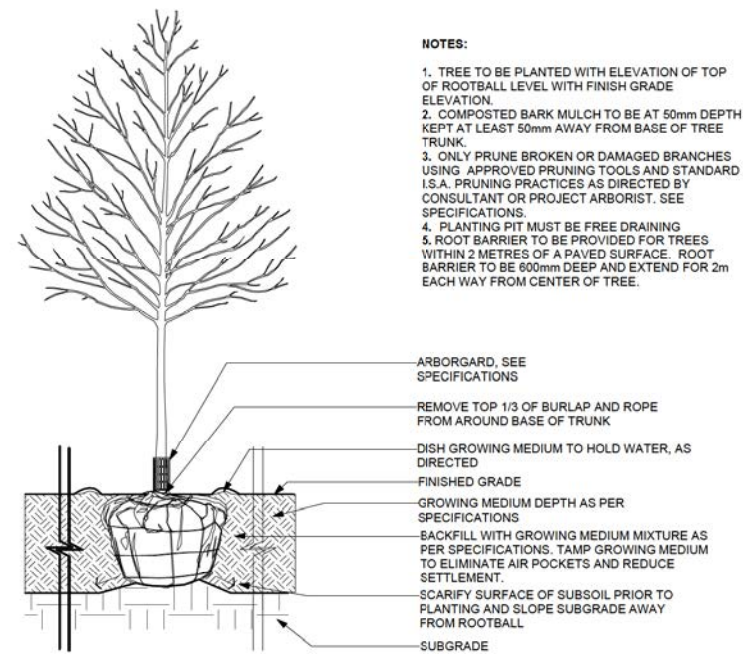

- NOTES:
1. TREE TO BE PLANTED WITH ELEVATION OF TOP OF ROOTBALL LEVEL WITH FINISH GRADE ELEVATION.
  2. COMPOSTED BARK MULCH TO BE AT 50mm DEPTH KEPT AT LEAST 50mm AWAY FROM BASE OF TREE TRUNK.
  3. ONLY PRUNE BROKEN OR DAMAGED BRANCHES USING APPROVED PRUNING TOOLS AND STANDARD I.S.A. PRUNING PRACTICES AS DIRECTED BY CONSULTANT OR PROJECT ARBORIST. SEE SPECIFICATIONS.
  4. PLANTING PIT MUST BE FREE DRAINING
  5. ROOT BARRIER TO BE PROVIDED FOR TREES WITHIN 2 METRES OF A PAVED SURFACE. ROOT BARRIER TO BE 600mm DEEP AND EXTEND FOR 2m EACH WAY FROM CENTER OF TREE.

- ARBORGARD, SEE SPECIFICATIONS
- REMOVE TOP 1/3 OF BURLAP AND ROPE FROM AROUND BASE OF TRUNK
- DISH GROWING MEDIUM TO HOLD WATER, AS DIRECTED
- FINISHED GRADE
- GROWING MEDIUM DEPTH AS PER SPECIFICATIONS
- BACKFILL WITH GROWING MEDIUM MIXTURE AS PER SPECIFICATIONS. TAMP GROWING MEDIUM TO ELIMINATE AIR POCKETS AND REDUCE SETTLEMENT.
- SCARIFY SURFACE OF SUBSOIL PRIOR TO PLANTING AND SLOPE SUBGRADE AWAY FROM ROOTBALL
- SUBGRADE

4 TREE PLANTING  
 1:10

PROJECT  
**UBC TOTEM MASTER PLAN  
 PHASE 1 CONSTRUCTION**

DRAWING TITLE  
**Details**

Copyright. All rights reserved. Reproduction in whole or in part is prohibited. This drawing is an instrument of service in the property of the Consultant and may not be used in any way without the written permission of this office.

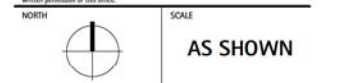

PROJECT NO.	1216
DATE	MAY 2012
FILE NAME	1216 TD Details.vwx
PLOTTED	5/17/12 at 4:19:53 PM
DRAWN	TH Ex SM
REVIEWED	JW

DRAWING  
**L5.03**