



**LEGEND**

1 L5.0	Concrete Walkway with Vehicular Access	13 L5.1	Pole Light
2 L5.0	Concrete Walkway Pedestrian Access	14 L5.2	Bike Rack
3 L5.0	Concrete Unit Pavers with Concrete Curb	15 L5.2	Trash Receptacle
4 L5.0	Play Surfacing with Concrete Curb	16 L5.2	Shrub and Ground Cover Planting
5 L5.0	Gravel Pathway	17 L5.2	Community Garden Planter Type 1
6 L5.0	Tree Planting	18 L5.2	Community Garden Planter Type 2
7 L5.0	Granite Faced Signage Wall	20 L5.2	Community Garden Compost Bin
8 L5.1	Concrete Water Channel	21 L5.2	Community Garden Fence
9 L5.1	Wood Pedestrian Bridge	22 L5.3	Play Structure 1
10 L5.1	Concrete Pedestrian Bridge	23 L5.3	Play Structure 2
11 L5.1	Bollard Light	24 L5.3	Play Structure 3
12 L5.1	Frances Andrew Bench		

**P+A**  
 Landscape Architecture  
 Site Planning  
 R. Kim Perry & Associates Inc.  
 200 - 1558 W 6th Avenue  
 Vancouver, BC V6J 1R2  
 T 604 738 4118  
 F 604 738 4116  
 www.perryandassociates.ca

2 Issued for DRC Review 09/08/2017  
 1 Issued for Development Permit 03/28/2017  
 Revision No. Date

**COPYRIGHT RESERVED**  
 This drawing is and shall remain the property of R. Kim Perry & Associates Inc., and R. Kim Perry & Associates Inc. shall retain the copyright therein. This document shall not be reproduced or used for additions or alterations to the project or for the purpose of any other project without the prior written consent of R. Kim Perry & Associates Inc.

Client:  
**UBC Properties Trust**

Project Title:  
**UBC SC Research Park**

Drawing Title:  
**Preliminary Concept Plan**

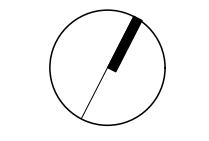
Project North:  Drawn By: JG  
 Checked By: MP  
 Scale: 1:500 Job No.: 16-043  
 Sheet No.:

**L1.0**



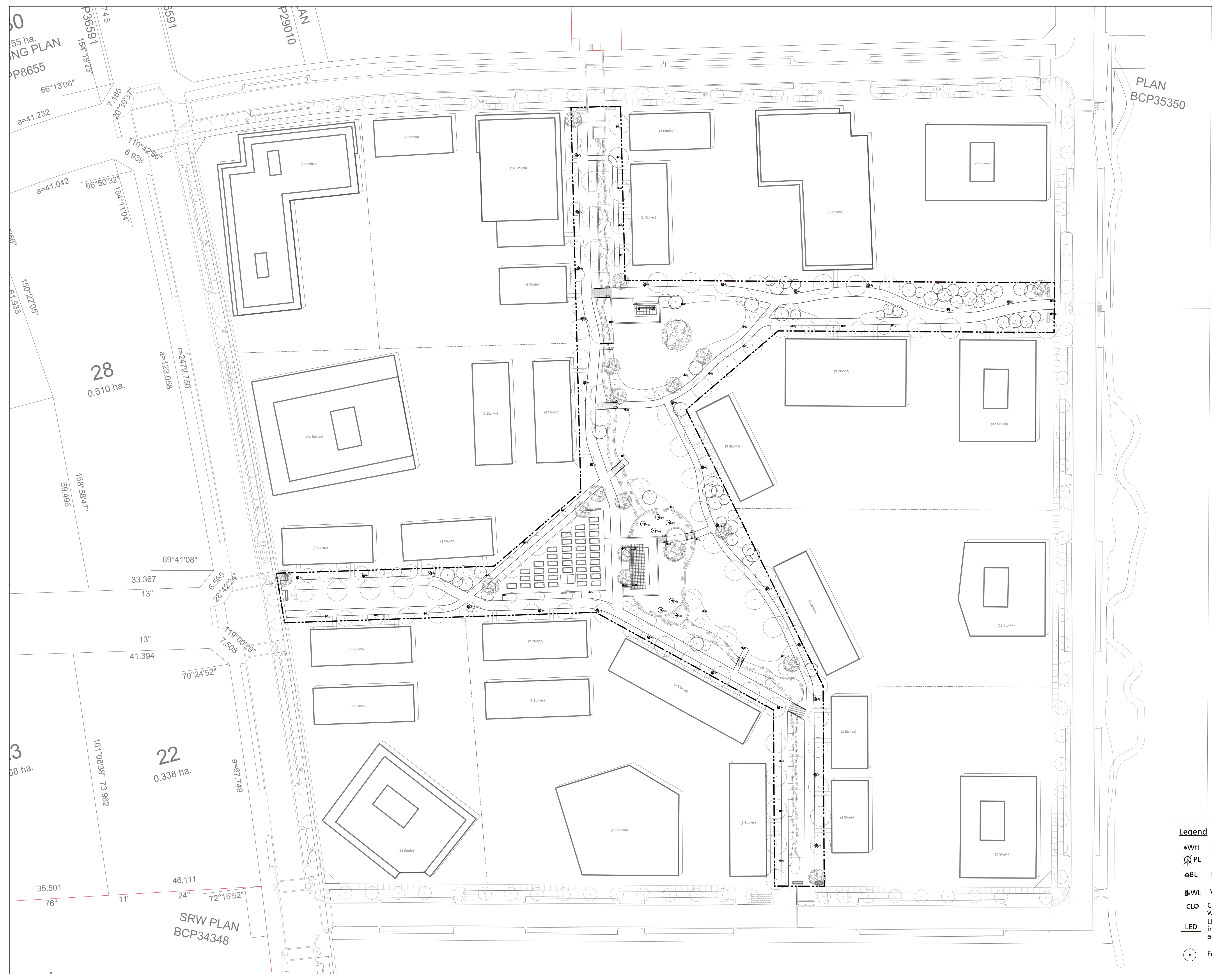

PLAN  
BCP35350

2	Issued for DRC Review	09/08/2017
1	Issued for Development Permit	03/28/2017
Revision No.		Date

COPYRIGHT RESERVED  
 This drawing is and shall remain the property of R. Kim Perry & Associates Inc., and R. Kim Perry & Associates Inc. shall retain the copyright therein. This document shall not be reproduced or used for additions or alterations to the project or for the purpose of any other project without the prior written consent of R. Kim Perry & Associates Inc.

Client:  
**UBC Properties Trust**

Project Title:  
**UBC SC Research Park**

Drawing Title:  
**Lighting Plan**

- Legend**
- Wfl Bubbler up light
  - ⊙PL Post-top light
  - ◆BL Bollard light
  - ▬WL Wall light
  - CLO Column light wall sconce (up & down)
  - LED LED strip light in concrete benches and bridge bull rails
  - ⊙ Fountain bubbler

Project North:	Drawn By:	JG
	Checked By:	MP
Scale:	Job No.:	16-043
Sheet No.:		

**L1.1**



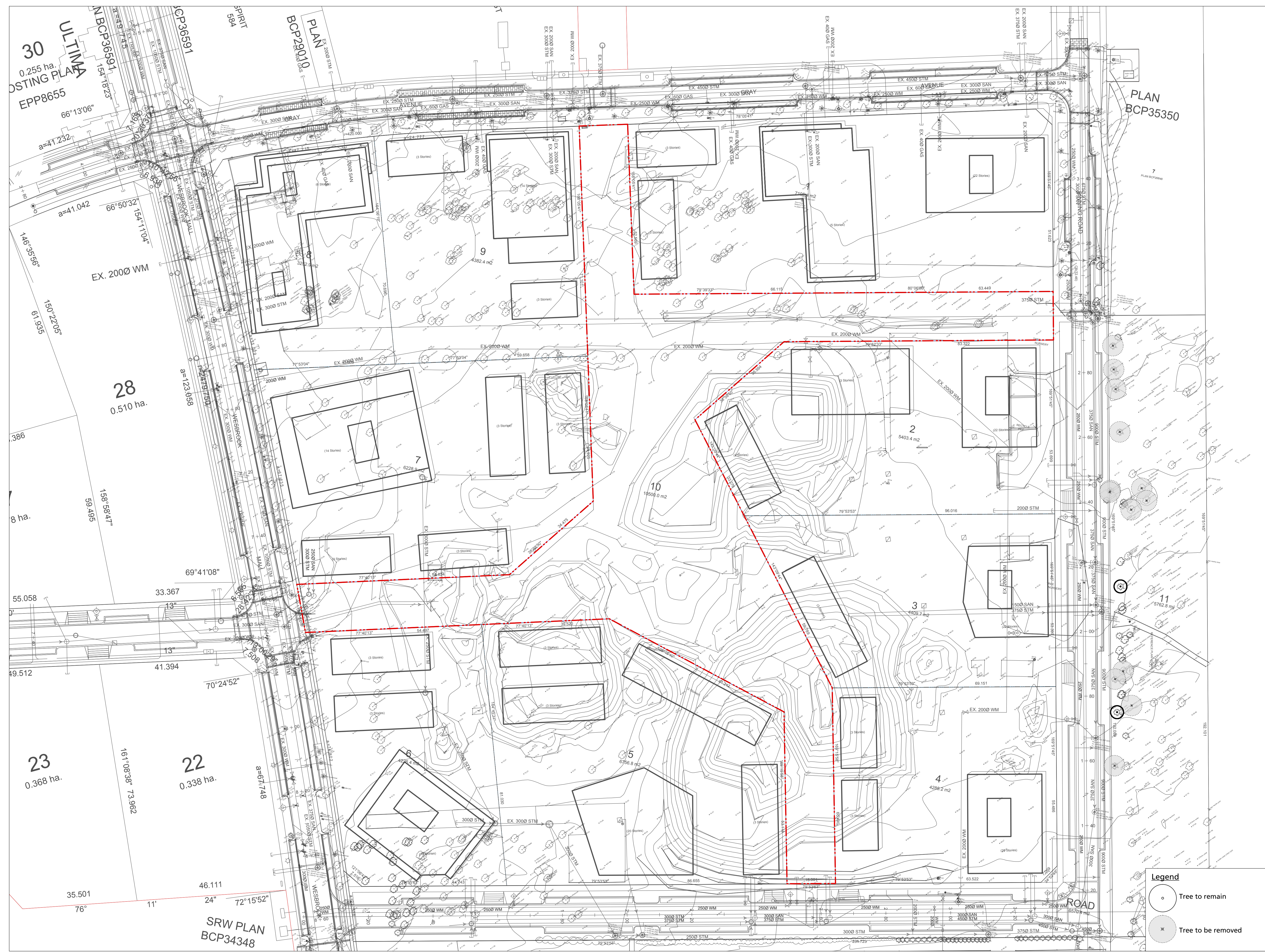

2	Issued for DRC Review	09/08/2017
1	Issued for Development Permit	03/28/2017
Revision No.		Date

**COPYRIGHT RESERVED**  
 This drawing is and shall remain the property of R. Kim Perry & Associates Inc., and R. Kim Perry & Associates Inc. shall retain the copyright therein. This document shall not be reproduced or used for additions or alterations to the project or for the purpose of any other project without the prior written consent of R. Kim Perry & Associates Inc.

Client:  
**UBC Properties Trust**

Project Title:  
**UBC SC Research Park**

Drawing Title:  
**Tree Removal Plan**

Project North:	Drawn By:	JG
	Checked By:	MP
Scale:	Job No.:	1500 16-043
Sheet No.:		

**Legend**

- Tree to remain
- Tree to be removed



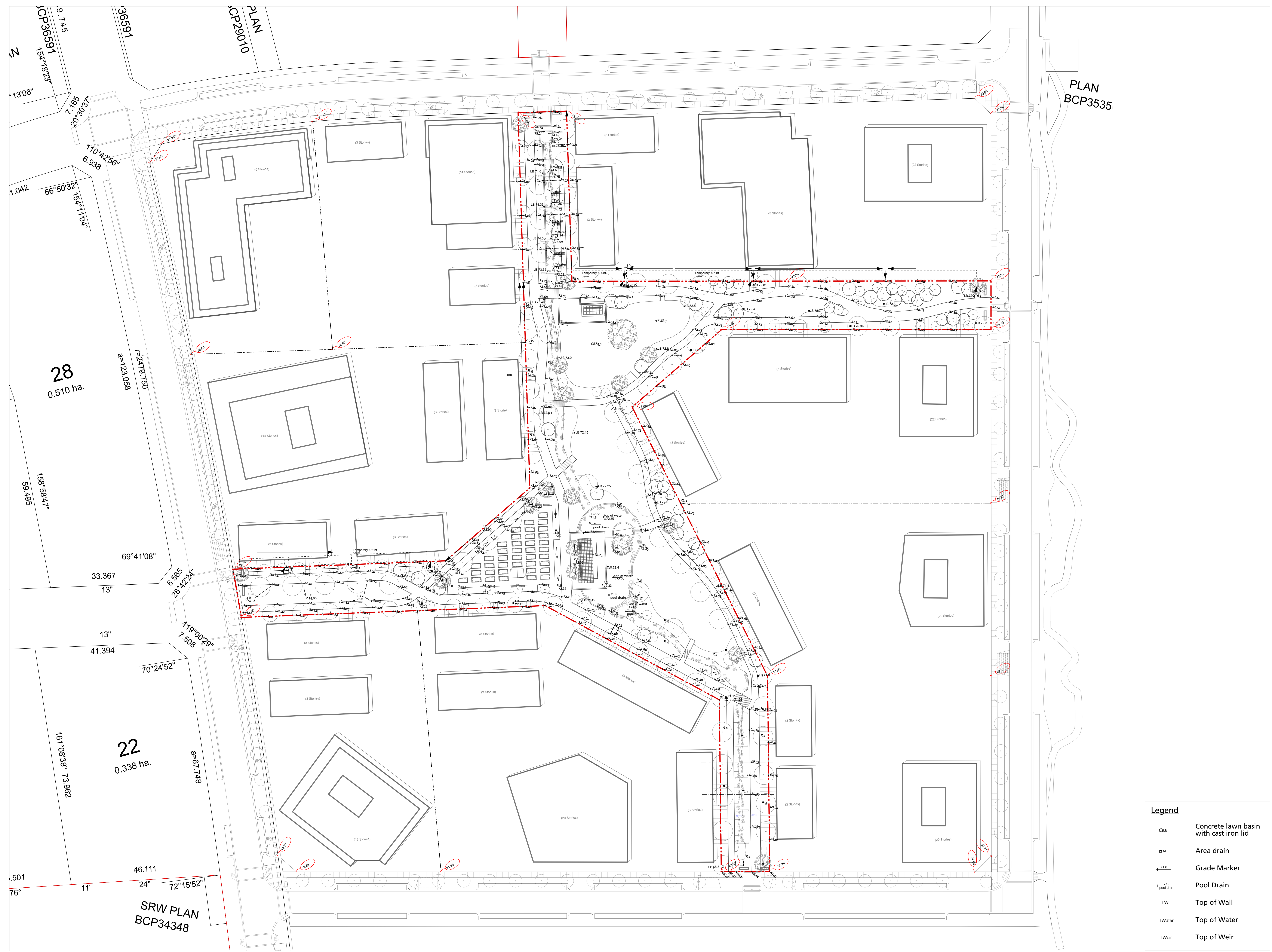

PLAN  
BCP3535

28  
0.510 ha.

1=2473.750  
a=123.058

33.367  
13"

6.565  
28°42'24"

13"  
41.394

70°24'52"

a=67.748

46.111  
24"

72°15'52"

SRW PLAN  
BCP34348

2	Issued for DRC Review	09/08/2017
1	Issued for Development Permit	03/28/2017
Revision No.		Date

**COPYRIGHT RESERVED**  
 This drawing is and shall remain the property of R. Kim Perry & Associates Inc., and R. Kim Perry & Associates Inc. shall retain the copyright therein. This document shall not be reproduced or used for additions or alterations to the project or for the purpose of any other project without the prior written consent of R. Kim Perry & Associates Inc.

Client:  
**UBC Properties Trust**

Project Title:  
**UBC SC Research Park**

Drawing Title:  
**Grading Plan**

**Legend**

CLB	Concrete lawn basin with cast iron lid
AD	Area drain
±1.8	Grade Marker
±1.8 pool drain	Pool Drain
TW	Top of Wall
TWater	Top of Water
TWeir	Top of Weir

Project North:  
 Drawn By: **JG**  
 Checked By: **MP**

Scale: 1:500  
 Job No.: 16-043  
 Sheet No.:

**L2.0**



Plant List	Qty.	Botanical Name	Common Name	Scheduled Size	Remarks
<b>Trees</b>					
Acc	39	<i>Acer circinatum</i>	Vine Maple	2.5m ht., B&B, max. 3 stems	
AccP	8	<i>Acer palmatum</i> 'Fireglow'	Fireglow Japanese Maple	6cm cal., 2.5m ht., WB	to be selected by LA
AccO	2	<i>Acer palmatum</i> 'Osakazuki'	Osakazuki Japanese Maple	6cm cal., 2.5m ht., WB	
CJ	16	<i>Cercidiphyllum japonicum</i>	Katsura Tree	6cm cal., WB	
CEW	18	<i>Cornus 'Eddie's White Wonder'</i>	Eddie's White Wonder Dogwood	6cm cal., WB	
MB	9	<i>Magnolia 'Betty'</i>	Betty Magnolia	8cm cal.	to be selected by LA
Ns	11	<i>Nyssa sylvatica</i>	Black Gum	6cm cal., WB	
Pp	5	<i>Parrotia persica</i>	Persian Ironwood	6cm cal., WB	Tree Form
Po	12	<i>Picea omorika</i>	Serbian Spruce	3m, B&B	
PaS	4	<i>Prunus avium</i> 'Stella'	Stella Sweet Cherry	10cm cal., WB	
Pm	7	<i>Pseudotsuga menziesii</i>	Douglas Fir	2.5m ht, B&B	
Stp	15	<i>Stewartia pseudocamellia</i>	Japanese Stewartia	6cm cal., WB	
Stj	23	<i>Styrax japonicus</i>	Japanese Snowbell	6cm cal., WB	Single Trunk
Thp	19	<i>Thuja plicata</i>	Western Red Cedar	2.5m ht, B&B	
<b>Shrubs</b>					
BcC	682	<i>Berberis thunbergii</i> 'Concorde'	Concorde Japanese Barberry	#2 pot	
BmW	143	<i>Buxus microphylla</i> 'Winter Gem'	Winter Gem Boxwood	#2 pot	
Ct	55	<i>Choisya ternata</i>	Mexican Orange	#3 pot	
CsK	392	<i>Cornus sericea</i> 'Kelsey'	Kelsey Dogwood	#2 pot	
Gs	467	<i>Gaultheria shallon</i>	Salal	#2 pot	
HmBB	108	<i>Hydrangea macrophylla</i> 'Blue Billows'	Lacecap Hydrangea	#5 pot	
Ma	51	<i>Mahonia aquifolium</i>	Oregon Grape	#2 pot	
Mn	494	<i>Mahonia nervosa</i>	Longleaf Mahonia	#2 pot	
NdF	233	<i>Nandina domestica</i> 'Fire Power'	Fire Power Heavenly Bamboo	#3 pot	
PoG	7	<i>Physocarpus opulifolius</i> 'Dart's Gold'	Dart's Gold Ninebark	#3 pot	
PoD	9	<i>Physocarpus opulifolius</i> 'Diablo'	Diablo Ninebark	#3 pot	
Pm	23	<i>Pinus mugo</i>	Mountain Pine	#2 pot	
PIO	116	<i>Prunus laurocerasus</i> 'Otto Luyken'	Otto Luyken Laurel	#3 pot	
PIR	47	<i>Prunus laurocerasus</i> 'Reynvaanii'	Russian Laurel	#3 pot	Hedge
RG	251	<i>Rhododendron</i> 'Girard's Pleasant White'	Girard's Pleasant White Azalea	#2 pot	
RmM	325	<i>Rhododendron</i> Minnetonka	Minnetonka Rhododendron	#5 pot	
RpE	44	<i>Rhododendron</i> PJM Elite	PJM Elite Rhododendron	#5 pot	
Rsk	109	<i>Ribes sanguineum</i> 'King Edward VII'	Flowering Currant	#5 pot	
Sh	536	<i>Sarcococca hookeriana</i> var. <i>humilis</i>	Dwarf Sweet Box	#2 pot	
Sr	353	<i>Sarcococca ruscifolia</i>	Fragrant Sarcococca	#3 pot	
Sj	185	<i>Skimmia japonica</i>	Japanese Skimmia	#3 pot	
SjRe	43	<i>Skimmia japonica</i> subsp. <i>reevesiana</i>	Reevesiana Skimmia	#3 pot	
SjG	256	<i>Spiraea japonica</i> 'Goldmound'	Goldmound Spirea	#3 pot	
Sa	126	<i>Symphoricarpos albus</i>	Snowberry	#2 pot	
Syc	97	<i>Symphoricarpos x chenaultii</i>	Chenault Coralberry	#3 pot	
Vd	251	<i>Viburnum davidii</i>	David Viburnum	#3 pot	
W	220	<i>Weigela</i> 'Midnight Wine'	Midnight Wine Weigela	#2 pot	
<b>Groundcovers, Vines, Ferns, Perennials and Grasses</b>					
AjD	13	<i>Astilbe japonica</i> 'Deutschland'	Amethyst False Spirea	#1 pot	white flower colour
CoE	1534	<i>Carex oshimensis</i> 'Evergold'	Sedge	#1 pot	
Em	46	<i>Elymus magellanicus</i>	Blue Clumping Wheatgrass	#1 pot	
Ev	64	<i>Epimedium x versicolor</i>	Barrenwort	#1 pot	
Hs	225	<i>Helictotrichon sempervirens</i>	Blue Oat Grass	#1 pot	
HJ	183	<i>Hosta 'June'</i>	June Hosta	#1 pot	
LaM	154	<i>Lavandula angustifolia</i> 'Munstead'	English Lavender	#1 pot	
Ls	586	<i>Liriope spicata</i>	Lily Turf	#1 pot	
Op	168	<i>Ophiopogon planiscapus</i> 'Nigrescens'	Black Mondo Grass	#1 pot	Groundcover
Pt	697	<i>Pachysandra terminalis</i>	Japanese Spurge	#1 pot	Groundcover
Pm	654	<i>Polystichum munifolium</i>	Western Sword Fern	#1 pot	
Rpt	11	<i>Rheum palmatum</i> var. <i>tanguticum</i>	Ornamental Rhubarb	#1 pot	
Rp	32	<i>Rodgersia pinnata</i>	Feather Leaf Rodgersia	#1 pot	white flower colour
Total	10194				

PLAN  
BCP35350

**P+A**  
Landscape Architecture  
Site Planning  
R. Kim Perry & Associates Inc.  
200 - 1558 W 6th Avenue  
Vancouver, BC V6J 1R2  
T 604 738 4118  
F 604 738 4116  
www.perryandassociates.ca

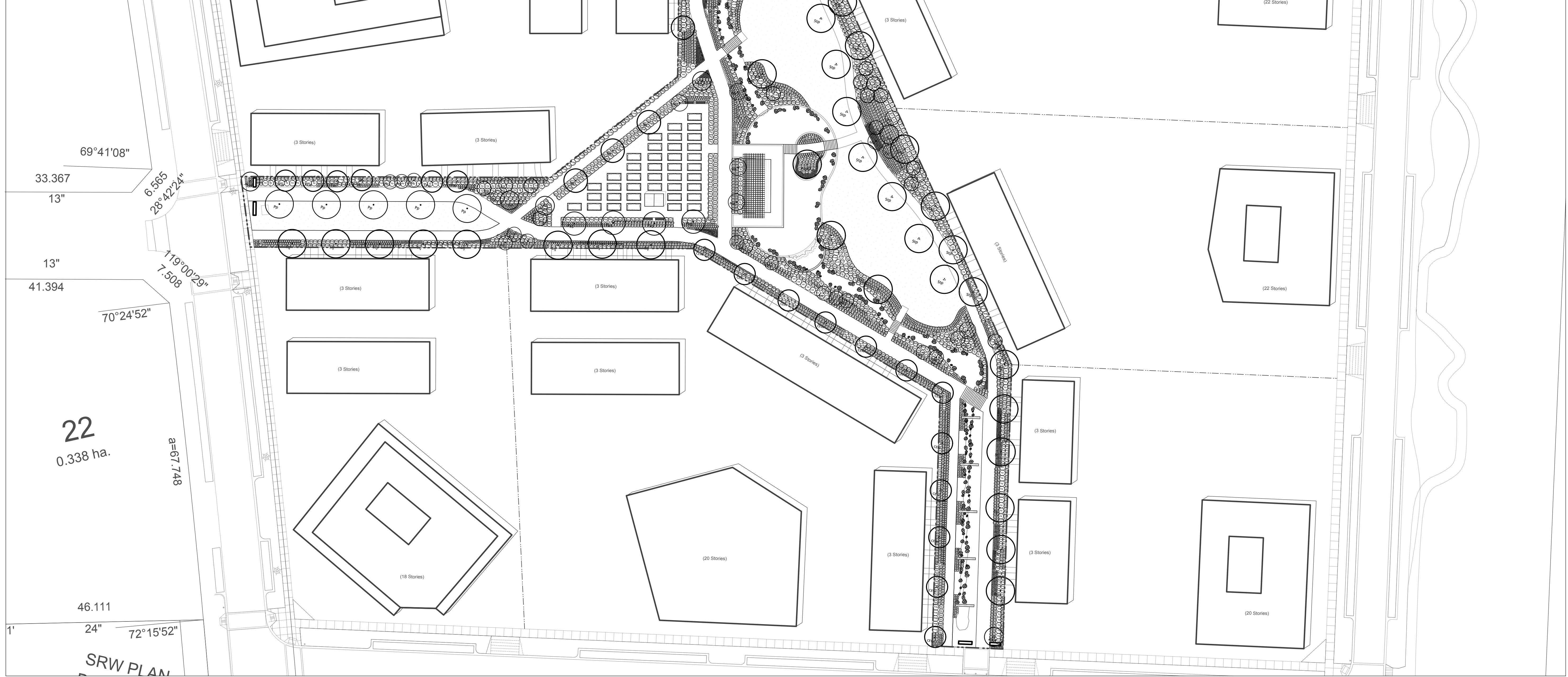

2 Issued for DRC Review 09/08/2017  
1 Issued for Development Permit 03/28/2017  
Revision No. Date

**COPYRIGHT RESERVED**  
This drawing is and shall remain the property of R. Kim Perry & Associates Inc., and R. Kim Perry & Associates Inc. shall retain the copyright therein. This document shall not be reproduced or used for additions or alterations to the project or for the purpose of any other project without the prior written consent of R. Kim Perry & Associates Inc.

Client:  
**UBC Properties Trust**

Project Title:  
**UBC SC Research Park**

Drawing Title:  
**Planting Plan**

Project North: Drawn By: **KS**  
Checked By: **MP**  
Scale: 1:425 Job No.: 16-043  
Sheet No.:

**L 3.0**



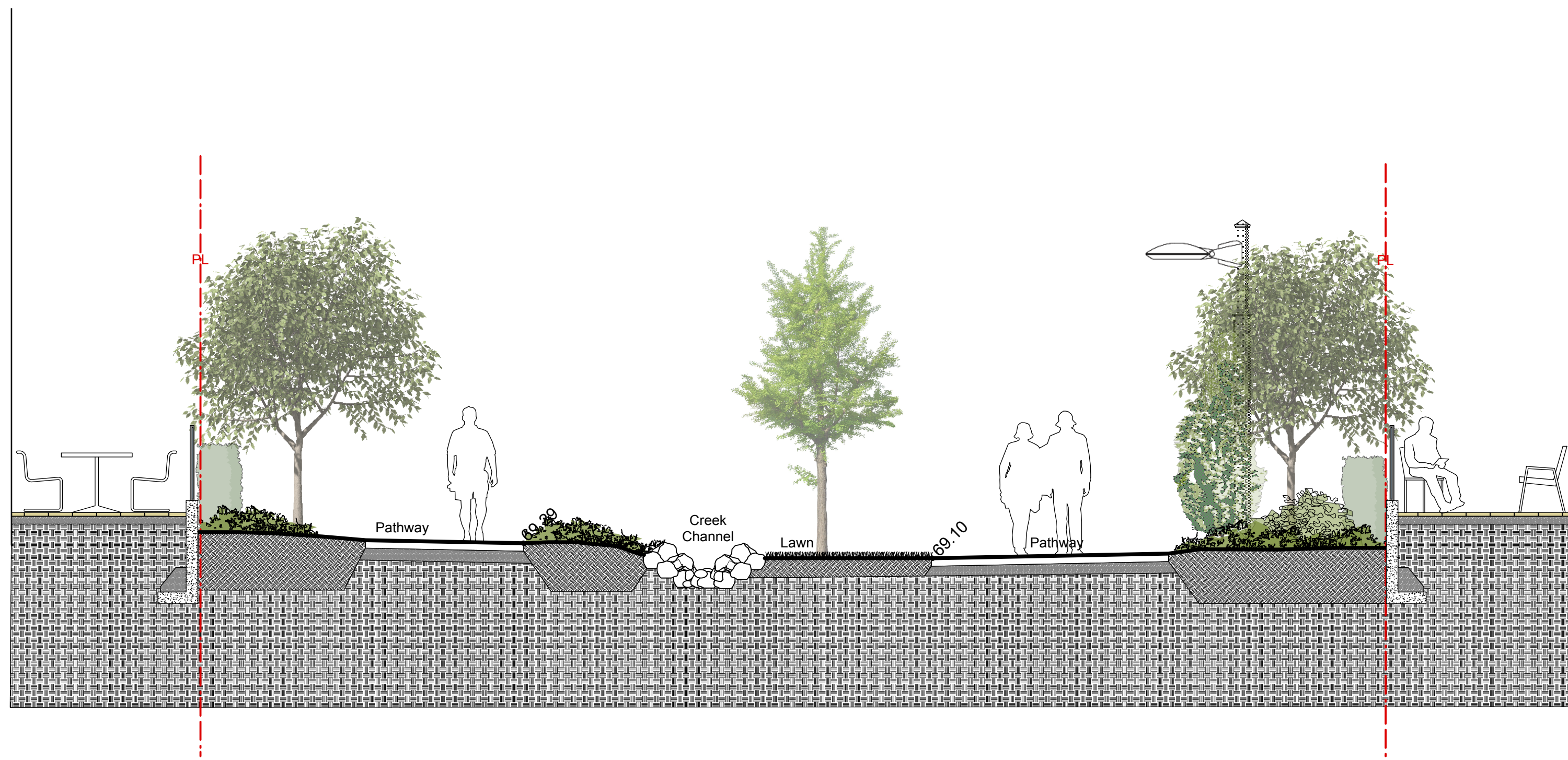

1 SECTION THROUGH SOUTHERN ARM

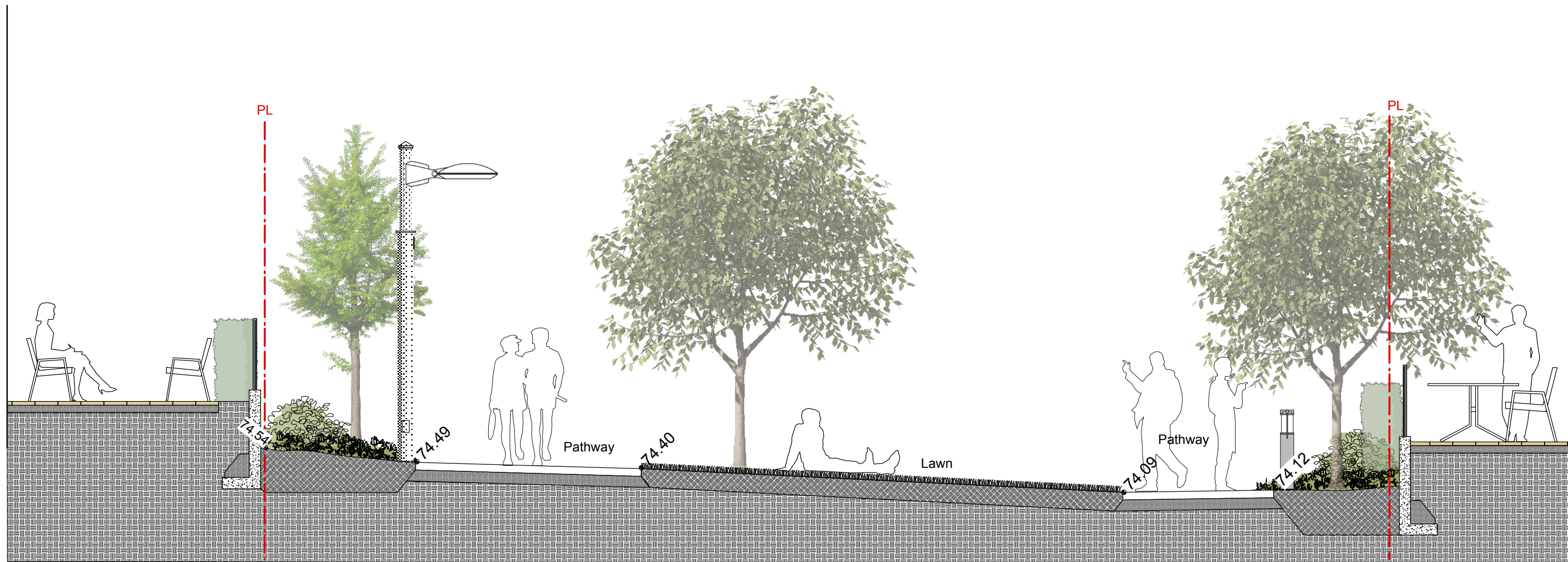

2 SECTION THROUGH WESTERN ARM

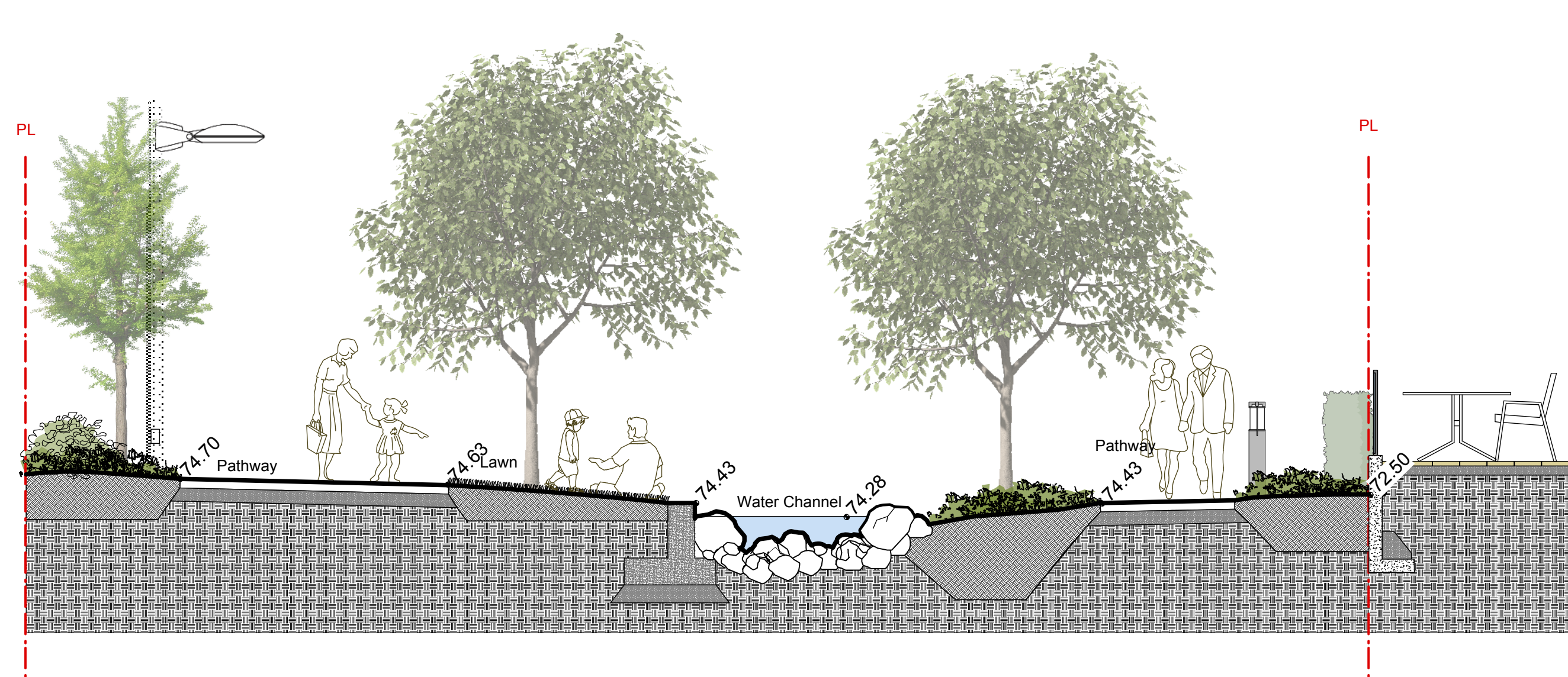

3 SECTION THROUGH NORTHERN ARM

2 Issued for DRC Review 09/08/2017  
 1 Issued for Development Permit 03/28/2017  
 Revision No. \_\_\_\_\_ Date \_\_\_\_\_

COPYRIGHT RESERVED  
 This drawing is and shall remain the property of R. Kim Perry & Associates Inc., and R. Kim Perry & Associates Inc. shall retain the copyright therein. This document shall not be reproduced or used for additions or alterations to the project or for the purpose of any other project without the prior written consent of R. Kim Perry & Associates Inc.

Client: **UBC Properties Trust**

Project Title: **UBC SC Research Park**

Drawing Title: **Illustrative Sections**

Project North: \_\_\_\_\_ Drawn By: **KS**  
 Checked By: **MP**  
 Scale: \_\_\_\_\_ Job No.: **16-043**  
 Sheet No.: \_\_\_\_\_



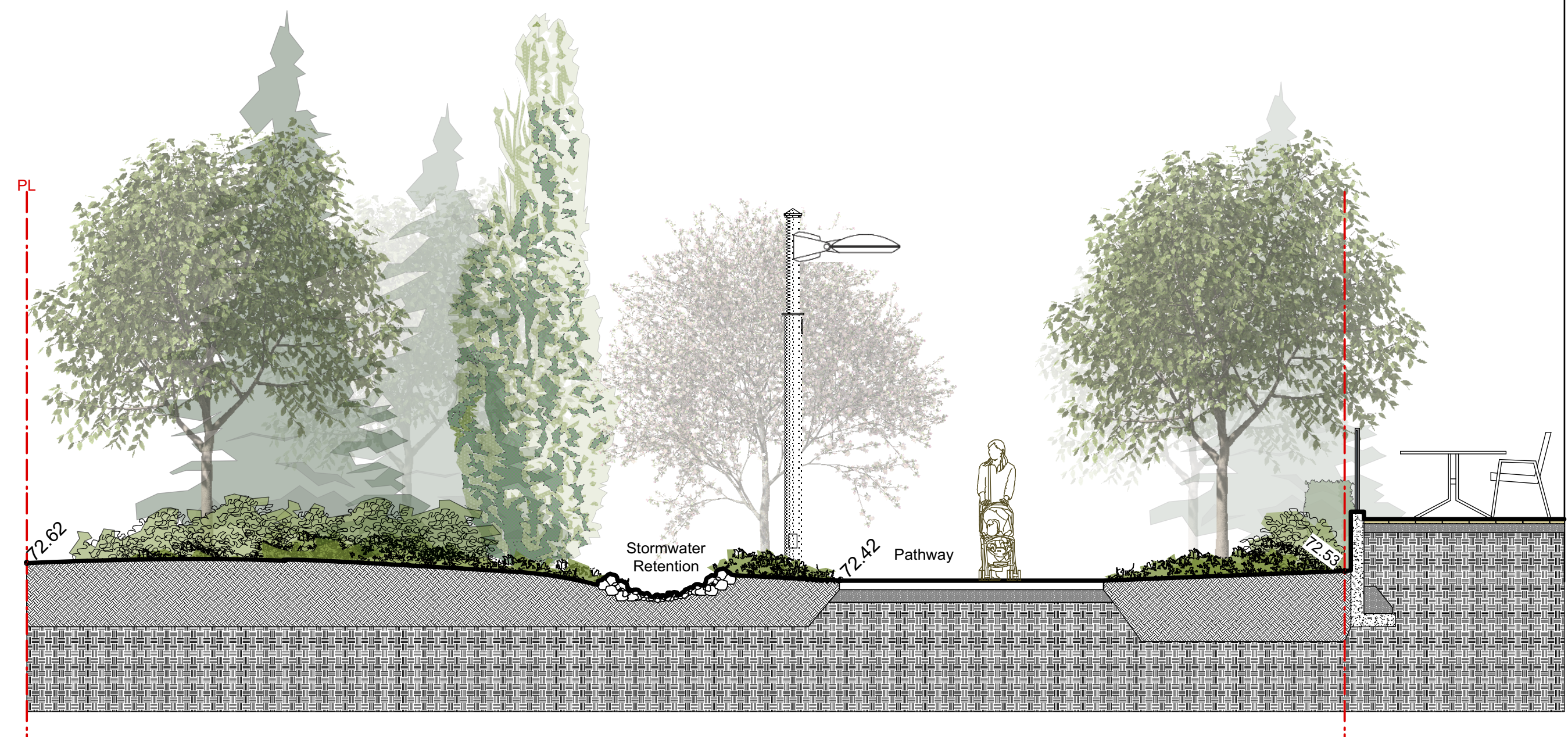

4 SECTION THROUGH EASTERN ARM

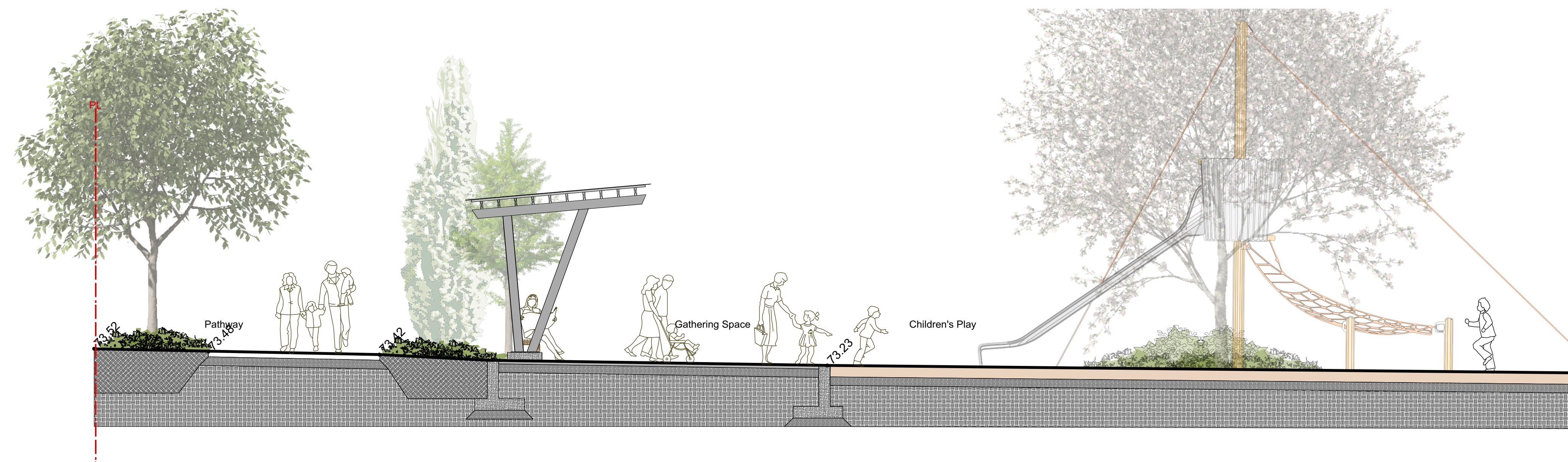

5 SECTION THROUGH PLAY AREA

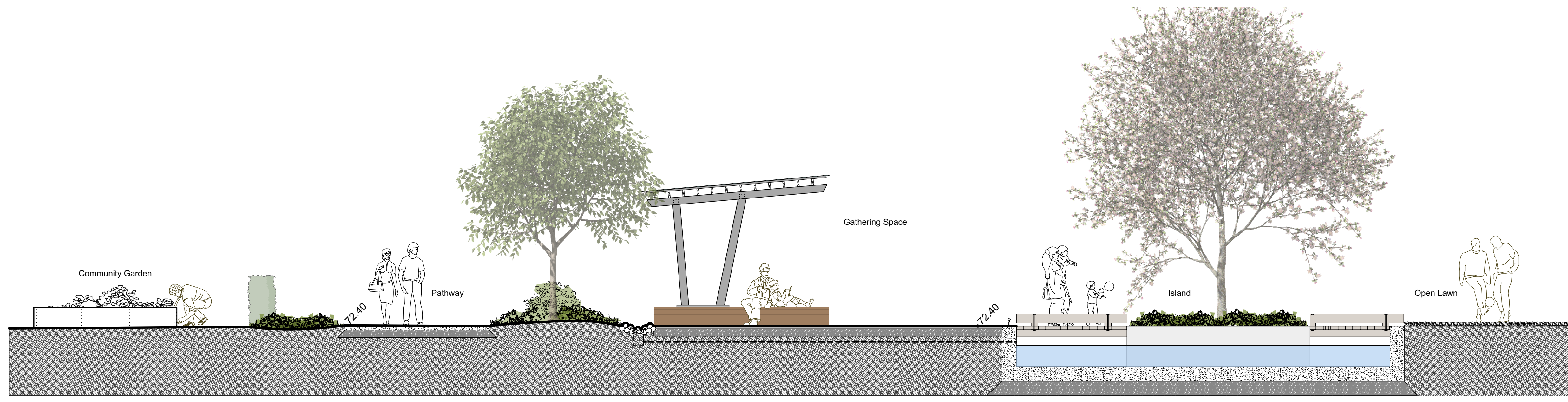

6 SECTION THROUGH PARK CENTRE

2	Issued for DRC Review	09/08/2017
1	Issued for Development Permit	03/28/2017
Revision No.		Date

COPYRIGHT RESERVED  
 This drawing is and shall remain the property of R. Kim Perry & Associates Inc., and R. Kim Perry & Associates Inc. shall retain the copyright therein. This document shall not be reproduced or used for additions or alterations to the project or for the purpose of any other project without the prior written consent of R. Kim Perry & Associates Inc.

Client:  
**UBC Properties Trust**

Project Title:  
**UBC SC Research Park**

Drawing Title:  
**Illustrative Sections**

Project North:	Drawn By:	KS
	Checked By:	JM
Scale:	Job No.:	16-043
		As Shown

Sheet No.:



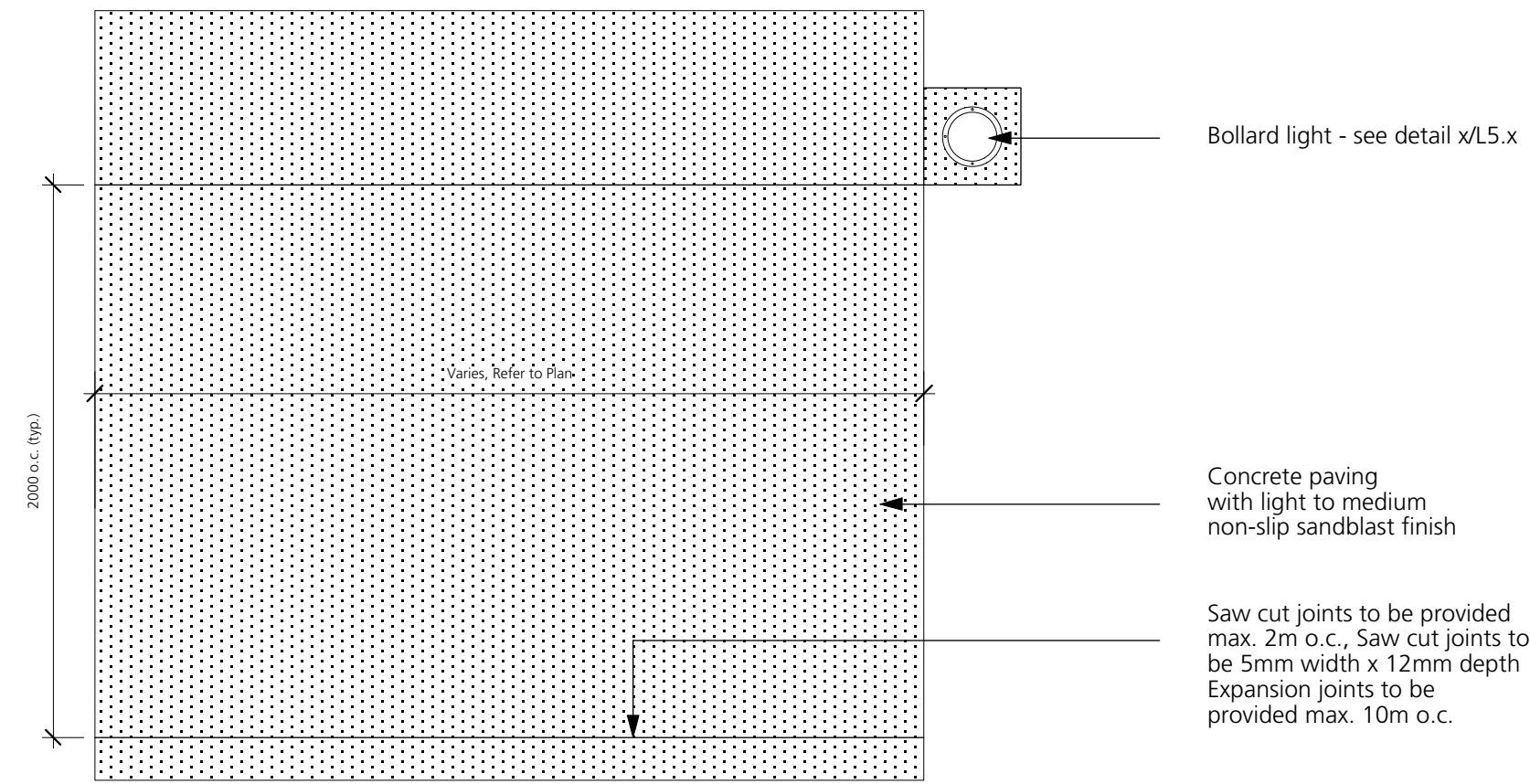
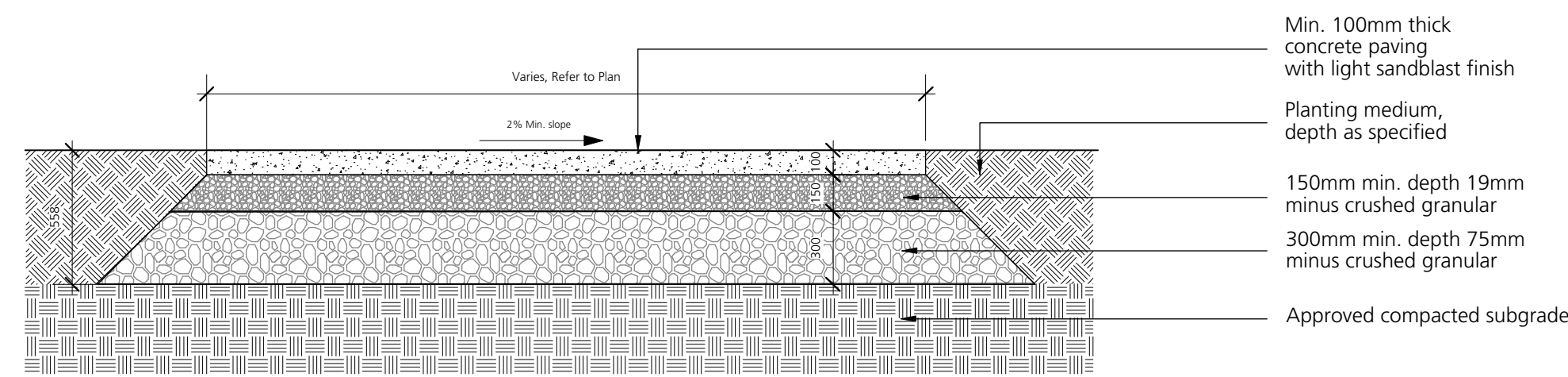

1 Concrete Walkway (with service vehicle access)  
1:25

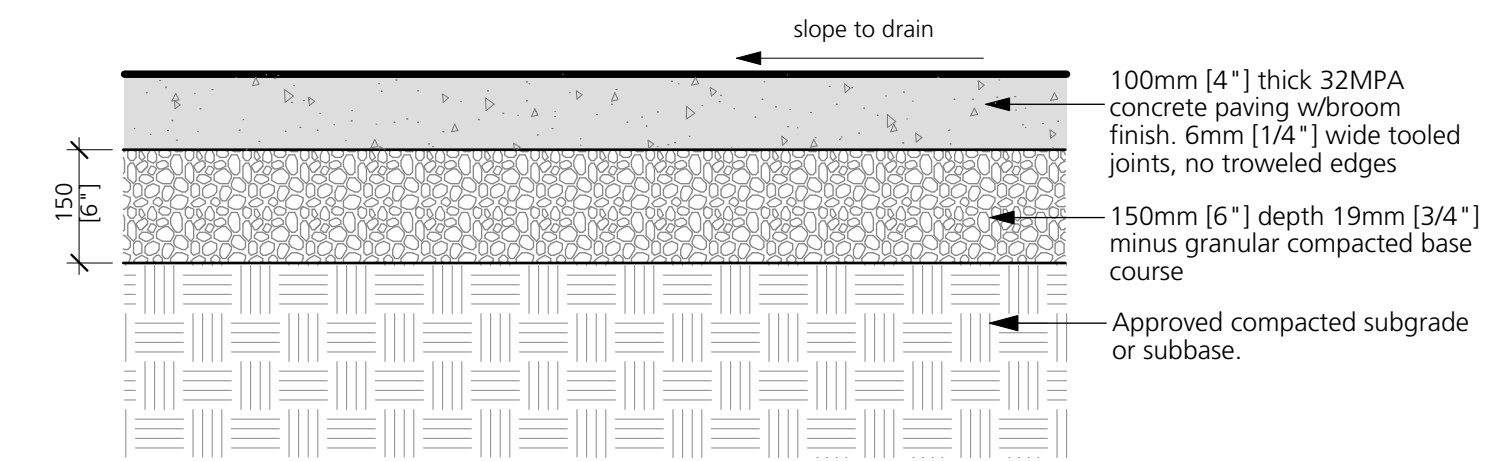

2 Concrete Walkway (Pedestrian Access)  
1:10

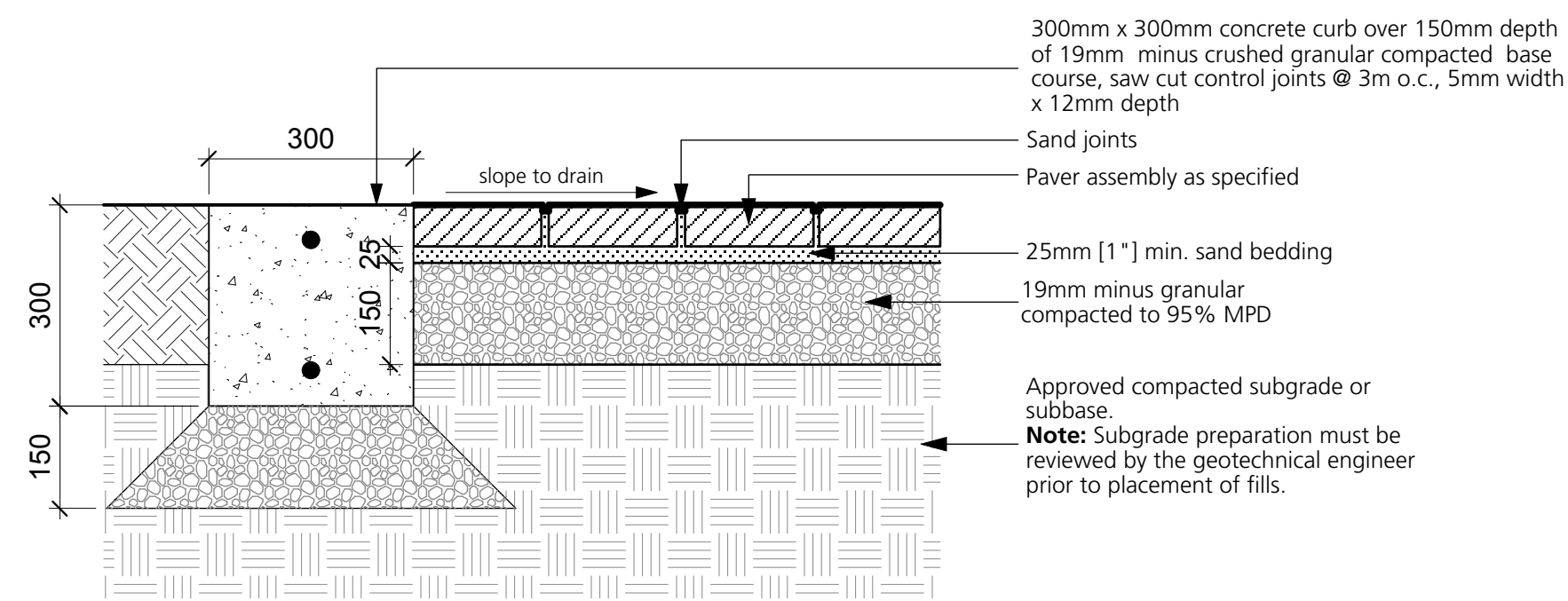

3 Concrete Unit Pavers with Concrete Curb  
1:10

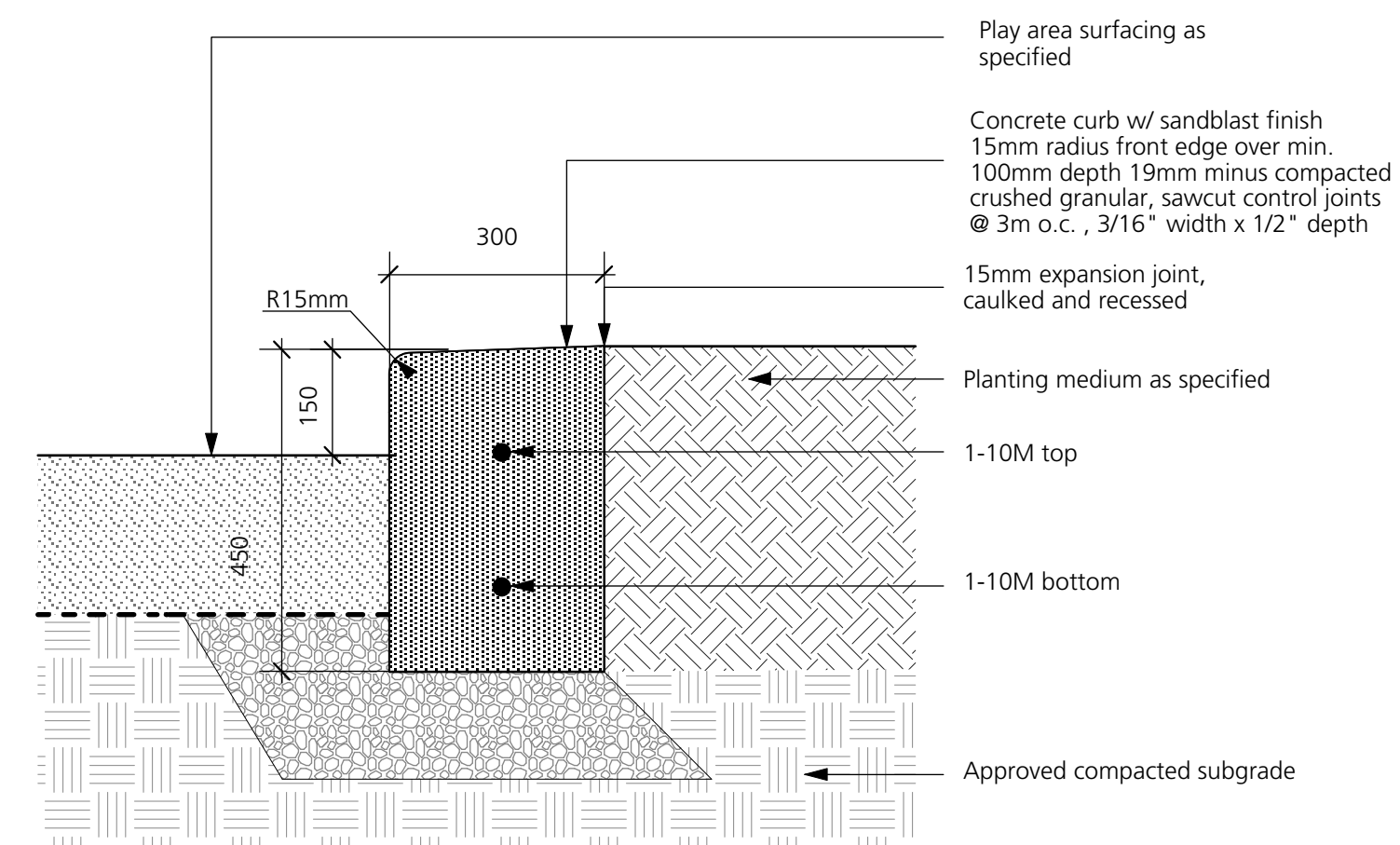

4 Play Surfacing with Concrete Curb  
1:10

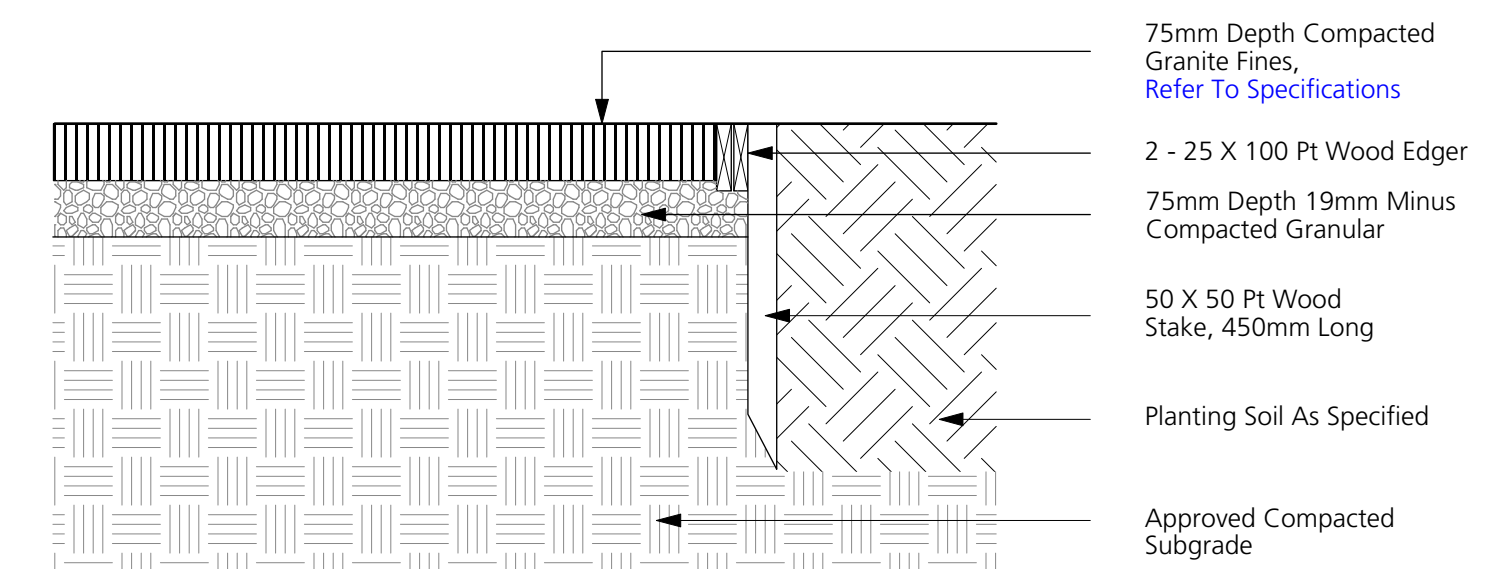

5 Community Garden Paving  
1:10

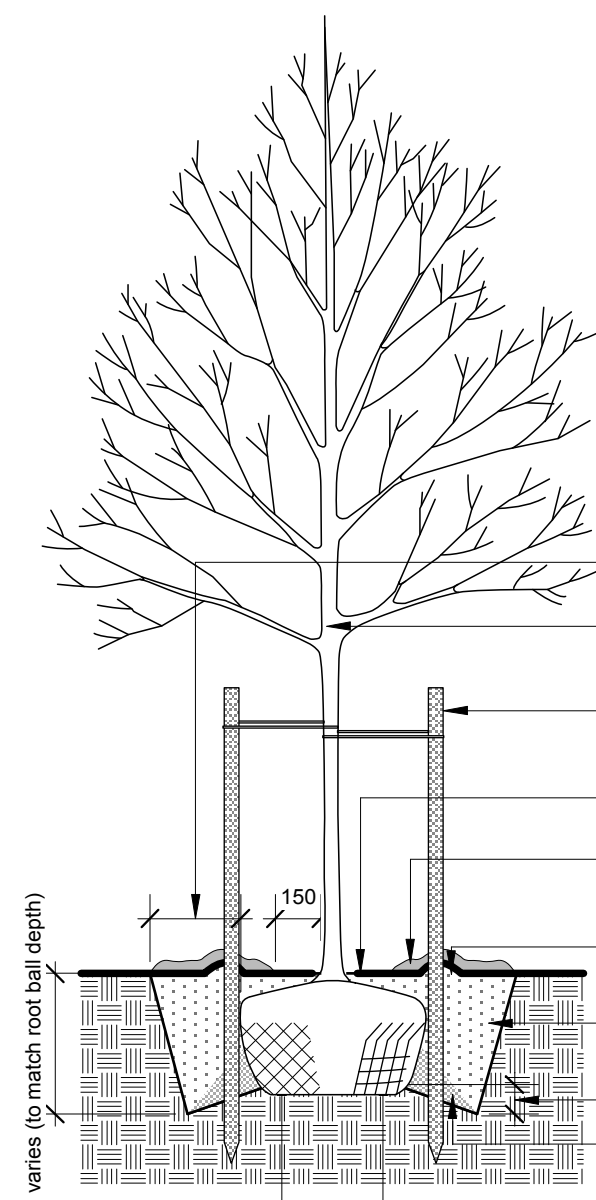

- NOTE:**
- DO NOT CUT LEADER.
  - STAKE TREES ONLY UPON THE APPROVAL OF THE LANDSCAPE ARCHITECT. WRAP TREE TRUNKS ONLY UPON THE APPROVAL OF THE LANDSCAPE ARCHITECT.
  - PROTECT TREE FROM DANGER DURING PLANTING. ENSURE ROOTBALL IS PROTECTED FROM SUN, FROST OR DESICCATION.
  - TREE SELECTION, HANDLING, PLANTING AND MAINTENANCE MUST MEET BC S/LA/CLMA STANDARDS, BE IN GOOD HEALTH AND CONDITION WITHOUT WOUNDS, HAVE NORMAL FORM, AND BE FREE OF DISEASES AND PESTS.
  - SITE PREPARATION MUST INCLUDE PROVISION FOR SOIL PLACEMENT, REPLACEMENT OR ENHANCEMENT TO MEET PROJECT SPECIFICATIONS.
  - PLANTING HOLES MUST BE FREE DRAINING TO THE EXTENT THAT RAINWATER AND/OR SUPPLEMENTAL WATER DOES NOT ACCUMULATE AND DROWN THE ROOTS. IF NECESSARY, THE SUBGRADE MUST BE GRADED WITH POSITIVE SLOPE AND/OR DRAINAGE SERVICES SUCH AS BUT NOT LIMITED TO PERCOLATION HOLES, FRENCH DRAINS OR DRAIN PIPES MUST BE INSTALLED TO SUIT.
  - WATERING OF THE ROOT BALL MUST BE UNDERTAKEN IMMEDIATELY AFTER PLANTING AND THEN FOR THE FIRST GROWING SEASON SO THAT THE ROOT BALL IS THOROUGHLY WETTED ONCE PER WEEK (MINIMUM).
  - THE MULCHED ROOT ZONE SHOULD BE REFRESHED ANNUALLY TO REPLACE THE MULCH. THIS AREA MUST BE WEEDED BY HAND TO AVOID TRUNK AND ROOT DAMAGE FROM STRING TRIMMERS OR MOWERS.
  - THE TREE SHOULD BE PRUNED TO ANSI A3000 STANDARDS AFTER ESTABLISHMENT AND FROM TIME TO TIME TO TRAIN IT FOR STRUCTURE TO CONFORM TO THE FORM OF THE SPECIES AND TO RESPOND TO GROWING SITE CONSTRAINTS. ALL PRUNING MUST BE UNDERTAKEN BY OR PERFORMED UNDER THE DIRECTION OF A QUALIFIED ARBORIST CERTIFIED BY THE INTERNATIONAL SOCIETY OF ARBORICULTURE AND WHO DEMONSTRATES PROFICIENCY IN PRUNING.
  - PLANTING HOLE MUST BE DUG TO AT LEAST 300MM LARGER THAN THE ROOT BALL ON ALL SIDES WITH SLOPED SIDE WALLS.
  - TREE MUST BE VERTICAL AND STABLE AFTER PLANTING. MARK THE NORTH SIDE OF THE TREE IN THE NURSEY, AND ROTATE TREE TO FACE NORTH AT THE SITE WHENEVER POSSIBLE.
  - STAKES AND TIES SHOULD BE INSTALLED FOR TREES THAT ARE NOT STABLE AFTER PLANTING DEPENDING ON FORM, ROOT BALL TYPE AND SIZE. STAKES AND TIES MUST BE REMOVED ONE YEAR AFTER PLANTING UNLESS OTHERWISE SPECIFIED.
  - SET ROOT BALL FLUSH TO GRADE OR 25-50MM HIGHER IN POORLY DRAINING SOILS. DO NOT COVER THE TIP OF THE ROOT BALL WITH SOIL.
  - PLANTING HOLE AND ROOT BALL MUST BE COVERED WITH 50MM OF COMPOSTED MULCH (OR TREE GRATE). THE MULCH SHOULD NOT BE PLACED WITHIN 200MM OF THE TRUNK FLARE.
  - 100MM BUILT-UP EARTH SAUCER BEYOND EDGE OF THE ROOT BALL TO AID IN DIRECTING SUPPLEMENTAL WATER TO THE ROOT BALL.
  - BACKFILL MUST BE OF APPROVED GROWING MEDIUM FOR QUALITY, COMPOSITION AND FERTILITY. LIGHTLY TAMP THE BACKFILL AND WATER IN AFTER PLANTING.
  - 100 TO 150MM DEEPER THAN ROOT BALL.
  - TAMP SOIL AROUND THE BASE OF ROOT BALL BASE FIRMLY WITH FOOT PRESSURE SO THAT ROOT BALL DOES NOT SHIFT.
  - REMOVE 1/3 OF BURLAP FROM ROOTBALL AND TWINE FROM BASE OF TRUNK (AND/OR WIRE BASKET "LIFTING LOOPS" AND TOP OF BASKET). REMOVE ANY SOIL ON TOP "ORIGINAL" ROOTBALL.

6 Tree Planting  
1:25

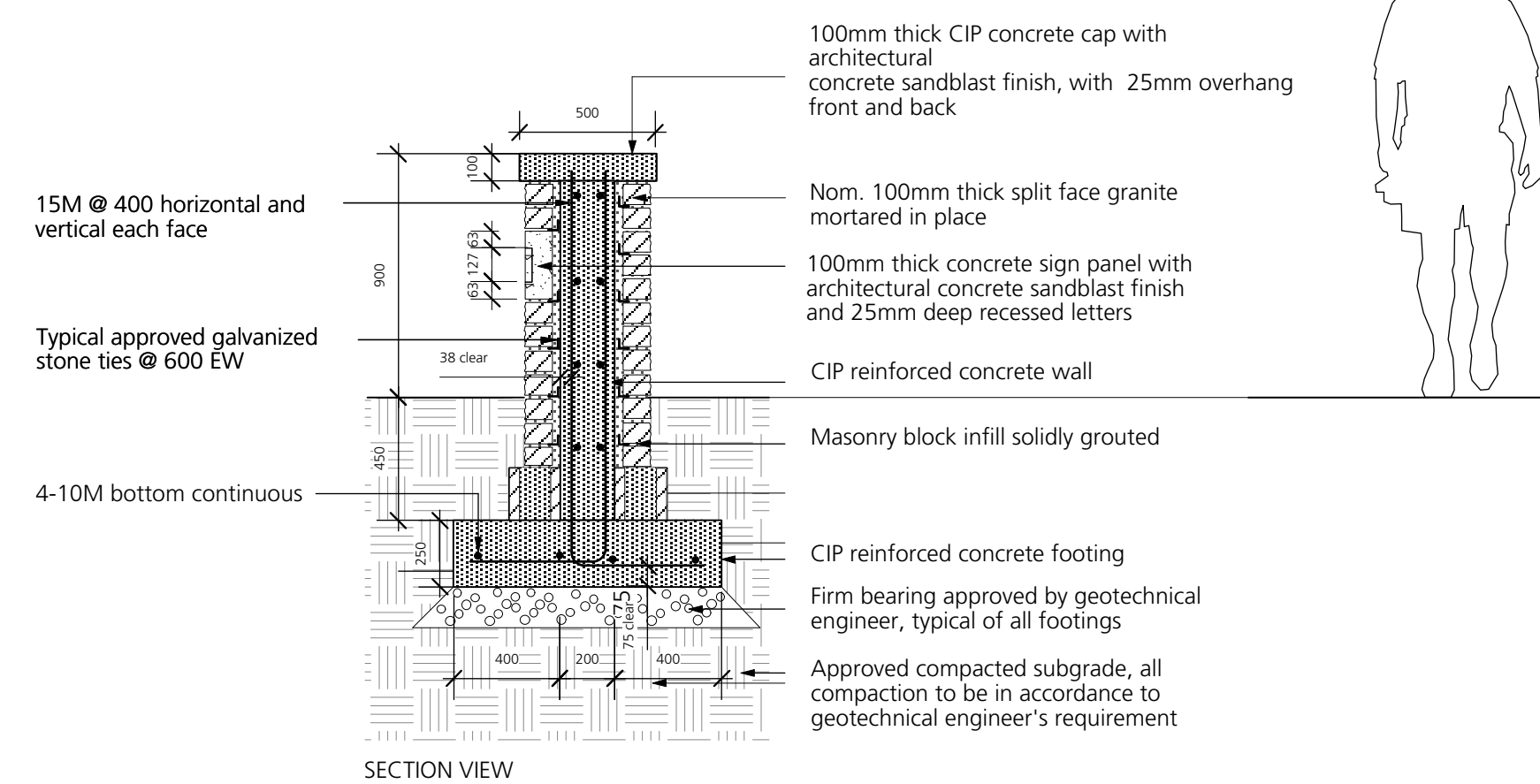

7 Granite Faced Signage Wall  
1:25

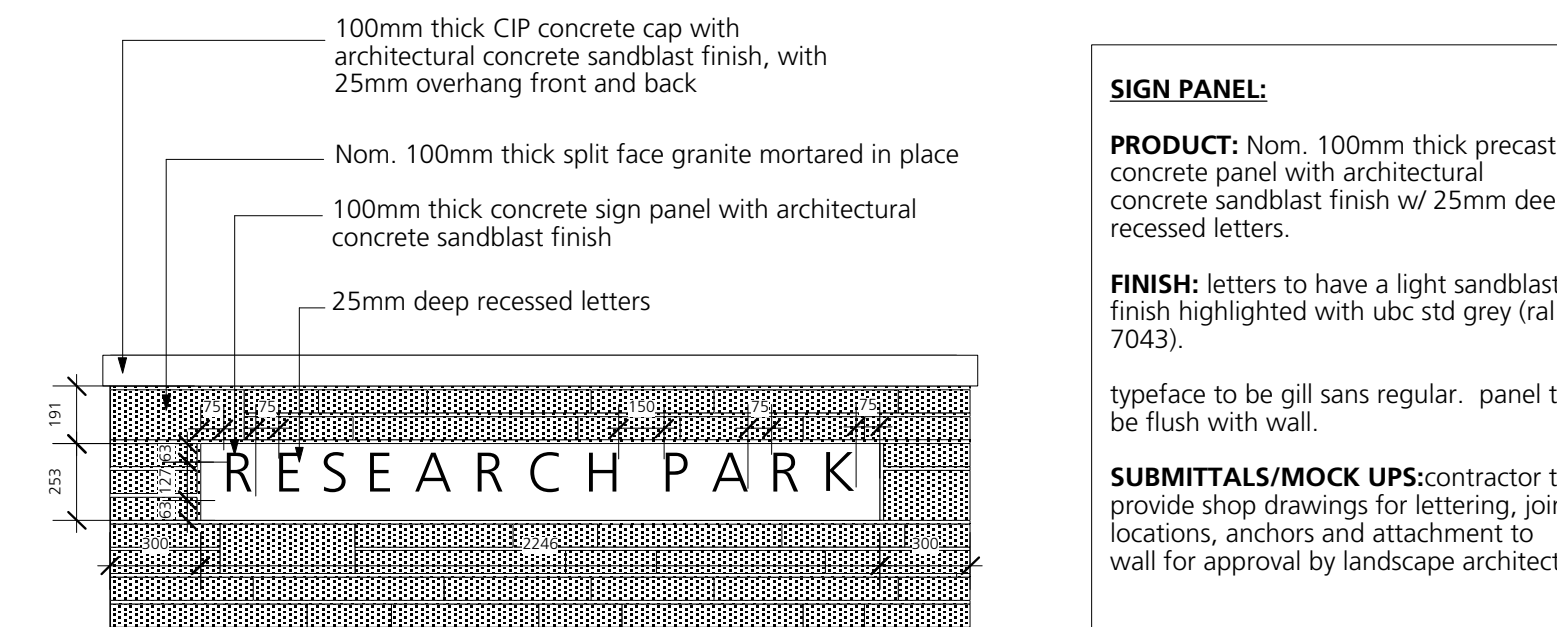

ELEVATION VIEW - FACING XXXX ROAD

**GRANITE CLADDING:**

**PRODUCT:** Hardy island salt and pepper available from bedrock granite sales (604)941-7783.

**DIMENSIONS:** 75mm high x 100mm deep x 200-900mm wide, dimension cut on 4 sides typical with random 165mm high pieces as shown.

**FINISH:** Split face

**SUBMITTALS/MOCK UPS:**

- Provide samples for approval prior to order showing representative range of stone sizes to be used.
- Contractor to provide a separate mock-up panel for approval by landscape architect prior to proceeding with stone masonry work. mock-up to be a minimum 1.5m wide x 1.0m ht.

**SIGN PANEL:**

**PRODUCT:** Nom. 100mm thick precast concrete panel with architectural concrete sandblast finish w/ 25mm deep recessed letters.

**FINISH:** letters to have a light sandblast finish highlighted with ubc std grey (ral 7043). typeface to be gill sans regular. panel to be flush with wall.

**SUBMITTALS/MOCK UPS:** contractor to provide shop drawings for lettering, joint locations, anchors and attachment to wall for approval by landscape architect

2 Issued for DRC Review	09/08/2017
1 Issued for Development Permit	03/28/2017
Revision No.	Date

COPYRIGHT RESERVED  
This drawing is and shall remain the property of R. Kim Perry & Associates Inc., and R. Kim Perry & Associates Inc. shall retain the copyright therein. This document shall not be reproduced or used for additions or alterations to the project or for the purpose of any other project without the prior written consent of R. Kim Perry & Associates Inc.

Client:  
**UBC Properties Trust**

Project Title:  
**UBC SC Research Park**

Drawing Title:  
**Landscape Details**

Project North:	Drawn By:	KS
	Checked By:	MP
Scale:	Job No.:	16-043
	As shown	
Sheet No.:		



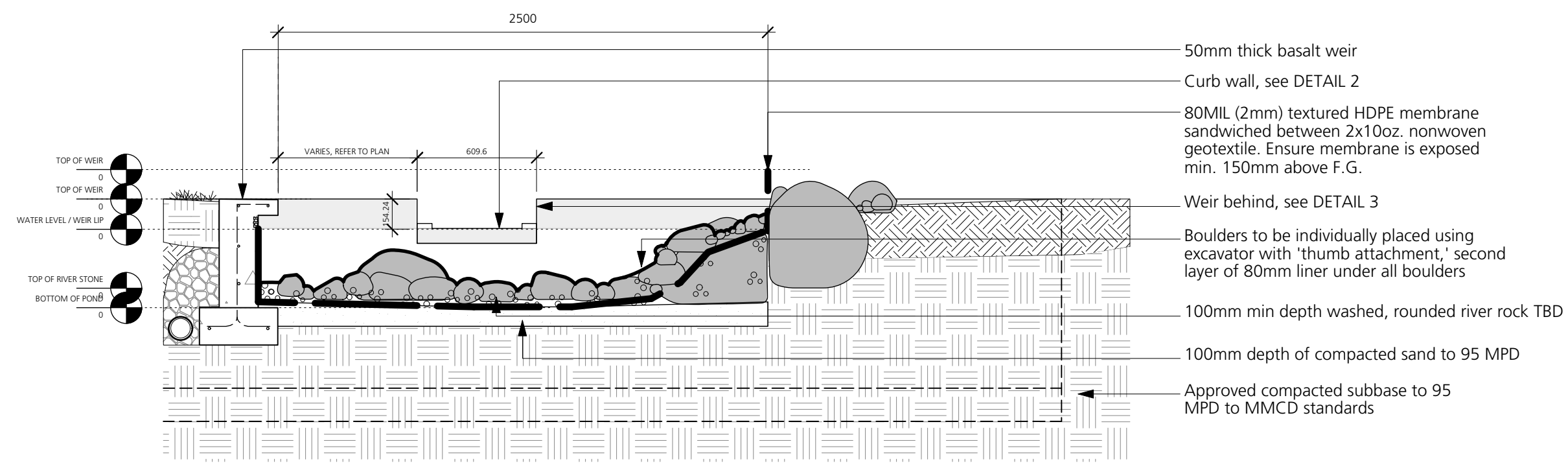

Note: For placement of boulders provide additional sheet of 80mm liner under boulder. Place boulders with bucket and thumb.

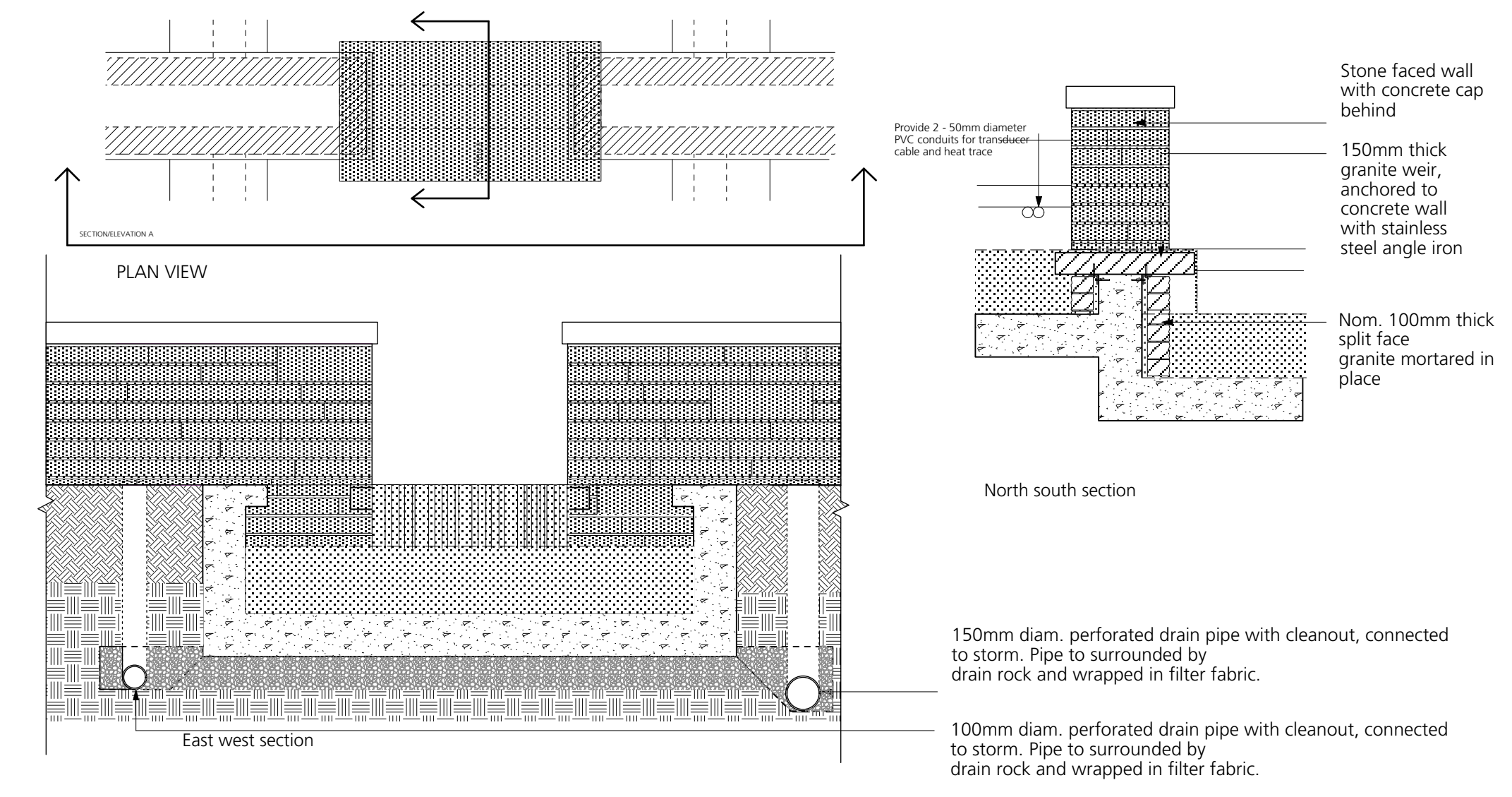

8 Concrete Water Channel  
1:25

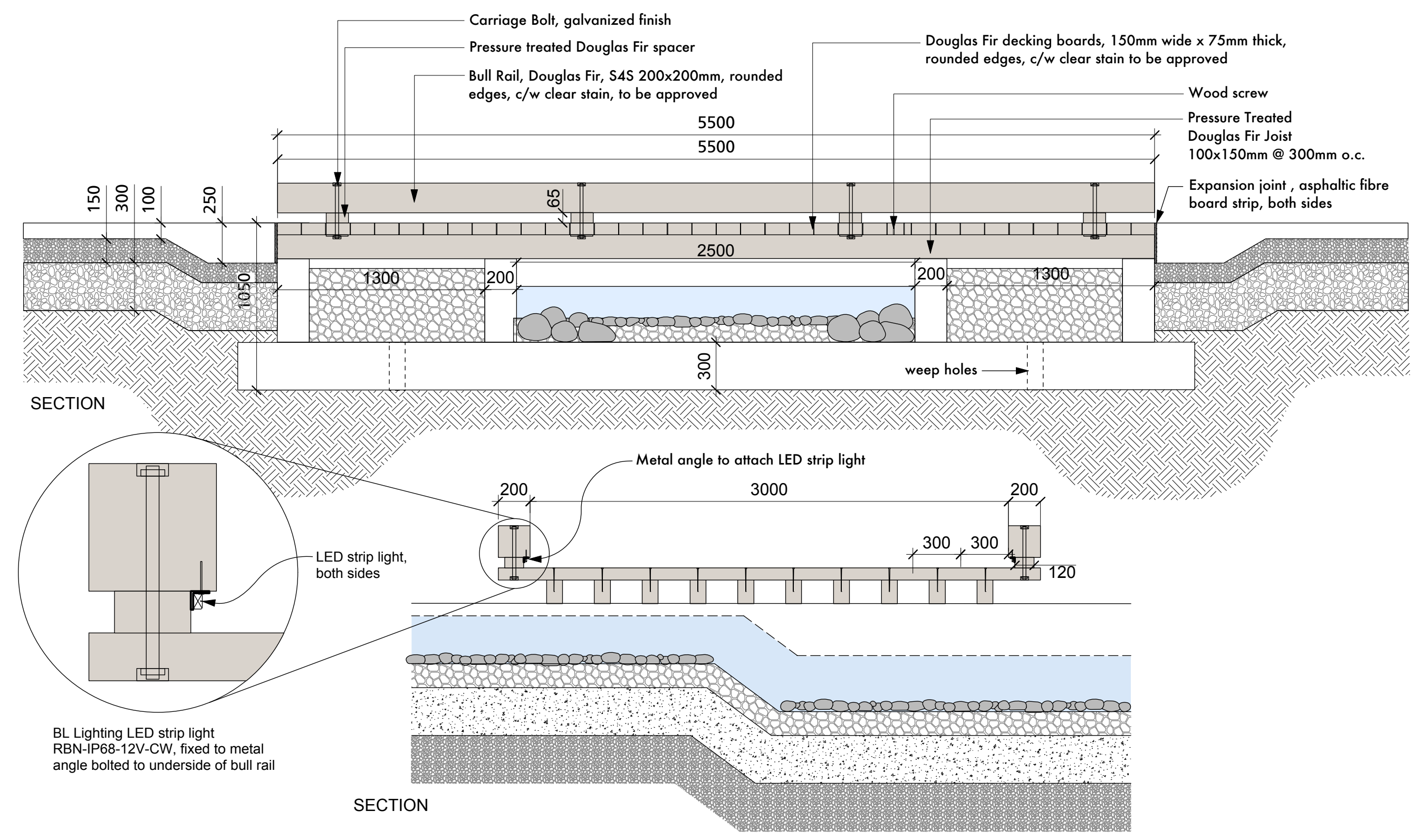

9 Wood Pedestrian Bridge  
1:25

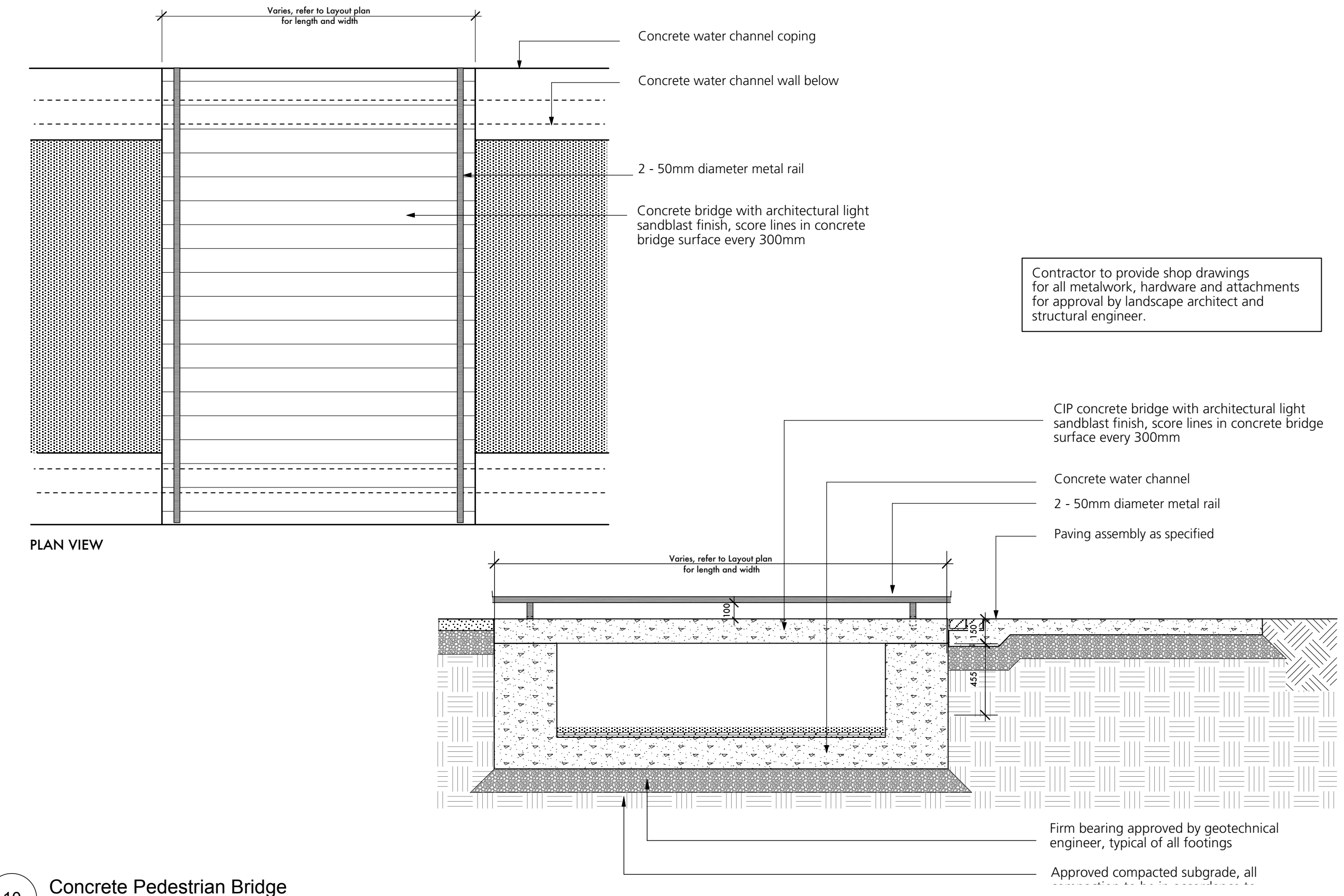

10 Concrete Pedestrian Bridge  
1:25

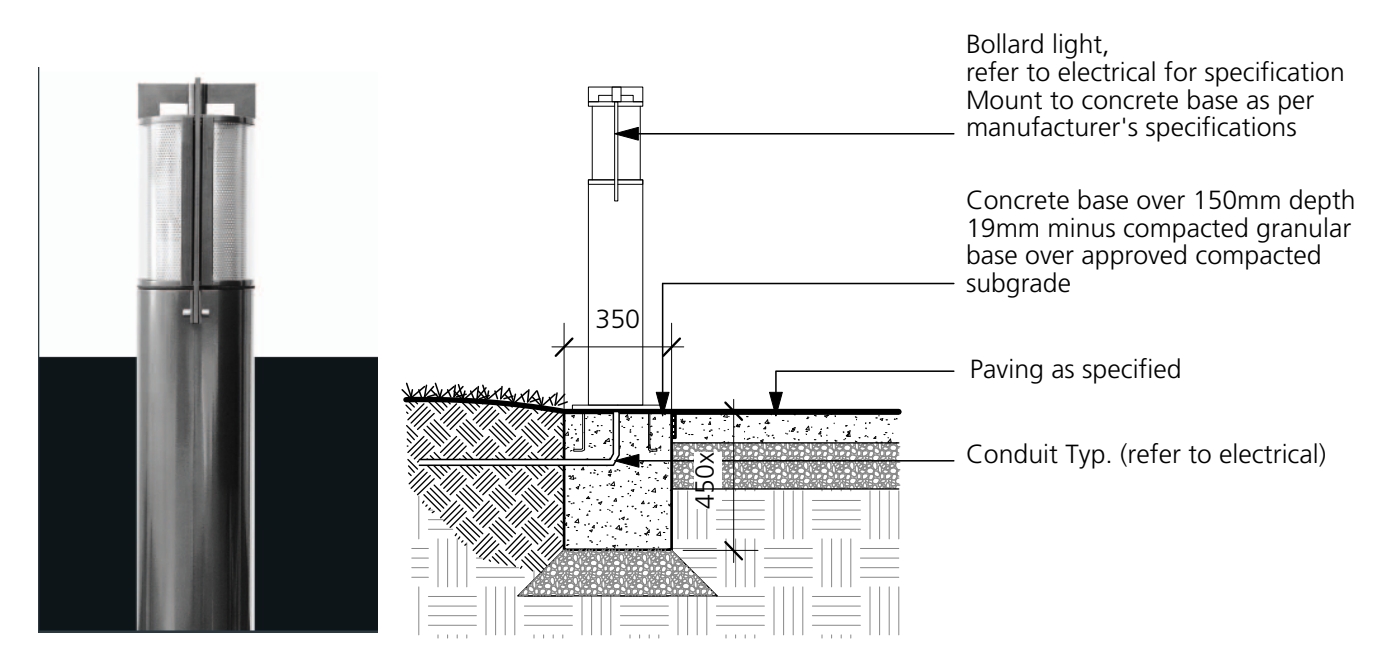

11 Bollard Light  
NTS

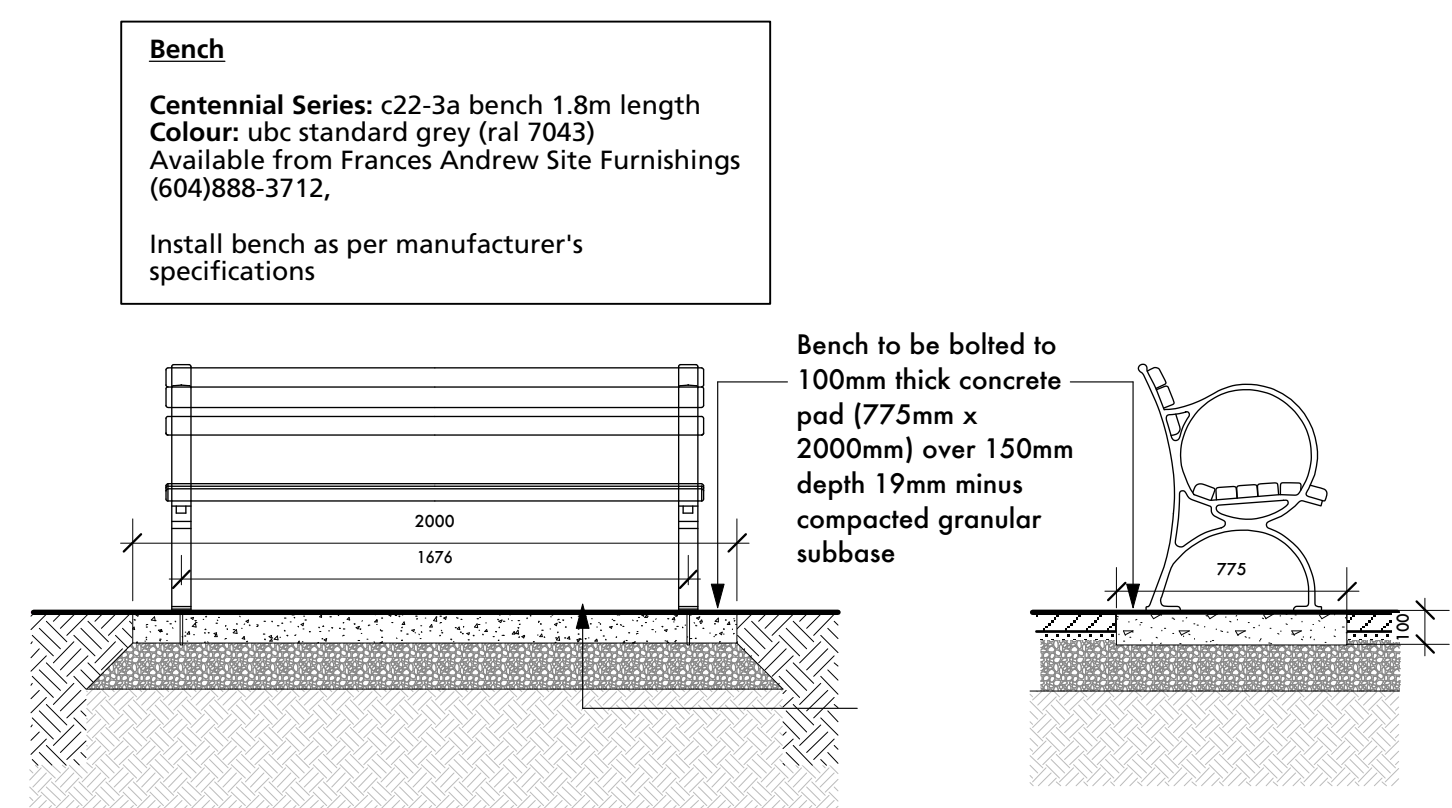

12 Frances Andrew Bench  
1:25

2	Issued for DRC Review	09/08/2017
1	Issued for Development Permit	03/28/2017
Revision No.		Date

COPYRIGHT RESERVED  
 This drawing is and shall remain the property of R. Kim Perry & Associates Inc. and R. Kim Perry & Associates Inc. shall retain the copyright therein. This document shall not be reproduced or used for additions or alterations to the project or for the purpose of any other project without the prior written consent of R. Kim Perry & Associates Inc.

Client: **UBC Properties Trust**

Project Title: **UBC SC Research Park**

Drawing Title: **Landscape Details**

Project North:	Drawn By:	KS
	Checked By:	MP
Scale:	Job No.:	16-043
As shown		
Sheet No.:		

**L5.1**



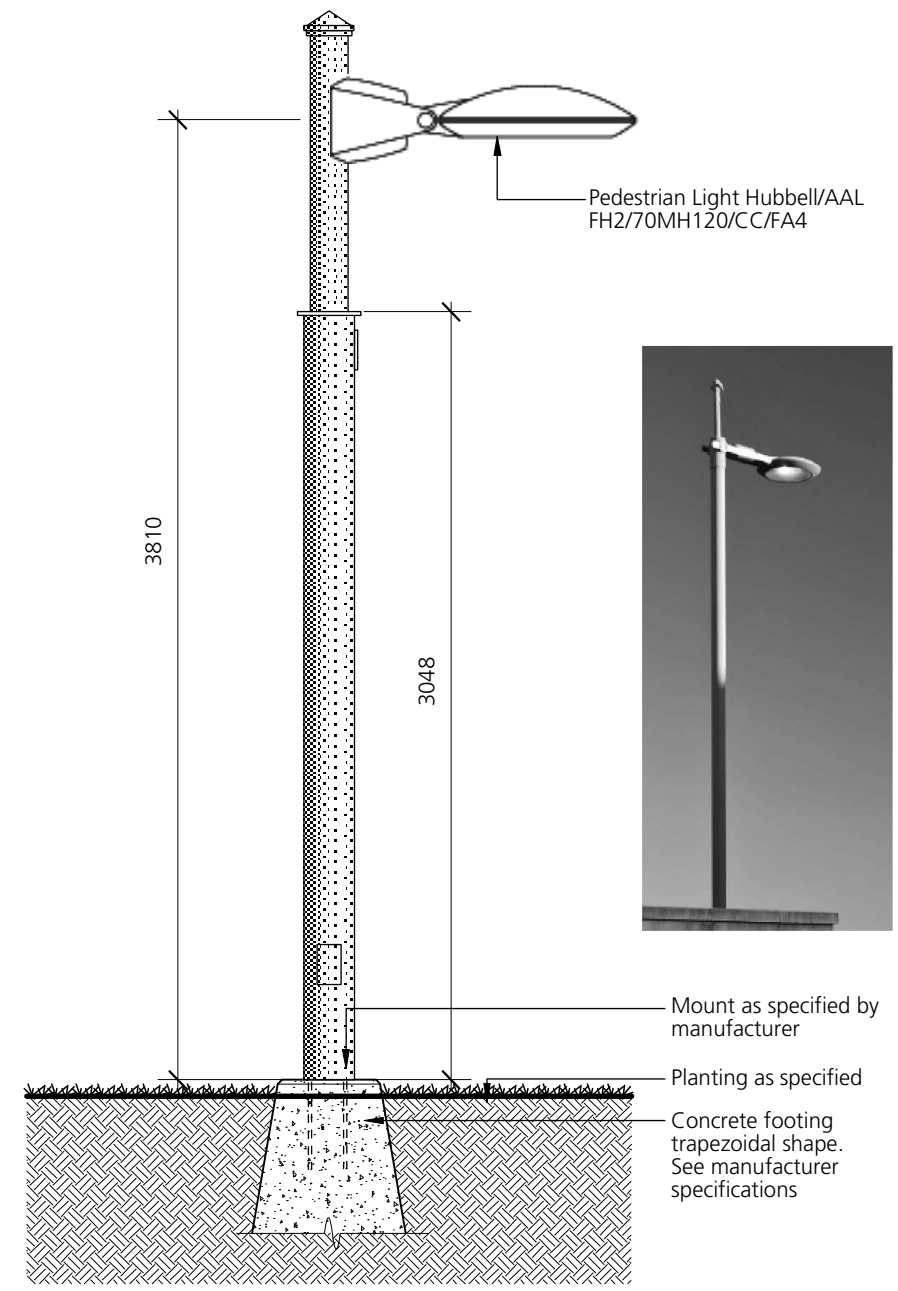

13 Pole Light  
NTS

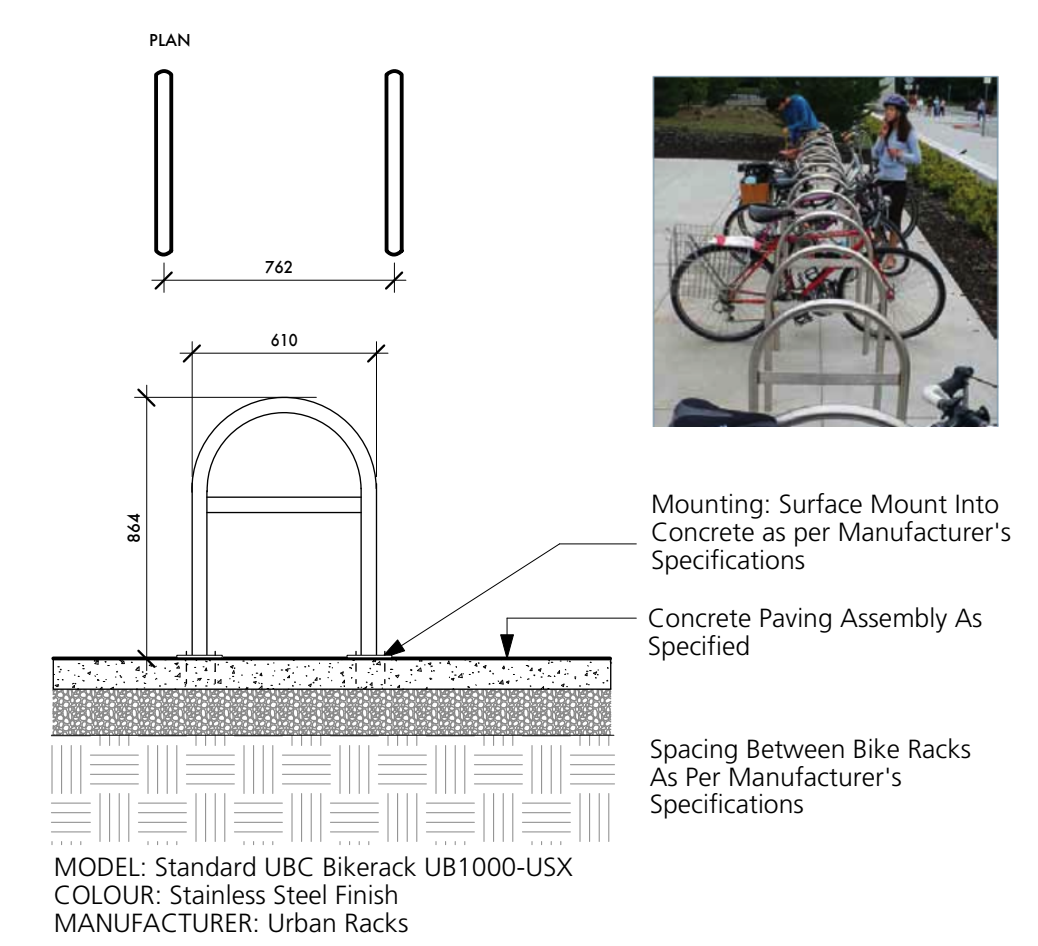

14 Bike Rack  
1:25

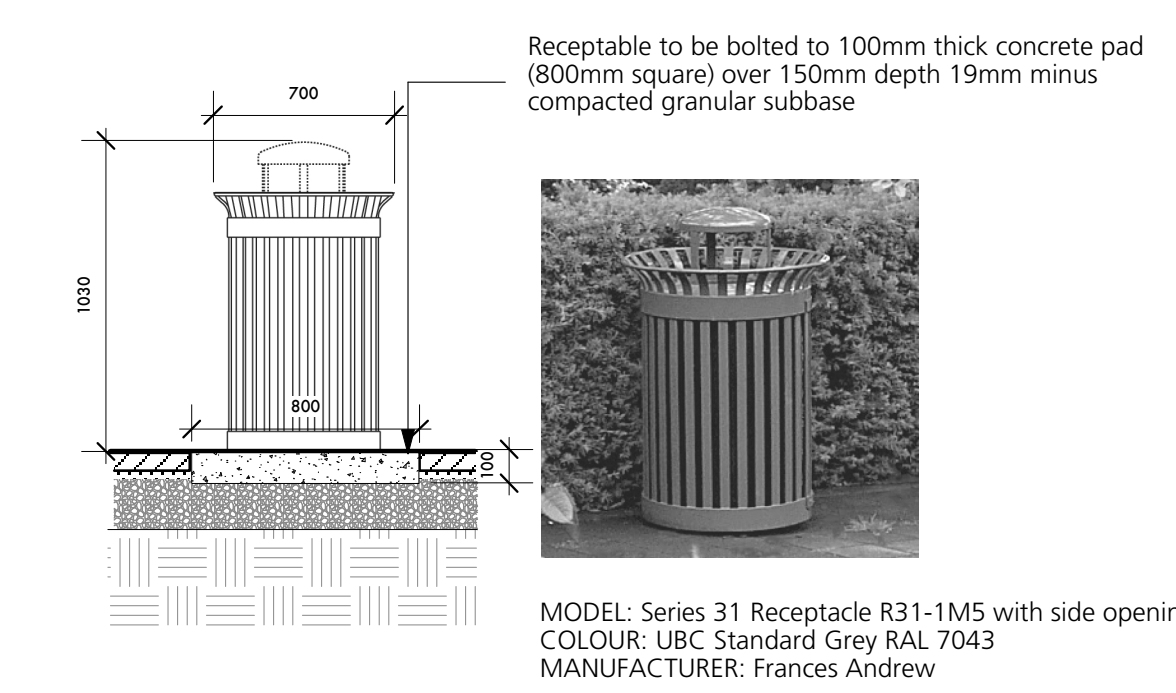

15 Trash Receptacle  
1:25

- NOTE:**
1. MIN. ROOT SPREAD TO BE IN ACCORDANCE WITH "AMERICAN STANDARDS FOR NURSERY STOCK"
  2. FOR CONTAINER-GROWN SHRUBS, USE FINGERS OR SMALL HAND TOOLS TO PULL THE ROOTS OUT OF THE OUTER LAYER OF POTTING SOIL; THEN CUT OR PULL APART ANY ROOTS THAT CIRCLE THE PERIMETER OF THE CONTAINER. PRUNE ALL DAMAGED, DISEASED, OR WEAK LIMBS AND ROOTS.
  3. CLEANLY PRUNE ALL DAMAGED ROOT ENDS.
  4. FOLD BURLAP FROM TOP OF ROOT BALL DOWN INTO GROUND SET TOP OF BALL FLUSH WITH FINISH GRADE.
  5. DO NOT ALLOW ROOTS TO DRY OUT DURING INSTALLATION PROCESS.
  6. SOAK ROOTS IN WATER OVERNIGHT BEFORE PLANTING.

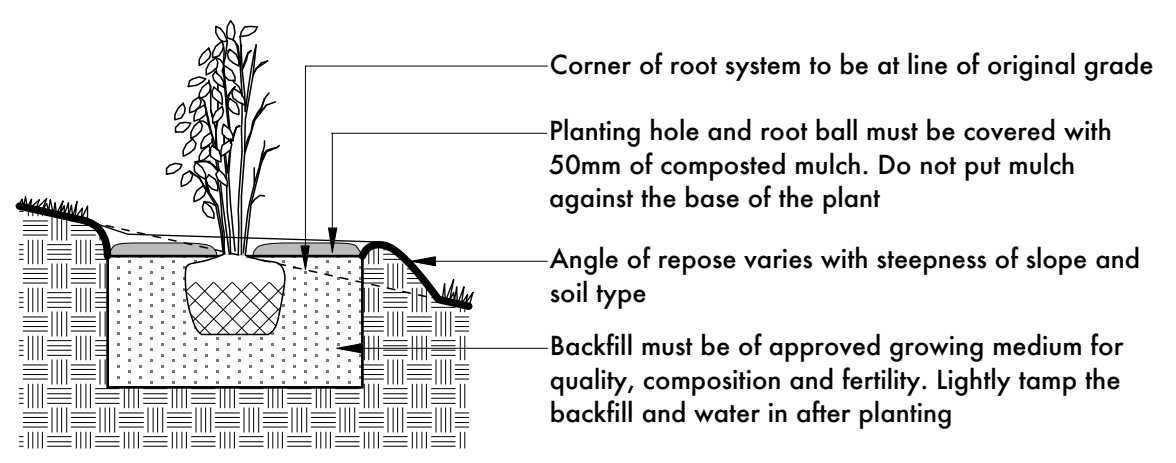
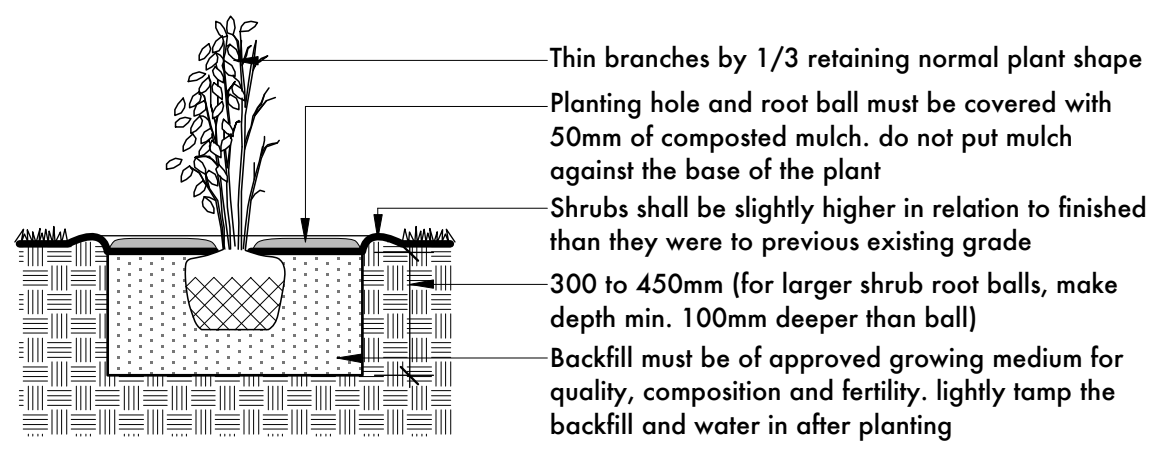

16 Shrub and Groundcover Planting  
1:25

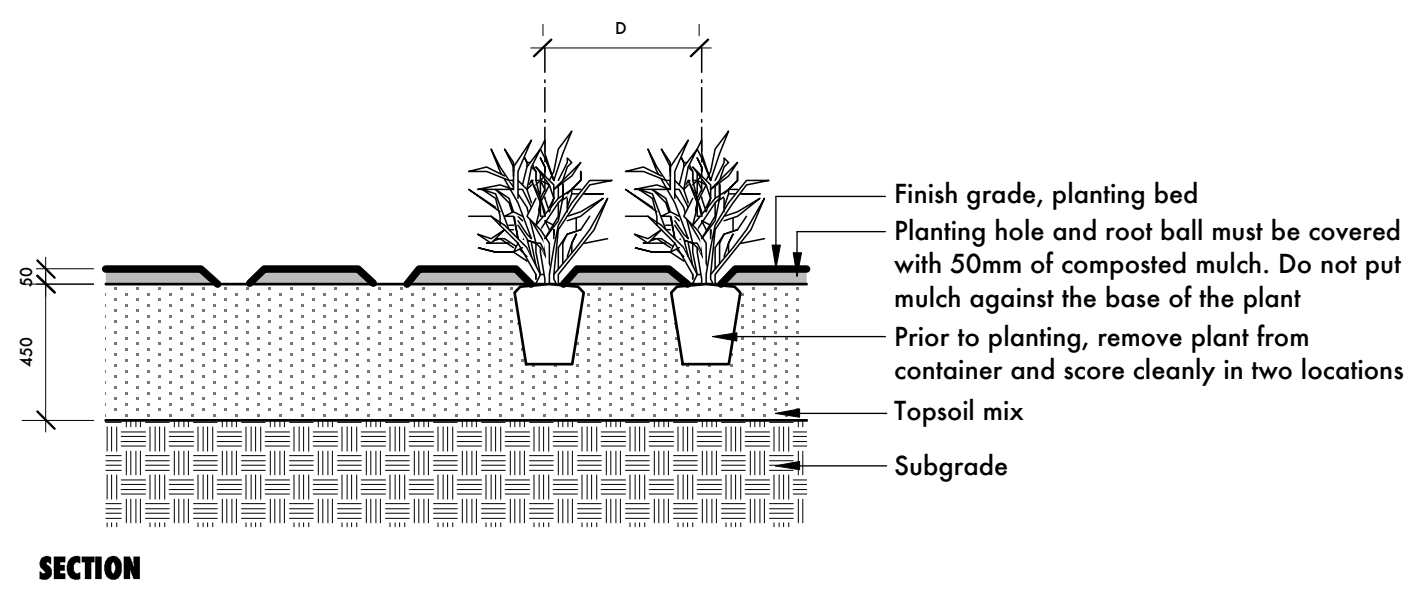
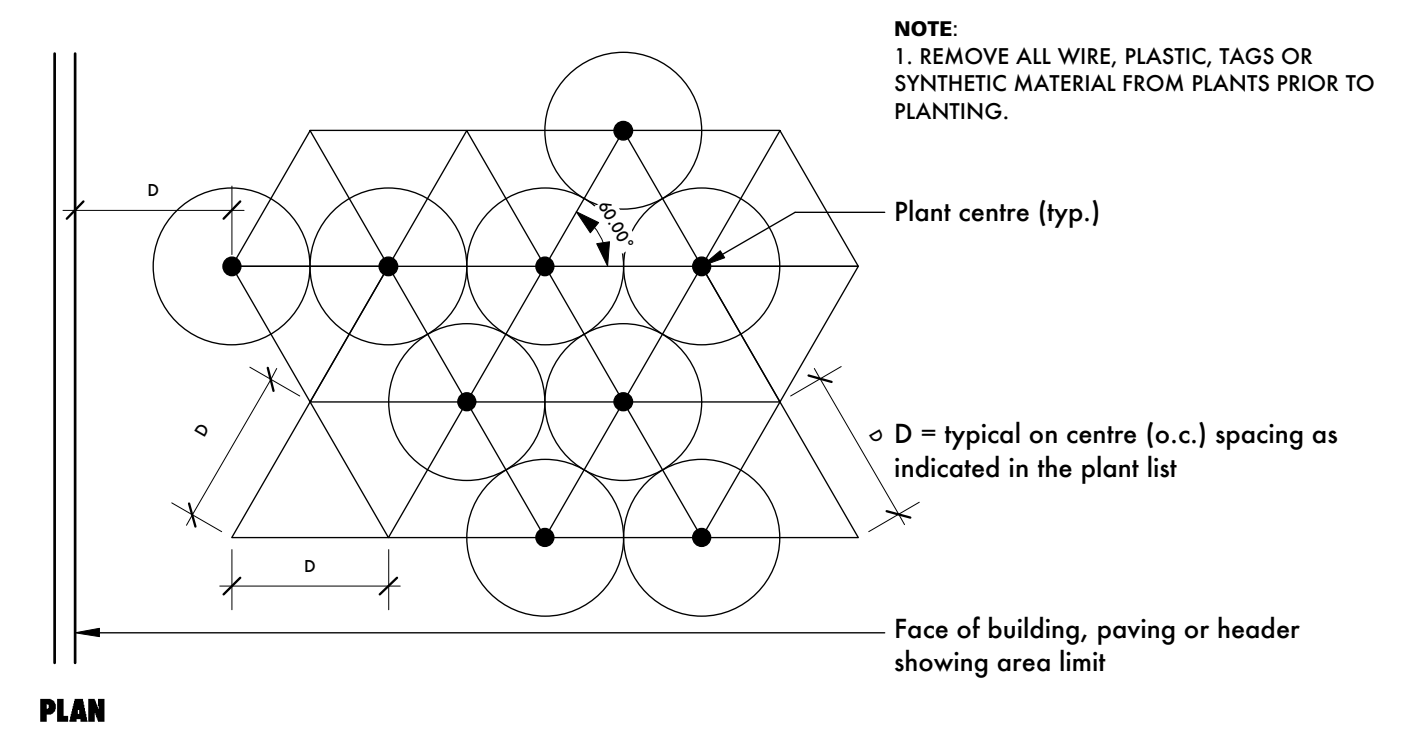

- NOTE:**
1. REMOVE ALL WIRE, PLASTIC, TAGS OR SYNTHETIC MATERIAL FROM PLANTS PRIOR TO PLANTING.

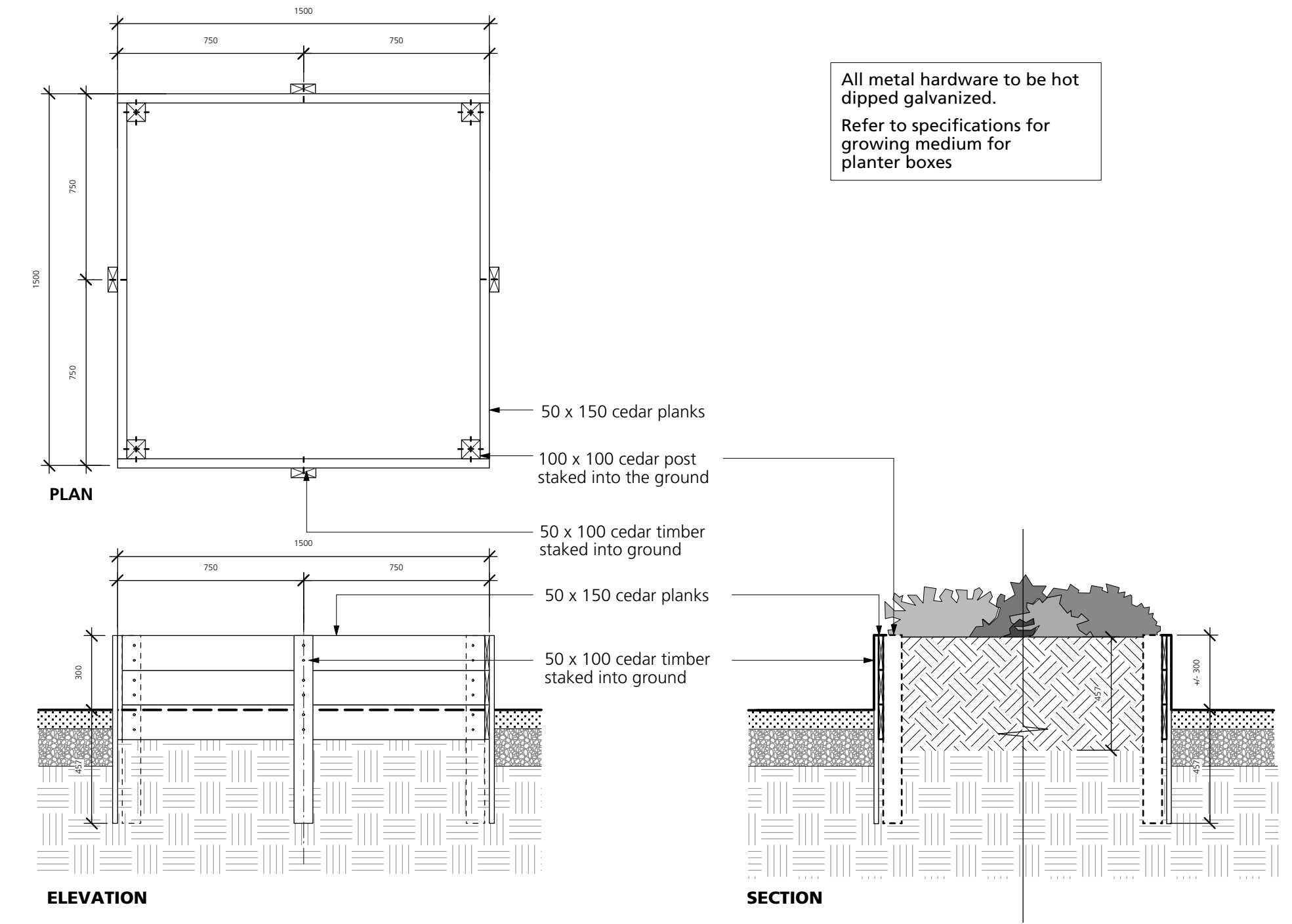

17 Community Garden Planter Box Type 1  
1:20

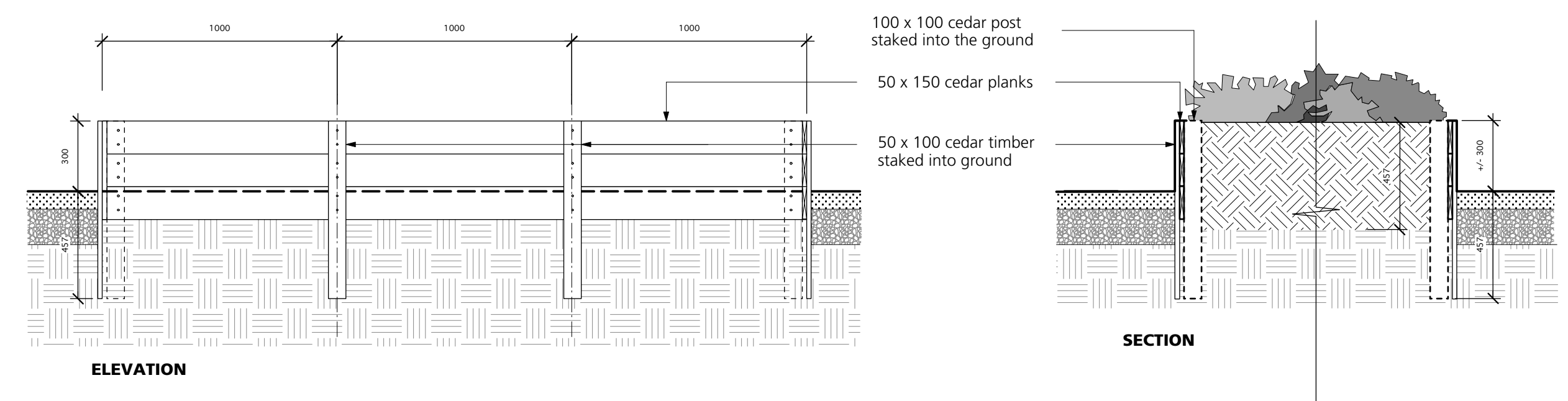

18 Community Garden Planter Box Type 2  
1:20



20 Community Garden Compost Bin  
NTS

2	Issued for DRC Review	09/08/2017
1	Issued for Development Permit	03/28/2017
	Revision No.	Date

COPYRIGHT RESERVED  
 This drawing is and shall remain the property of R. Kim Perry & Associates Inc., and R. Kim Perry & Associates Inc. shall retain the copyright therein. This document shall not be reproduced or used for additions or alterations to the project or for the purpose of any other project without the prior written consent of R. Kim Perry & Associates Inc.

Client:  
**UBC Properties Trust**

Project Title:  
**UBC SC Research Park**

Drawing Title:  
**Landscape Details**

Project North:	Drawn By:	KS
	Checked By:	MP
Scale:	Job No.:	16-043
As shown		
Sheet No.:		



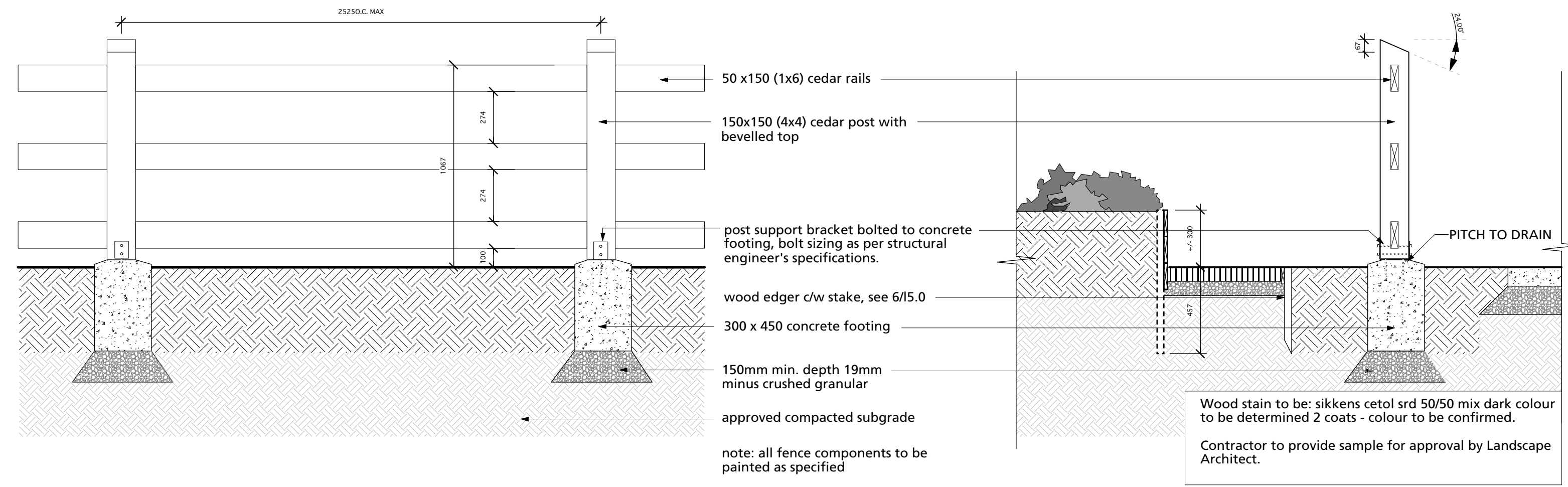

21 Community Garden Fence  
1:20

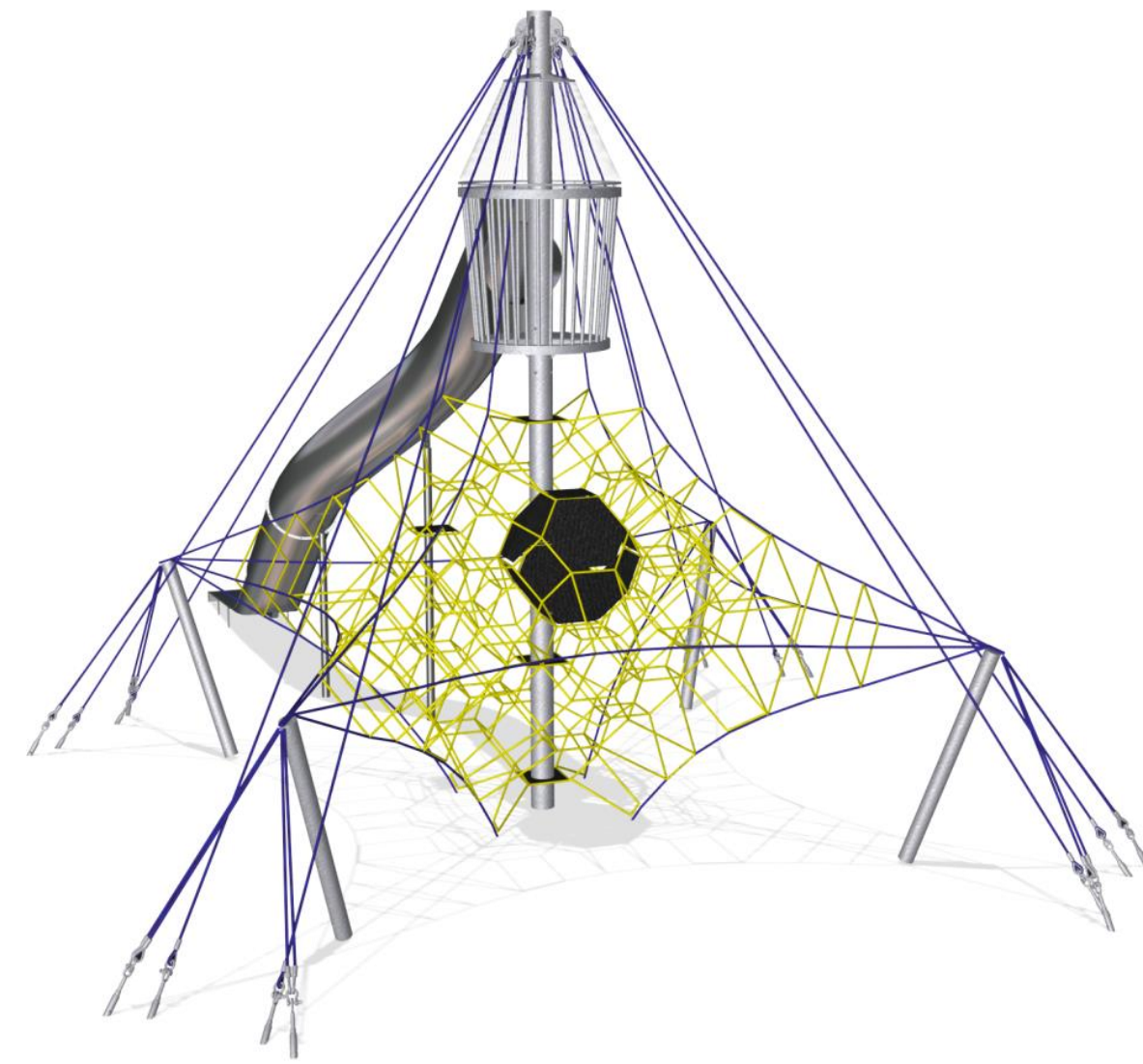

22 Playground Climber  
NTS

TO BE DETERMINED

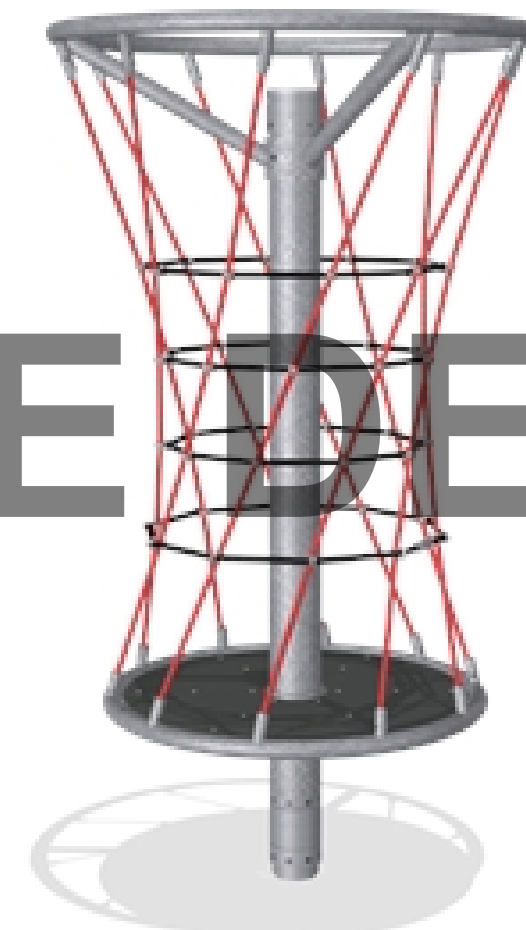

23 Playground Spinner  
NTS



24 Playground Swings  
NTS

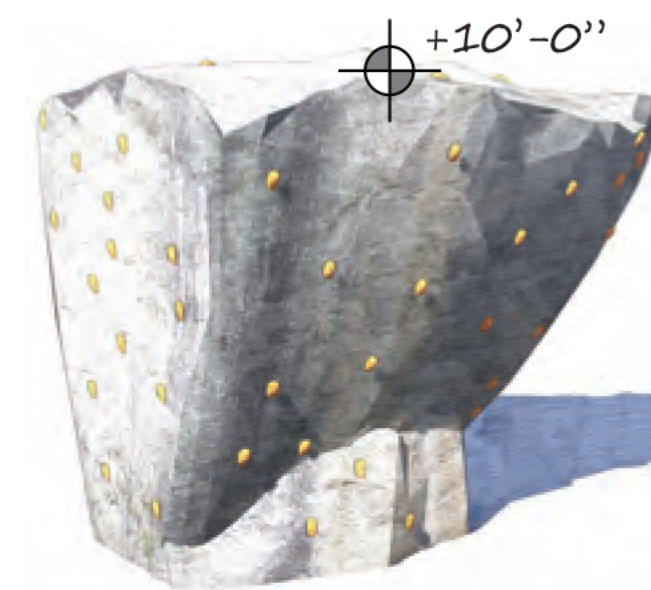

**MEDIUM SIZED**

- 10' average height
- 13' average length
- Approx 350 sf



Boulder by Eldorado Wall Company

25 Climbing Boulder  
NTS

Revision No.	Date
2	09/08/2017
1	03/28/2017

COPYRIGHT RESERVED  
 This drawing is and shall remain the property of R. Kim Perry & Associates Inc., and R. Kim Perry & Associates Inc. shall retain the copyright therein. This document shall not be reproduced or used for additions or alterations to the project or for the purpose of any other project without the prior written consent of R. Kim Perry & Associates Inc.

Client:  
**UBC Properties Trust**

Project Title:  
**UBC SC Research Park**

Drawing Title:  
**Landscape Details**

Project North:	Drawn By:	KS
	Checked By:	MP
Scale:	Job No.:	16-043
As shown		
Sheet No.:		