

ISSUED:	DATE:
1. DP REVIEW by UBCPT	OCT.21.2013
2. DPA	OCT.28.2013
3. PERFORMANCE TENDER	NOV.18.2013
3. DP RE-SUBMISSION	DEC. 3.2013
4. DPA RE-SUBMISSION	DEC.11.2013

ISSUED FOR  
**DP RE-SUBMISSION**  
December 11, 2013

NO. REVISION: DATE:  
This drawing as an instrument of service is the property of Rositch Hemphill Architects and may not be reproduced without the firm's permission. All information shown on the drawing is for use in this specific project only and shall not be used otherwise without written permission from this office. Contractors shall verify and be responsible for all dimensions on the job and this office shall be informed of any discrepancies and variations shown on drawing.

ARCHITECTURAL SEAL:

CLIENT:  
 ADERA  
LIVE WEST COAST

PROJECT:  
**PRODIGY at LOT 32**  
UBC South Campus  
Gray Avenue and Ross Road

DRAWING TITLE:  
**SITE PLAN**  
**FIRE FIGHTER ACCESS**

DATABASE: 1322-A1.2.dwg  
SCALE: 1/16"=1'-0"  
PLOTDATE: DEC. 3.2013  
DRAWN: GJ  
CHECKED:

PROJECT NO. **1322**

DWG. NO.  
**A1.1**

D.P. No:  
B.P. No:

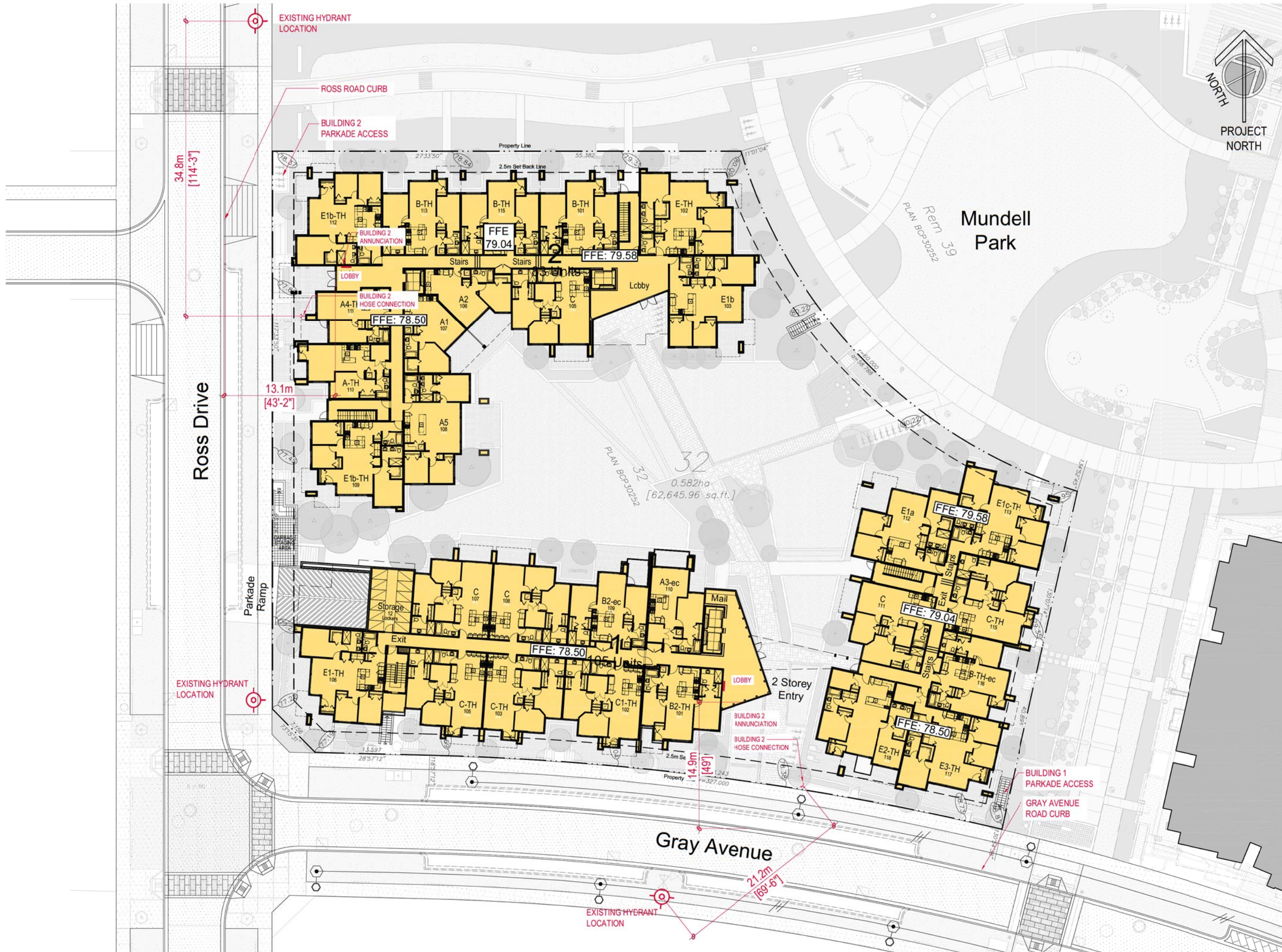



WATER LINES AND HYDRANT LOCATIONS



Rositch Hemphill Architects

120 Powell Street, Unit 10  
Vancouver, BC Canada  
V6A 1G1

t 604.669.6002  
f 604.669.1091

www.rharchitects.ca

ISSUED:	DATE:
1. DP REVIEW by UBCPT	OCT.21.2013
2. DPA	NOV.28.2013
3. PERFORMANCE TENDER	NOV.18.2013
3. DP RE-SUBMISSION	DEC. 3.2013
4. DPA RE-SUBMISSION	DEC.11.2013

ISSUED FOR  
**DP RE-SUBMISSION**  
December 11, 2013

NO. REVISION: DATE:  
This drawing as an instrument of service is the property of Rositch Hemphill Architects and may not be reproduced without the firm's permission. All information shown on the drawing is for use in this specific project only and shall not be used otherwise without written permission from this office. Contractors shall verify and be responsible for all dimensions on the job and this office shall be informed of any discrepancies and variations shown on drawing.

ARCHITECTURAL SEAL:

CLIENT:  
**ADERA**  
LIVE WEST COAST

PROJECT:  
**PRODIGY at LOT 32**  
UBC South Campus  
Gray Avenue and Ross Road

DRAWING TITLE:  
**SITE PLAN - UTILITIES**  
**WATER**  
**HYDRANT LOCATIONS**

DATABASE: 1322-A1.2.dwg  
SCALE: 1/16"=1'-0"  
PLOTDATE: DEC. 3.2013  
DRAWN: GJ  
CHECKED:

PROJECT NO. **1322**

DWG. NO. **A1.2**

D.P. No:  
B.P. No:

E:\ACAD\JOB\2013\1322\DP\1322-A1.2.DWG



ISSUED:	DATE:
1. DP REVIEW by UBCPT	OCT.21.2013
2. DPA	OCT.28.2013
3. PERFORMANCE TENDER	NOV.18.2013
3. DP RE-SUBMISSION	DEC. 3.2013
4. DPA RE-SUBMISSION	DEC.11.2013

ISSUED FOR  
**DP RE-SUBMISSION**  
December 11, 2013

NO. REVISION: DATE:  
This drawing as an instrument of service is the property of Rositch Hemphill Architects and may not be reproduced without the firm's permission. All information shown on the drawing is for use in this specific project only and shall not be used otherwise without written permission from this office. Contractors shall verify and be responsible for all dimensions on the job and this office shall be informed of any discrepancies and variations shown on drawing.

ARCHITECTURAL SEAL:

CLIENT:  
 ADERA  
LIVE WEST COAST

PROJECT:  
**PRODIGY at LOT 32**  
UBC South Campus  
Gray Avenue and Ross Road

DRAWING TITLE:  
**SITE PLAN - UTILITIES**  
**STORM**

DATABASE: 1322-A1.2.dwg  
SCALE: 1/16"=1'-0"  
PLOTDATE: DEC. 3.2013  
DRAWN: GJ  
CHECKED:

PROJECT NO. **1322**

DWG. NO. **A1.4**

D.P. No:  
B.P. No:

STORM LINES



Mundell Park

Gray Avenue

Ross Drive



E:\ACAD\JOB\2013\1322\DP\1322-A1.2.DWG



# HYDRO LINES AND STREET LIGHTING



Rositch Hemphill Architects

120 Powell Street, Unit 10  
Vancouver, BC Canada  
V6A 1G1

t 604.669.6002  
f 604.669.1091

www.rharchitects.ca

ISSUED:	DATE:
1. DP REVIEW by UBCPT	OCT.21.2013
2. DPA	OCT.28.2013
3. PERFORMANCE TENDER	NOV.18.2013
4. DP RE-SUBMISSION	DEC. 3.2013
5. DPA RE-SUBMISSION	DEC.11.2013

ISSUED FOR  
**DP RE-SUBMISSION**  
 December 11, 2013

NO. REVISION: DATE:  
 This drawing as an instrument of service is the property of Rositch Hemphill Architects and may not be reproduced without the firm's permission. All information shown on the drawing is for use in this specific project only and shall not be used otherwise without written permission from this office. Contractors shall verify and be responsible for all dimensions on the job and this office shall be informed of any discrepancies and variations shown on drawing.

ARCHITECTURAL SEAL:

CLIENT:  
 ADERA  
 LIVE WEST COAST

PROJECT:  
**PRODIGY at LOT 32**  
 UBC South Campus  
 Gray Avenue and Ross Road

DRAWING TITLE:  
**SITE PLAN - UTILITIES**  
 ELECTRICAL  
 STREETLIGHTS

DATABASE: 1322-A1.2.dwg  
 SCALE: 1/16"=1'-0"  
 PLOTDATE: DEC. 3.2013  
 DRAWN: GJ  
 CHECKED:

PROJECT NO. **1322**

DWG. NO.  
**A1.5**

D.P. No:  
B.P. No:

E:\ACAD\JOB\2013\1322\DP\1322-A1.2.DWG

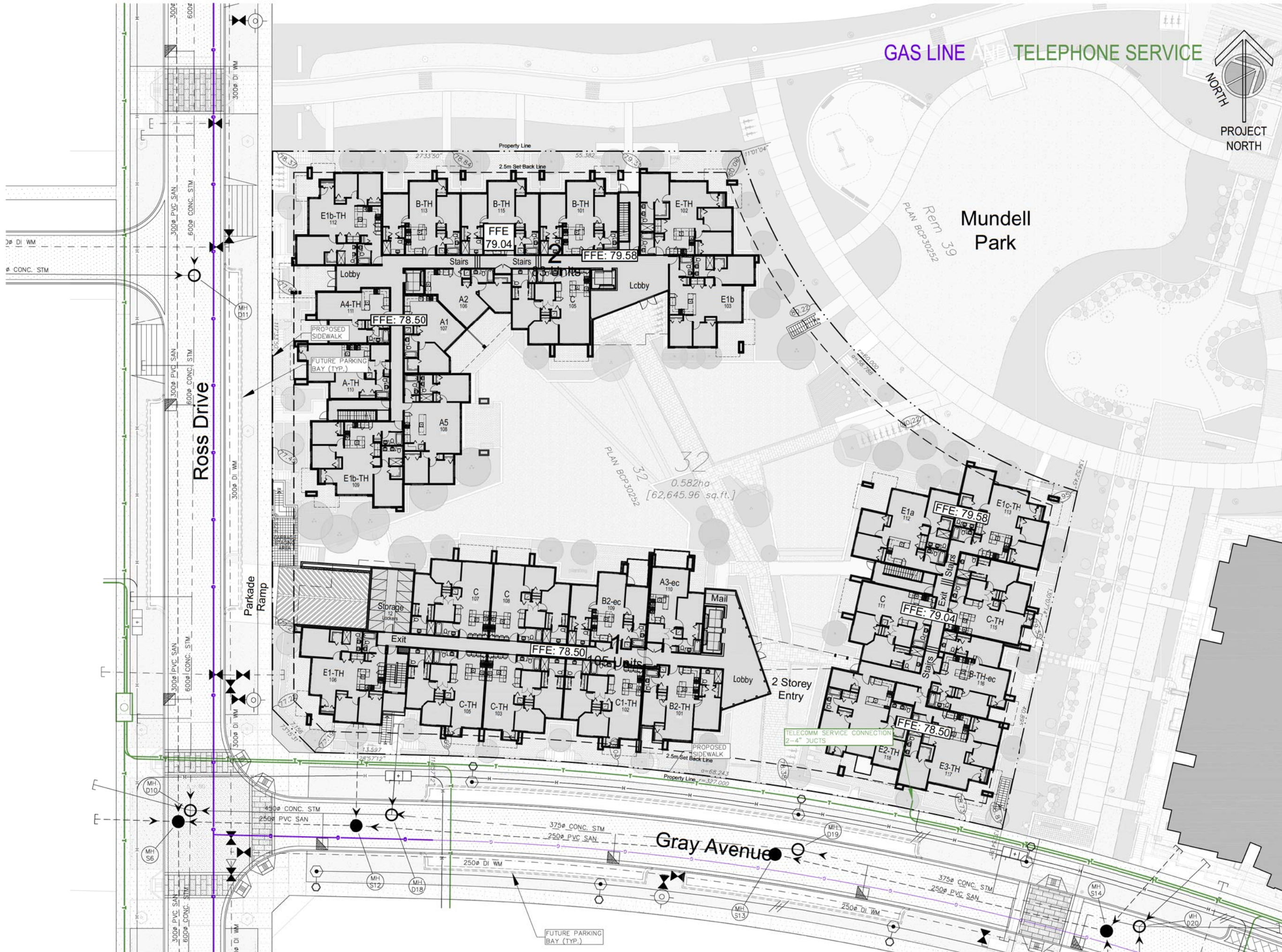

GAS LINE TELEPHONE SERVICE



Rositch Hemphill Architects

120 Powell Street, Unit 10  
Vancouver, BC Canada  
V6A 1G1

t 604.669.6002  
f 604.669.1091

www.rharchitects.ca

ISSUED:	DATE:
1. DP REVIEW by UBCPT	OCT.21.2013
2. DPA	OCT.28.2013
3. PERFORMANCE TENDER	NOV.18.2013
3. DP RE-SUBMISSION	DEC. 3.2013
4. DPA RE-SUBMISSION	DEC.11.2013

ISSUED FOR  
**DP RE-SUBMISSION**  
December 11, 2013

NO. REVISION: DATE:  
This drawing as an instrument of service is the property of Rositch Hemphill Architects and may not be reproduced without the firm's permission. All information shown on the drawing is for use in this specific project only and shall not be used otherwise without written permission from this office. Contractors shall verify and be responsible for all dimensions on the job and this office shall be informed of any discrepancies and variations shown on drawing.

ARCHITECTURAL SEAL:

CLIENT:  
**ADERA**  
LIVE WEST COAST

PROJECT:  
**PRODIGY at LOT 32**  
UBC South Campus  
Gray Avenue and Ross Road

DRAWING TITLE:  
**SITE PLAN - UTILITIES**  
GAS  
TELEPHONE

DATABASE: 1322-A1.2.dwg  
SCALE: 1/16"=1'-0"  
PLOTDATE: DEC. 3.2013  
DRAWN: GJ  
CHECKED:

PROJECT NO. **1322**

DWG. NO.  
**A1.6**

D.P. No:  
B.P. No: