



THE UNIVERSITY OF BRITISH COLUMBIA ASSUMES NO RESPONSIBILITY FOR CORRECTNESS OF INFORMATION SHOWN

| NO | DESCRIPTION | DATE | BY |
|----|---|-----------|-----|
| 11 | WESBROOK SUPERMARKET UNIT SUB | FEB 4/09 | DJS |
| 12 | WESBROOK PLACE PH1 EAST BOYDING (MFD ONLY) AND TELCOM | AUG 27/08 | DJS |
| 13 | TELECOM HUB @ WESBROOK/ BERTON, VARIOUS HYDRO PRELIM | JAN 18/10 | DJS |
| 14 | BC HYDRO AS-BUILT DWGS FOR WESBROOK PH1 EAST | APR 7/10 | DJS |
| 15 | POWER SERVICE TO GC LOT 18 | JAN 15/09 | DJS |

| SECTOR INDEX | |
|--------------|----|
| 13 | 14 |
| 15 | 16 |
| 17 | 18 |
| 19 | 20 |
| 21 | 22 |
| 23 | 24 |
| 25 | 26 |
| 27 | 28 |
| 29 | 30 |
| 31 | 32 |

The University of British Columbia
Land and Building Services

SCALE: 1:600
1" = 50'



ELECTRICAL
(EXCLUDING STREET LIGHTS)

SECTOR
22

NOTE: When converting metric to imperial elevations include 91.62 feet to the imperial geodetic base. For details refer to UBC Monument - Plan Standard No.01-01

Acad 18.0s (LMS Tech) R:\UBC_Map\base\electrical\elec-base.dwg (22), Apr 07, 2010 - 10:55am

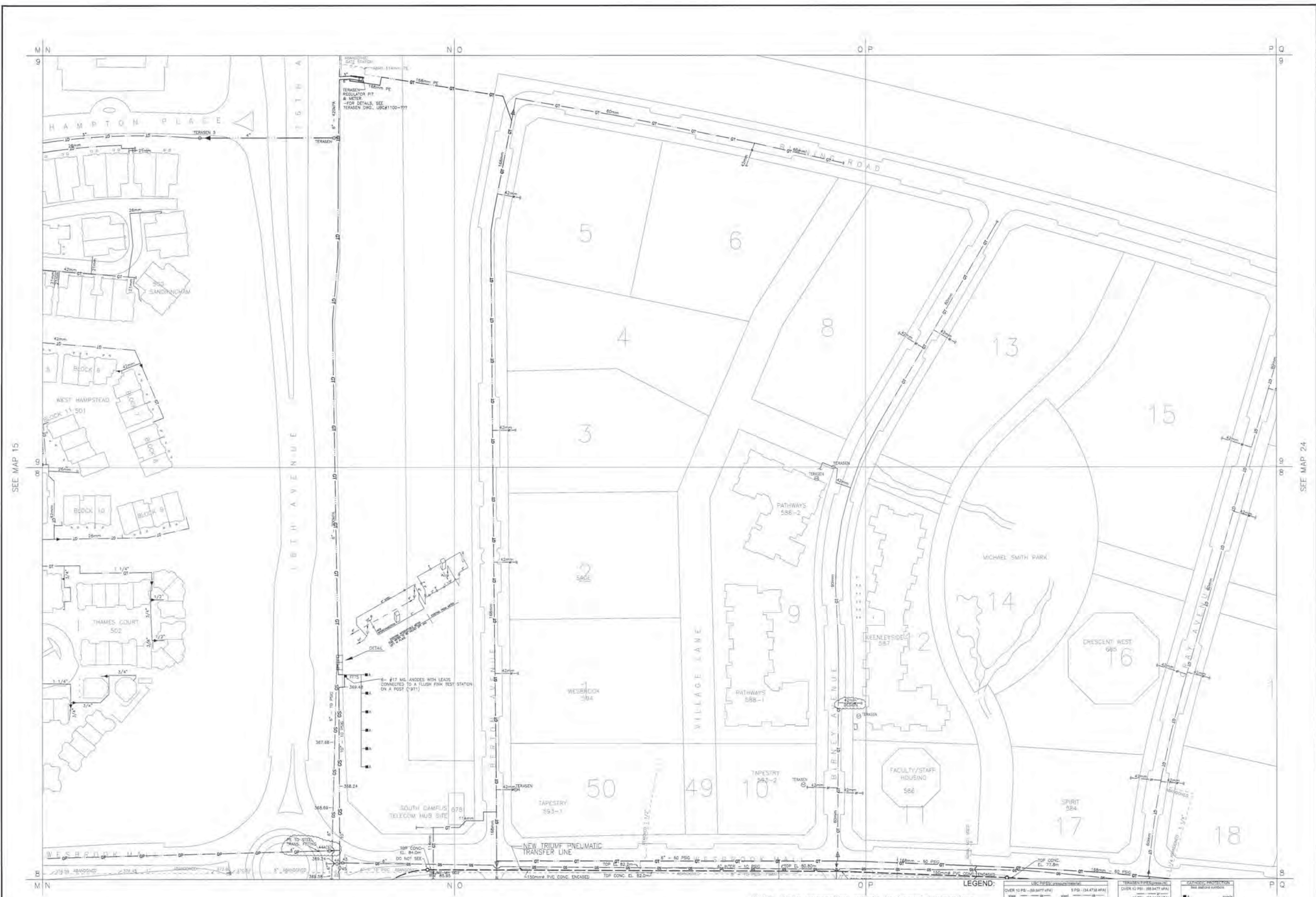

SEE MAP 15

SEE MAP 24

SEE MAP 21

NOTE: When converting metric to Imperial elevations include 91.62 feet to the Imperial geodetic base. For details refer to UBC Monuments Plan - Standard No.01-01

LEGEND:

| | | |
|--|---|---|
| UBC PRESSURIZED GAS OVER 10 PSI - (68.9477 kPa) | TERASEN PIPE (ENCASED) OVER 12 PSI - (82.7477 kPa) | GAS CONDUIT PROJECTIONS See schedule symbols ■ SWIRLS ■ 1/2" DIA. (12.7mm) ■ 1/4" DIA. (6.35mm) ■ 1/8" DIA. (3.175mm) ■ 1/16" DIA. (1.5875mm) |
| UBC PRESSURIZED GAS OVER 12 PSI - (82.7477 kPa) | TERASEN PIPE (ENCASED) OVER 10 PSI - (68.9477 kPa) | |
| UBC PRESSURIZED GAS OVER 15 PSI - (103.4277 kPa) | TERASEN PIPE (ENCASED) OVER 15 PSI - (103.4277 kPa) | |
| UBC PRESSURIZED GAS OVER 20 PSI - (137.9077 kPa) | TERASEN PIPE (ENCASED) OVER 20 PSI - (137.9077 kPa) | |

THE UNIVERSITY OF BRITISH COLUMBIA ASSUMES NO RESPONSIBILITY FOR CORRECTNESS OF INFORMATION SHOWN.

| REVISED TO LATEST DATE | NO | DESCRIPTION | DATE | BY |
|------------------------|----|--|-----------|-----|
| | 11 | SOUTH CAMPUS PARKING LOT SITE | 30 MAY 04 | 028 |
| | 12 | WESTBROOK PLACE PH1 EAST, PH1 WEST IS PROPOSED | AUG 20/08 | 028 |
| | 13 | WESTBROOK PLACE PH1-EAST TERASEN GAS LINES & TRUMP LINE | JAN 15/09 | 028 |
| | 14 | UPGRADED TERASEN LINES @ WESTBROOK PH1-EAST & TRUMP LINE | AUG 21/09 | 028 |
| | 15 | TERASEN REGULATOR PH1 16TH AVE | JAN 28/10 | 028 |

| SECTOR INDEX | |
|--------------|-----------------------|
| NORTH | 4 5 12 13 22 24 30 |
| EAST | 3 8 11 16 21 25 29 31 |
| SOUTH | 2 7 10 17 20 26 28 |
| WEST | 1 6 9 14 19 27 |



The University of British Columbia
Land and Building Services



GAS

SECTOR
22

M N
9
8
M N

N O
N O
N O

O P
O P
O P

P Q
P Q
P Q

SEE MAP 15

SEE MAP 24

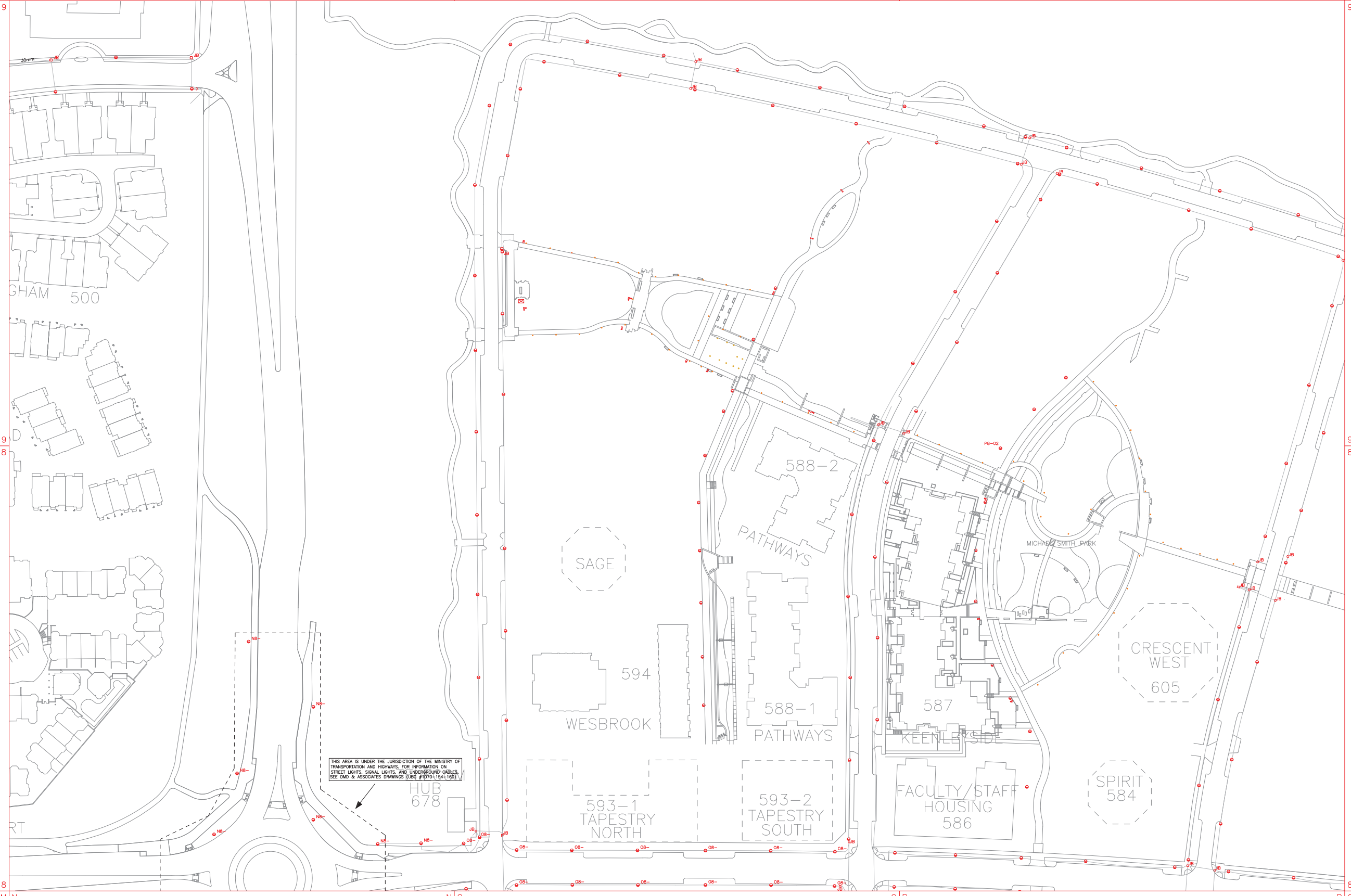

THIS AREA IS UNDER THE JURISDICTION OF THE MINISTRY OF TRANSPORTATION AND HIGHWAYS. FOR INFORMATION ON STREET LIGHTS, SIGNAL LIGHTS, AND UNDERGROUND CABLES, SEE DMD & ASSOCIATES DRAWINGS (URC #1070-154-160)

HUB 678

SAGE

594

WESBROOK

593-1 TAPESTRY NORTH

593-2 TAPESTRY SOUTH

588-2

PATHWAYS

588-1

PATHWAYS

587

KEENLE SIDE

FACULTY/STAFF HOUSING 586

CRESCENT WEST 605

SPIRIT 584

SEE MAP 21

NOTE: When converting metric to imperial elevation include 91.62 feet to the imperial geodetic base. For details refer to UBC Monument Plan Standard No.01-01

THE UNIVERSITY OF BRITISH COLUMBIA ASSUMES NO RESPONSIBILITY FOR CORRECTNESS OF INFORMATION SHOWN.

REVISED TO LATEST DATE

| NO | DESCRIPTION | DATE | BY |
|----|---|-----------|-----|
| 6 | WESBROOK PLACE PARKS LIGHTING | APR 6/11 | HGH |
| 7 | KHORANA & MICHAEL SMITH PARKS LIGHTING | APR 21/11 | HGH |
| 3 | STREET LIGHT RE-NUMBERING AS PER BC HYDRO | JUN 15/09 | RO |
| 4 | WESBROOK PLACE PHASE 1 EAST | OCT 14/09 | HCW |
| 5 | ROUNDOFF INFORMATION DWG. 1070-162 | JAN 20/10 | DCB |

| | | SECTOR INDEX | | | | | |
|---------|---|--------------|----|----|----|----|----|
| | | 13 | 14 | 23 | | | |
| 13NORTH | 4 | 5 | 12 | 15 | 22 | 24 | 30 |
| 13NORTH | 3 | 6 | 11 | 16 | 21 | 25 | 29 |
| 13NORTH | 2 | 7 | 10 | 17 | 20 | 26 | 28 |
| 13NORTH | 1 | 8 | 9 | 18 | 19 | 27 | |
| | | | | | | | |

The University of British Columbia
Land and Building Services

FOR REFERENCE ONLY



STREET LIGHTS

SECTOR
22

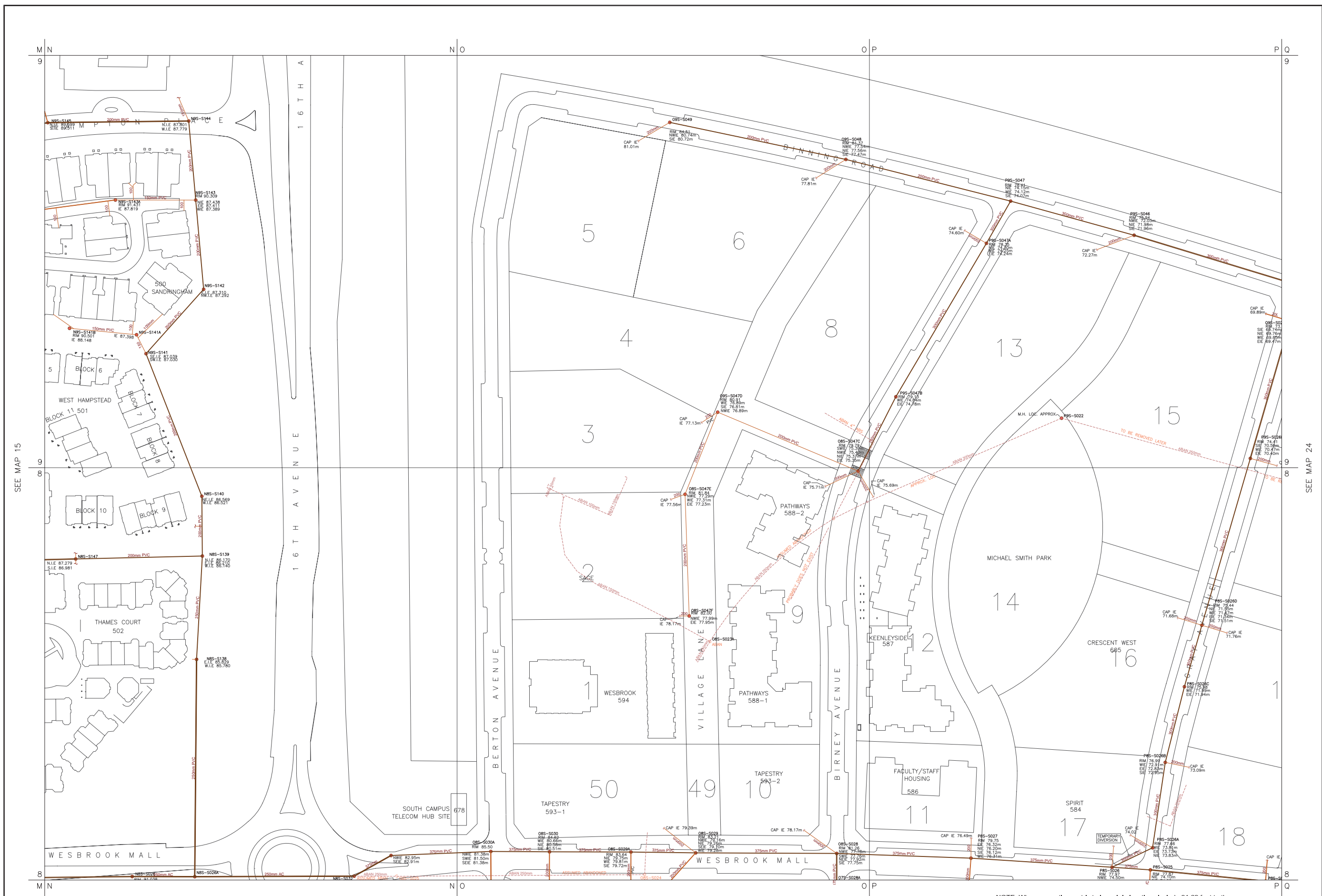

THE UNIVERSITY OF BRITISH COLUMBIA ASSUMES NO RESPONSIBILITY FOR CORRECTNESS OF INFORMATION SHOWN.

| REVISED TO LATEST DATE | NO | DESCRIPTION | DATE | BY |
|------------------------|----|--|-------------|-----|
| | 6 | WESBROOK PLACE PH1 EAST | OCT. 2/07 | DCB |
| | 7 | WESBROOK PLACE PH1 EAST, REVISED WITH ROADWORK | JUNE 3/09 | DCB |
| | 8 | PARKS AT WESBROOK PLACE PH1 EAST | APRIL 13/11 | DCB |
| | 4 | VARIOUS MH/UPDATE UTILITIES MARKUP | JAN/04 | NV |
| | 5 | SOUTH CAMPUS PARKING SITE | MAY 20/04 | DCB |

| SECTOR INDEX | |
|--------------|------|
| 113 | 14 |
| 12 | 15 |
| 13 | 22 |
| 24 | 30 |
| 25 | 29 |
| 26 | 28 |
| 18 | 19 |
| 19 | 27 |
| WEST | EAST |

The University of British Columbia
Land and Building Services

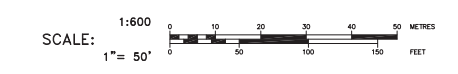

SANITARY

SECTOR
22

NOTE: When converting metric to Imperial elevations include 91.62 feet to the imperial geoidetic base.
For details refer to UBC Monuments Plan-Standard No.01-01

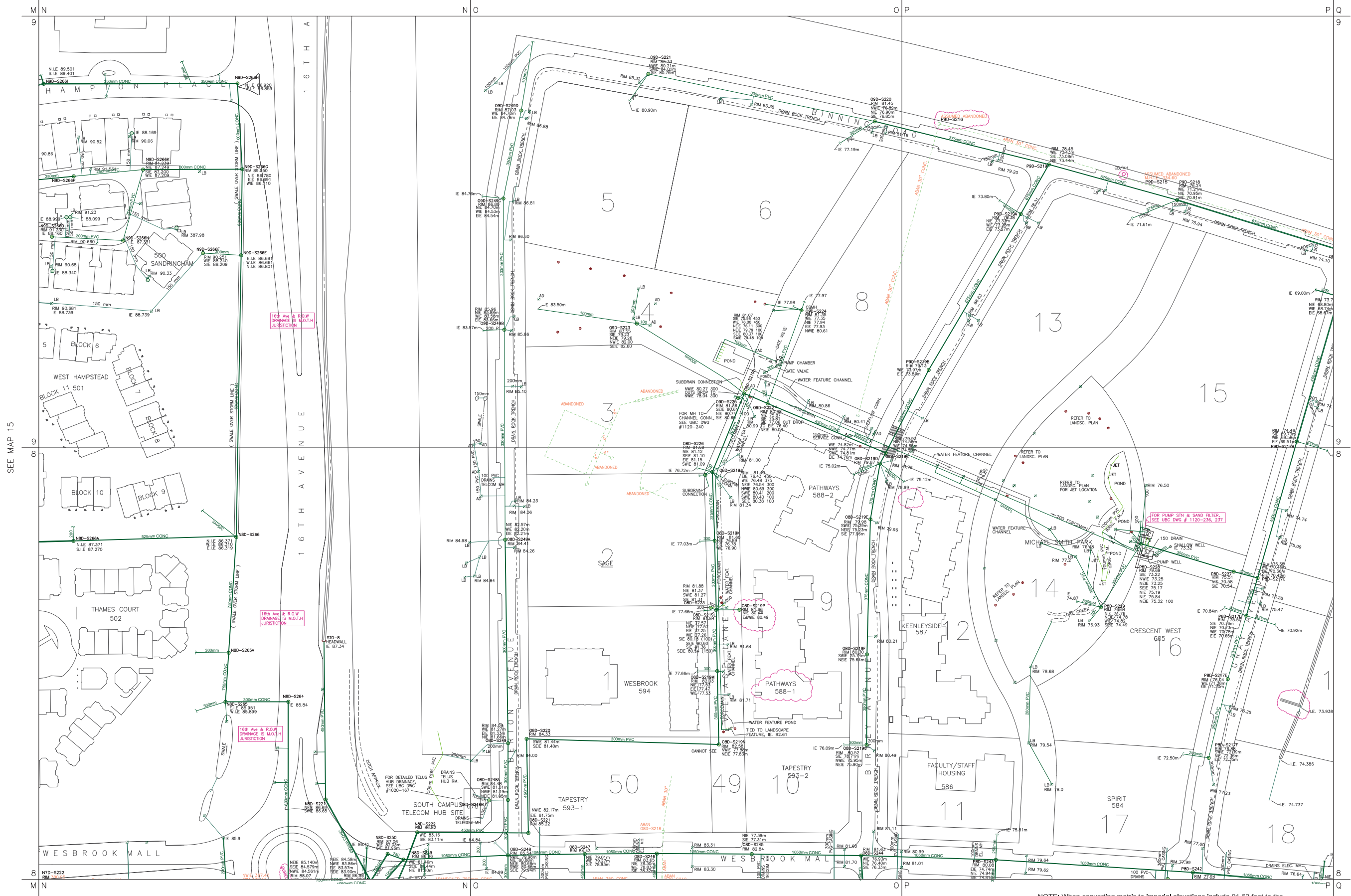

NOTE: When converting metric to imperial elevations include 91.62 feet to the Imperial geodetic base.
For details refer to UBC Monuments Plan - Standard No.01-01

SEE MAP 21

THE UNIVERSITY OF BRITISH COLUMBIA ASSUMES NO RESPONSIBILITY FOR CORRECTNESS OF INFORMATION SHOWN.

REVISED TO LATEST DATE

| NO | DESCRIPTION | DATE | BY |
|----|--|-------------|-----|
| 6 | WESBROOK PLACE PH1 | OCT. 17/07 | DCB |
| 7 | WESBROOK PLACE PH1 - EAST, REVISED WITH ROADWORK | JULY 2/09 | DCB |
| 8 | KHORANA & SMITH PARKS AT WESBROOK PLACE PH1 - EAST | APRIL 7/11 | DCB |
| 9 | 16TH AVE ROUNDABOUT | APRIL 13/11 | DCB |
| 5 | 2ND MARKUPS FROM UTILITIES | OCT 31/03 | DCB |

| SECTOR INDEX | |
|--------------|----|
| 13 | 14 |
| 12 | 15 |
| 11 | 16 |
| 10 | 17 |
| 9 | 18 |
| 8 | 19 |
| 7 | 20 |
| 6 | 21 |
| 5 | 22 |
| 4 | 23 |
| 3 | 24 |
| 2 | 25 |
| 1 | 26 |
| WEST | 27 |



The University of British Columbia
Land and Building Services

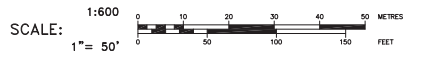

STORM

SECTOR
22

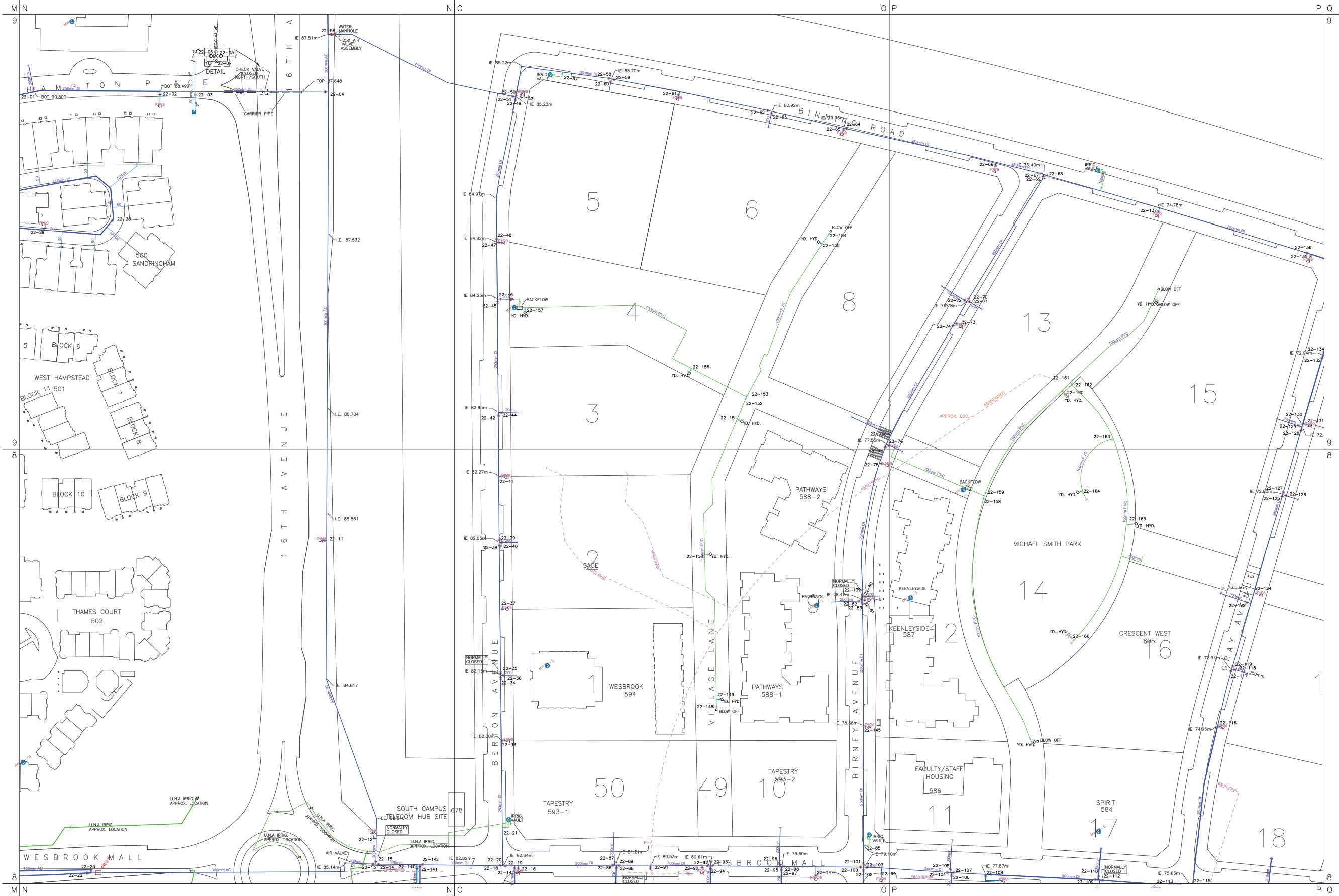

SEE MAP 15

SEE MAP 24

SEE MAP 21

THE UNIVERSITY OF BRITISH COLUMBIA ASSUMES NO RESPONSIBILITY FOR CORRECTNESS OF INFORMATION SHOWN.

| REVISED TO LATEST DATE | NO | DESCRIPTION | DATE | BY |
|------------------------|----|---|------------|-----|
| | 6 | WESBROOK PLACE PH1 EAST - REVISED WITH ROADWORK | JULY 28/09 | DCB |
| | 7 | KHORANA & SMITH PARKS AT WESBROOK PL PH1 EAST | MAR 7/11 | DCB |
| | 3 | SOUTH CAMPUS PARKING SITE | MAY 20/04 | DCB |
| | 4 | UTILITIES MARK UPS 2 | JUN 01/04 | NV |
| | 5 | WESBROOK PLACE PH1 | SEPT 28/07 | DCB |

| SECTOR INDEX | |
|--------------|----|
| 13 | 14 |
| 15 | 23 |
| 24 | 30 |
| 31 | |
| 32 | |
| 33 | |
| 34 | |
| 35 | |
| 36 | |
| 37 | |
| 38 | |
| 39 | |
| 40 | |
| 41 | |
| 42 | |
| 43 | |
| 44 | |
| 45 | |
| 46 | |
| 47 | |
| 48 | |
| 49 | |
| 50 | |



The University of British Columbia
Land and Building Services

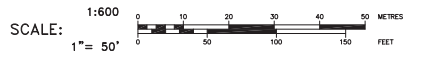

WATER

SECTOR
22