

ISSUES +	NO	DATE	DESCRIPTION
	24	NOV 2011	ISSUED FOR DEVELOPMENT PERMIT

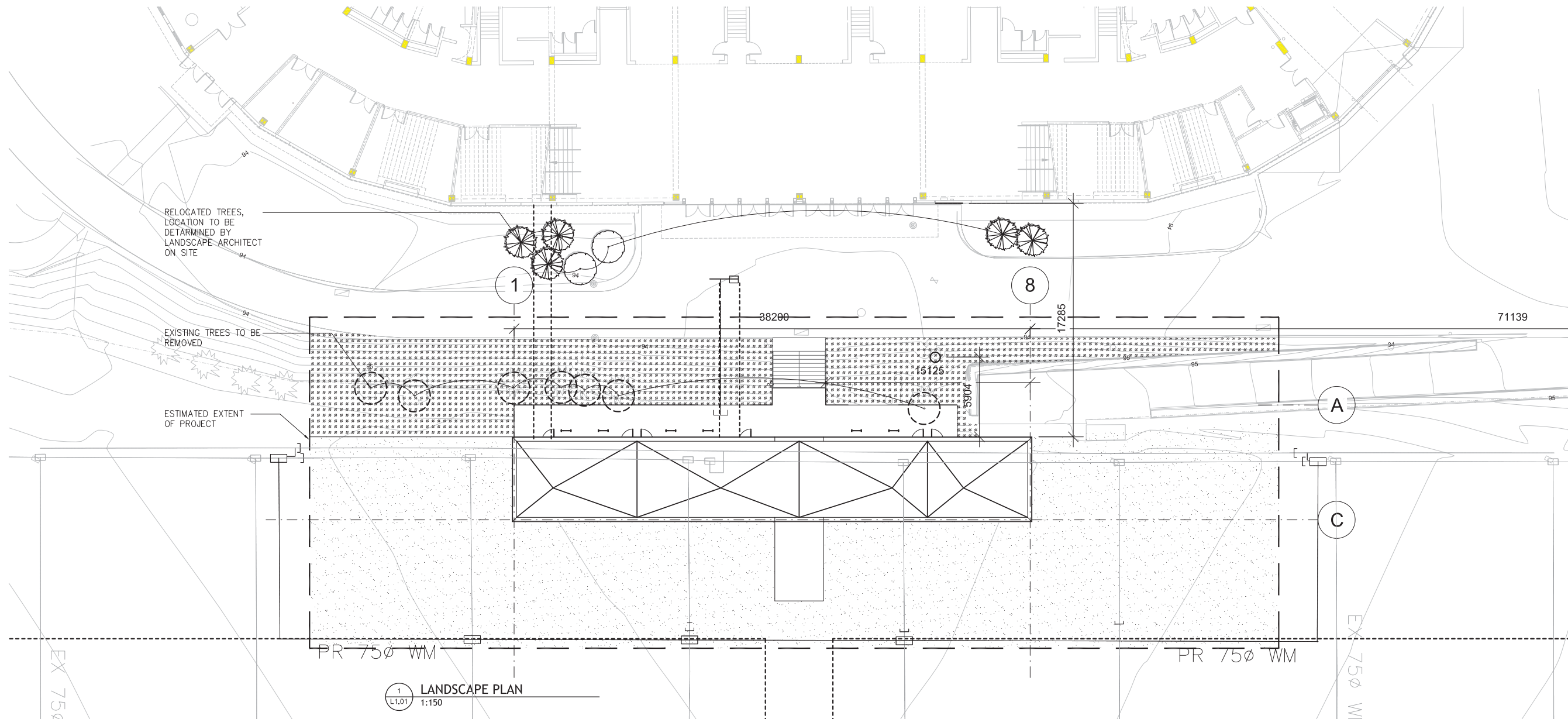

1 LANDSCAPE PLAN
L1.01 1:150

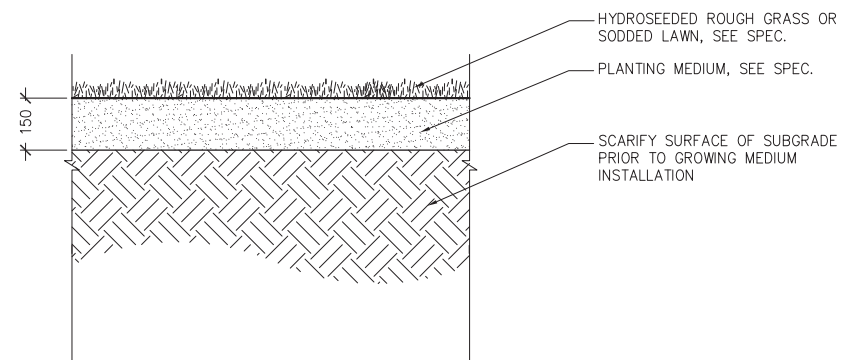

2 SOIL PROFILE FOR LAWN PLANTING
L1.01 NTS

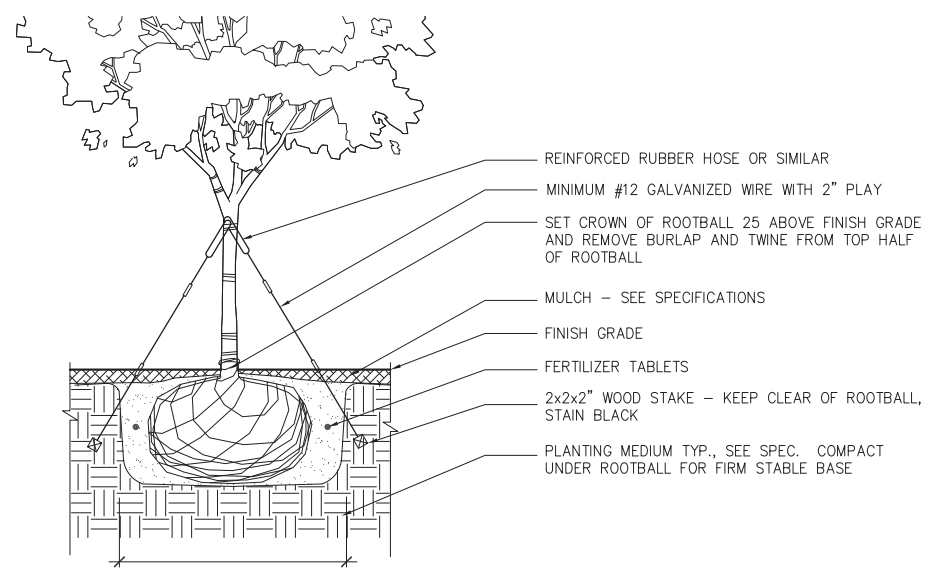

3 SOIL PROFILE FOR LAWN PLANTING
L1.01 NTS

- LEGEND**
- [Pattern] SODDED LAWN
 - [Pattern] HYDROSEEDED ROUGH GRASS
 - [Symbol] EXISTING TREES TO BE REMOVED AND RELOCATED
 - [Symbol] RELOCATED TREES

- NOTES:**
- REFER TO SPECIFICATIONS FOR GROWING MEDIUM, SODDED LAWN, LAWNS AND MEADOWS, IRRIGATION AND TREE RELOCATION.
 - RECONFIGURE EXISTING IRRIGATION LATERAL LINES AND SPRAYHEADS FOR FIELD IRRIGATION TO MAINTAIN FULL AND COMPLETE COVERAGE OF LAWN AREA. REFER TO CIVIL. PROVIDE AS-BUILT DRAWING TO OWNER
 - REMOVE AND RELOCATE SIX (6) EXISTING TREES. CONSULT WITH LANDSCAPE ARCHITECT FOR NEW LOCATION
 - CONFIRM LOCATIONS OF ALL EXIST. UTILITIES/SERVICES, PRIOR TO COMMENCING CONSTRUCTION.
 - REFER TO DETAILS AND SECTIONS FOR ALL LANDSCAPE IMPROVEMENTS.
 - ALL DIMENSIONS ARE NOMINAL
 - VERIFY ALL MEASUREMENTS ON SITE
 - NO UNDERGROUND UTILITIES TO PASS DIRECTLY UNDER ROOTBALL OF TREES

NOT FOR CONSTRUCTION

public hapa
215 - 309 W CORDOVA ST VANCOUVER BC V6B 1E5
TEL 604 738 4323 FAX 604 673 4312 WWW.PUBLICDESIGN.CA

Gerald McGavin
Rugby Pavilion
Phase One
6066 Thunderbird Blvd, UBC, Vancouver, BC
PROJECT 1105 STATUS CD
SCALE 1:150 DATE NOV 24, 2011