

WELCOME!

Public Consultation: Beaty Biodiversity Centre Addition (DP05012-5)

Overview

The proposed expansion of the Beaty Biodiversity Centre will be a 4,586 sq. m. 6-storey laboratory and office addition to serve research functions and the Beaty Biodiversity Museum. It will provide room for researchers and storage for museum collections as well as meeting and gathering spaces.

The existing building is located along Main Mall, an important public space on campus. The proposed addition will be situated east of Fairview Grove and set back from Main Mall.

Considerable planning has gone into the design of the landscape to address the loss of trees through enhancement of the grove and connection of the ecology of this site to adjacent natural, cultural and ecological systems.

ABOUT THIS PUBLIC CONSULTATION

This Public Consultation is an opportunity to provide feedback on the Development Permit Application for the Beaty Centre Addition. Details about the proposed building and landscape plan along with additional information about an emerging approach to landscape design that supports ecology, integrated systems, inclusion, and a strengthened Musqueam presence in the landscape are available using the QR code.

Please provide your comments or concerns using the online feedback form until July 6, 2022. Project information and the feedback can be found via the QR code:

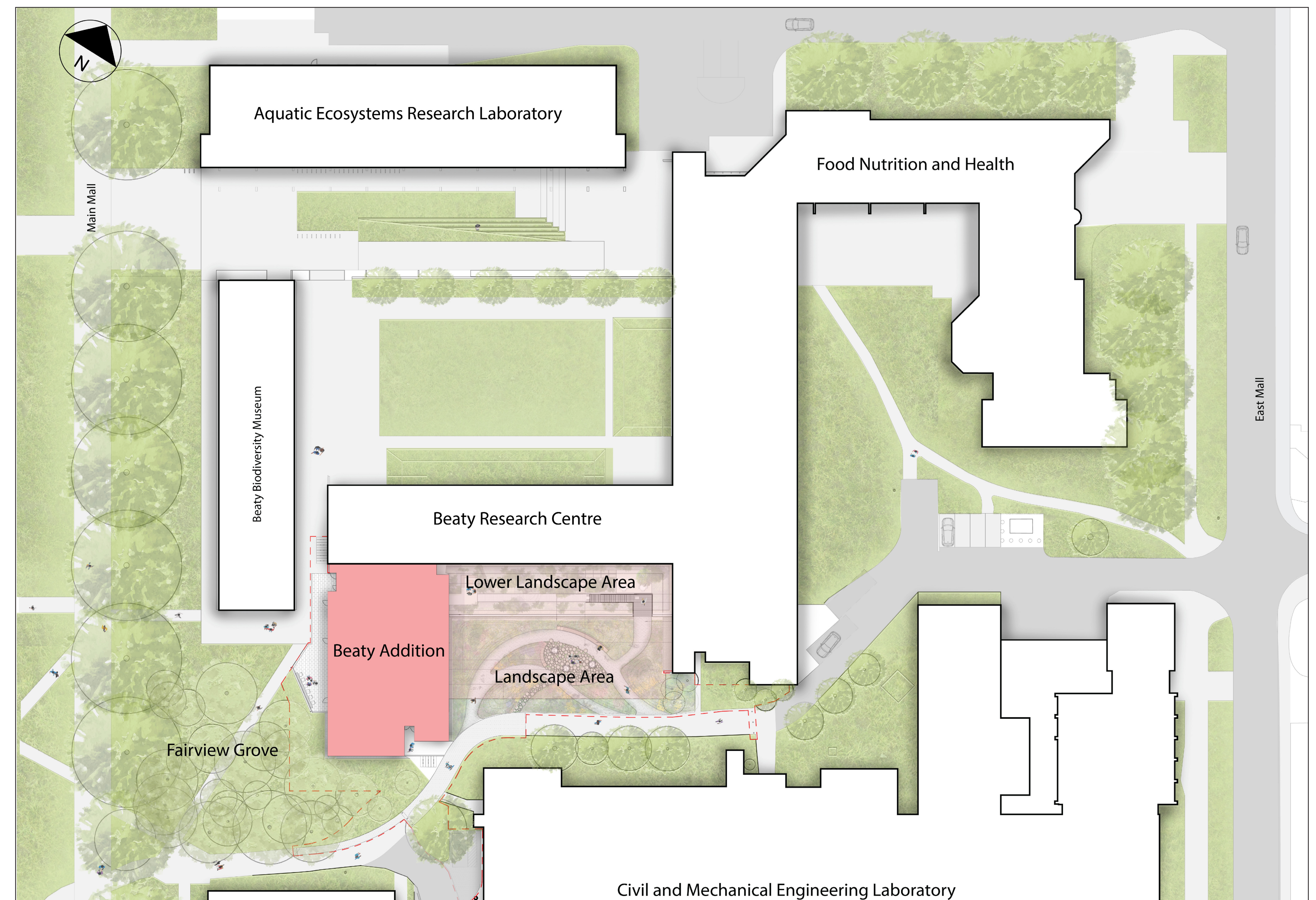

Site plan showing the new addition (in red) ▲

PLANNING CONTEXT

The planning and design for the Beaty Addition has been shaped by the academic needs of the users and an emerging landscape approach called the Connected Landscapes project that supports ecology, integrated systems, inclusion, and a strengthened Musqueam presence in the landscape beyond individual project sites.

UBC's forests, gardens and green spaces are a distinguishing feature of the campus highly valued by the community. As the campus continues to change and grow, and we begin to plan for the future through Campus Vision 2050, the community and Musqueam have expressed a desire to see campus green spaces and biodiversity preserved and enhanced. This is of particular relevance to the Beaty Biodiversity Centre Addition as the project will result in changes to the surrounding green space including the removal of trees.

With the interests of the community and Musqueam in mind, UBC undertook a landscape planning initiative to go beyond a typical site-specific biomass replacement approach for this project, using the opportunity to develop a holistic strategy, called the Connected Landscapes project, that supports enhancement of the natural, ecological and cultural systems connected to this area.

Connected Landscapes

The Connected Landscapes project establishes design direction for landscapes in specific areas of campus – the Central Connector and the North Connector. This work is distinct from, but related to, Campus Vision 2050 as it will inform, through project implementation and testing, the larger campus landscape character.

The intention is to realize broader, long-term ecological gains for the campus by applying landscape design strategies to campus corridors that can be delivered through individual projects, such as the Beaty Biodiversity Centre Addition. By applying ecological, social and Musqueam presence strategies to key opportunities within an area, the biodiversity and ecological health of the area will improve beyond what would otherwise be possible.

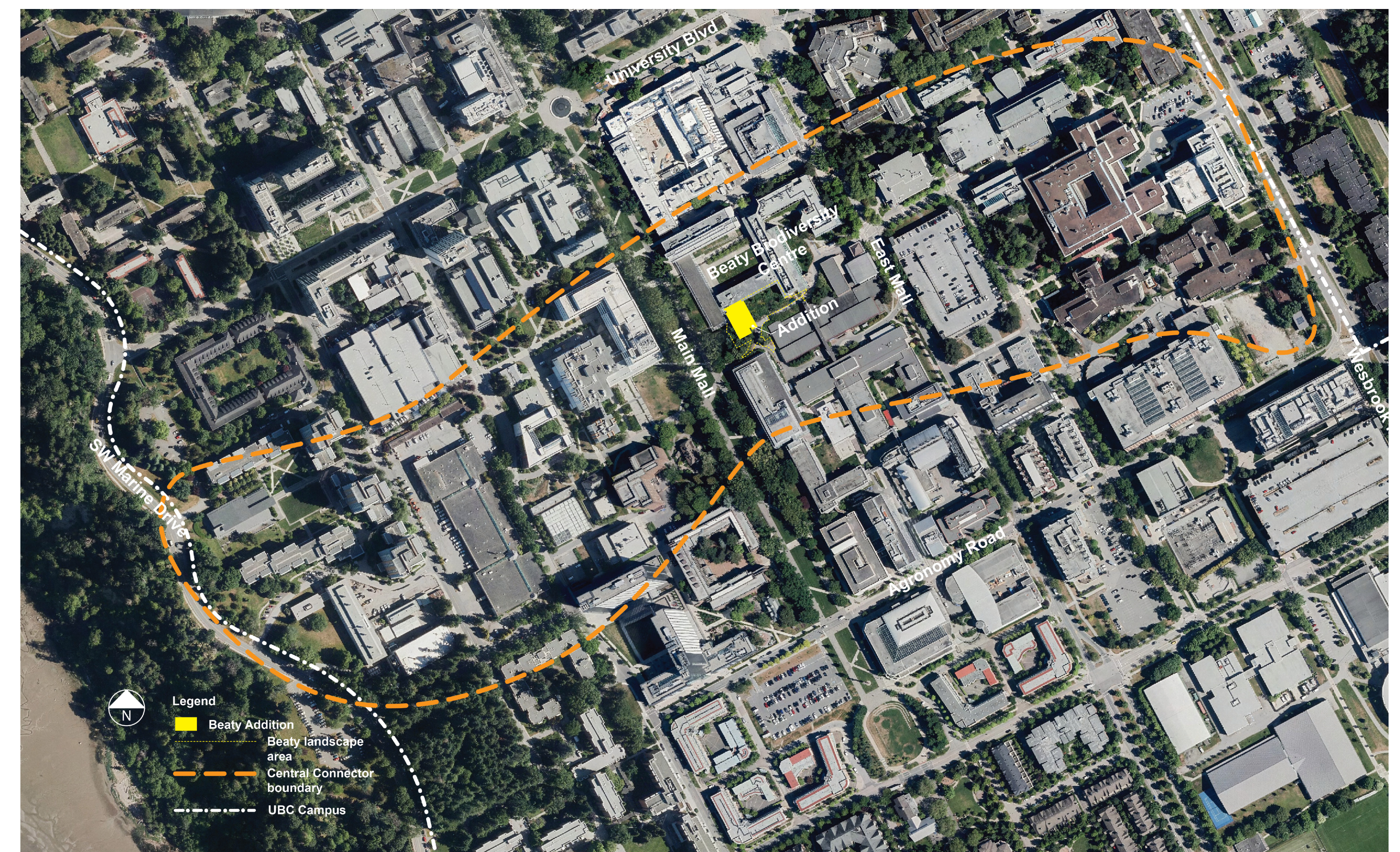

Central Connector area ▲

CAMPUS VISION 2050

Campus Vision 2050 is a comprehensive land use planning and engagement process that will shape how the Vancouver campus changes and grows over the next 30 years. It will result in a long-term plan for the campus that supports the needs of the university and balances the multiple interests of Musqueam and the UBC community. Learn more via the QR code:



PLANNING PROCESS

The Beaty Addition presents an opportunity to apply and test the Connected Landscapes project, integrating Indigenous knowledge and the university community's expertise to increase the ecological health of the site and adjacent area, support ecosystem services, and increase the societal wellbeing of the campus community.

Who's Involved

The Beaty Addition and the Connected Landscape project have been shaped with input from campus biodiversity experts, Musqueam and what we've heard from the broader UBC community interests through Campus Vision 2050, and other planning projects. This includes:

- Musqueam knowledge keepers and staff
- Researchers and faculty from Beaty Biodiversity Centre
- Faculty and staff on the Campus Biodiversity Initiative: Research and Demonstration Steering Committee

This Public Consultation is an opportunity for campus community members to provide input on the Beaty Addition development application, both the proposed building and landscape.

Next Steps

The Beaty Addition will be presented to the Board of Governors for consideration in September 2022. Subject to approval, construction will begin April 2023. While the application is being considered, Campus and Community will be conducting an assessment of biomass changes due to the building addition and the new landscape. The Central Connector project will continue to be implemented over time, as opportunities arise.



Please have a look at the other display boards, prepared by the project applicant, that provide more information on the proposed building and landscape, along with the Connected Landscapes project.

