

UBC ORCHARD CHILDCARE

LANDSCAPE DRAWING LIST

SHEET	DESCRIPTION
L0.00	COVER SHEET
L1.00	TREE MANAGEMENT PLAN
L2.00	MATERIALS PLAN
L3.00	GRADING PLAN
L6.00	PLANTING SCHEDULE
L6.01	PLANTING PLAN
L8.00	SECTIONS
L9.00	SOFTSCAPE DETAILS
L9.10	HARDSCAPE DETAILS
L9.20	FURNISHINGS DETAILS

GENERAL NOTES

- A SURVEY HAS BEEN PROVIDED BY THE CLIENT FOR THIS PROJECT. IT HAS BEEN REFORMATTED FOR USE IN AND FOR PREPARING THESE DOCUMENTS. CONTRACTOR SHALL OBTAIN AN OFFICIALLY SIGNED COPY FROM THE CLIENT AND BECOME FAMILIAR WITH IT, THE EXISTING CONDITIONS AND SITE CONTEXT PRIOR TO CONSTRUCTION. ALL DISCREPANCIES SHOULD BE BROUGHT TO THE ATTENTION OF THE LANDSCAPE ARCHITECT FOR RESOLUTION IMMEDIATELY. THE LANDSCAPE ARCHITECT IS NOT RESPONSIBLE FOR ERRORS OR OMISSIONS ASSOCIATED WITH PREPARATION OR DOCUMENTATION OF SURVEY.
- THE CONTRACTOR SHALL VISIT THE SITE AND BECOME FAMILIAR WITH EXISTING SITE CONDITIONS PRIOR TO BIDDING AND CONSTRUCTION.
- THE CONTRACTOR IS RESPONSIBLE FOR OBTAINING ALL NECESSARY PERMITS AND FOR ADHERENCE TO ORDINANCES, REGULATIONS, LAWS AND CODES HAVING JURISDICTION OVER THE PROPERTY PRIOR TO COMMENCING WORK.
- CONTRACTOR IS RESPONSIBLE FOR DETERMINING MEANS AND METHODS FOR CONSTRUCTION. THESE DRAWINGS MAY INDICATE A LIMIT OF PROPOSED IMPROVEMENTS, LIMITS OF SITE DEMOLITION, ETC. FOR DELINEATION OF EXPECTED EXTENTS OF DISTURBANCE. HOWEVER, FINAL IMPACT SHALL BE DETERMINED IN THE FIELD. SHOULD LIMITS OF DISTURBANCE EXCEED BOUNDARIES DEFINED IN DRAWINGS, CONTRACTOR SHALL CONTACT LANDSCAPE ARCHITECT FOR RESOLUTION.
- CONTRACTOR IS RESPONSIBLE FOR REPAIRING ALL WORK DISTURBED BY CONSTRUCTION OUTSIDE OF LIMIT LINES DEFINED ON DRAWINGS OR THROUGH HIS/HER MEANS AND METHODS TO A CONDITION BETTER THAN OR EQUAL TO THE EXISTING CONDITIONS PRIOR TO COMMENCEMENT OF CONSTRUCTION AT NO ADDITIONAL COST TO THE OWNER.
- THE DRAWINGS AND SPECIFICATIONS ARE COMPLEMENTARY TO ONE ANOTHER AND IMPLIED TO CORRESPOND WITH ONE ANOTHER. ANY DISCREPANCIES SHOULD BE BROUGHT TO THE ATTENTION OF THE LANDSCAPE ARCHITECT FOR RESOLUTION IMMEDIATELY.
- LANDSCAPE DRAWINGS ARE TO BE READ IN CONJUNCTION WITH ARCHITECTURAL AND ENGINEERING DRAWINGS. REPORT ANY DISCREPANCIES TO THE CONSULTANT FOR REVIEW AND RESPONSE.
- EXISTING UTILITIES SHOWN ARE APPROXIMATE AND SHALL BE VERIFIED IN THE FIELD PRIOR TO BEGINNING WORK. THE CONTRACTOR SHALL EXERCISE CAUTION WHEN WORKING AROUND EXISTING UTILITIES TO REMAIN.
- ROADWAYS AND BUILDINGS MUST BE CAPABLE OF SUPPORTING FIRE AND EMERGENCY APPARATUS DURING CONSTRUCTION.
- SEE CIVIL FOR SEDIMENTATION AND EROSION CONTROL MEASURES.
- SEE CIVIL FOR UTILITY AND UNDERGROUND STORM DRAINAGE INFORMATION.
- ALL MATERIALS, CONSTRUCTION, AND WORKMANSHIP SHALL MEET THE UNIVERSITY OF BRITISH COLUMBIA SPECIFICATIONS AND DESIGN STANDARDS.
- THE CONTRACTOR IS RESPONSIBLE FOR INSTALLING SLEEVING FOR ELECTRIC, DRAINAGE, IRRIGATION, AND UTILITIES PRIOR TO THE INSTALLATION OF COMPACTED SUB-GRADE, SUB-BASE AND PAVEMENT AS NECESSARY. SLEEVES TO BE INSTALLED AT A MINIMUM DEPTH BELOW GRADE AS PER UNIVERSITY STANDARDS.

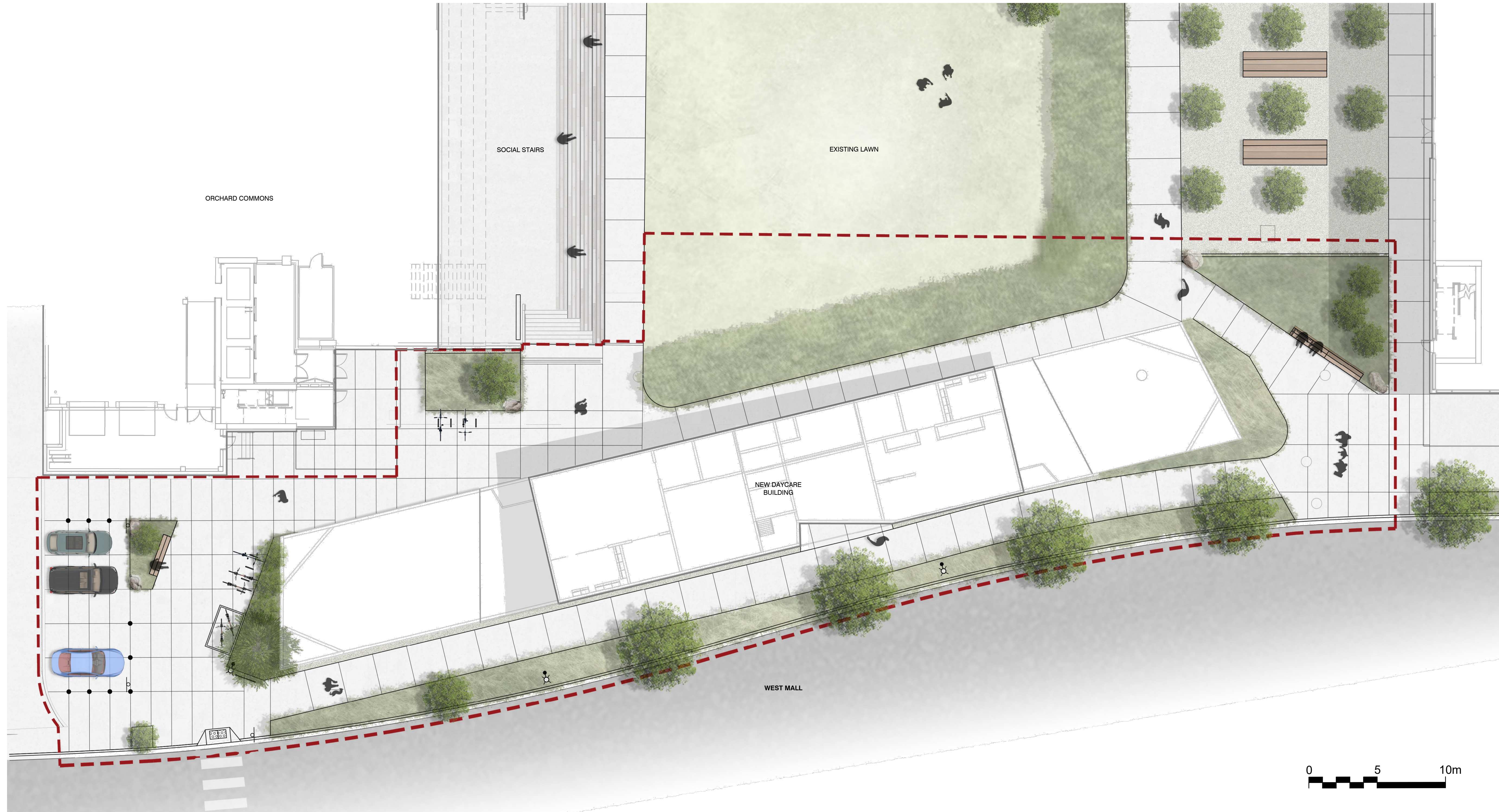
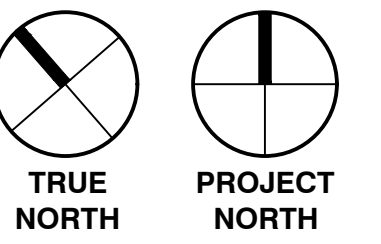

UBC ORCHARD CHILD CARE
6363 AGRONOMY ROAD
VANCOUVER, BC, V6J 0E5

PROJECT NO. 23-003

1 ISSUED FOR DP 2024.03.07

COVER SHEET

L0.00

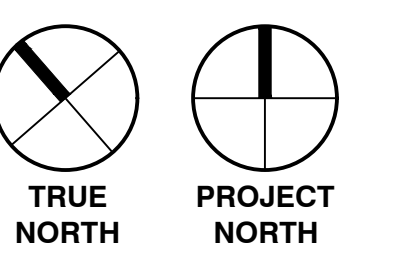

PLANT PROTECTION AND REMOVALS

1. LOCATION OF TREE PROTECTION FENCING AND LIMIT OF ACCESS FENCING TO BE VERIFIED WITH CONSULTANT AND PROJECT ARBORIST PRIOR TO INSTALLATION.
2. NO STORAGE OF BUILDING / CONSTRUCTION MATERIALS WITHIN PROTECTED AREAS OR AGAINST PROTECTION BARRIER.
3. ANY PRUNING OF BRANCHES OR ROOTS MUST BE DONE BY THE PROJECT ARBORIST.
4. HAND EXCAVATE ONLY WITHIN DRIPLINE OF TREES TO BE RETAINED. SEVER ROOTS CLEANLY. CONTACT PROJECT ARBORIST FOR APPROVAL PRIOR TO SEVERING ROOTS IN EXCESS OF 50mm DIA.
5. TREE PROTECTION FENCE IS NOT TO BE LIFTED OR REMOVED AT ANY TIME FOR VEHICULAR ACCESS. VEHICLES AND HEAVY EQUIPMENT CAN CAUSE SOIL COMPACTION IN THE ROOT ZONE DEPLETING THE AIR SPACE THAT IS ESSENTIAL TO THE TREE'S HEALTH.
6. BASED ON CONTRACTOR'S STAGING AND ACCESS REQUIREMENTS, ADDITIONAL TREE PROTECTION FENCING MAY BE REQUIRED.
7. THE TREE PROTECTION ZONE SHOWN IS A GRAPHICAL REPRESENTATION OF THE CRITICAL ROOT ZONE. REFER TO THE ARBORIST REPORT FOR TREE PROTECTION REQUIREMENTS.
8. ALL EXCAVATION WORK WITHIN TWO METERS OF A TREE PROTECTION ZONE SHOULD BE CONDUCTED UNDER ARBORIST SUPERVISION.
9. TREES IDENTIFIED FOR RELOCATION REQUIRE ASSESSMENT AND COORDINATION WITH THE PROJECT ARBORIST AND CAMPUS LANDSCAPE ARCHITECT. RELOCATION TO BE DETERMINED BY CAMPUS LANDSCAPE ARCHITECT.
10. TREES INDICATED FOR REMOVAL SHALL ALSO INCLUDE COMPLETE REMOVAL OF STUMPS AND ROOTS AND FILLING IN DEPRESSION WITH SUITABLE SOIL FILL.

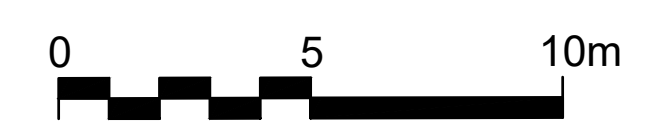
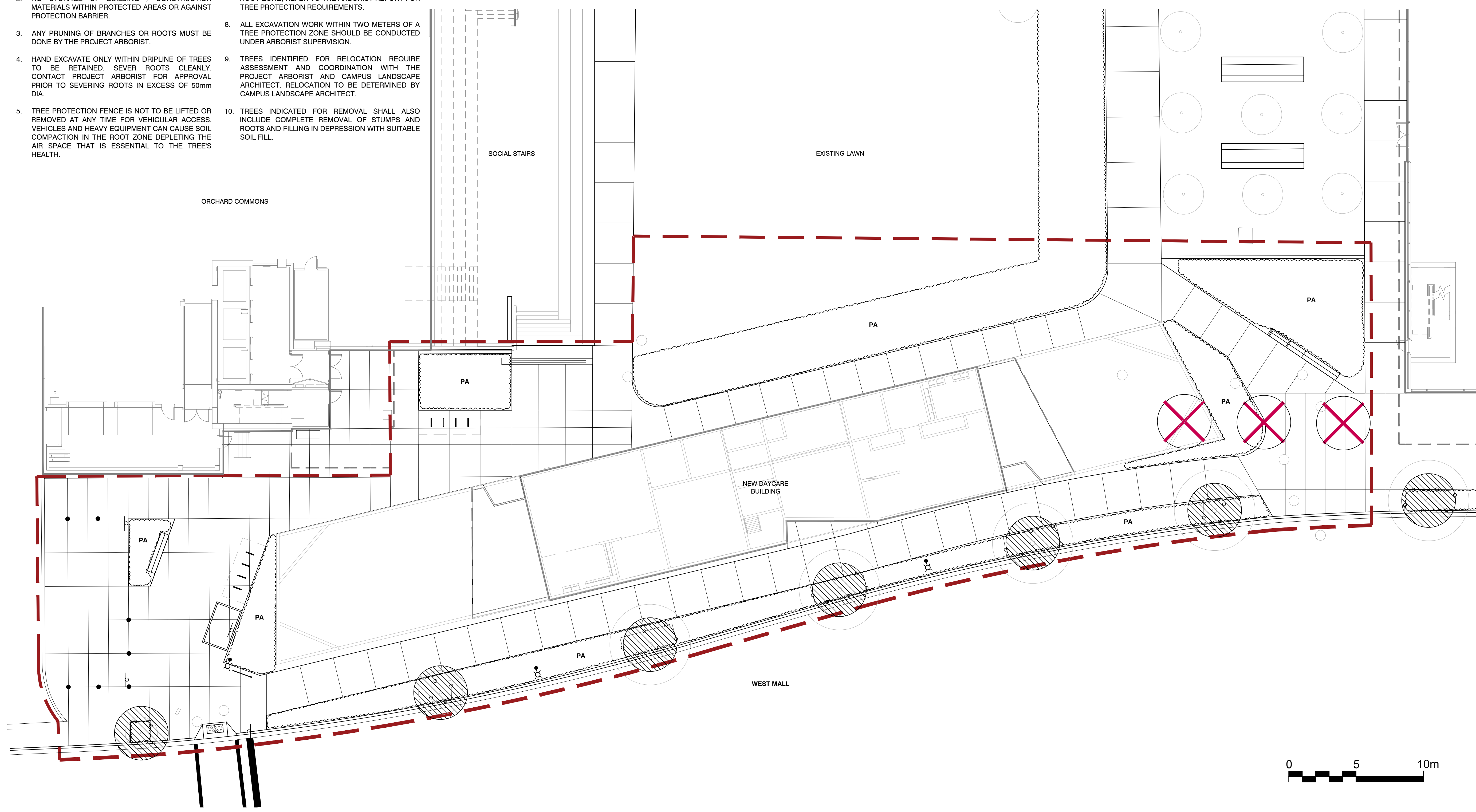

1 TREE MANAGEMENT PLAN
1:150

GENERAL LEGEND

- LIMIT OF WORK
- BUILDING OVERHANG
- EXISTING PROPOSED DECIDUOUS TREES
- EXISTING PROPOSED CONIFEROUS TREES
- PLANTING AREA

TREE PROTECTION LEGEND

- EXISTING TREE TO BE RETAINED
EXTENT OF TREE PROTECTION ZONE
- EXISTING TREE TO BE REMOVED
- TREE PROTECTION FENCING

UBC ORCHARD CHILD CARE
6363 AGRONOMY ROAD
VANCOUVER, BC, V6J 0E5

PROJECT NO. 23-003

1 ISSUED FOR DP 2024.03.07

TREE MANAGEMENT PLAN

L1.00

2024-03-07 11:31:09 AM 11.00 tree management plan.dwg

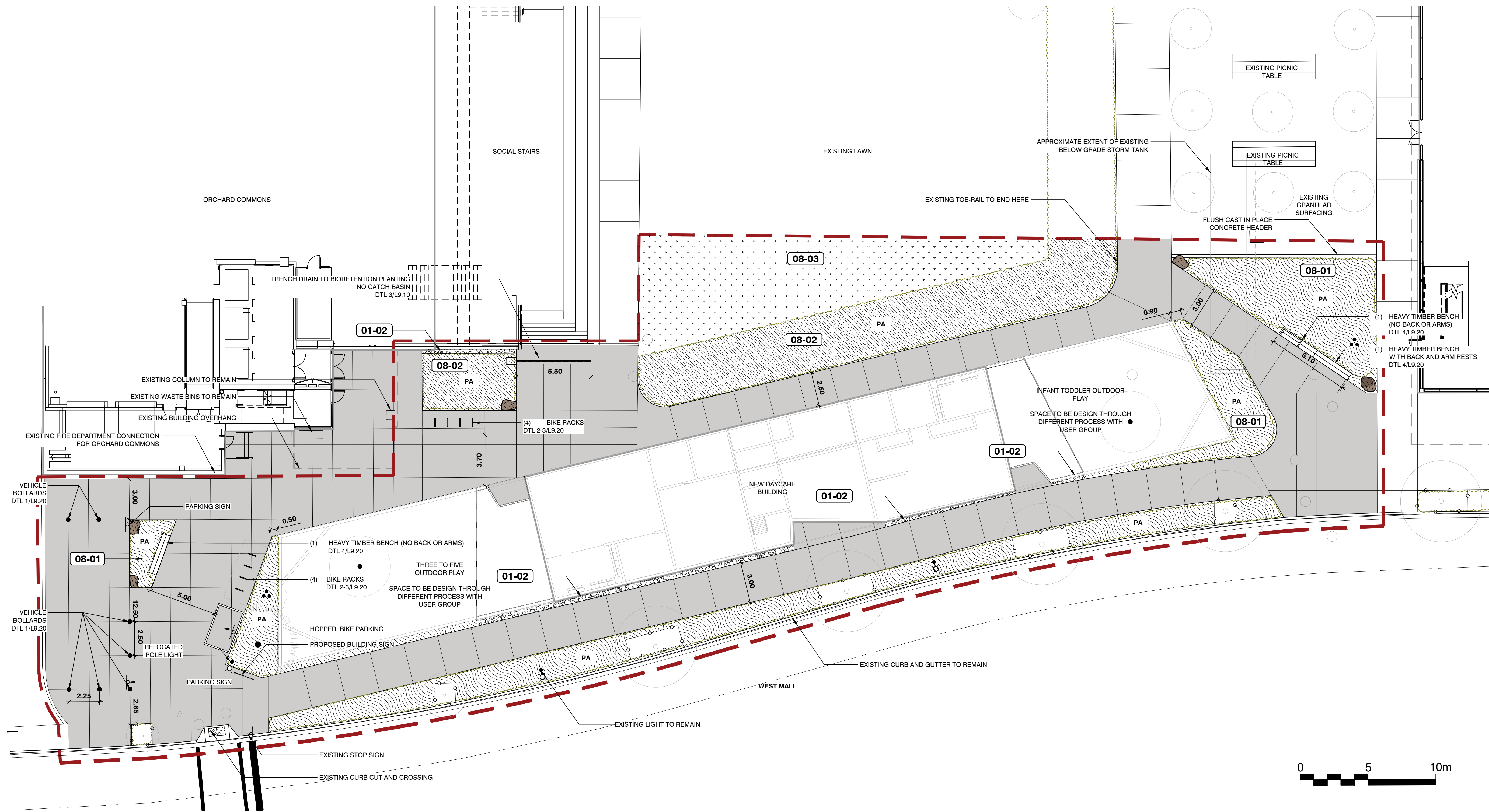
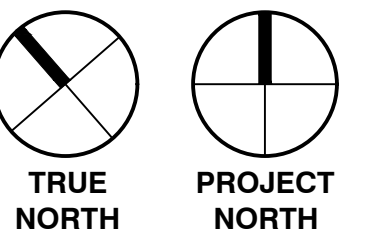

1 MATERIALS PLAN

1:150

GENERAL LEGEND

- LIMIT OF WORK
- BUILDING OVERHANG
- EXISTING PROPOSED DECIDUOUS TREES
- CONIFEROUS TREES
- PLANTING AREA

MATERIALS LEGEND

CODE	01 PAVING DESCRIPTION	DETAIL
01-01	PAVING TYPE 1 - CAST IN PLACE CONCRETE	1/L9.20
01-02	MAINTENANCE STRIP	5/L9.20
CODE	08 SOILS DESCRIPTION	DETAIL
08-01	SOIL TYPE 1 - PLANTING BEDS	1/L9.00
08-02	SOIL TYPE 2 - BIORETENTION GROWING MEDIUM	1/L9.00
08-03	SOIL TYPE 3 - LAWN	1/L9.00

LANDSCAPE BOULDERS 4/L9.10

UBC ORCHARD CHILD CARE
6363 AGRONOMY ROAD
VANCOUVER, BC, V6J 0E5

PROJECT NO. 23-003

1 ISSUED FOR DP 2024.03.07

MATERIALS PLAN

L2.00

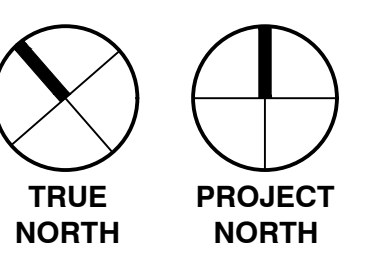

GRADING PLAN

L4.00

GRADING NOTES

1. REFER TO SURVEY PLAN FOR EXISTING ELEVATIONS.
2. ALL SPOT ELEVATIONS IN METRIC METER MEASUREMENT UNITS UNLESS OTHERWISE INDICATED.
3. REFER TO CIVIL DRAWINGS FOR ALL SUBSURFACE DRAINAGE
4. ENSURE POSITIVE DRAINAGE AWAY FROM BUILDINGS AND TO STORM DRAINS.
5. UTILITY LIDS/COVERS TO BE PROTECTED DURING DEMOLITION, ADJUSTED TO FINAL GRADE AND BE ADJUSTED FOR FUTURE MAINTENANCE ACCESS. REFER TO CIVIL.

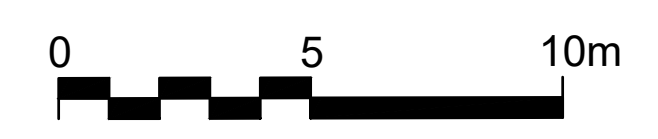
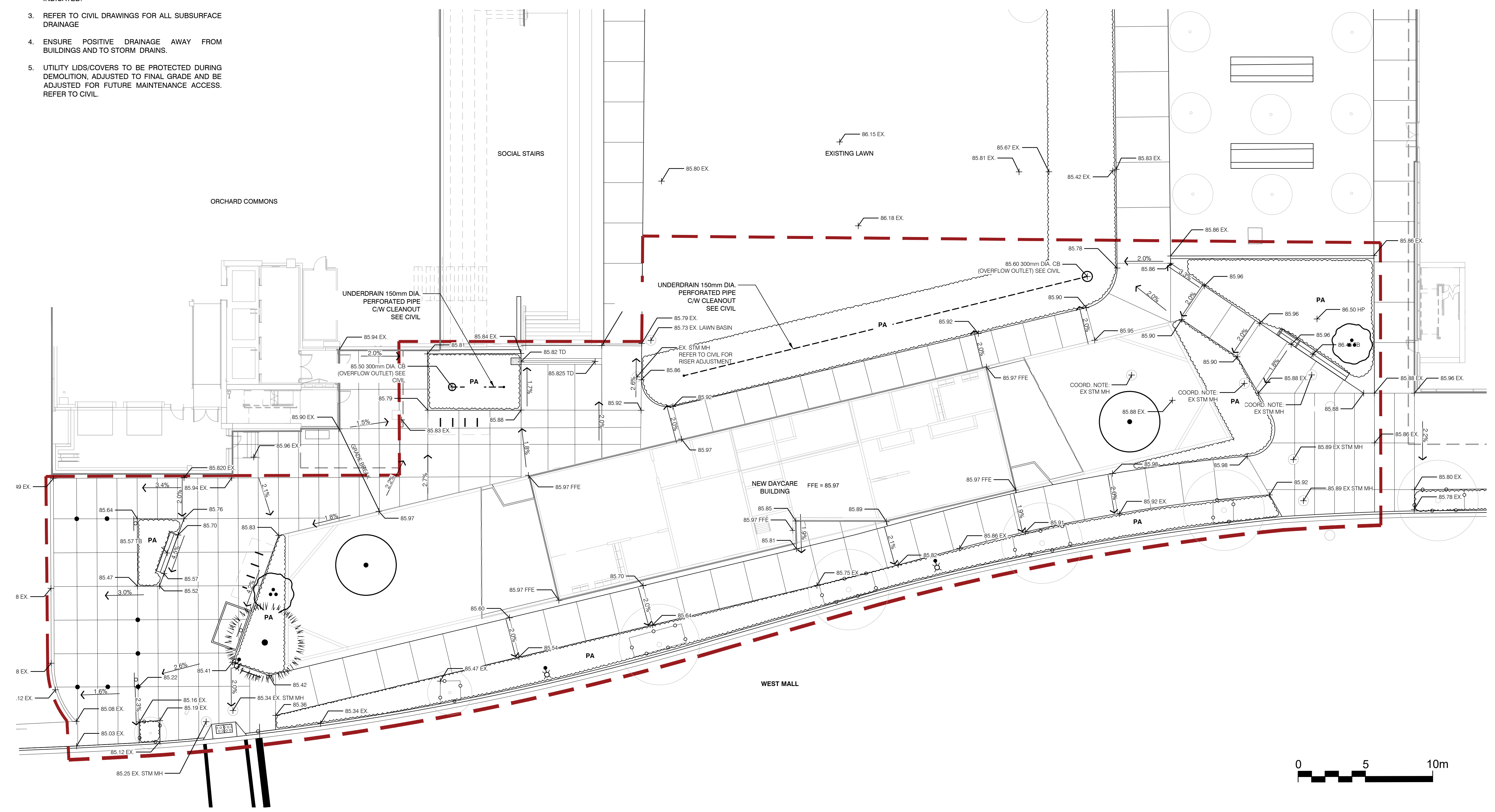

1 GRADING PLAN
1:150

GENERAL LEGEND

- LIMIT OF WORK
- BUILDING OVERHANG
- EXISTING DECIDUOUS TREES
- EXISTING CONIFEROUS TREES
- PLANTING AREA

GRADING LEGEND

- AD AREA DRAIN
- BS BOTTOM OF STAIRS
- BW BOTTOM OF WALL
- CB CATCH BASIN
- CO CLEAN OUT
- DI DRAIN INLET
- FFE FINISHED FLOOR ELEVATION
- GB GRADE BREAK
- HP HIGH POINT
- INV INVERT ELEVATION
- LB LAWN BASIN
- LP LOW POINT
- MH MANHOLE
- TB TOP OF BENCH
- TC TOP OF CURB
- TF TOP OF FOOTING
- TP TOP OF PAVING
- TS TOP OF STEPS
- TW TOP OF WALL

2024-03-07 11:31:53 AM 14.00 grading plan.dwg

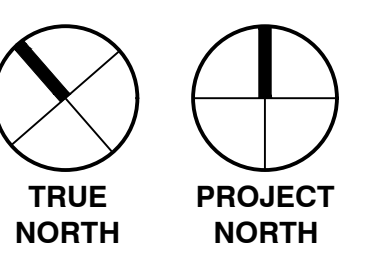

PLANTING SCHEDULE

L6.00

PLANT SCHEDULE

SYMBOL	CODE	BOTANICAL / COMMON NAME	SIZE	CONTAINER	QTY
TREES					
	AC	ACER CIRCINATUM / VINE MAPLE	175CM HT.	LARGE POT	2
	PE	PINUS NIGRA SELECT GREEN / AUSTRIAN PINE	225CM HT.	B&B	1
	TC	TILIA CORDATA 'CORZAM' / CORINTHIAN® LITTLELEAF LINDEN	70MM CAL.	B&B	2

SYMBOL	CODE	BOTANICAL / COMMON NAME	SIZE	CONTAINER	QTY
SHRUBS					
	Af	AMELANCHIER X GRANDIFLORA 'AUTUMN BRILLIANCE' / AUTUMN BRILLIANCE SERVICEBERRY	2.0M HT.	B&B	2
	Cf	CORNUS SERICEA 'FLAVIRAMEA' / YELLOW TWIG DOGWOOD	#2	POT	3
	Ck	CORNUS SERICEA 'KELSEYI' / KELSEY'S DWARF RED TWIG DOGWOOD	#2	POT	67
	Oc	OEMLERIA CERASIFORMIS / OSOBERRY	#10	POT	1
	Sa	SYMPHORICARPOS ALBUS / COMMON WHITE SNOWBERRY	#2	POT	1
	Vo	VACCINIUM OVATUM / EVERGREEN HUCKLEBERRY	#2	POT	4
	Vp	VACCINIUM PARVIFOLIUM / RED HUCKLEBERRY	#2	POT	10
	Vn	VACCINIUM X 'NORTHSKY' / NORTHSKY BLUEBERRY	#1	POT	23

SYMBOL	CODE	BOTANICAL / COMMON NAME	SIZE	CONTAINER	QTY
FERNS					
	bs	BLECHNUM SPICANT / DEER FERN	#1	POT	18
	pm	POLYSTICHUM MUNITUM / WESTERN SWORD FERN	#1	POT	75

SYMBOL	CODE	BOTANICAL / COMMON NAME	SIZE	CONTAINER	QTY
GRASSES					
	ca	CALAMAGROSTIS X ACUTIFLORA / FEATHER REED GRASS	#1	POT	18
	pa	PENNISETUM ALOPECUROIDES 'MOUDRY' / MOUDRY FOUNTAIN GRASS	#1	POT	43

SYMBOL	CODE	BOTANICAL / COMMON NAME	SIZE	CONTAINER	SPACING	QTY
SHRUB AREAS						
	Ge2	GAULTHERIA SHALLON / SALAL	#2	POT	450 mm	233
	Lp	LONICERA PILEATA / PRIVET HONEYSUCKLE	#1	POT	1,000 mm	148
GROUND COVERS						
	ep	ECHINACEA PURPUREA / CONEFLOWER	#1	POT	300 mm	46
	fw	FRAGARIA VESCA / WOODLAND STRAWBERRY	#1	POT	300 mm	123

WET PLANTING		141 m ²
	CAREX OBNUPTA / SLOUGH SEDGE	180 #1, POT 25% @ 0.45m oc
	JUNCUS EFFUSUS / SOFT RUSH	137 #1, POT 15% @ 0.4m oc
	JUNCUS ENSIFOLIUS / SWORDLEAF RUSH	406 #1, POT 25% @ 0.3m oc
	IRIS DOUGLASIANA / DOUGLAS IRIS	253 #1, POT 35% @ 0.45m oc

PLANTING NOTES

1. THE CONTRACTOR SHALL CONFIRM PLANT QUANTITIES ON THE DRAWINGS CORRESPOND TO THOSE INDICATED ON THE PLANT LIST. ANY DISCREPANCIES ARE TO BE VERIFIED BY THE CONSULTANT FOR REVIEW AND RESPONSE.
2. ALL NEW TREES TO BE PLANTED A MINIMUM OF 1.0m AWAY FROM UTILITIES (FROM EDGE OF ROOTBALL).
3. CONTRACTOR IS RESPONSIBLE TO 'RESTORE' ALL AREAS OF THE SITE, OR ADJACENT AREAS, WHERE DISTURBED TO A CONDITION THAT MEETS OR EXCEEDS THE CONDITIONS PRIOR TO THE DISTURBANCE.
4. ALL PLANT MATERIAL SHALL CONFORM TO THE STANDARD SPECIFIED IN THE CURRENT EDITION OF THE CANADIAN NURSERY STOCK STANDARD (CNSS) AND PER PROJECT SPECIFICATIONS.
5. PLANT MATERIAL SIZES SPECIFIED ARE THE MINIMUM ACCEPTABLE SIZES TO BE SUPPLIED TO THIS PROJECT.
6. ALL PLANT MATERIAL SHALL BE WELL-ESTABLISHED AND UNIFORM IN SHAPE AND SIZE.
7. ALL PLANT MATERIAL SHALL BE NURSERY GROWN UNLESS OTHERWISE NOTED. ONLY CERTIFIED S.O.D. NURSERY STOCK WILL BE ACCEPTED.
8. THE CONTRACTOR SHALL PROVIDE A GROWING MEDIUM ANALYSIS FOR REVIEW BY THE CONSULTANT - AS PER SPECIFICATIONS - PRIOR TO THE START OF CONSTRUCTION. GROWING MEDIUM SUPPLIED TO THE SITE OR INSTALLED ON SITE PRIOR TO CONSULTANT APPROVAL SHALL BE REJECTED AT NO COST TO THE OWNER.
9. PLANT LIST TO BE READ IN CONJUNCTION WITH SPECIFICATIONS FOR COMPLIANCE.
10. PRIOR TO THE START OF CONSTRUCTION, THE CONTRACTOR SHALL CONFIRM THE AVAILABILITY OF THE PLANT MATERIAL SPECIFIED AS PER SPECIFICATIONS, ALLOWING FOR ANY AND ALL REQUIRED APPROVALS. PLANT SUBSTITUTIONS NOT CONFIRMED AND APPROVED BY THE CONSULTANT WILL BE REJECTED.
11. PRIOR TO INSTALLATION OF PLANT MATERIAL: PLANTS MUST BE PLACED AND LANDSCAPE ARCHITECT CALLED TO SITE TO REVIEW AND APPROVE LAYOUT, CONSULTANT MAY PROVIDE DIRECTIONS FOR LAYOUT MODIFICATIONS UPON REVIEW.
12. ALL PLANTING AREAS SHALL BE WATERED WITH AN IN-GROUND AUTOMATIC IRRIGATION SYSTEM.
13. PROVIDE ADEQUATE SUB-SURFACE DRAINAGE IN ALL PLANTED AREAS.

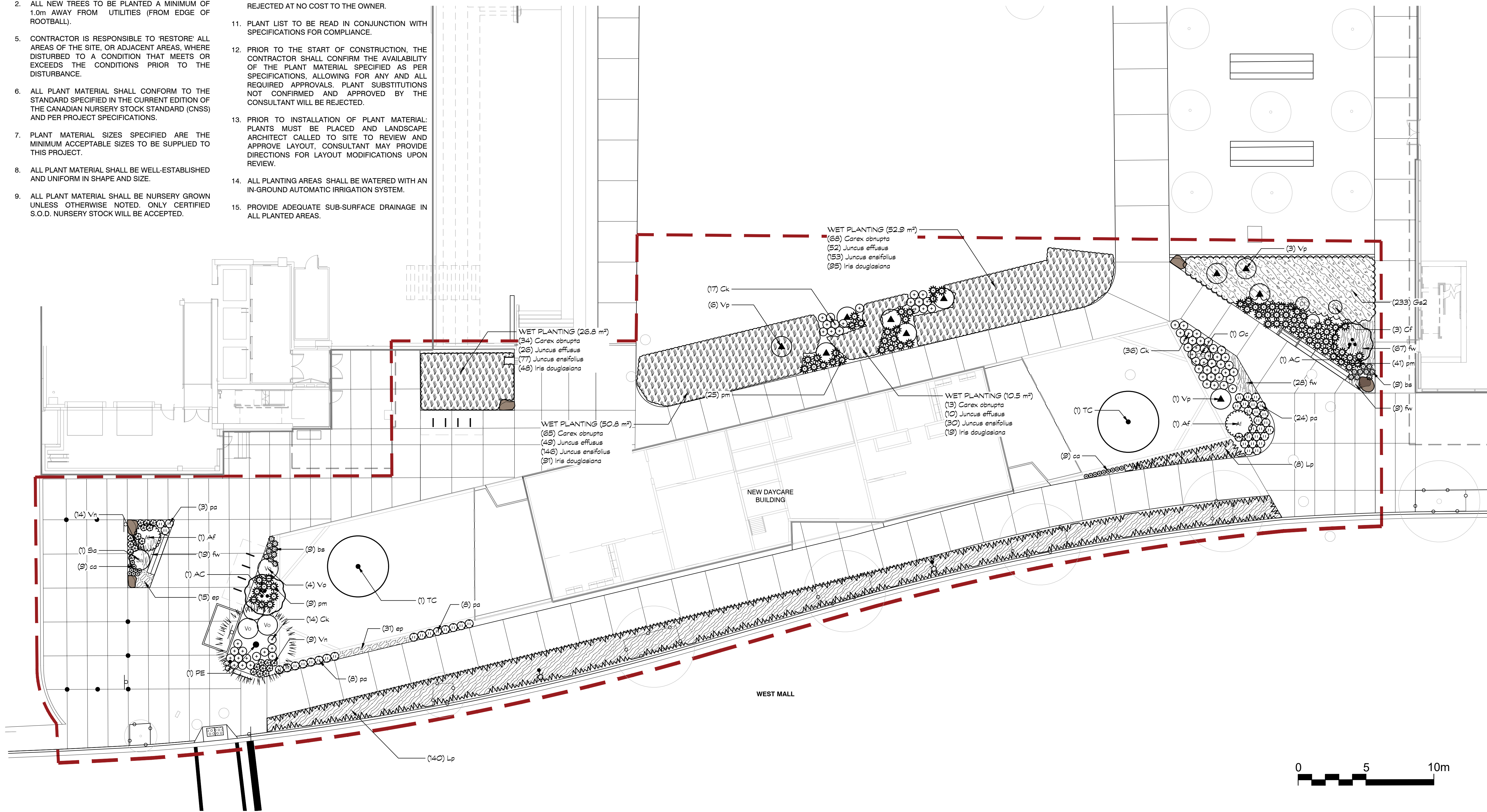
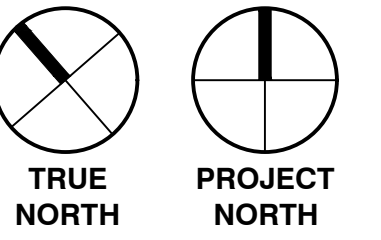

1 PLANTING PLAN

1:150

GENERAL LEGEND

- LIMIT OF WORK
- BUILDING OVERHANG

EXISTING PROPOSED

- DECIDUOUS TREES
- CONIFEROUS TREES
- PA PLANTING AREA

TREE PROTECTION LEGEND

- EXISTING TREE TO BE RETAINED
- EXTENT OF TREE PROTECTION ZONE
- ⊗ EXISTING TREE TO BE REMOVED
- TREE PROTECTION FENCING

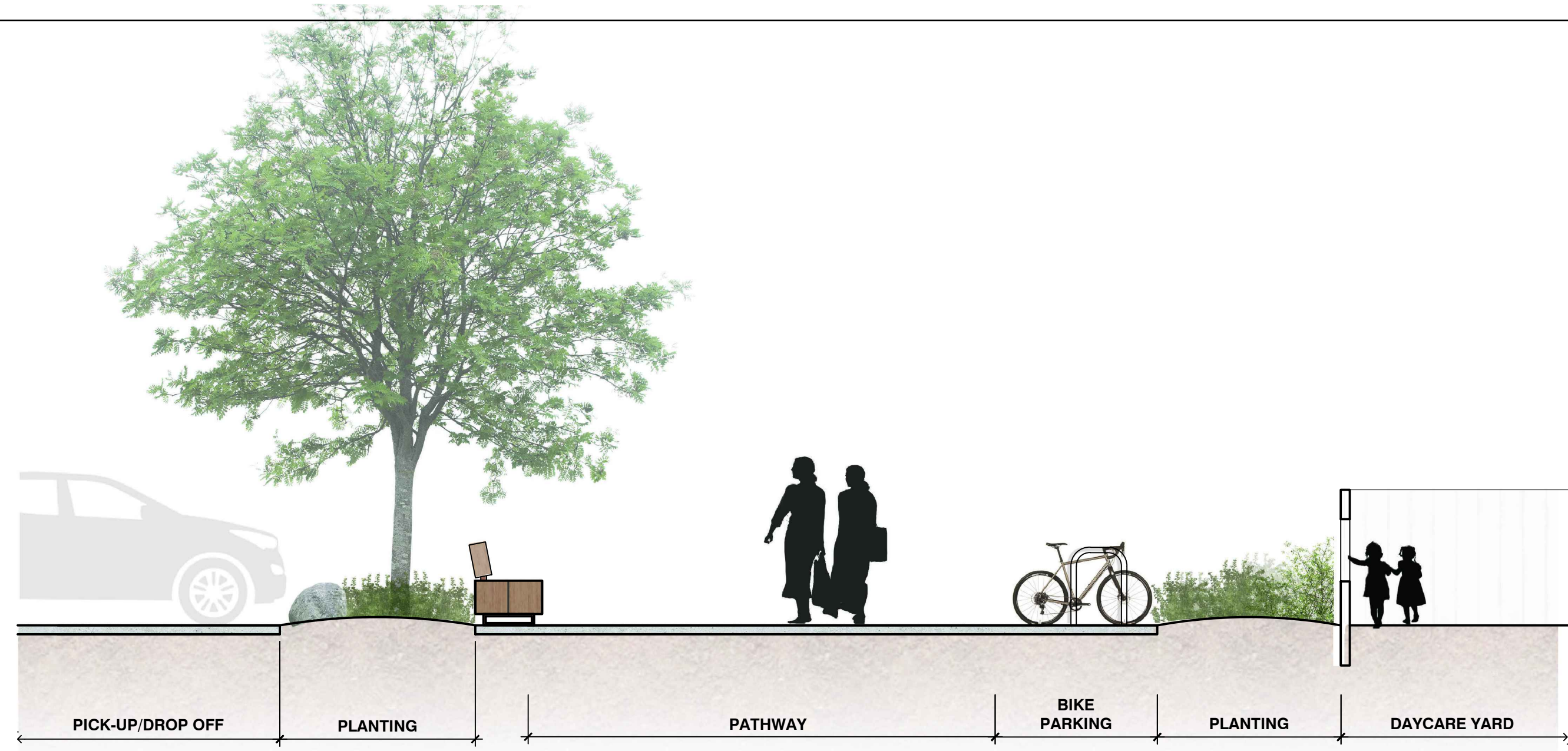

1 SECTION AA (NORTH)
1:50

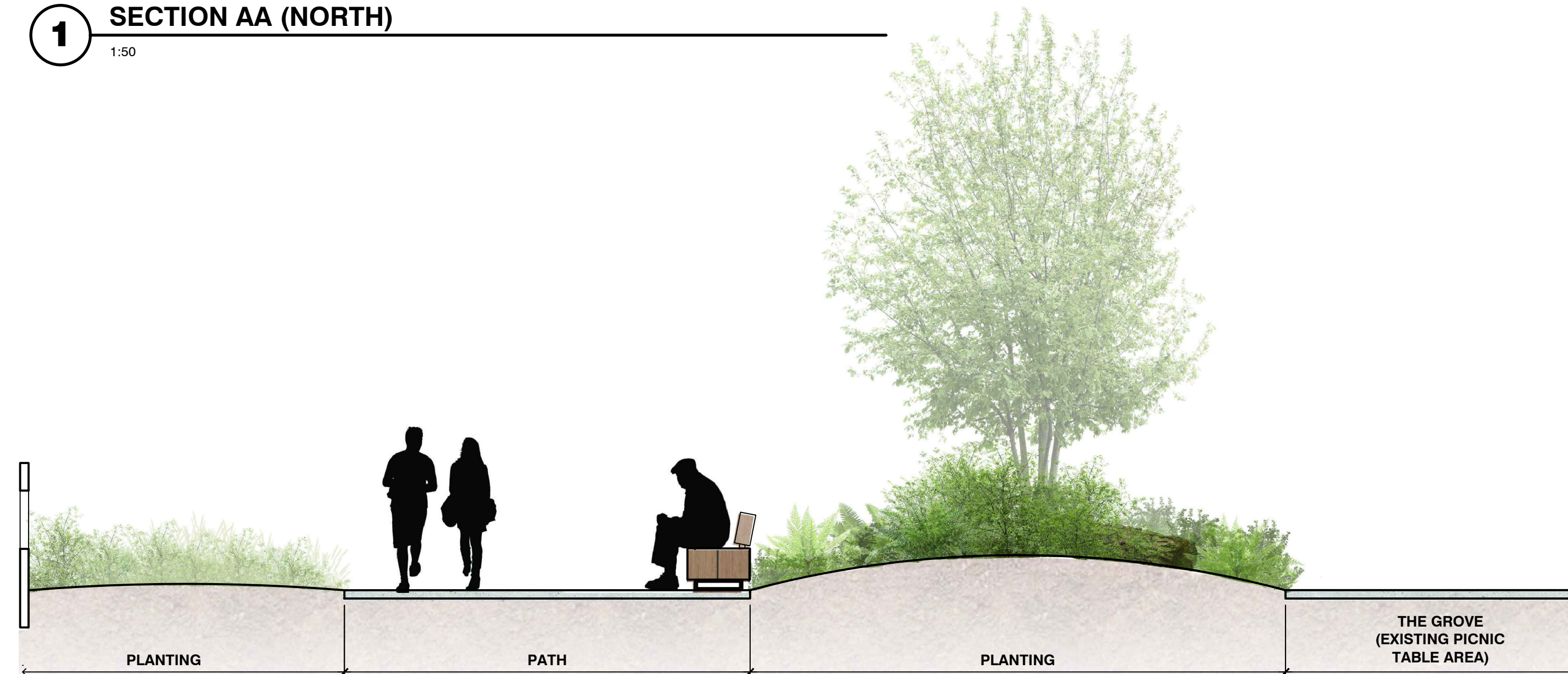

2 SECTION BB (SOUTH)
1:50



3 SECTION CC (SOUTH ELEVATION)
1:50

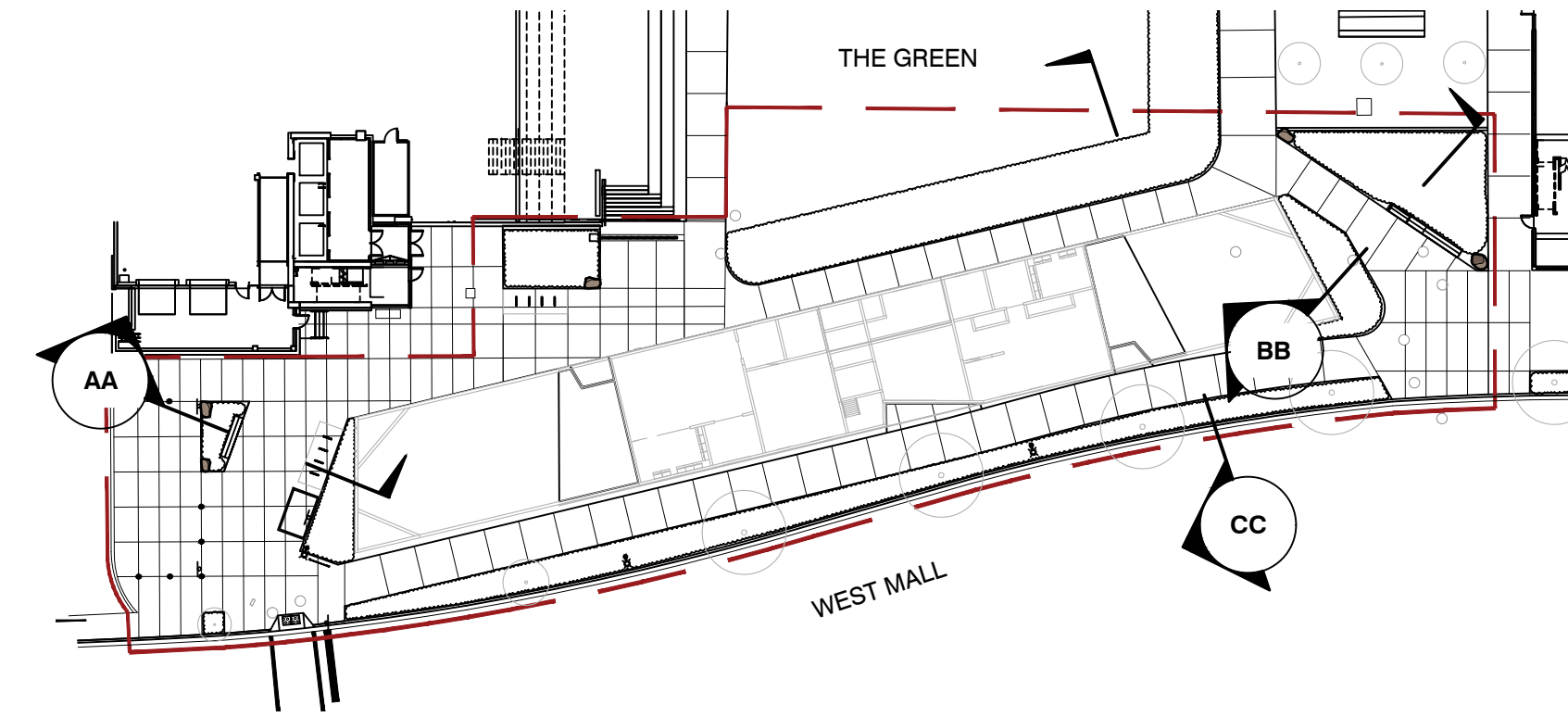

4 KEYPLAN
1:500

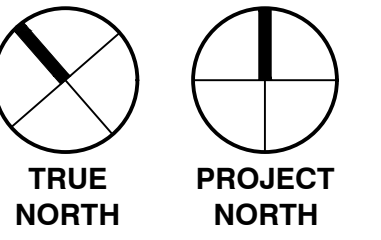

UBC ORCHARD CHILD CARE
6363 AGRONOMY ROAD
VANCOUVER, BC, V6J 0E5

PROJECT NO. 23-003

1 ISSUED FOR DP 2024.03.07

SECTIONS

L8.00

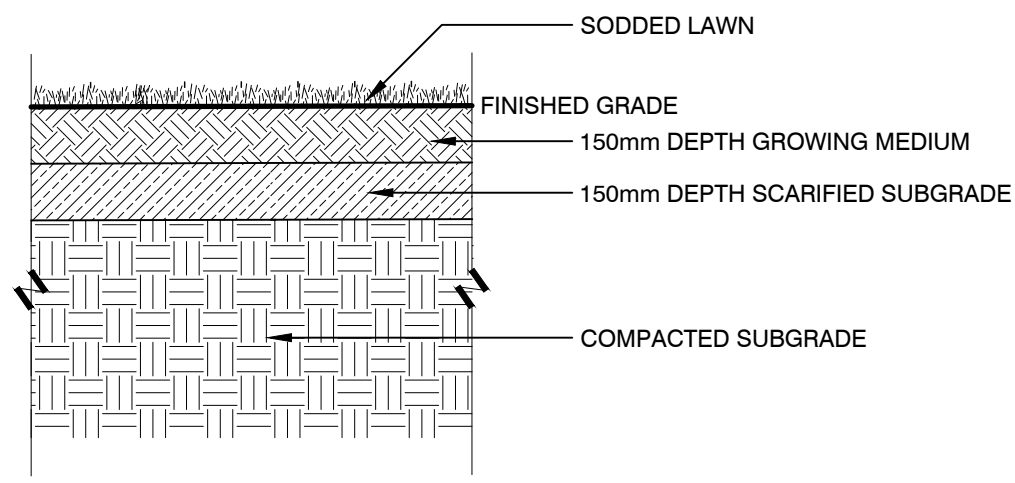

PROFILE A - SODDED LAWN

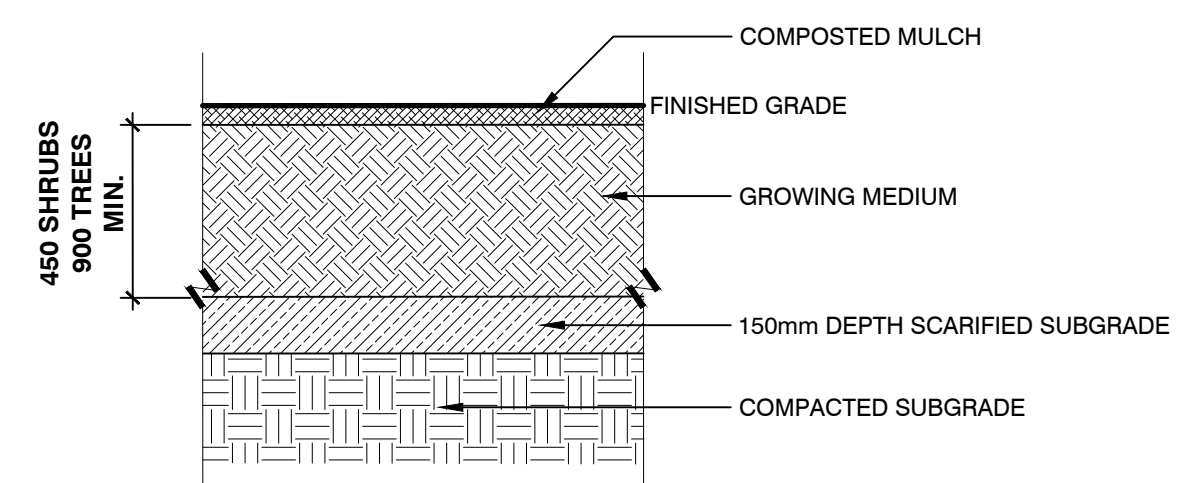

PROFILE B - PLANTING BEDS

1 SOIL PROFILES
1:20

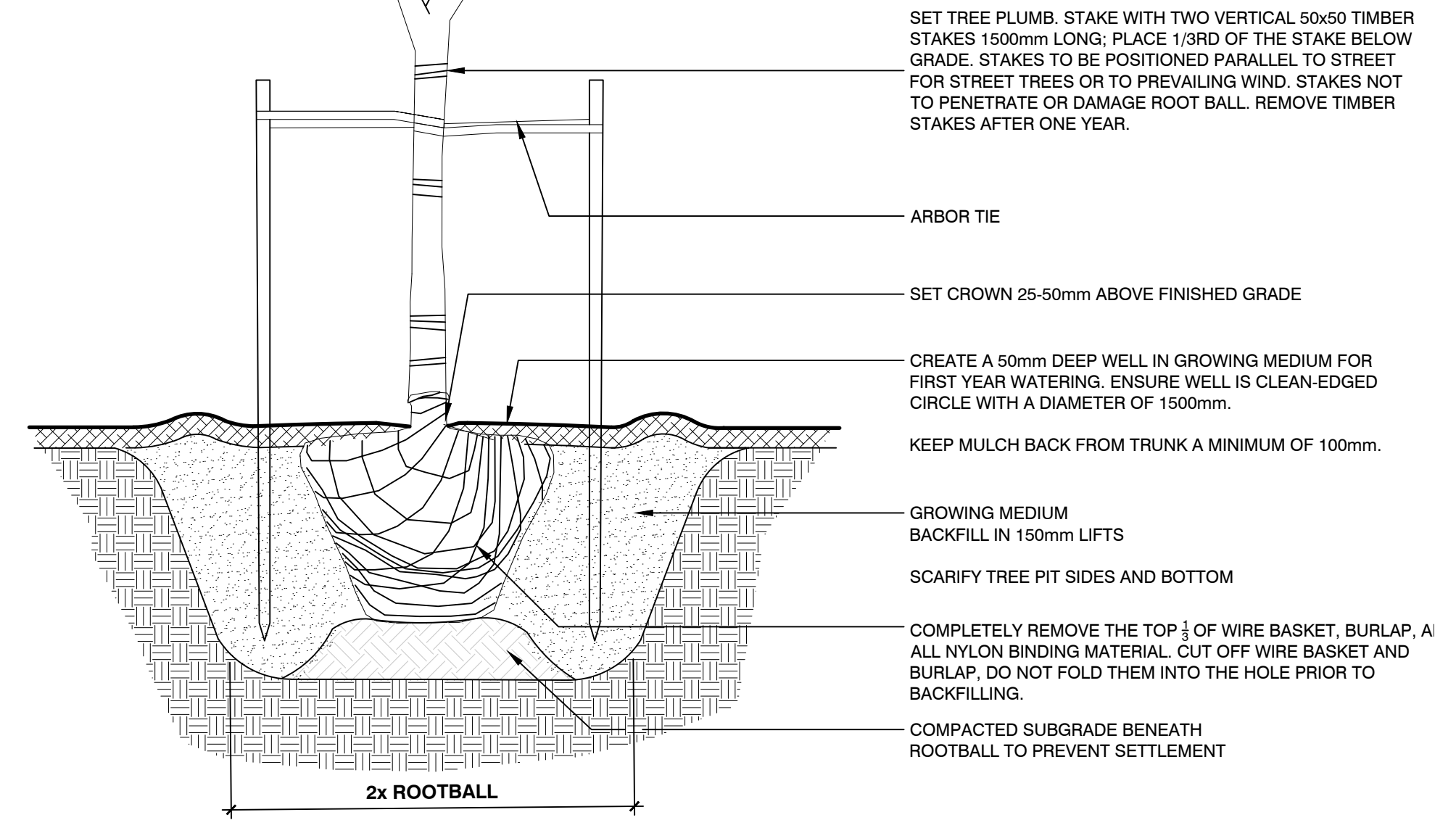
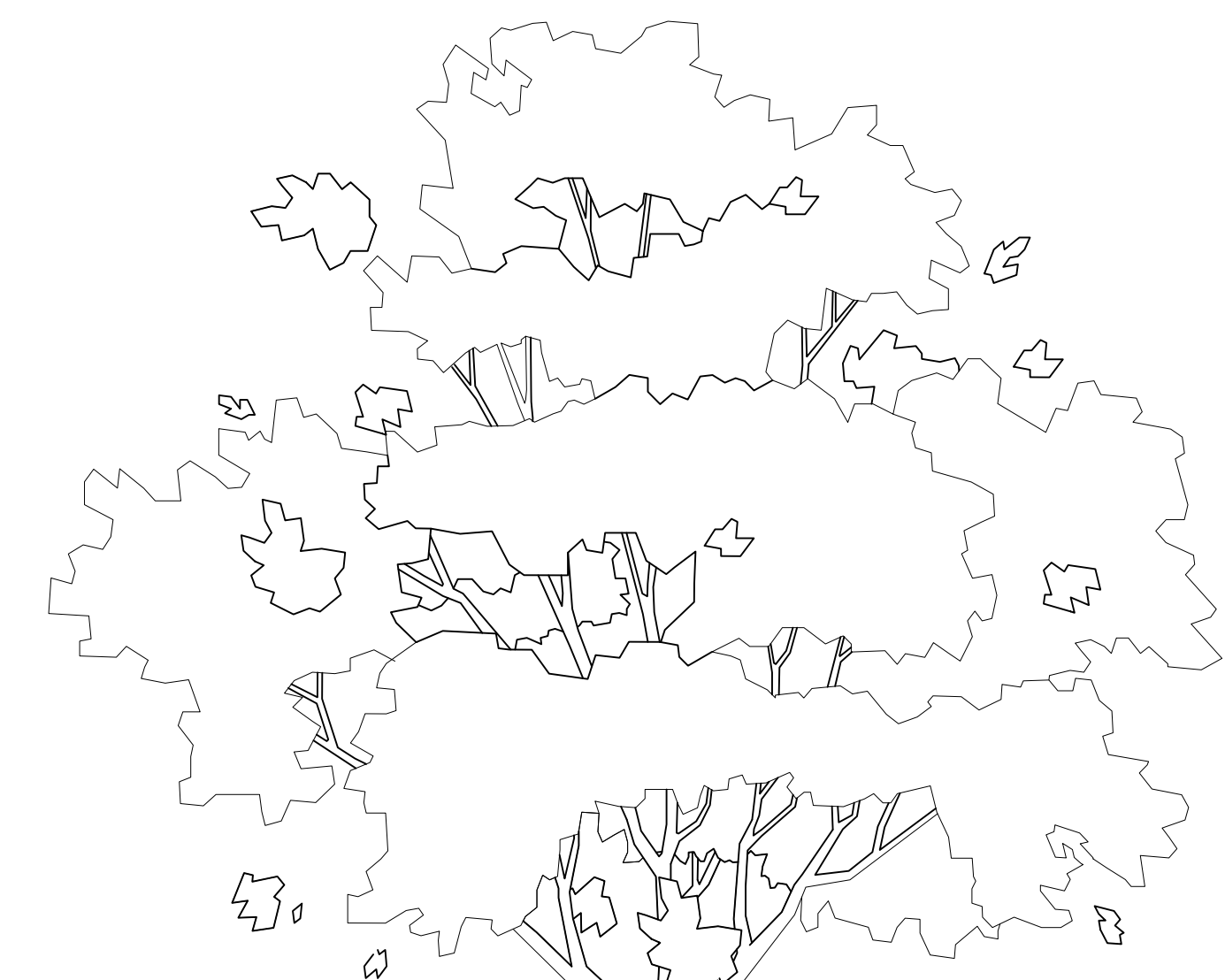

SET TREE PLUMB. STAKE WITH TWO VERTICAL 50x50 TIMBER STAKES 1500mm LONG. PLACE 1/3RD OF THE STAKE BELOW GRADE. STAKES TO BE POSITIONED PARALLEL TO STREET FOR STREET TREES OR TO PREVAILING WIND. STAKES NOT TO PENETRATE OR DAMAGE ROOT BALL. REMOVE TIMBER STAKES AFTER ONE YEAR.

ARBOR TIE

SET CROWN 25-50mm ABOVE FINISHED GRADE

CREATE A 50mm DEEP WELL IN GROWING MEDIUM FOR FIRST YEAR WATERING. ENSURE WELL IS CLEAN-EDGED CIRCLE WITH A DIAMETER OF 1500mm.

KEEP MULCH BACK FROM TRUNK A MINIMUM OF 100mm.

GROWING MEDIUM BACKFILL IN 150mm LIFTS

SCARIFY TREE PIT SIDES AND BOTTOM

COMPLETELY REMOVE THE TOP 1/3 OF WIRE BASKET, BURLAP, AND ALL NYLON BINDING MATERIAL. CUT OFF WIRE BASKET AND BURLAP. DO NOT FOLD THEM INTO THE HOLE PRIOR TO BACKFILLING.

COMPACTED SUBGRADE BENEATH ROOTBALL TO PREVENT SETTLEMENT

2x ROOTBALL

3 TREE PLANTING
1:20

NOTES:
1. MULCH TO BE KEPT ATLEAST 50mm WAY FROM STEMS OF SHRUBS.
2. PLANTING PIT TO BE FREE DRAINING.

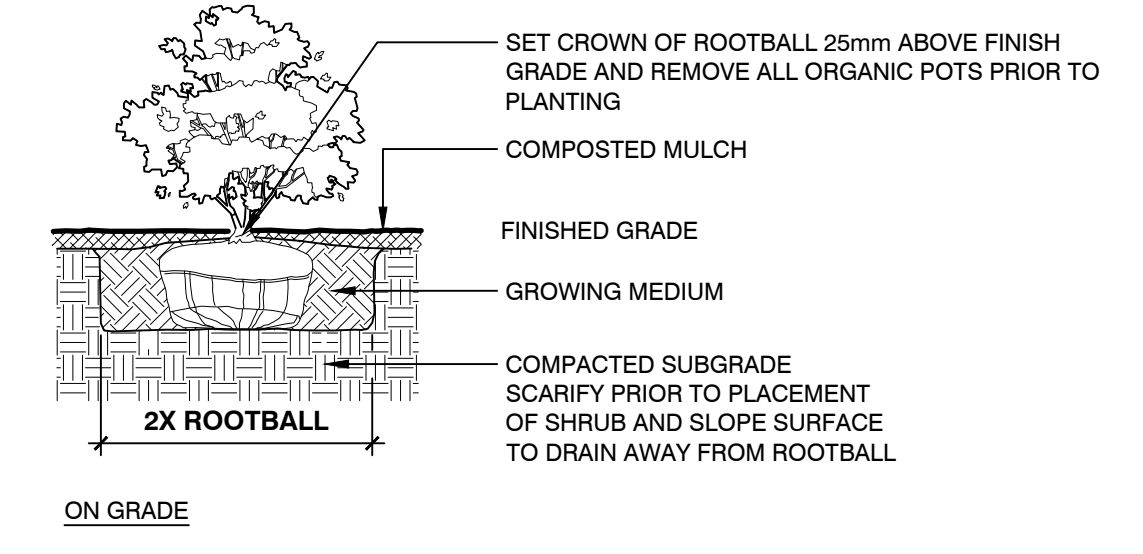

3 SHRUB PLANTING
1:20

NOTES:
1. MULCH TO BE KEPT ATLEAST 50mm WAY FROM STEMS.
2. PLANTING PIT TO BE FREE DRAINING.

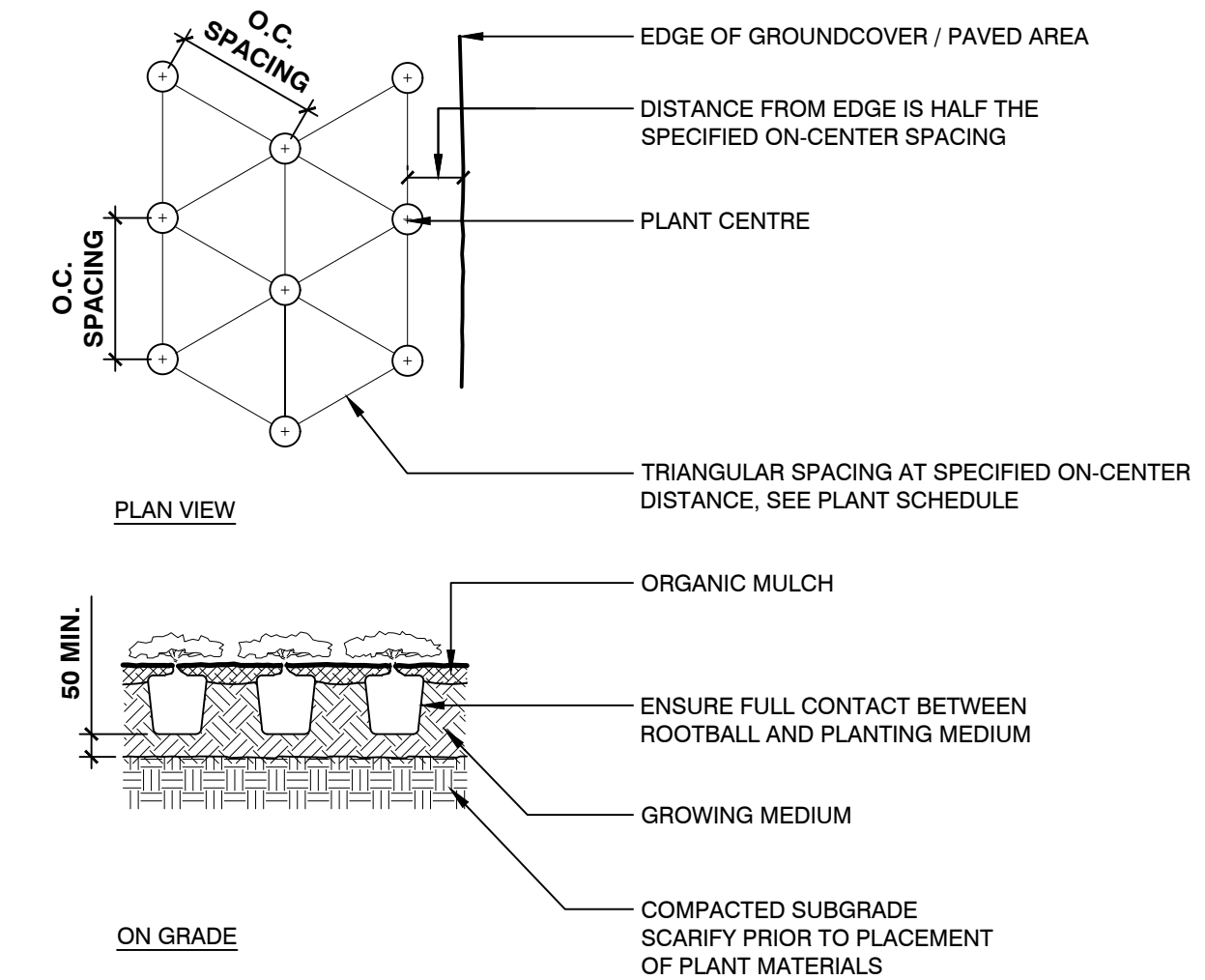

4 GROUNDCOVERS
1:20

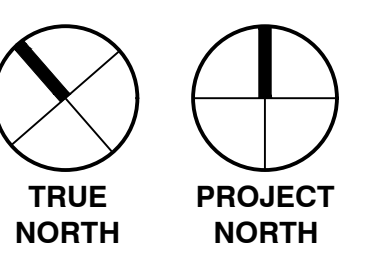

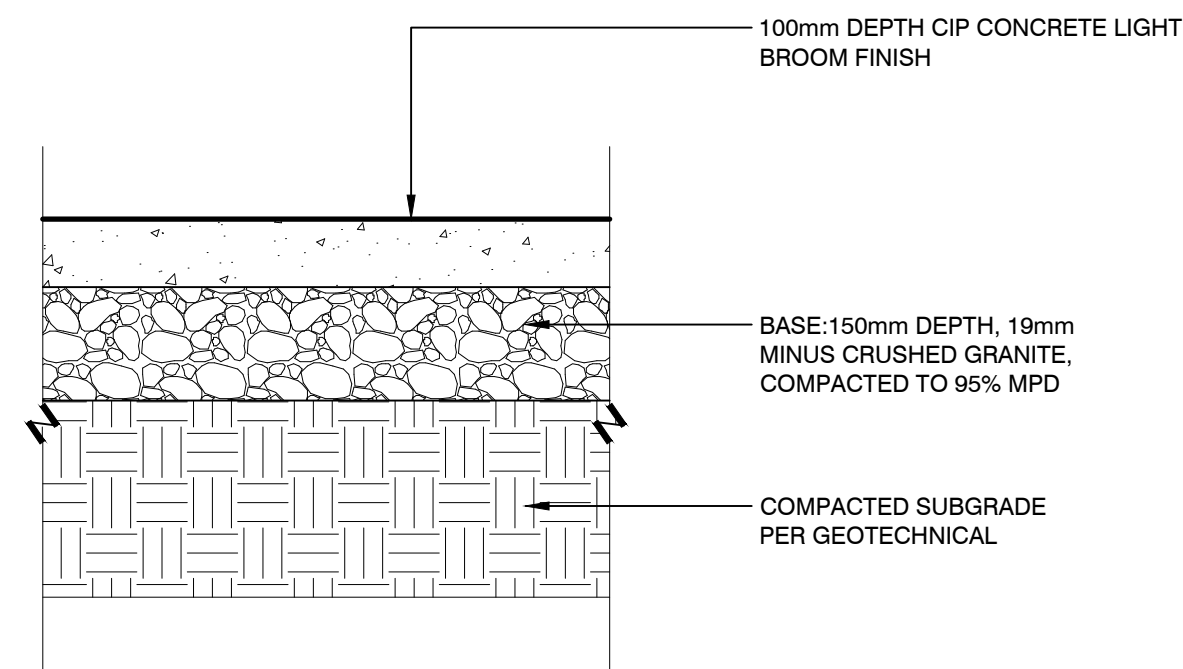
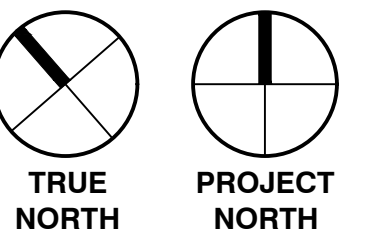

1 PAVING TYPE 1 - CAST IN PLACE CONCRETE ON GRADE
1:10

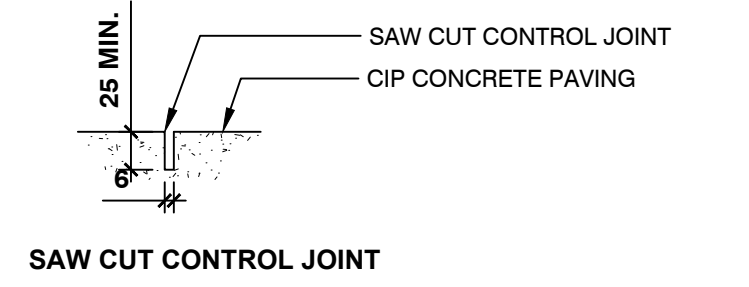

- NOTES:**
- WHERE DEPTH OF CIP CONCRETE EXCEEDS 100mm SAW CUT DEPTH TO BE MIN. 1/4 THE DEPTH OF CONCRETE.
 - CONTROL JOINTS TO BE CONSTRUCTED AT MAXIMUM 3m INTERVALS OR AS SHOWN ON PROJECT DRAWINGS.

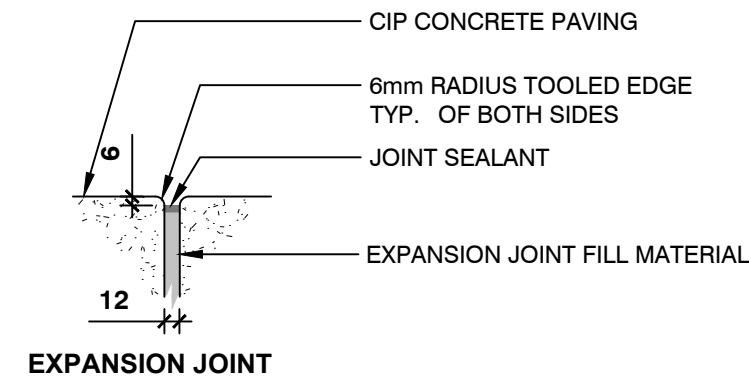

- NOTES:**
- EXTEND THROUGH FULL LENGTH OF CONCRETE.
 - INSTALL AT A MAXIMUM SPACING OF 9m OR AS SHOWN ON PROJECT DRAWINGS.

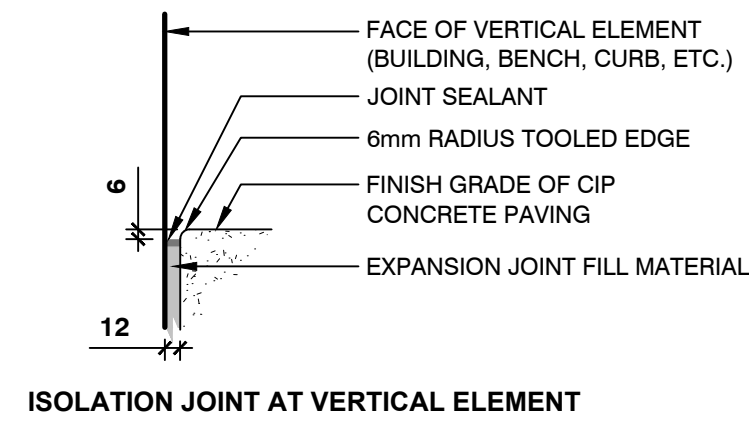

- NOTES:**
- USE 13mm PRE MOULDED HARDBOARD JOINT MATERIAL TO FORM ISOLATION JOINTS BETWEEN HORIZONTAL SURFACES AND ABUTTING WALLS AND STRUCTURES.
 - FORM ISOLATION JOINTS AROUND ALL POLES, HYDRANTS, MANHOLES, WALLS, AND ALL STRUCTURES OR OBJECTS LOCATED WITHIN CONCRETE SECTION.

2 CONCRETE JOINTING
1:5

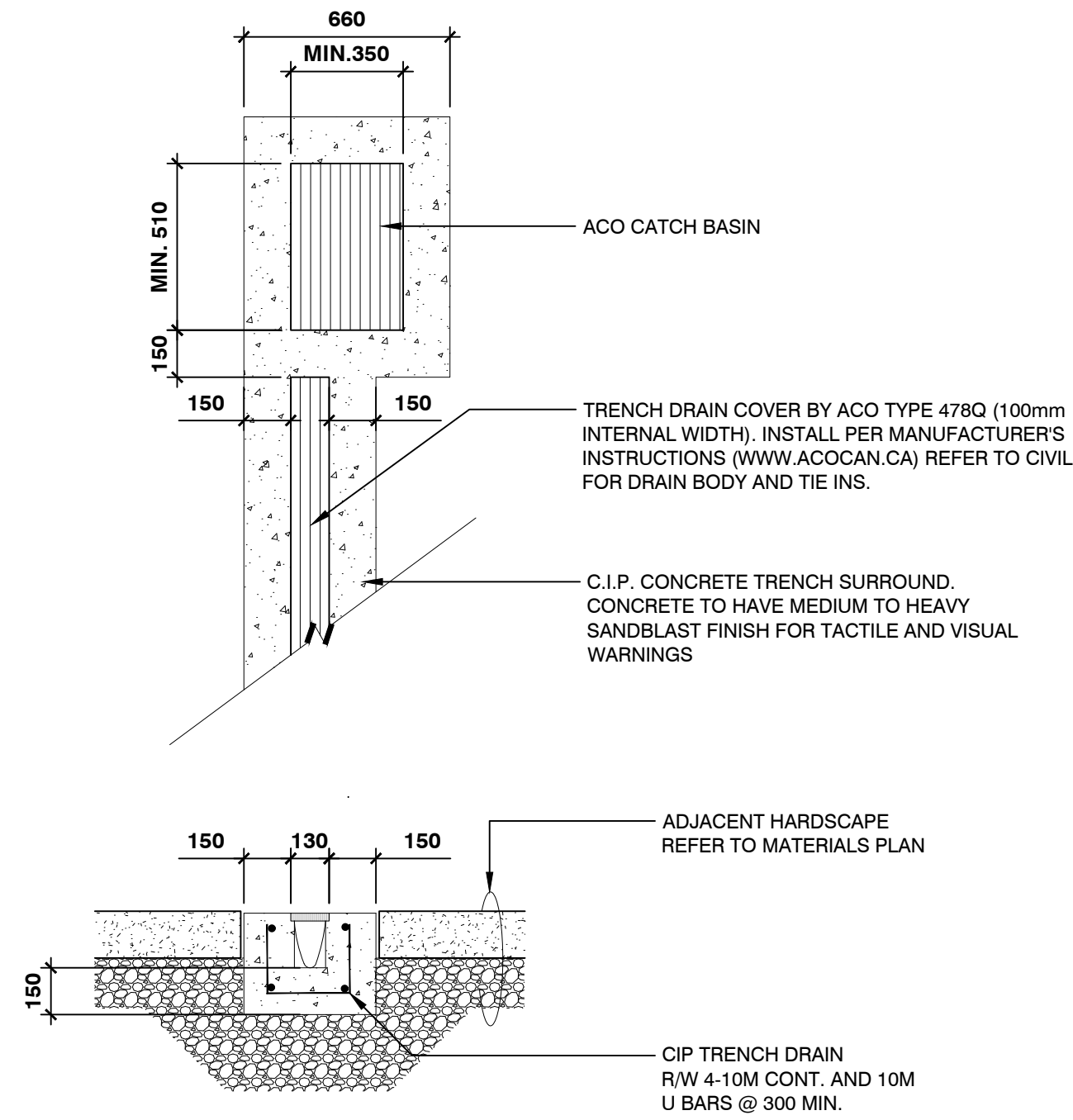

3 TRENCH DRAIN
1:20

- NOTES:**
- BOULDER TO BE 1/3 TO 1/2 BELOW GRADE.
 - NO SHARP EDGES, CRACKS OR BROKEN EDGES TO BE EXPOSED ABOVE GRADE.

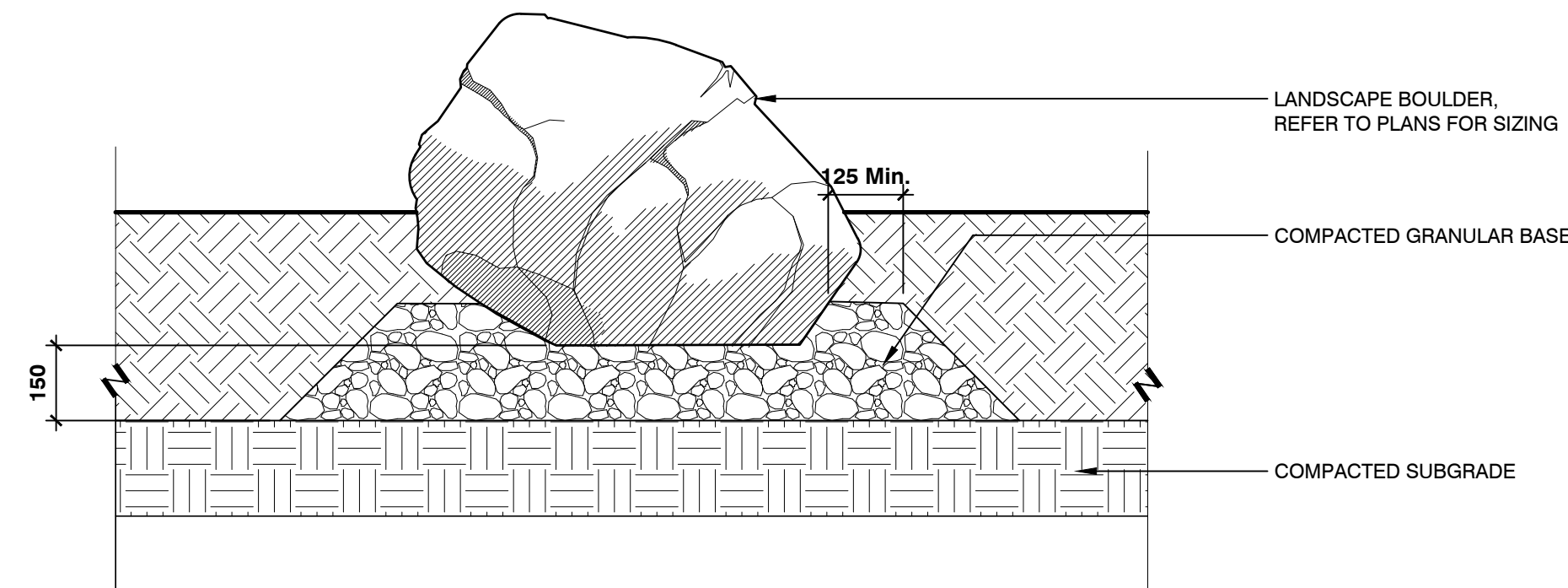

4 LANDSCAPE BOULDER
1:10

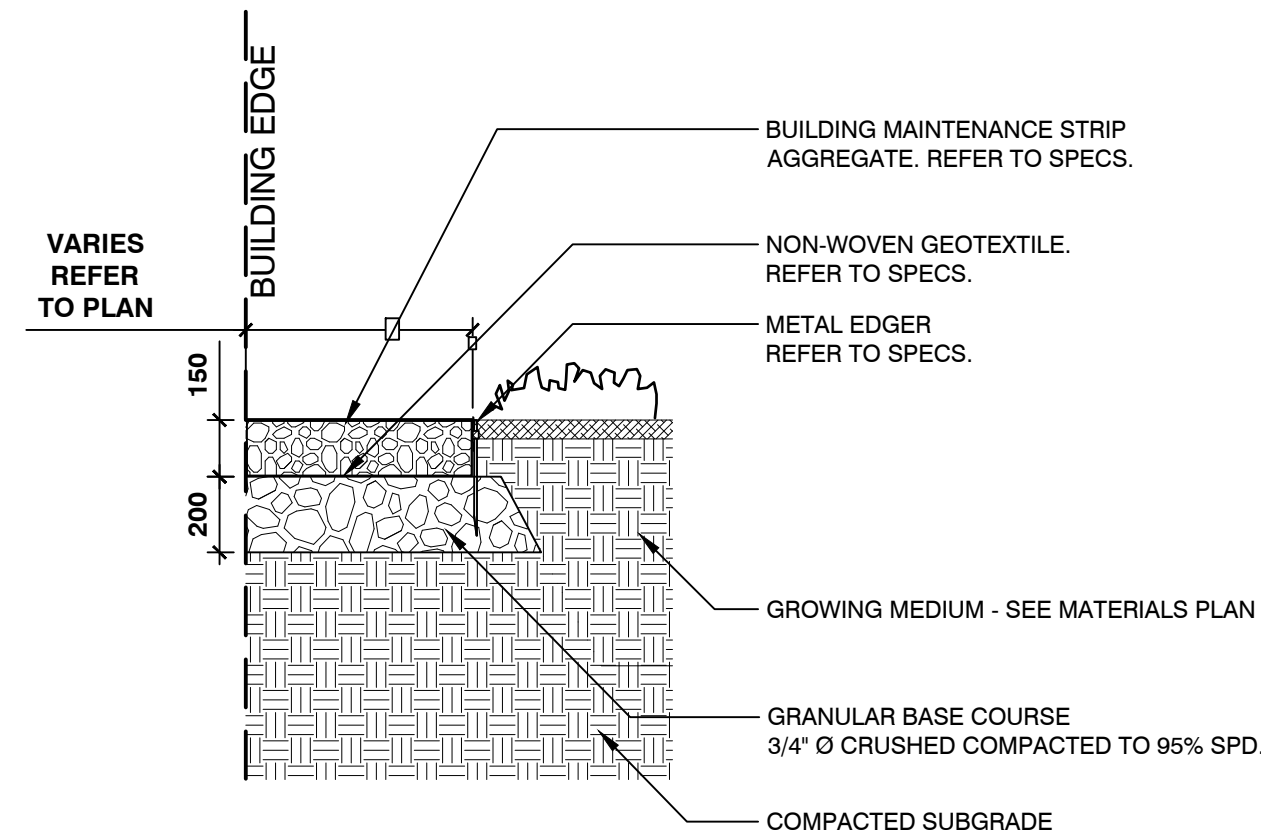

5 LANDSCAPE MAINTENANCE STRIP
1:10

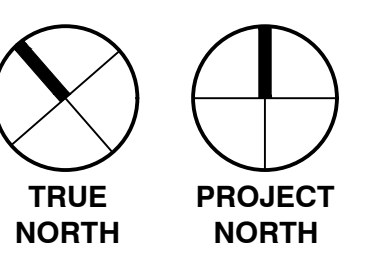

- NOTES:**
- TO BE INSTALLED PER MANUFACTURER'S INSTRUCTIONS.
 - SEE MATERIAL PLAN FOR LOCATION AND QUANTITIES.
 - PRODUCT:
 - MODEL: SERIES 32 SB32-P1-UBC SMALL RADIUS
 - MATERIAL: STEEL TUBE HOUSING
 - MOUNTING: 6" SCHEDULE 40 STEEL PIPE, IN-GROUND
 - 24" DEEP ON CONCRETE BASE
 - COLOUR: UBC GREY (RAL #7043)
 - SUPPLIER: FRANCES ANDREW SITE FURNISHINGS LTD. WWW.FRANCESANDREWS.COM 1-800-565-6579

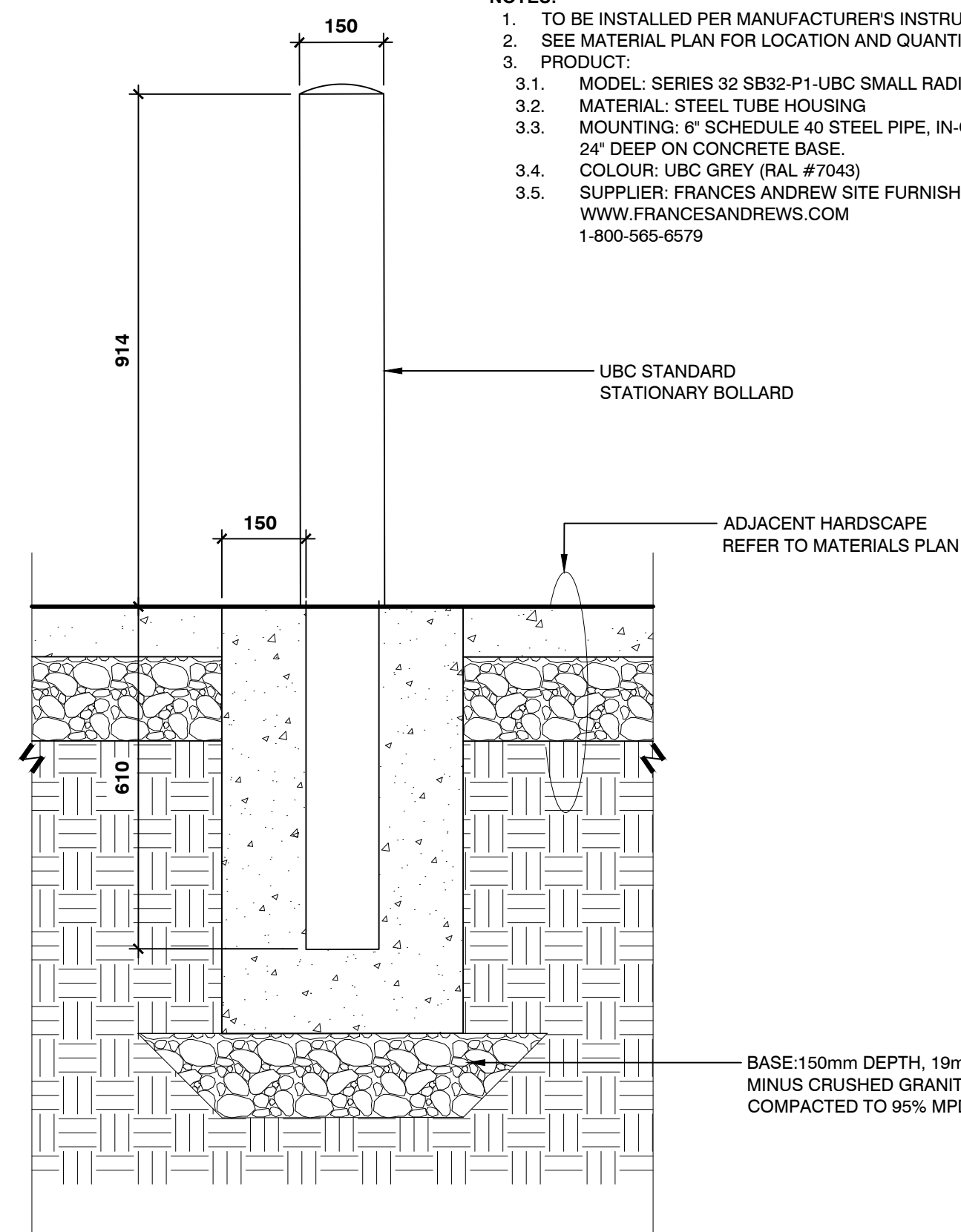

1 INGROUND BOLLARD
1:10

- NOTES:**
- TO BE INSTALLED PER MANUFACTURER'S INSTRUCTIONS.
 - USE ONE TAMPER PROOF ANCHOR PER RACK
 - SEE MATERIAL PLAN FOR LOCATION AND QUANTITIES.
 - PRODUCT:
 - MODEL: URBAN STAPLE
 - SCHEDULE 50 STEEL PIPE WITH FLAT CROSS BAR
 - FINISH: HOT-DIP GALVANIZED
 - SUPPLIER: URBAN RACKS 1-888-717-8881 WWW.URBANRACKS.COM

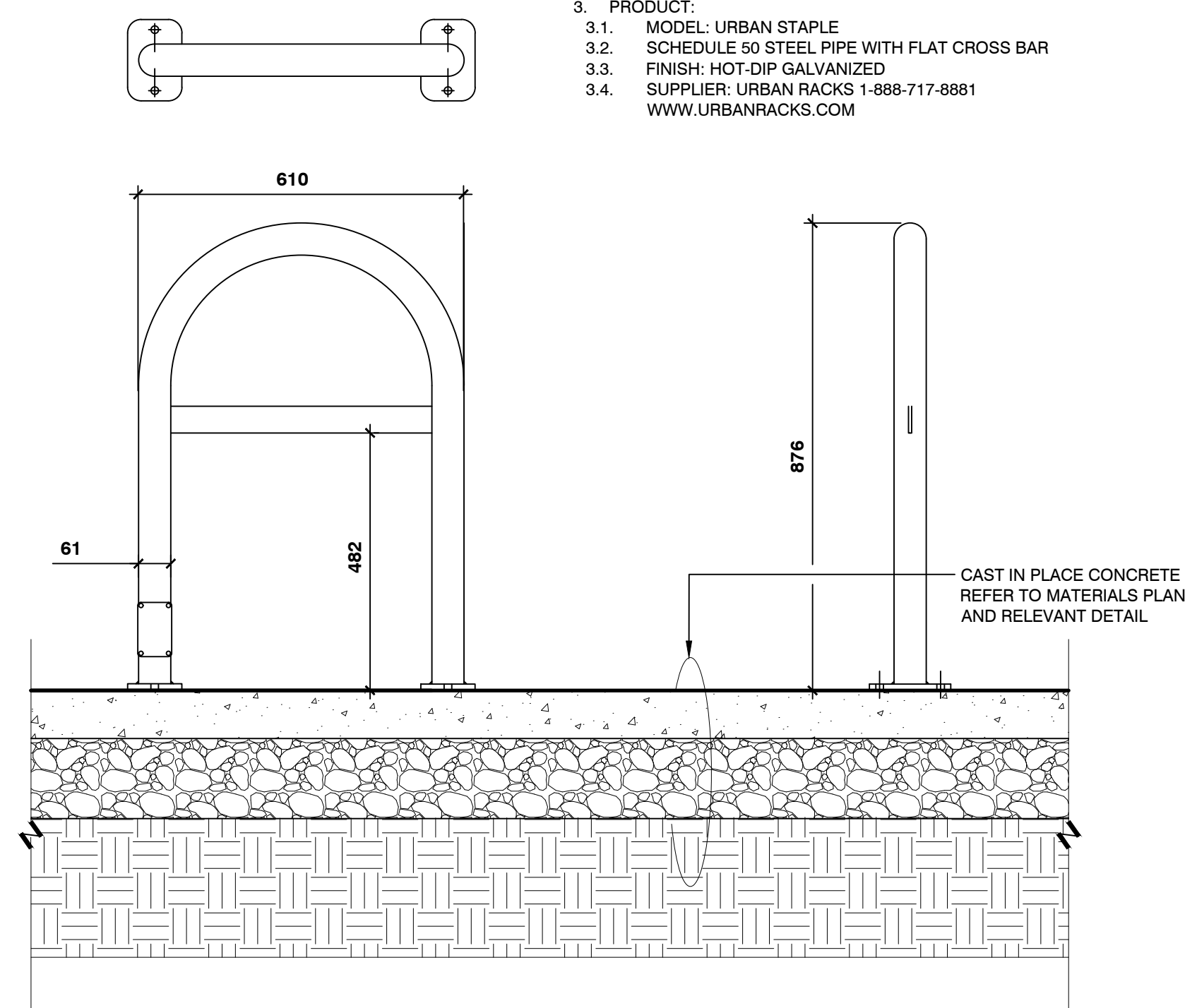

2 UBC STANDARD BIKE RACK (SURFACE MOUNT)
1:10

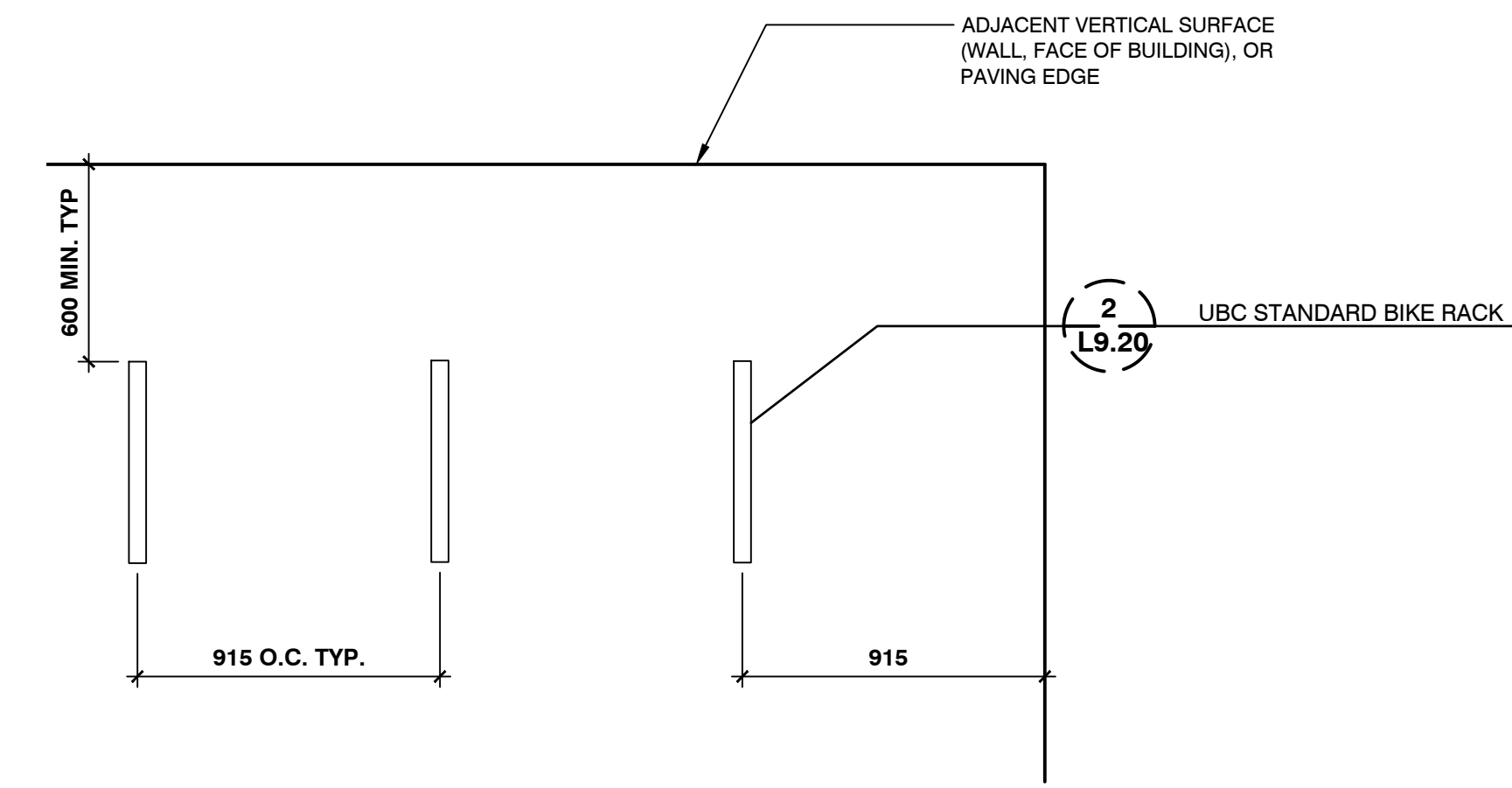

3 TYPICAL BIKE RACK LAYOUT
1:20

- NOTES:**
- SUBMIT ENGINEERED SHOP DRAWINGS PRIOR TO FABRICATION.
 - ALL WOOD TO BE YELLOW CEDAR.

- WEATHERING STEEL LEGS 9.5mm THICK WEATHERING STEEL
- YELLOW CEDAR WOOD PLUG
- 13mm GALVANIZED STEEL THREADED ROD WITH NUT/WASHER ASSEMBLY BOTH ENDS.
- 38X10mm NYLON SPACER
- UPSTAND PLATE
- WOOD BACKREST OPTION
- S.S ANCHOR BOLTS - TAMPERPROOF HILTI 1/2" X 3"
- 75x480 x 9.5mm THICK 316 S.S. STRAPPING
- ARMREST (2) 50mm WIDE x 10mm THICK S.S. ATTACHED TO TIMBERS WITH S.S. SCREWS

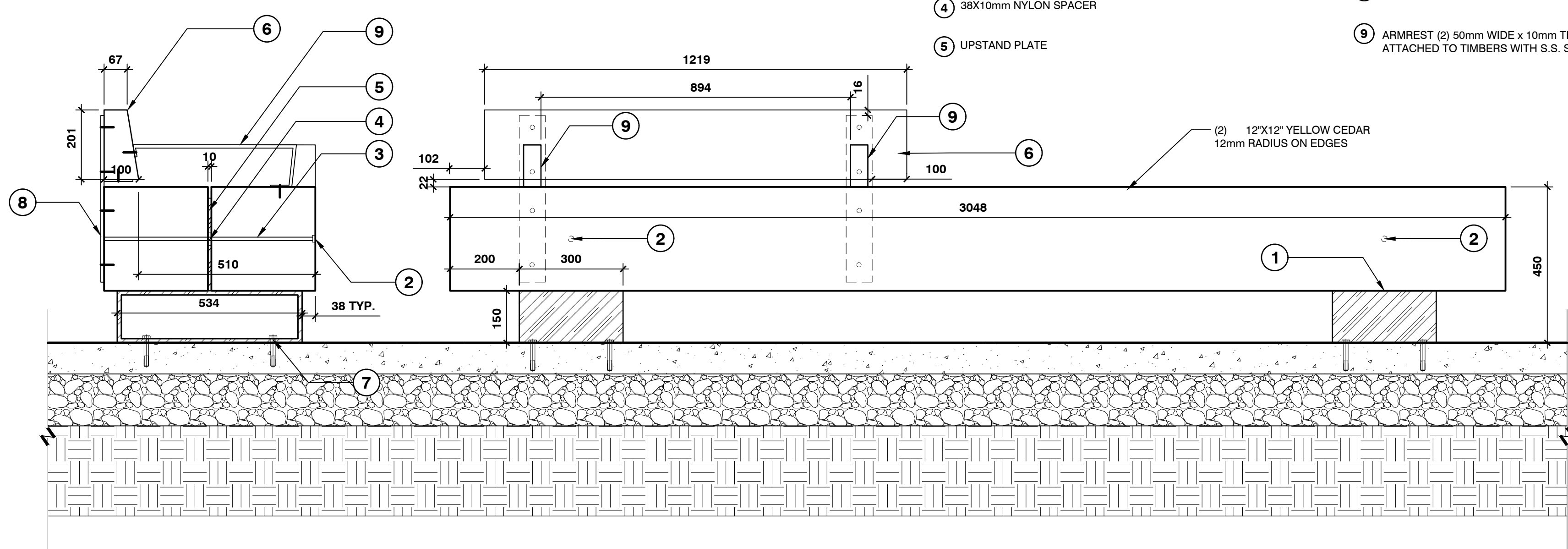

4 HEAVY TIMBER BENCH - OPTIONAL BACKREST + ARMREST
1:10



REFERENCE IMAGE FOR DESIGN INTENT ONLY

UBC ORCHARD CHILD CARE
6363 AGRONOMY ROAD
VANCOUVER, BC, V6J 0E5

PROJECT NO. 23-003

1 ISSUED FOR DP 2024.03.07

FURNISHINGS DETAILS

L9.20