



Minutes | Community Advisory Committee

Campus Vision 2050

Date & Time: February 22nd, 2024 from 4:30-6:30PM

Location: BC Hydro Theatre (CIRS Building)

Committee Attendees

Name	Role
Naton Ting	Students
Henry Yu	Faculty
Joe Dahmen	Faculty
Michele Koppes	Faculty
Ella Shi	Residents
Paul Thorkelsson	Residents, UNA
Deb Pickman	Alumni

Campus + Community Planning Staff Support

Name	Role
Joanne Proft	Associate Director, Planning
Aviva Savelson	Senior Manager, Engagement
Brittany Jang	Community Planner

Committee Regrets

Name	Role
Leona Sparrow	Musqueam
Wade Grant	Musqueam
Kamil Kanji	Students, AMS
Emily Tang	Students, GSS
Gia-An Trinh	Students
Max Arsenault	Students, Physical Disabilities
Robin Poirier-Vasic	Staff
Alex Volkoff	Residents
Jennifer Cue	Alumni



Minutes | Community Advisory Committee

Campus Vision 2050

Agenda Item	Issues/Conclusions	Action
1. Welcome	Joanne Proft introduced herself as chair and welcomed Paul Thorkelsson, CAO, UNA replacing Sundance Topham.	
2. Status Update	Joanne Proft shared an update on the Board of Governors' approval of the Land Use Plan and its implications for the implementation of Campus Vision 2050. She noted that the Land Use Plan has been shared with the Province and UBC is awaiting its adoption.	
3. Initial Campus Plan Frameworks	<p>Joanne Proft shared an overview of three draft frameworks as part of the 10-Year Campus Plan process, focused on biodiversity, open space, and campus design.</p> <p><i>Biodiversity and Open Space</i></p> <ul style="list-style-type: none">• Are there conversations with Musqueam around the Farm?<ul style="list-style-type: none">– Staff shared that there are ongoing discussions with Musqueam about the Farm, including the construction of a new Farm Centre and removal of invasive species along the forest edge of the Farm.• What defines the character of parks, what differentiates a natural, green, or open space?• Consider diverse perspectives around what characterizes a good/nice open/green space. <p><u>Discussion Question: What's needed for this framework to be an effective planning/design/ operational tool?</u></p> <ul style="list-style-type: none">• From an operations perspective, how can the framework inform changes to the landscape in terms of enhancing biodiversity and ecology in existing neighbourhood landscapes?• The UNA would like flexibility to change landscape maintenance standards over time.<ul style="list-style-type: none">– The UNA understands that Properties Trust designs landscapes that are attractive for marketing purposes, however they are expensive to maintain. In addition, they often do not reflect interests around climate resilience, culture, and history of this place.– Staff shared that UBC and the UNA are currently revising maintenance standards in the UNA Neighbours' Agreement.• It is difficult to reconcile a framework for biodiversity that is separate from rainwater and climate adaptation/resilience.<ul style="list-style-type: none">– The frameworks approach needs to be less siloed.– The draft framework reflects an antithetical relationship between biodiversity/ecology spaces and people spaces.	



This framework should enhance connections between nature and humans.

- To support implementation, staff need to enhance communication around Campus Vision and the Campus Plan to convey the amount of work and change/difference from 2010.
 - Need more supporting narrative around how the values have evolved from 2010 and the “why” driving the new set of changes.
 - Also communicate how the Campus Plan translates Campus Vision into reality on the academic campus.

Discussion Question: Is there additional research/analysis that could feed into/come out of this framework?

- Some feel there is a need for mechanisms to protect green and open space that removes it from future planning consideration (i.e., conversion into non-open space).
- The patchwork theory of ecological restoration may not be that effective. It is important to connect large areas of high ecological value.
 - Biodiversity framework as presented does not seem very compelling, particularly given most of the campus is shown as micro-corridors and micro-habitat. Would like to see a better approach to connecting large-scale areas of high-value biodiversity (i.e., stepping stones) with the rest of the campus and surrounding area.
- Opportunity to incorporate Campus as a Living Lab projects.

Campus Design

Discussion Question: What’s needed for this framework to be an effective planning/design/ operational tool?

- Objectives sound generic, instead need to highlight what is unique to UBC (e.g., academic community, biodiversity, etc.).
 - Update the goal to weave in biodiversity.
- Would like to see the Arts & Culture District as a community heart, to give recognition to cultural anchors, their role in serving the community, and need to increase amenities to serve the area.
 - Community hearts should be more than just a retail/commercial focus.
 - Another community heart is missing around Thunderbird Stadium with a sports/athletics focus.
 - The framework should help communicate that UBC already has many significant existing cultural assets. Narrative could be speak to how these existing facilities can be leveraged to support greater visitation and tourism from both within the campus community and the region.
- How can this framework leverage existing assets, including natural assets?



One member not present followed-up after the meeting to share insights into Campus Design, including thoughts around “key moments” and “key character zones.”

- Key moments make UBC unique compared to other campuses in North America. Aside from achievements in academics and research, character areas (described below) are a competitive advantage relative to other post-secondary institutions. The following three aspects are most critical:
 - Vistas: including access to natural beauty, the physical place, and history of the land.
 - Wilderness: including the vast forest and access to beaches, water, mountains and overall natural beauty.
 - Cultural Hub: including the Chan, MOA, Arts buildings, Rose Garden, and Nitobe as gathering places for students and visitors.
- Character zones could be distinct by academic function and/or student life, and be identifiable and accessible for all—including visitors. All character zones should reflect the full set of Campus Vision principles, for example including aspects of Musqueam education/understanding, accessibility, and sustainability. Zones could be delineated more effectively to provide more ease of access and understanding/learning (e.g., identifying zones with indicators of their achievements). Some ideas:
 - Cultural Zone: anchored around the Chan/MOA/Arts, a cultural hub for students and visitors, offering a combination of cultural, academic, natural (i.e., vistas of the ocean and mountains), and heritage (i.e., MOA) moments.
 - Library Zone: a restorative area for learning, with spaces for students to study and socialize.
 - Sciences Zone: anchored around Engineering/Sciences, innovation, and research, highlighting learning, innovation, and breakthrough research.
 - Medical Zone: defined by the hospital, and a secondary area for the sciences/innovation, with access to amenities for physical wellbeing.
 - Athletics Zone: an area to undertake physical activities, watch high-level sports, and celebrate university pride.
 - Beach Access Zone: a unique feature of the campus, where paths and access to beaches and ocean should be improved and highlighted.
 - Pacific Spirit Park: an escape to the natural landscape that exemplifies the Pacific Northwest.
- Overall, when possible, maintain views/vistas to the region.

4. Role of the CAC

Joanne Proft shared that since the last meeting in May 2023, some members have resigned from their role or are no longer eligible for their role. The Committee was asked whether they wish to see the CAC continue and vacancies filled through to completion of the Campus Plan in 2025, or dissolved and alternative engagement opportunities found for interested members.

Staff to update the CAC ToR to be circulated among existing members and to support the



-
- Members present shared a strong desire to continue the CAC, seeing value in a diverse range of perspectives at one table.
 - One member not present followed-up after the meeting, to also share a strong desire to continue the CAC. They acknowledged that the CAC has been successful in surfacing many differences in opinions, generating productive feedback and inputs into the Campus Vision process.

process to fill vacancies.

5. Next Steps

Next meeting: TBD, following Provincial adoption of the Land Use Plan (decision pending).

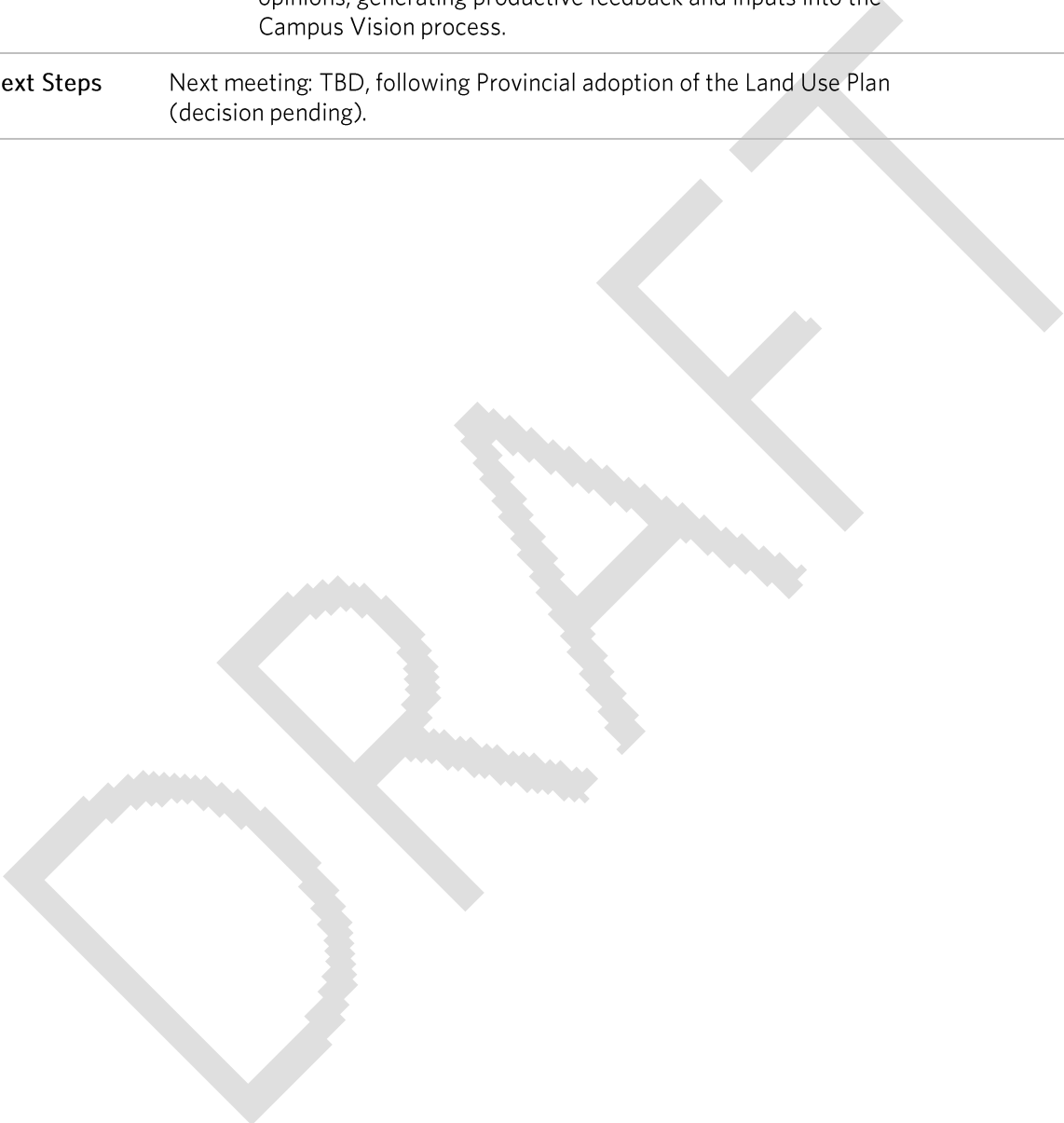

UBC
campus
vision
2050



Meeting 16 | February 22nd, 2024

Campus Vision 2050 Community Advisory Committee



THE UNIVERSITY OF BRITISH COLUMBIA
Campus + Community Planning

campusvision2050.ubc.ca



Agenda

1. Status Update
2. Initial Campus Plan Frameworks
3. Role of CAC
4. Next steps



Status Update

The background features several overlapping, curved, organic shapes in various colors: a teal shape on the left, a dark blue shape at the top left, a light blue shape in the upper right, an orange shape on the right, and a purple shape at the bottom right. The text 'Status Update' is positioned in the dark blue area.

CV 2050 Timeline

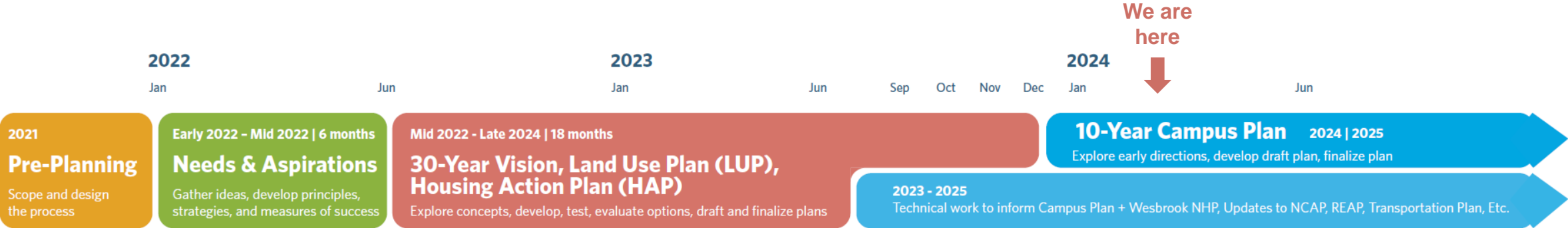

CV 2050 Implementation 2024/2025

◆ Public Engagement
 ◆ Jan/ Feb Targeted Engagement
 ◆ Board of Gov.
 ➔ Inputs

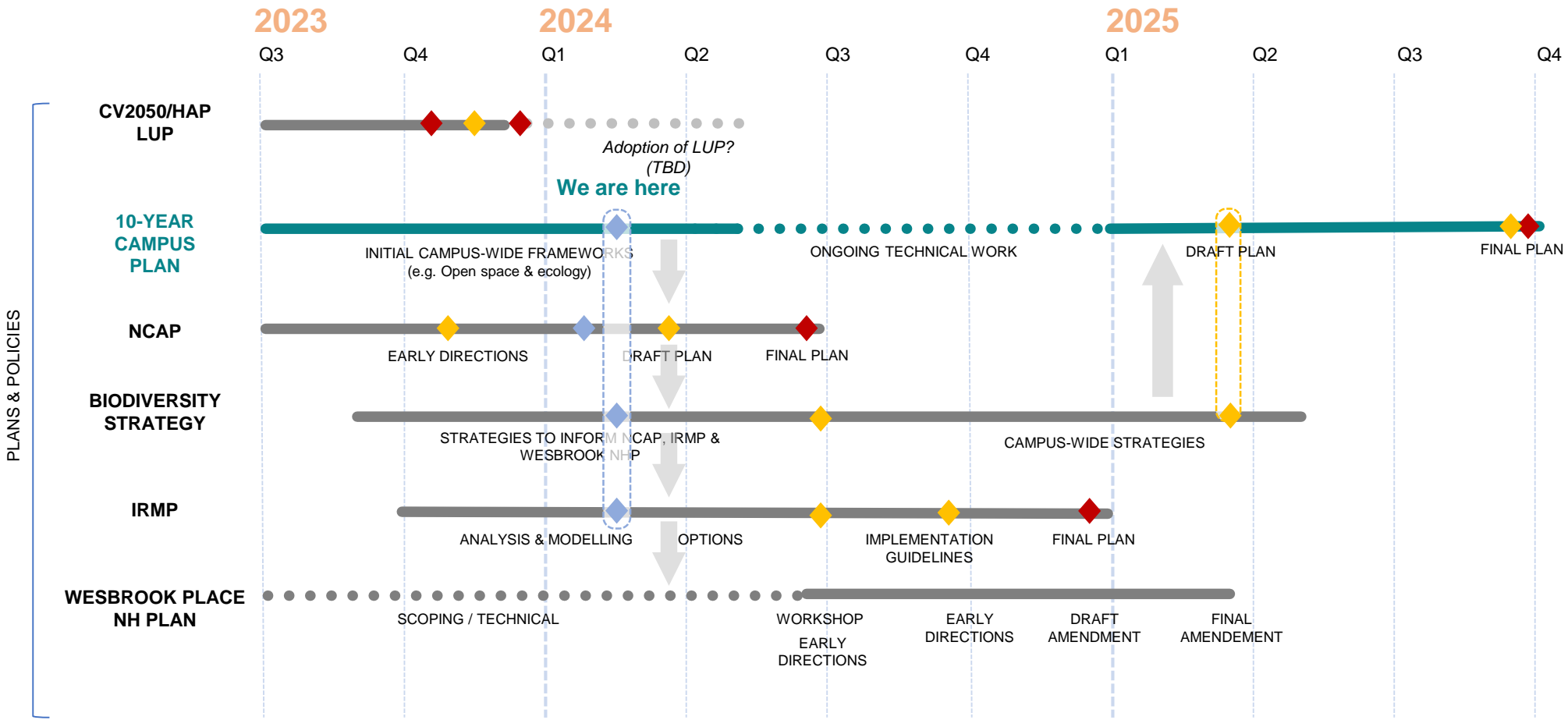



Initial Campus Plan Frameworks

Purpose of the Campus Plan

- The Vancouver Campus Plan provides detailed guidance for where and how future academic and research activities, student housing and services will be accommodated, in alignment with Campus Vision 2050 and the Land Use Plan.
- Also identifies how neighbourhoods and surrounding areas are integrated in terms of transportation, open space and ecology.

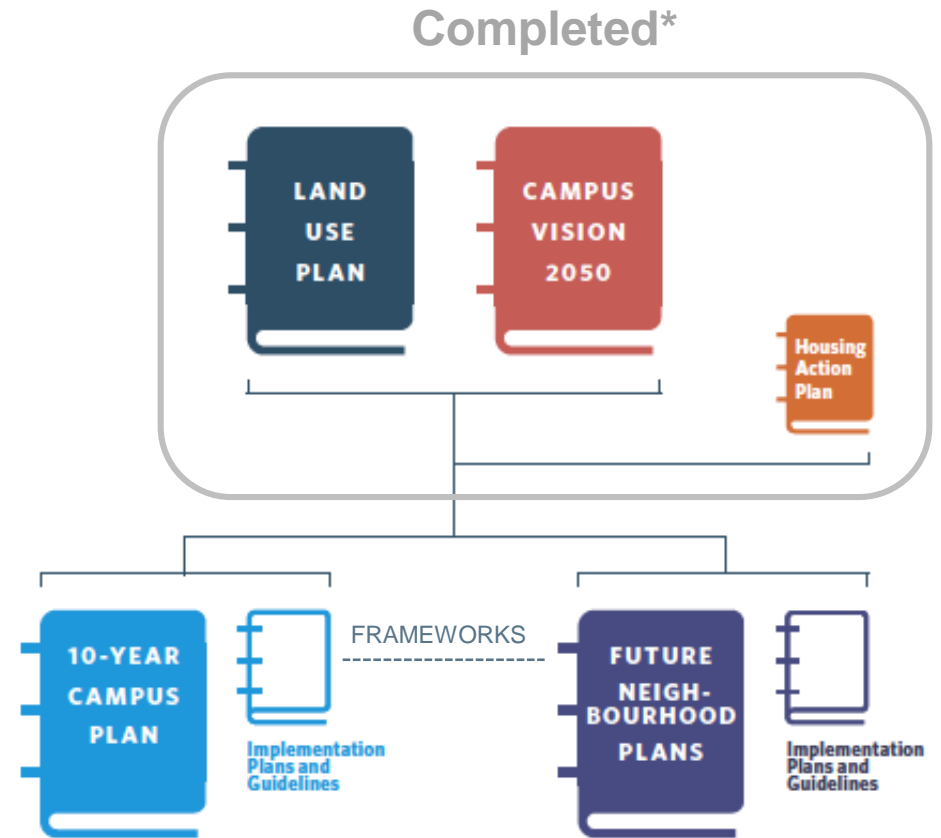

**In December 2023, the UBC Board of Governors endorsed the proposed amendments to the Land Use Plan (LUP) and approved its submission to Province for consideration of adoption. The Board also approved Campus Vision 2050 and the updated Housing Action Plan (HAP), subject to adoption of the LUP by the Province.*

Hierarchy of Plans and Policies

High-level, more broad
 Longer time horizon
 Updated less frequently,
 Lasts over time

More specific targets
 and actions
 to implement
 high-level policies

Area-specific direction
 Shorter time horizon
 Updated more frequently
 to keep pace with change

Project-specific
 application

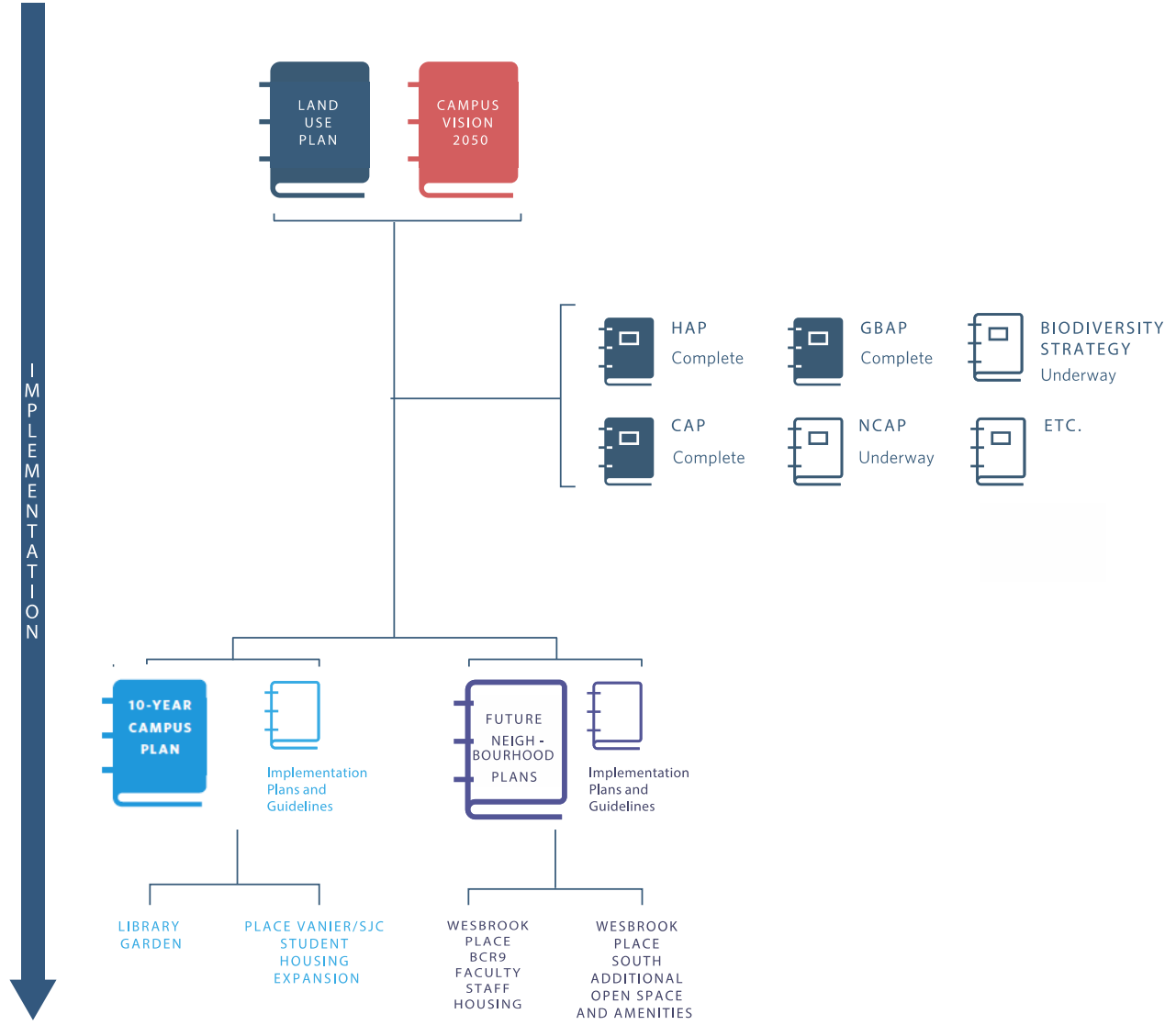

How the Campus Plan is Used

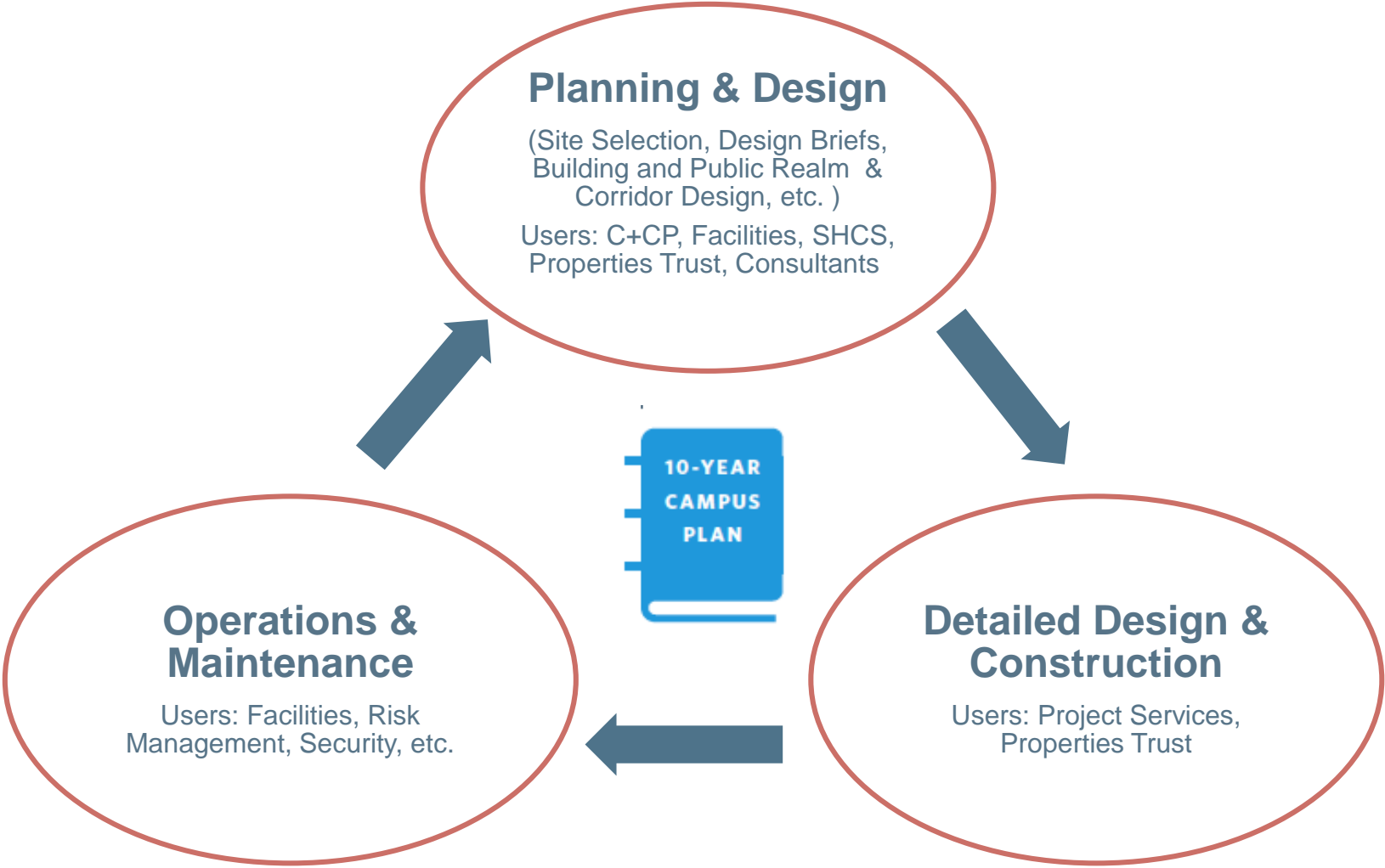

What the Campus Plan will Include

- **Background and context** – e.g. policy context, applicability, etc.
- **Frameworks**– e.g. biodiversity, open space, transportation, campus / urban design
- **Design guidance** – e.g. policies, guidelines, etc.
- **‘Place’ specific concepts** – e.g. indicative designs for key places and corridors (i.e. Main Mall, the Diagonal, SkyTrain Station area, etc.)
- **Process and implementation** – e.g. site selection, project reviews and approvals, monitoring, etc.



2010 Campus Plan

Inputs to Campus Plan Frameworks

- Land Use Plan policies (2023)
- Campus Vision 2050 guiding principles, big ideas, strategies and engagement summaries (2023)
- Transportation Planning Report (2023)
- Ecological Baseline Report (2023) including SEEDS, CBIRD and LiDAR data
- **UBC-Musqueam Peninsula Coordination Maps and Campus Existing Conditions Mapping** (2022)
- **Work Sessions with CBIRD** to identify ecology/biodiversity priorities (2021-2023)
- **Campus Plan Staff User Interviews** (June 2023)
- **NCAP Emerging Directions** (October 2023)
- **Initial Ideas Workshop** with staff + consultants (October 2023)
- Vancouver Campus Plan (2010)

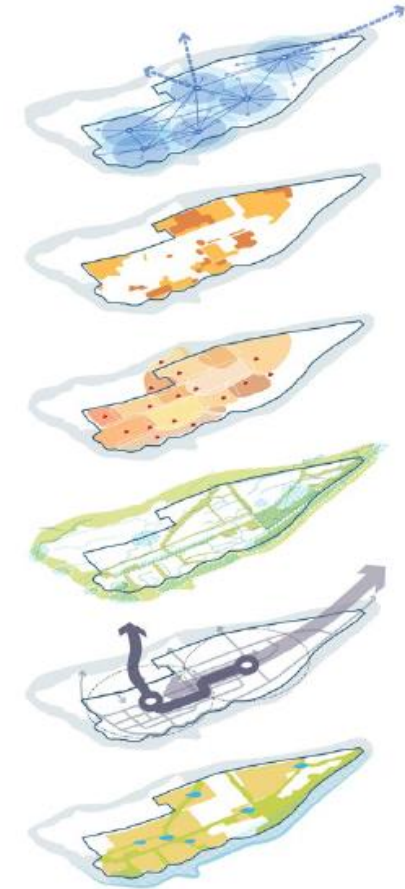

Campus Vision 2050 Big Ideas

Anticipated Key Areas of Change <2035



Buildings:

- Chem, Applied 1, Med 1, Math
- TEF 4 & 5
- Public Safety Site (Acadia)
- Underway: Gateway, SBME, Rec North, Brock 2, Sauder, Orchard Childcare, UBC Farm

Corridors

- East Mall, Main Mall, Lower Mall
- Central & North Connectors
- West 16th Ave intersections & Wesbrook Mall South

Hubs

- Armouries, Lower Mall Precinct

Neighbourhoods

- Wesbrook South
- Wesbrook School

Amenities

- Childcare, food, athletics and rec
- South Campus Works Yard

Biodiversity, Ecology & Open Space

The background features a series of overlapping, curved, organic shapes in various colors: a teal shape on the left, a dark blue shape in the upper left, a light blue shape in the center, an orange shape on the right, and a purple shape at the bottom right. The text is positioned in the upper left corner, set against the dark blue background.

Campus Vision 2050 Big Idea: Restorative and Resilient Landscapes

Diagram is for illustrative purposes only. Future design and layout of buildings, streets and open spaces are subject to more detailed planning.



KEY STRATEGIES

- Protect and enhance existing high-value ecological areas (e.g., UBC Farm forested area) and habitat for wildlife
- Working with Musqueam, identify areas of campus with significant cultural value and create campus gateways and landscapes with a strong Musqueam welcome and presence
- Create substantial new green spaces for social, recreational, research and ecological benefit
- Create and protect ecological and mobility corridors, including a new east-west diagonal connector
- Extend surrounding forests into the campus to support species movement and increase biodiversity
- Introduce abundant indigenous plants traditionally harvested by Musqueam, and work with Musqueam to plan and steward these landscapes including removal of invasive species
- Provide equitable access to nature on campus, emphasizing accessible walking, rolling and cycling paths

Biodiversity + Ecology

Draft Goals and Objectives

Vision

- An ecologically rich campus connected to its unique natural setting and reflecting a deep Musqueam presence and sense of welcome. (source: Vision, restorative and resilient landscapes big idea statement)

Goal

- Support simultaneous improvements in human and ecological health and wellbeing. (Source: UBC 20-Year Sustainability Strategy)



Biodiversity + Ecology

Draft Goals and Objectives

Objectives

- Maintain and enhance urban biodiversity
- Strengthen Musqueam presence on campus through biodiversity and ecology
- Enable connection with the land and nature on campus
- Support species movement and habitat creation
- Mitigate downstream ecological impacts
- Strengthen campus climate resilience and adaptation
- Advance biodiversity research, education, and awareness
- Make ecology a visible part of the public realm

Background



Figure 11. Ecological condition of soft landscapes on campus.

Very high	Large natural area with limited disturbance is well connected and includes a variety of habitat types.
High	Intact natural area with some levels of disturbance, connections, and habitat types. Not limiting to wildlife, but not providing good habitat.
Moderate	Semi-disturbed natural areas, minor connections, and habitat types. Partially limiting to wildlife.
Low	Disturbed or developed area that provides limited habitat. Includes some canopy, but this may be young or sparse. Small patch size. Suitable for urban tolerant species.
Very Low	Disturbed or developed area that provides very limited or no habitat. Suitable for urban tolerant species.

UBC-Musqueam Peninsula Coordination Maps
(2022)

Ecological Baseline Report
(2023)

Biodiversity Network

- Building on the existing conditions, identifies the future locations and types of ecological habitat areas and corridors on the campus
- Informs Ecological Landscape Mosaic

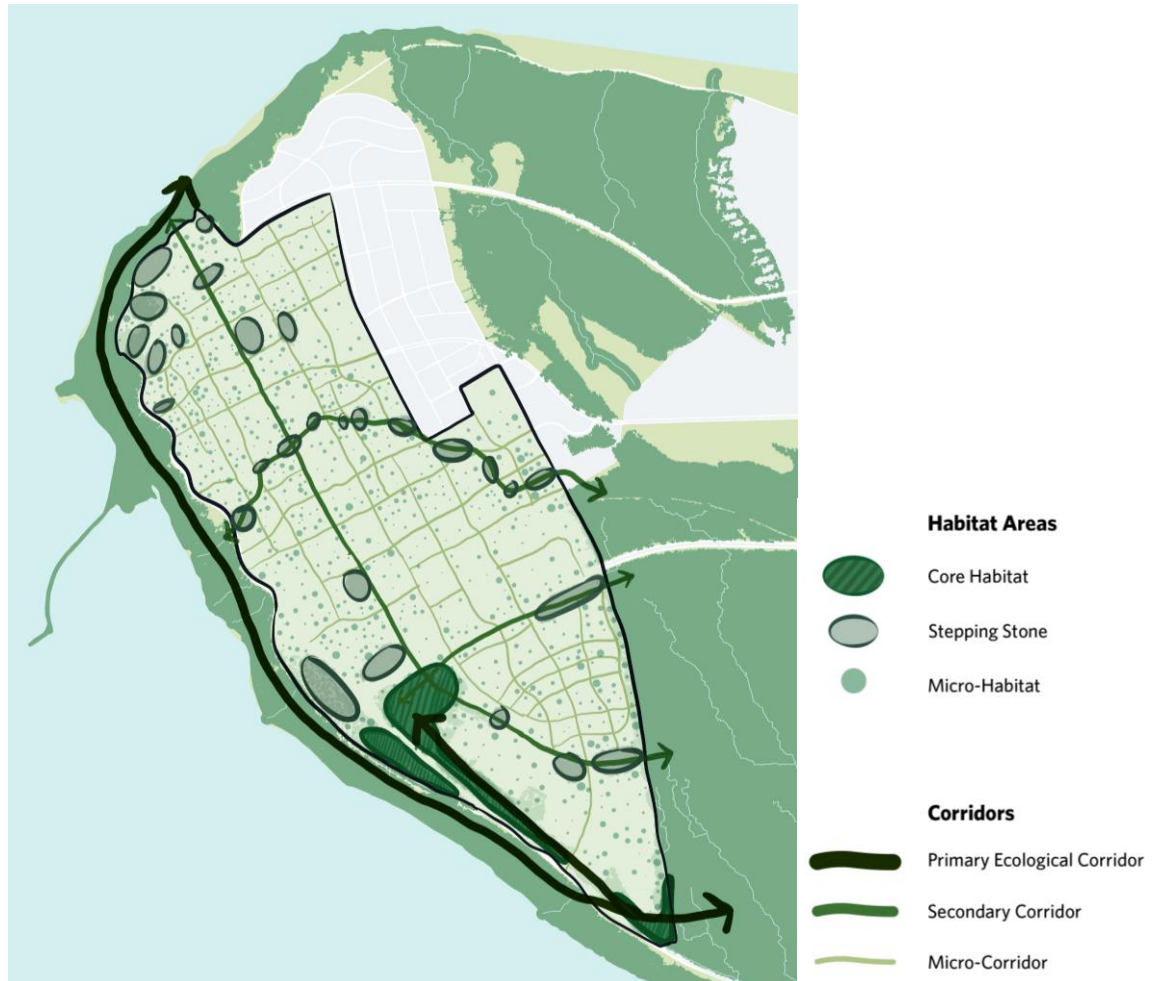

Descriptions

Habitat Areas

- **Core Habitat:** Larger areas that provide habitat for species less tolerant of urbanization, shielded from the impacts of development and human activity.
- **Stepping Stone Habitat:** Smaller areas that provide habitat for species more tolerant of urban conditions and facilitate the movement and dispersal of highly mobile wildlife.
- **Micro-Habitat:** Areas that contribute on a small scale to biodiversity on campus. Collectively, these spaces create habitats for species tolerant of human disturbances.

Corridors

- **Primary Ecological Corridors:** Linear natural areas that connect core habitats. They are wide enough to support movement of species less tolerant of urban conditions.
- **Secondary Corridors:** Narrow, fragmented linkages that support the movement of species tolerant of urban conditions, and have continuous canopy cover.
- **Micro-Corridors:** Narrower corridors that provide finer-grained connections supporting a robust biodiversity network.

Ecological Mosaic

- Building on existing conditions and the Habitat Network, identifies the future locations and types of ecological landscapes, their intended character and function, and strategies for climate adaptation and succession
- Guides site and building design and landscape planning, design and management

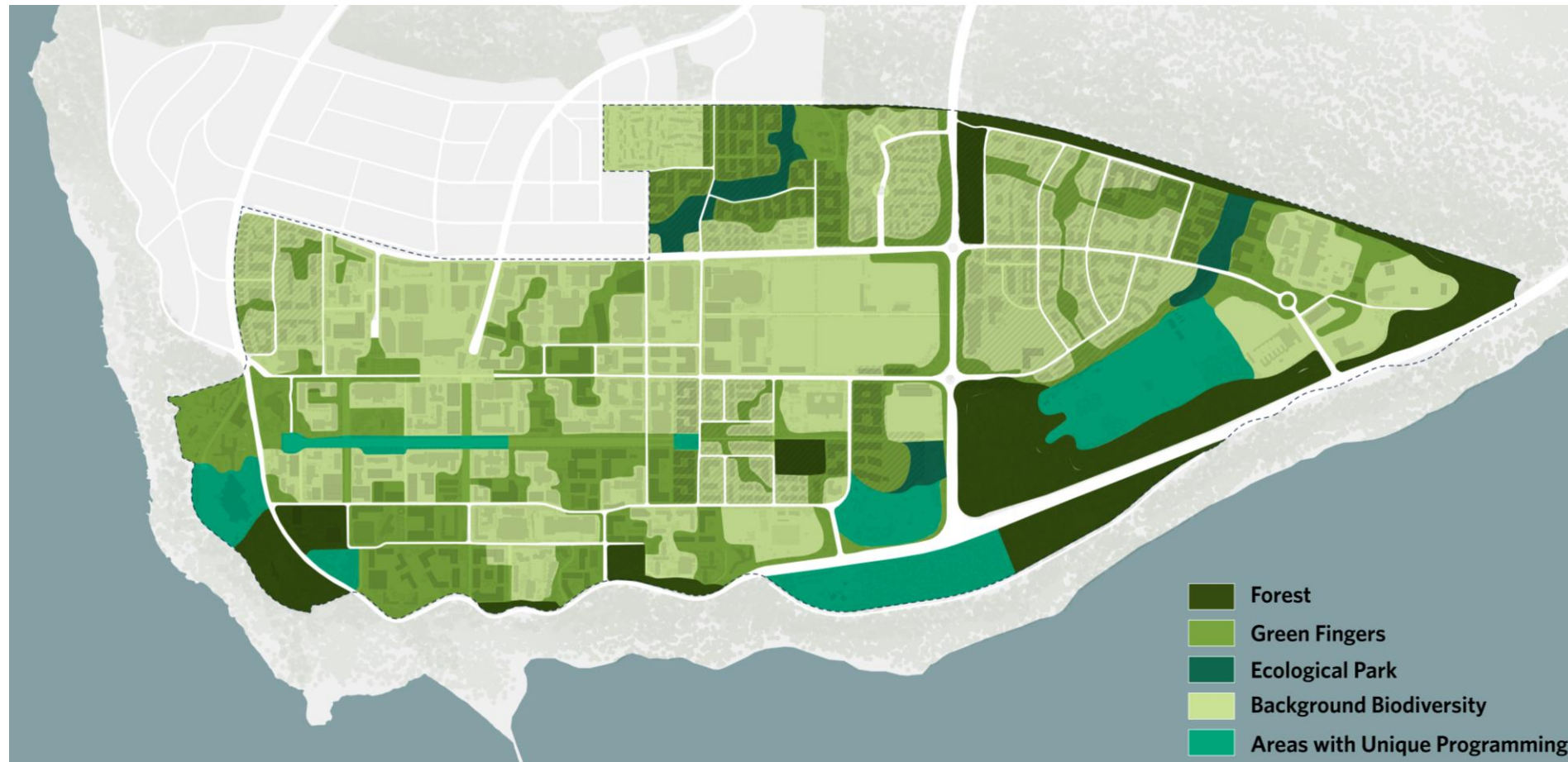

Ecological Mosaic:

Forest

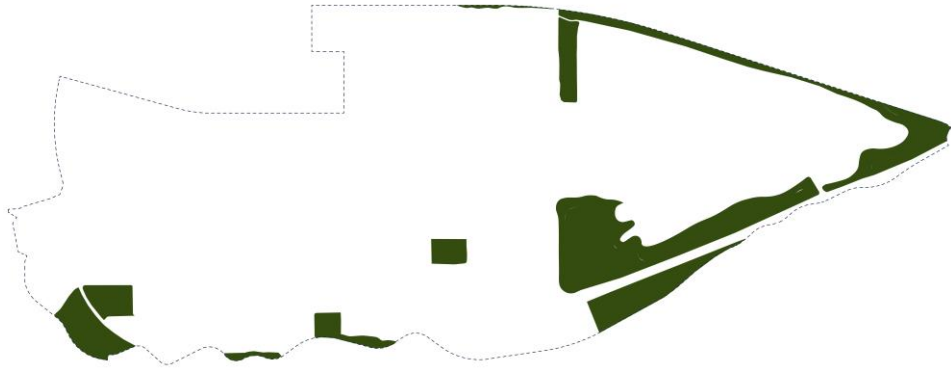

Ecological Character + Function

- High value ecological nature sanctuary for a remnant forest in the Coastal Western Hemlock Zone to be preserved and restored

Climate Adaptation + Succession

- Plan for succession and transition to a forest typical of the Coastal Douglas Fir Zone over time and plant climate resilient species to suit this new condition

Access, Activities + Uses

- Limited public and service access
- Ecosystem Management - protection, conservation, and restoration, as well as supporting Traditional Ecological Knowledge and plant migration
- Research activities

Ecological Mosaic:

Green Fingers



Ecological Character + Function

- Woodland landscape with varying degrees of planted density meshed with buildings and circulation networks, transitioning from the Forest character into the heart of campus.

Climate Adaptation + Succession

- Plan to increase the baseline ecological condition of landscapes within the Green Fingers areas and plant climate resilient woodland vegetation for new and renewed landscapes.

Access, Activities + Uses

- Full public access - sidewalks, roads, paths, plazas, and courtyards
- Plan for emergency and service access in designated areas
- Ecosystem Management - maintenance of current landscapes and planned renewal of aging landscapes as well as supporting Traditional Ecological Knowledge and plant migration
- Research activities

Ecological Mosaic:

Ecological Park

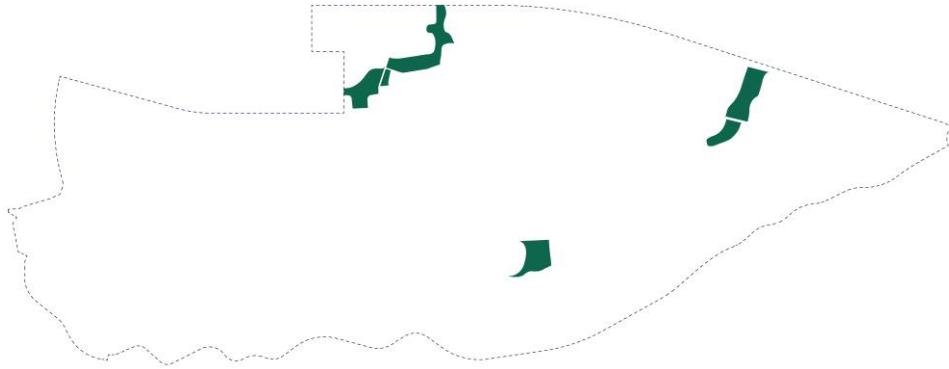

Ecological Character + Function

- Park space inviting active outdoor amenities supporting a high value ecological condition.

Climate Adaptation + Succession

- Restore the local Coastal Western Hemlock Zone forest vegetation, transition to Coastal Douglas Fir Zone forest vegetation over time and plant climate resilient species to suit this new condition.

Access, Activities + Uses

- Limited public access - walking trail (including dog-walking) access, bike trail access
- Limited service access - only as required and in designated areas
- Plan for emergency access
- Park Management - ongoing management of ecological and recreational spaces
- Research activities

Ecological Mosaic:

Background Biodiversity



Ecological Character + Function

- Ecologically variable spaces that contribute to habitat connectivity and provide an opportunistic boost to biodiversity

Climate Adaptation + Succession

- Optimize biodiversity wherever possible, and integrate with green rainwater infrastructure.

Access, Activities + Uses

- Full public access - sidewalks, roads, paths, plazas, and courtyards
- Full emergency and service access
- Landscape Management - as appropriate for the site condition
- Research activities



Ecological Mosaic:

Areas with Unique Programming

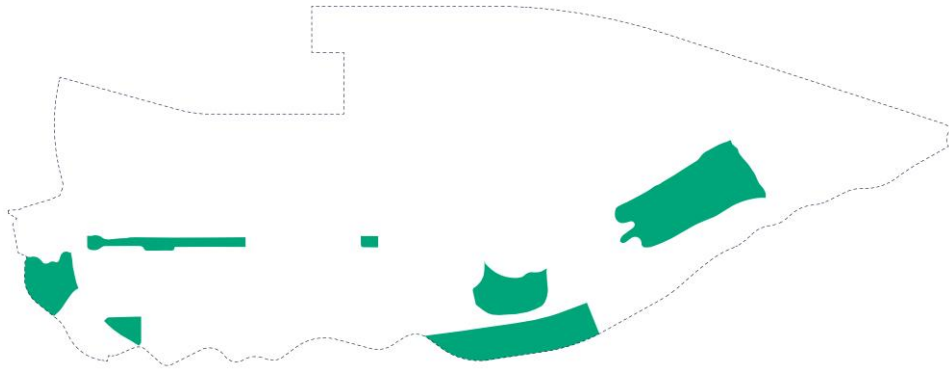

Ecological Character + Function

- The character and function of the areas with unique programming will remain as they currently are, or change according to area-specific planning and design.

Climate Adaptation + Succession

- In coordination with Campus and Community Planning, areas with unique programming should have policies and procedures in place to prepare for changes in climate that will affect their area's ecology and align with the greater adaptation and mitigation goals of UBC.

Access, Activities + Uses

- As per program requirements



Open Space Goals and Objectives

Vision

- An ecologically rich campus connected to its unique natural setting and reflecting a deep Musqueam presence and sense of welcome. (source: Vision, restorative and resilient landscapes big idea statement)

Goal

- Support simultaneous improvements in human and ecological health and wellbeing. (Source: UBC 20-Year Sustainability Strategy)



Open Space Goals and Objectives

Objectives

- Strengthen Musqueam presence through campus landscapes.
- Provide equitable access to open space on campus, emphasizing accessible walking, rolling and cycling paths
- Provide opportunities for learning and research in campus open spaces (e.g. outdoor learning, storytelling, student projects, etc.).
- Create opportunities for community building and social connection in open spaces.
- Provide for moments of respite, reflection, and recreation.
- Contribute to campus placemaking, campus organization, and intuitive wayfinding.
- Support cross-cultural understanding and expression.

Access to Open Space

- Defines areas of campus that are designated as open space, and describes level of access
- To monitor open space and clarify access for people



Estimated change in open space

Based on draft 30-Year Vision, specifics to be determined through detailed campus & neighbourhood planning

	2023	2050
Usable Neighbourhood Open Space (UNOS)	19.7 ha (1.0 ha/1000 n'hood res.)	appx 33 ha (0.9 ha/1000 n'hood res.)
Access to open space on academic lands	appx 55-60 ha	appx 50-55 ha
Access to limited open space on academic lands	appx 65-70 ha	appx 60-65 ha
Access to Pacific Spirit Park within 5 min walk from UBC	appx 155 ha	appx 155 ha
Total access to open space	appx 300 ha	appx 300 ha

People at UBC benefit from access to:

* Community centres

Access to Open Space

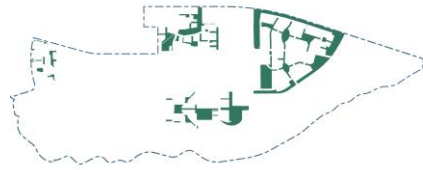

Usable Neighbourhood Open Space (UNOS)

- Public open space located within neighbourhoods (Land Use Plan requires 0.7-1.1 ha of UNOS per 1,000 neighbourhood residents)
- Accessible by neighbourhood residents and the rest of UBC's general population as part of the overall open space framework



Open Space on Academic Land

- Large, publicly accessible open spaces on the academic campus
- Areas are open to everyone



Limited Access Open Space on Academic Land

- Open spaces on campus that have limited public access

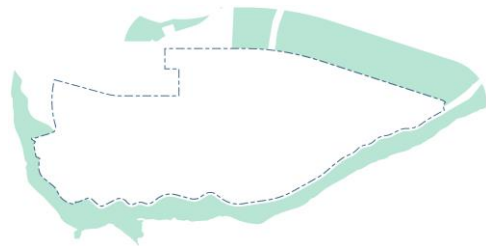

Pacific Spirit Park

- UBC campus is adjacent to Pacific Spirit park with highlighted areas falling within a 5 minute walk

Open Space Typologies

- Defines the network of outdoor public spaces and describes their intended character and function
- Guides projects, including buildings that need to respond to open spaces



Open Space Typologies

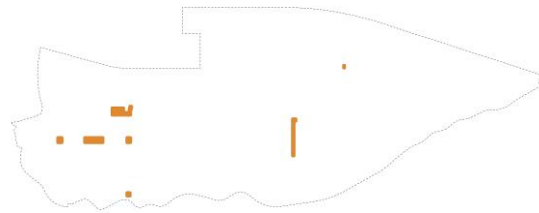

Commons + Plazas

- Large open spaces that function as the campus's key civic spaces.
- Predominantly paved or hardscaped materials.
- Opportunity to incorporate Musqueam identity and presence



Community Open Space

- Large open spaces that function as the campus' living room.
- Predominantly hardscape and softscape depending on character.
- Provide opportunities for interaction with each other and nature.
- Provide opportunities to advance habitat formation and biodiversity.

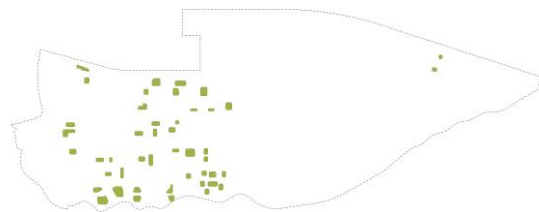

Courtyards

- Smaller open spaces for small group gathering and respite.
- Both hardscape and softscape materials, seating and shade.
- Provide open space relief throughout the academic campus, and should incorporate outdoor learning and educational expression.

Open Space Typologies

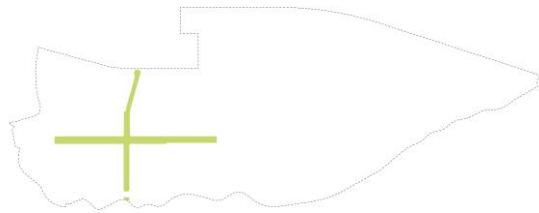

Linear Open Space

- Linear, define key campus corridors, and support movement.
- Reinforce a consistent identity.
- Differentiate places for movement and places for gathering.

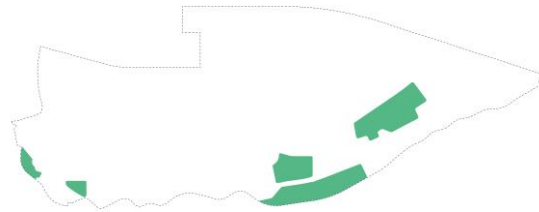

Unique Programming

- Highlight campus attractions.
- Well-designed and highly curated expression.
- Accommodate large groups of people.
- Support public and visitor access.

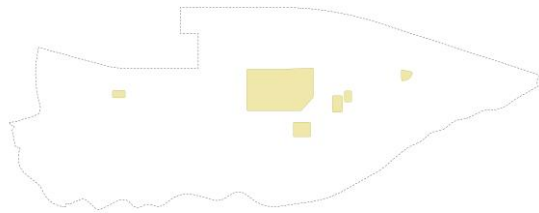

Recreation Fields

- Include both grass and turf open spaces.
- Support a range of use and programming.
- Support public and visitor access.
- Provide opportunities to integrate natural elements and shade.

Discussion

Biodiversity, Ecology & Open Space

- Is this framework serving the goals and objectives?
- What's needed for this framework to be an effective planning / design / operational tool?
- Is there additional research / analysis that could feed into / come out of this framework?



Campus Design

The background features a series of overlapping, semi-transparent circular shapes. On the left, a teal circle overlaps a dark blue circle. In the center, a light blue circle overlaps a darker blue circle. On the right, an orange circle overlaps a purple circle. The overall composition is modern and minimalist.

Campus Character & Design



A Place of Learning



More Housing and Expanded Affordability



A Community of Communities



Restorative and Resilient Landscapes



Connected Campus



Climate Mitigation and Adaptation

- The design of the physical campus responds to and embraces the Vision's big ideas as well as UBC's unique natural context and historic structure.
- Open and green spaces, streets and buildings interact at different scales with diverse uses, activities and programming, informing the character and experience of the campus.

CV2050 6 Big Ideas

Campus Design

Draft Goals and Objectives

Vision

- Open and green spaces, streets and buildings, diverse uses, activities and programming interact at different scales with a unique physical context and strengthened Musqueam presence to inform the character, organization, and experience of the campus. (source: Vision, character)

Goal

- Create places for people that are socially-connected, inclusive and responsive to the unique context of UBC.



Campus Design

Draft Goals and Objectives

Objectives

- Strengthen sense of arrival and connection to place (both to Musqueam's traditional territory and UBC as a global institution)
- Celebrate and showcase UBC as a place of learning, innovation and the exchange of ideas
- Create compact, complete communities with access to daily needs
- Create a legible campus structure
- Activate the campus, day and night to support interaction and safety
- Reinforce a pedestrian-scaled experience
- Create opportunities for community building and social connection in indoor and outdoor spaces.
- Design for climate mitigation and adaptation

Amenities + Activators

- Identifies corridors / special streets, amenity clusters and areas of ground floor activation, important nodes and corridors
- Concentrates activation along key corridors and nodes, for vibrancy and nighttime security

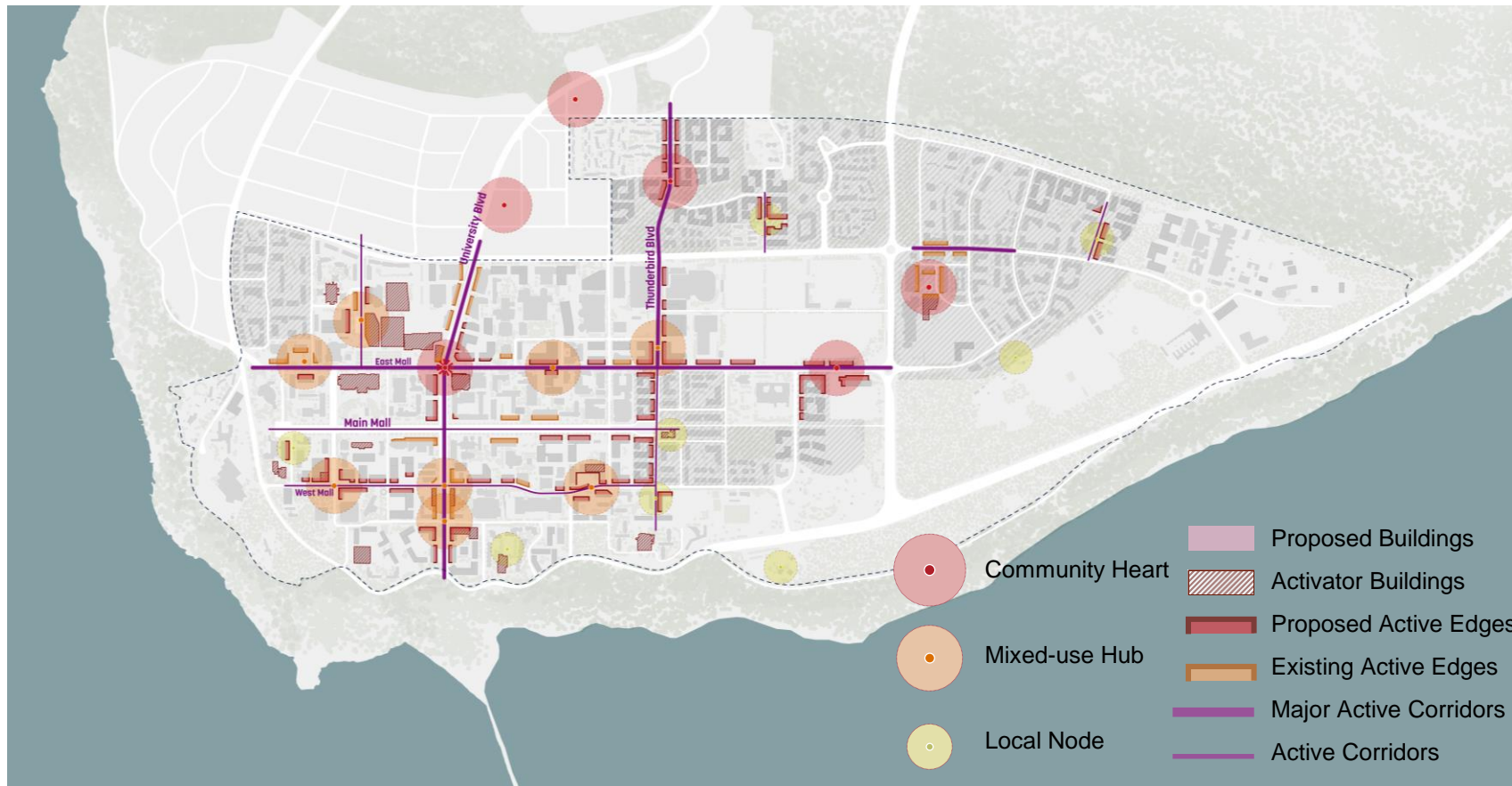

Gateways + Views

- Identifies locations of current and future gateways and key views to support wayfinding, legibility, navigation and visual connections to surrounding campus
- Defines view corridors that need to be preserved, to inform building setbacks and placement, and gateways to reinforce a sense of hierarchy and transition to campus



Gateways + Views



Prominent views and points of welcome root the campus in its context: proximity to the water and views of the Salish Sea and mountains to the north, a forested edge to the west, and a sense of welcome and arrival from the south and east.

Gateways

- Strengthen a memorable and welcoming arrival experience to campus at key gateways.
- Unique to each context, expressing the cultural values of Musqueam through a combination of distinctive architecture, indigenous landscapes and features, public art, street design and lighting.

Views

- UBC views connect the community with the surrounding natural setting, and for Musqueam use of land and places of cultural value.
- The view at the north end of Main Mall is culturally significant to Musqueam and will be enhanced by a reimagined landscape that replaces parts of the formal lawns with a more naturalized landscape using indigenous plants and design elements.
- UBC will work with Musqueam and Metro Vancouver to explore enhancing and restoring cherished views from Main Mall, University Boulevard, East Mall and West Mall.

Academic Communities

- Identifies areas of unique / distinctive academic use
- Informs siting of future uses to promote programmatic synergies

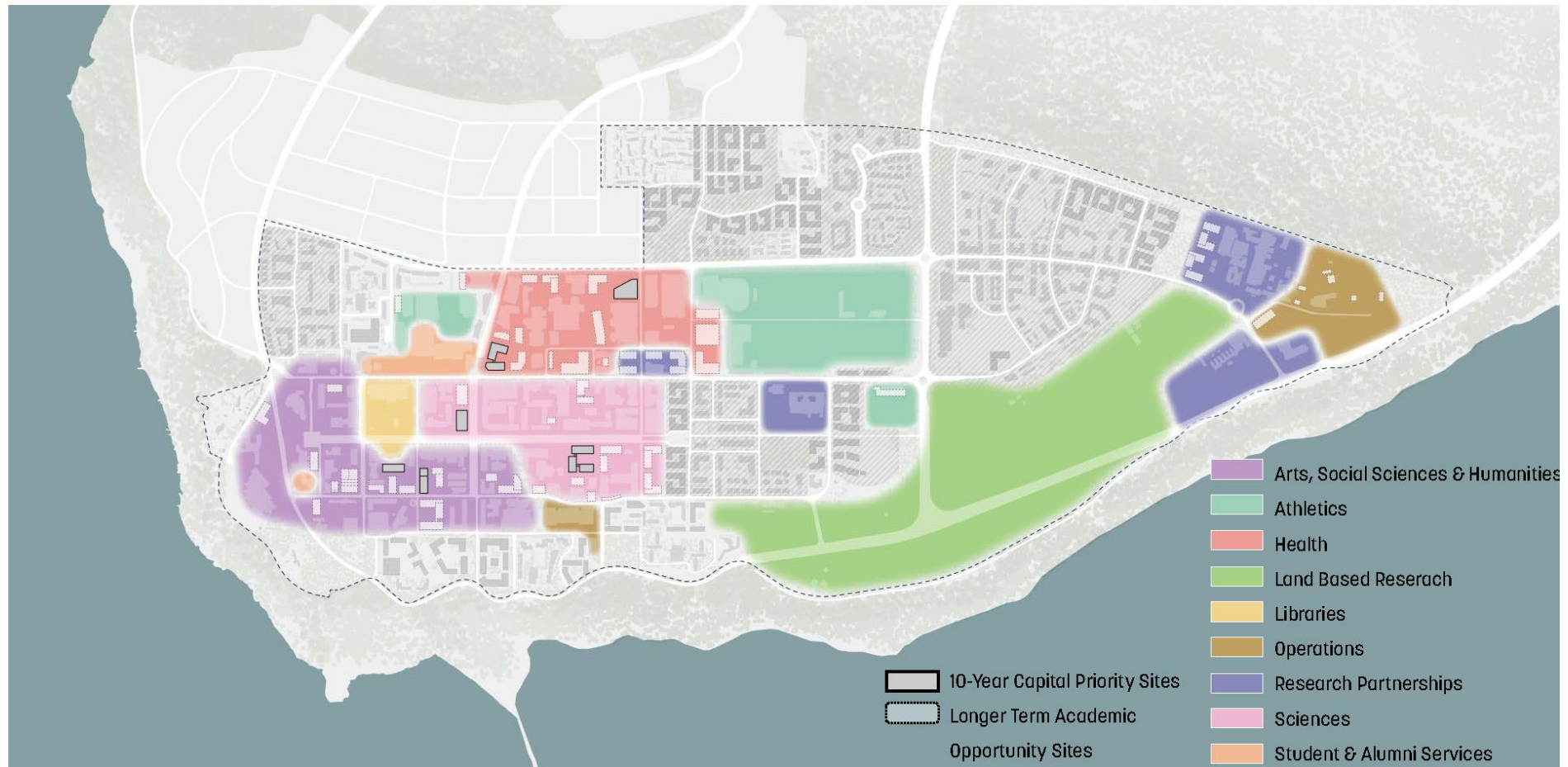

Character Areas

Preliminary

- Defines areas with a unique physical identity, and describes their character
- Informs building and landscape character

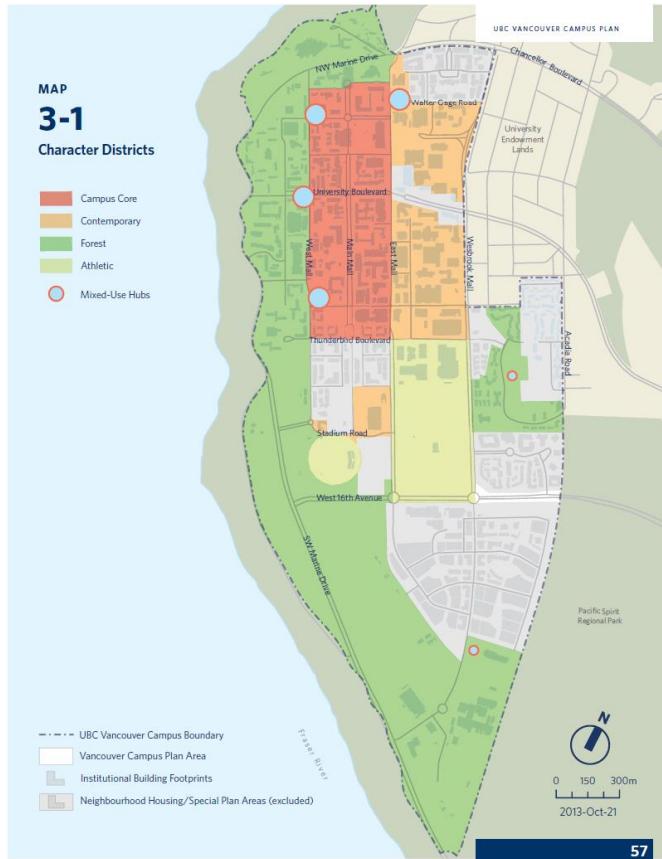

Vancouver Campus Plan 2010

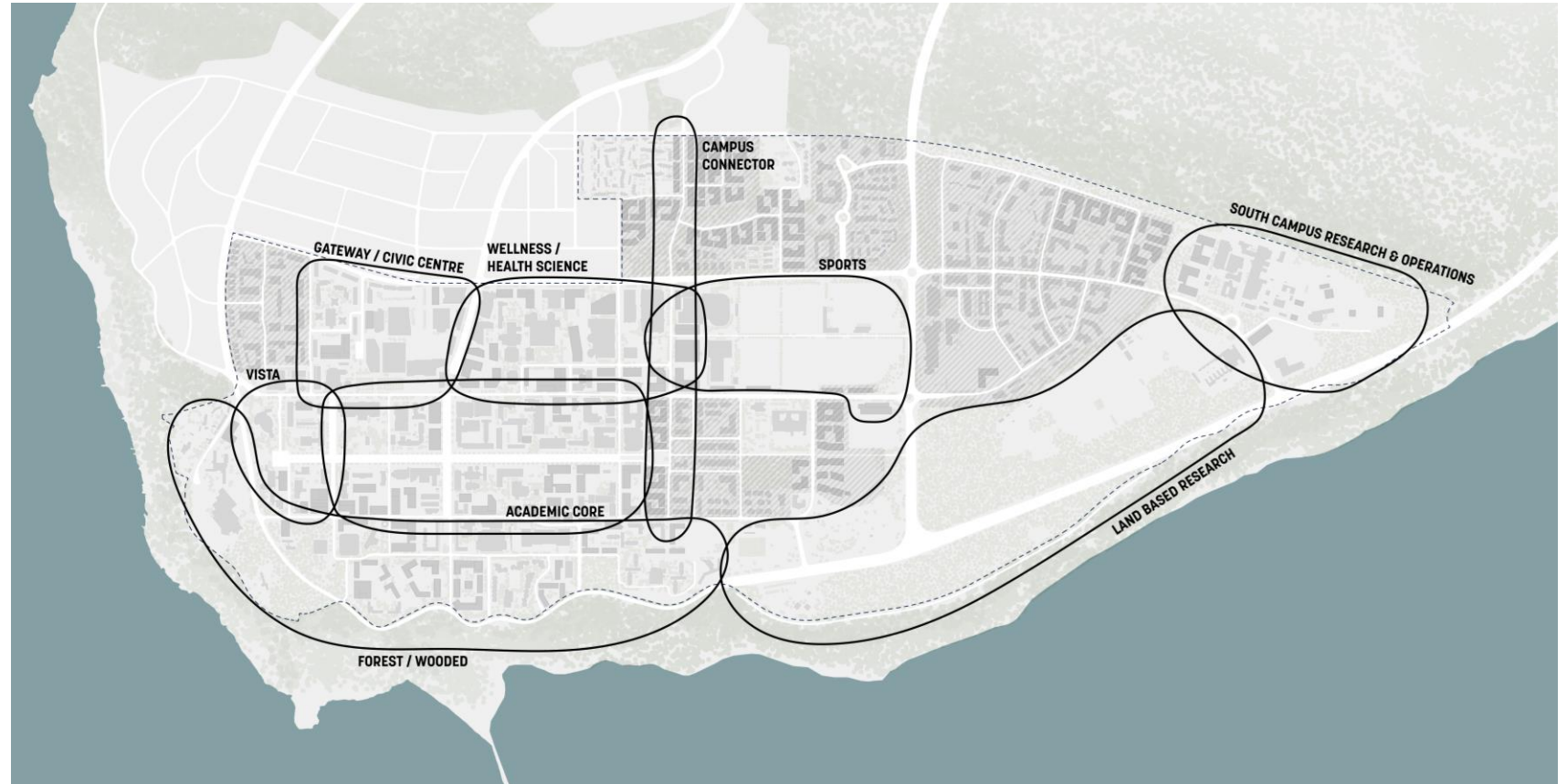

Character Areas Map Example

Discussion

Campus Design

- Please trace outlines around what you consider to be the key character zones on campus. Share / discuss
- How would you use and apply character zones in campus planning and design? How should character zones / academic communities be distinct? What should be consistent across character zones?
- Please identify what you consider to be key campus moments (i.e. special places, memorable experiences) now and in the future, and why?



Role of the CAC

The background features several overlapping, curved, organic shapes in various colors: a teal shape on the left, a dark blue shape at the top left, a light blue shape in the upper middle, an orange shape on the right, and a purple shape at the bottom right. The text 'Role of the CAC' is positioned in the dark blue area on the left side.

Discussion

Role of the CAC

Option 1

- Fill CAC vacancies
- Meet as needed to align with key milestones
 - Early directions on Wesbrook Neighbourhood Plan Amendment
 - Draft Neighbourhood Climate Action Plan
- Resume regular meetings in early 2025 to provide input into draft Campus Plan

Option 2

- Dissolve CAC and support member engagement through other processes

Next Steps

- Poll on role of CAC
- Next meeting in May (TBD)
- Upcoming Engagement: Neighbourhood Climate Action Plan
 - March 9: Open House and Workshop at the Wesbrook Community Centre
 - March 13: Open House and Workshop at CIRS

For more information see here: <https://planning.ubc.ca/NCAP>



Thank you!



THE UNIVERSITY OF BRITISH COLUMBIA
Campus + Community Planning

campusvision2050.ubc.ca